

## Nut - A-INL-M20-P-LG - 1414570

Please be informed that the data shown in this PDF Document is generated from our Online Catalog. Please find the complete data in the user's documentation. Our General Terms of Use for Downloads are valid (<http://phoenixcontact.com/download>)

Nut, Cable gland material: Polyamide, PA 6 GF 30, For threads M20, Color: lightgrey RAL 7035



### Key Commercial Data

Packing unit	1 STK
Minimum order quantity	5 STK
Custom tariff number	39269097
Country of origin	Turkey

### Technical data

#### Dimensions

Length	6 mm
Connecting thread diameter	20 mm
Wrench size, counter nut	26 mm
Hexagon angular dimension GRP	28.6 mm

#### Ambient conditions

Ambient temperature (operation)	-20 °C ... 80 °C
---------------------------------	------------------

#### General

Material	PA 6 GF 30
Cable gland material	Polyamide
Color	lightgrey RAL 7035

### Drawings

# Nut - A-INL-M20-P-LG - 1414570

Dimensional drawing

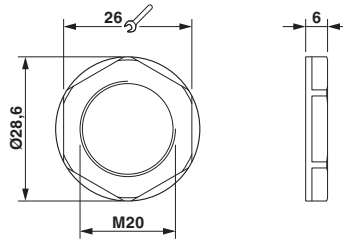

## Classifications

### eCl@ss

eCl@ss 5.1	23110701
eCl@ss 6.0	27149109
eCl@ss 8.0	23110701

### ETIM

ETIM 5.0	EC000129
----------	----------

单击下面可查看定价，库存，交付和生命周期等信息

[>>Phoenix Contact\(菲尼克斯\)](#)