

## Connector - C-SCFFI 2,5/6,3X0,8 - 3240547

Please be informed that the data shown in this PDF Document is generated from our Online Catalog. Please find the complete data in the user's documentation. Our General Terms of Use for Downloads are valid (<http://download.phoenixcontact.com>)



Slip-on sleeve, fully isolated, blue, 1.5 - 2.5 mm<sup>2</sup>, for plug 6.3 x 0.8 mm

### Product Features

- Hard-soldered crimping zone for maximum conductor pull-out forces in connection with CRIMPFOX RCI... pliers
- Easy and reliable conductor entry thanks to 'EASY ENTRY'
- Halogen-free
- Electrolytically tin-plated



### Key commercial data

Packing unit	1 1
Minimum order quantity	25 1
Custom tariff number	85366990
Country of origin	China

### Technical data

#### Dimensions

Length (b)	22 mm
Width (a)	6.3 mm
Length of insulation sleeve (c)	11 mm
Inner dimension of the insulating collar (d)	5 mm
Material thickness (g)	0.4 mm

#### Ambient conditions

Ambient temperature (operation)	-20 °C ... 105 °C
Short-term temperature	120 °C
Max. permanent temperature	105 °C

#### General

## Connector - C-SCFFI 2,5/6,3X0,8 - 3240547

### Technical data

#### General

Color	blue
Stripping length	8 mm
Components	Halogen-free
Material	Brass

### Classifications

#### eCl@ss

eCl@ss 4.0	27140815
eCl@ss 4.1	27140815
eCl@ss 5.0	27260701
eCl@ss 5.1	27260701
eCl@ss 6.0	27400209
eCl@ss 7.0	27440304
eCl@ss 8.0	27440304

#### ETIM

ETIM 2.0	EC000516
ETIM 3.0	EC000516
ETIM 4.0	EC000516
ETIM 5.0	EC000516

#### UNSPSC

UNSPSC 6.01	30211923
UNSPSC 7.0901	39121522
UNSPSC 11	39121522
UNSPSC 12.01	39121522
UNSPSC 13.2	39121522

### Drawings

## Connector - C-SCFFI 2,5/6,3X0,8 - 3240547

Dimensioned drawing

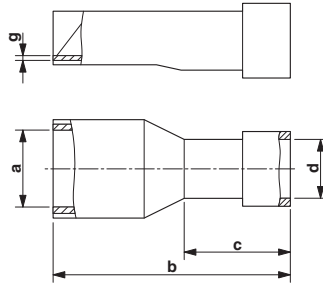

单击下面可查看定价，库存，交付和生命周期等信息

[>>Phoenix Contact \(菲尼克斯\)](#)