

# Header - PCV 6-16/ 4-G1F-10,16 - 1998881

Please be informed that the data shown in this PDF Document is generated from our Online Catalog. Please find the complete data in the user's documentation. Our General Terms of Use for Downloads are valid (<http://phoenixcontact.com/download>)



Header, nominal current: 76 A, rated voltage (III/2): 1000 V, number of positions: 4, pitch: 10.16 mm, color: green, contact surface: Silver, mounting: Wave soldering

The figure shows a 5-pos. version of the product

## Why buy this product

- Well-known mounting principle allows worldwide use
- Screwable flange for superior mechanical stability
- Maximum flexibility when it comes to device design – one header for connectors with different connection technologies

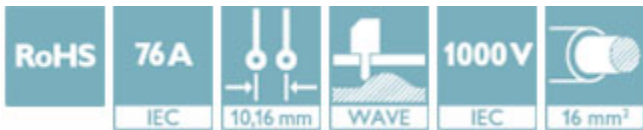

## Key Commercial Data

Packing unit	1 STK
Minimum order quantity	50 STK
GTIN	
GTIN	4046356038386
Weight per Piece (excluding packing)	22.920 g
Custom tariff number	85366930
Country of origin	Poland

## Technical data

### Dimensions

Length [ l ]	13.4 mm
Pitch	10.16 mm
Dimension a	30.48 mm
Width [ w ]	43.68 mm

# Header - PCV 6-16/ 4-G1F-10,16 - 1998881

## Technical data

### Dimensions

Constructional height	34 mm
Height [ h ]	38 mm
Length of the solder pin	4 mm
Pin dimensions	1 x 1.2 mm
Pin spacing	10.16 mm
Hole diameter	1.7 mm

### General

Range of articles	PCV 6-16/...-G1F
Insulating material group	I
Rated surge voltage (III/3)	6 kV
Rated surge voltage (III/2)	8 kV
Rated surge voltage (II/2)	8 kV
Rated voltage (III/3)	1000 V
Rated voltage (III/2)	1000 V
Rated voltage (II/2)	1000 V
Connection in acc. with standard	EN-VDE
Nominal current $I_N$	76 A (41 A in combination with PC 6 plug)
Maximum load current	76 A (41 A in combination with PC 6 plug)
Insulating material	PA
Flammability rating according to UL 94	V0
Color	green
Number of positions	4

### Standards and Regulations

Connection in acc. with standard	EN-VDE
	CUL
Flammability rating according to UL 94	V0

### Environmental Product Compliance

China RoHS	Environmentally friendly use period: unlimited = EFUP-e
	No hazardous substances above threshold values

### Drawings

# Header - PCV 6-16/ 4-G1F-10,16 - 1998881

Drilling diagram

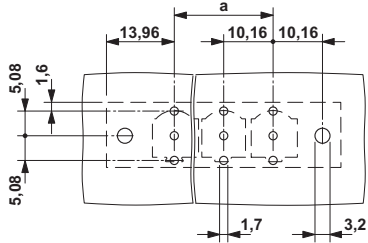

Dimensional drawing

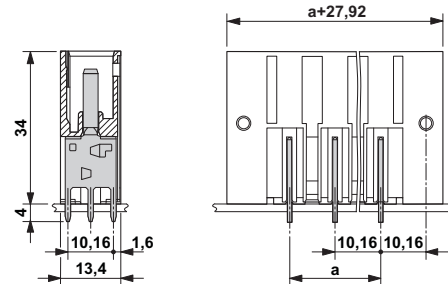

## Classifications

### eCl@ss

eCl@ss 4.0	272607xx
eCl@ss 4.1	27260701
eCl@ss 5.0	27260701
eCl@ss 5.1	27260701
eCl@ss 6.0	27260704
eCl@ss 7.0	27440402
eCl@ss 8.0	27440402
eCl@ss 9.0	27440402

### ETIM

ETIM 3.0	EC001121
ETIM 4.0	EC002637
ETIM 5.0	EC002637
ETIM 6.0	EC002637

### UNSPSC

UNSPSC 6.01	30211810
UNSPSC 7.0901	39121409
UNSPSC 11	39121409
UNSPSC 12.01	39121409
UNSPSC 13.2	39121409

## Approvals

### Approvals

#### Approvals

SEV / IECCEB CB Scheme / EAC / cULus Recognized

# Header - PCV 6-16/ 4-G1F-10,16 - 1998881

## Approvals

Ex Approvals

### Approval details

SEV		<a href="https://www.electrosuisse.ch/en/meta/shop/product-certificates.html">https://www.electrosuisse.ch/en/meta/shop/product-certificates.html</a>	IK-3431
Nominal current IN	76 A		
Nominal voltage UN	1000 V		

IECEE CB Scheme		<a href="http://www.iecee.org/">http://www.iecee.org/</a>	CH-8077
Nominal current IN	76 A		
Nominal voltage UN	1000 V		

EAC			B.01742
-----	---	--	---------

cULus Recognized		<a href="http://database.ul.com/cgi-bin/XYV/template/LISEXT/1FRAME/index.htm">http://database.ul.com/cgi-bin/XYV/template/LISEXT/1FRAME/index.htm</a>	E60425-20040202
	B	C	D
Nominal current IN	66 A	66 A	5 A
Nominal voltage UN	300 V	300 V	600 V

## Accessories

Accessories

Coding element

## Header - PCV 6-16/ 4-G1F-10,16 - 1998881

### Accessories

Coding profile - CP-PC RD - 1701967



Coding profile, for plugging into the coding ribs of the plug at a later date, insulating material, color: Red

---

### Mounting material

Accessories - DFK-PC 16-SS - 1705449



Screw set for DFK-PC 16... connectors

---

### Additional products

Printed-circuit board connector - SPC 16/ 4-STF-10,16 - 1711394



Plug component, nominal current: 76 A, rated voltage (III/2): 1000 V, number of positions: 4, pitch: 10.16 mm, connection method: Push-in spring connection, color: green, contact surface: Silver

---

Printed-circuit board connector - SPC 16/ 4-STF-SH-10,16 - 1711488



Plug component, nominal current: 76 A, rated voltage (III/2): 1000 V, number of positions: 4, pitch: 10.16 mm, connection method: Push-in spring connection, color: green, contact surface: Silver

---

Printed-circuit board connector - TPC 16/ 4-STF-10,16 - 1715277



Plug component, nominal current: 76 A, rated voltage (III/2): 1000 V, number of positions: 4, pitch: 10.16 mm, connection method: Screw connection with tension sleeve, color: green, contact surface: Silver

## Header - PCV 6-16/ 4-G1F-10,16 - 1998881

### Accessories

---

Printed-circuit board connector - PC 6/ 4-STF-10,16 - 1913594



Plug component, nominal current: 41 A, rated voltage (III/2): 1000 V, number of positions: 4, pitch: 10.16 mm, connection method: Screw connection with tension sleeve, color: green, contact surface: Silver

---

Printed-circuit board connector - PC 16/ 4-STF-10,16 - 1967472



Plug component, nominal current: 76 A, rated voltage (III/2): 1000 V, number of positions: 4, pitch: 10.16 mm, connection method: Screw connection with tension sleeve, color: green, contact surface: Silver

---

Printed-circuit board connector - PC 16/ 4-STF-SH-10,16 - 1970359



Plug component, nominal current: 76 A, rated voltage (III/2): 1000 V, number of positions: 4, pitch: 10.16 mm, connection method: Screw connection with tension sleeve, color: green, contact surface: Silver

---

单击下面可查看定价，库存，交付和生命周期等信息

[>>Phoenix Contact \(菲尼克斯\)](#)