

Device connector, front mounting - SH-8ESS48AAD00S - 1621564

Please be informed that the data shown in this PDF Document is generated from our Online Catalog. Please find the complete data in the user's documentation. Our General Terms of Use for Downloads are valid (<http://phoenixcontact.com/download>)



Device connector for front wall, angled rotatable, shielded: yes, Screw locking, M23, Number of positions: 8+4+PE, Type of contact: Socket, Crimp connection, Axial O-ring, 4x Ø3.2, Flange dimensions: 26 mm x 26 mm

The figure shows the product version with CAT5 interface

Product Features

- All housing can be fitted with pin or socket contacts
- A total of eight contacts are available for signal transmission
- Reduced connection time with optional SPEEDCON fast locking system



Key Commercial Data

| | |
|----------------------|----------|
| Packing unit | 1 pc |
| Custom tariff number | 85366990 |
| Country of origin | Germany |

Technical data

Temperature range

| | |
|---------------------------------|-------------------|
| Ambient temperature (operation) | -40 °C ... 130 °C |
|---------------------------------|-------------------|

Data of the insulating body

| | |
|--|--|
| Note | Order information Crimp contacts, 8 x Ø 1 mm, 5 x Ø 2 mm, order separately |
| Coding | N |
| Insulator material | Polyamide (PA 6.6) |
| Insertion/withdrawal cycles mechanical | 100 |
| Contact connection method | Crimp connection |
| Type of contacts | Socket |
| Number of positions | 13 |
| Contact diameter of power contacts | 2 mm |

Device connector, front mounting - SH-8ESS48AAD00S - 1621564

Technical data

Data of the insulating body

| | |
|---|----------------------|
| Litz wire cross section of power contacts min. | 0.25 mm ² |
| Litz wire cross section of power contacts max. | 4 mm ² |
| Nominal current per power contact at 25°C | 30 A |
| Nominal voltage, power contact | 630 V AC |
| Contact diameter of signal contacts | 1 mm |
| Litz wire cross section of signal contacts min. | 0.06 mm ² |
| Litz wire cross section of signal contacts max. | 1 mm ² |
| Nominal current per signal contact at 25°C | 8 A |
| Nominal voltage, signal contact | 50 V |
| Overvoltage category | III |
| Degree of pollution | 3 |

Housing data

| | |
|--|--|
| Housing material | Turned parts: copper zinc alloy (CuZn), die-cast parts: zinc (GD-Zn) |
| Flange dimensions | 26 mm x 26 mm |
| Type of locking | Screw locking |
| Degree of protection (when plugged in) | IP67 |
| | IP68 |
| Thread type | M23 |

Classifications

eCl@ss

| | |
|------------|----------|
| eCl@ss 4.0 | 272607xx |
| eCl@ss 4.1 | 27260701 |
| eCl@ss 5.0 | 27143424 |
| eCl@ss 5.1 | 27143424 |
| eCl@ss 6.0 | 27143424 |
| eCl@ss 7.0 | 27440209 |
| eCl@ss 8.0 | 27440102 |

ETIM

| | |
|----------|----------|
| ETIM 4.0 | EC002635 |
| ETIM 5.0 | EC002635 |

Approvals

Approvals

Device connector, front mounting - SH-8ESS48AAD00S - 1621564

Approvals

Approvals

EAC

Ex Approvals

Approvals submitted

Approval details

EAC

Drawings

Schematic diagram

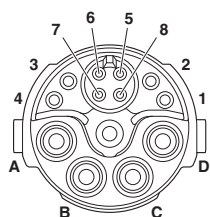

Socket pin assignment, signal

Dimensional drawing

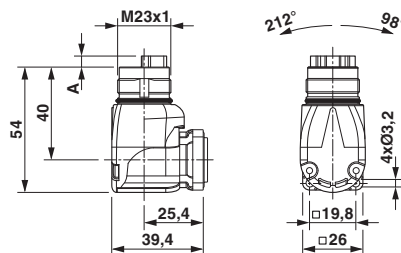

Pin version: dimension A = 4.7 mm, socket version: dimension A = 0 mm

Dimensional drawing

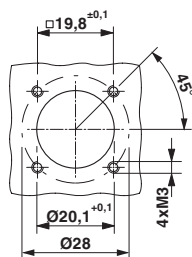

Installation dimensions

单击下面可查看定价，库存，交付和生命周期等信息

[>>Phoenix Contact\(菲尼克斯\)](#)