

## Type 2 surge protection base element - VAL-MS TE-AR/75X350/3EQ/ FM - 2905684

Please be informed that the data shown in this PDF Document is generated from our Online Catalog. Please find the complete data in the user's documentation. Our General Terms of Use for Downloads are valid (<http://phoenixcontact.com/download>)

Assembly with base element for type 2 arresters of the VALVETRAB MS product range, with remote indication contact and field wire disconnect. Version for 3-mode protection of 2-wire signals.



### Product Features

- With floating remote indication contact
- 3-Mode equalizer protection
- Field wire disconnect



### Key Commercial Data

Packing unit	1 pc
Weight per Piece (excluding packing)	550.0 g
Country of origin	Germany

### Technical data

#### Note

Trade restriction	The products are offered exclusively for export outside the EU and the European Economic Area.
-------------------	--

#### Dimensions

Height	193 mm
Width	54 mm
Depth	78 mm
Horizontal pitch	3 Div.

#### Ambient conditions

Degree of protection	IP20
	IP20 (Only when all disconnects are closed)
Ambient temperature (operation)	-40 °C ... 80 °C

# Type 2 surge protection base element - VAL-MS TE-AR/75X350/3EQ/ FM - 2905684

## Technical data

### General

Housing material	PBT / PA
Flammability rating according to UL 94	V0
Color	black
Standards for clearances and creepage distances	EN 60664-1
	EN 61643-1
Mounting type	DIN rail mounting with additional retaining screw
Number of positions	3
Surge protection fault message	Optical, remote indicator contact
Direction of action	(L+)-PE & (L-)-PE & (L+)-(L-)
	(L+)-PE & (L-)-PE & (L+)-(L-)

### Protective circuit

IEC test classification	II
	T2
Nominal voltage $U_N$	5 V AC ... 48 V AC
Maximum continuous operating voltage $U_C$	60 V
	60 V
Maximum continuous operating voltage $U_C$ (L-PE)	230 V
	230 V
Rated load current $I_L$	80 A (Serial through wiring at 16 mm <sup>2</sup> )
Residual current $I_{PE}$	≤ 5 μA
Max. discharge current $I_{max}$ (8/20) μs maximum (L-PE)	20 kA
Nominal discharge current $I_n$ (8/20) μs (L-PE)	10 kA
Voltage protection level $U_p$ (L-PE)	≤ 1.5 kV
Response time $t_A$	≤ 25 ns
Max. backup fuse with branch wiring	200 A (gL / gG)
Max. backup fuse with V-type through wiring	80 A (gL / gG)
Short-circuit resistance $I_p$ with max. backup fuse (effective)	25 kA
	25 kA
Short-circuit current rating $I_{SCCR}$	10 kA (L-L)

### Connection, protective circuit

Connection method	Screw terminal block
Connection type IN	Screw terminal blocks
Connection type OUT	Screw terminal blocks
Screw thread	M5

# Type 2 surge protection base element - VAL-MS TE-AR/75X350/3EQ/FM - 2905684

## Technical data

### Connection, protective circuit

Tightening torque	26.5 lb <sub>F</sub> -in. ... 30 lb <sub>F</sub> -in. (UL)
Stripping length	16 mm
Conductor cross section flexible min.	0.5 mm <sup>2</sup>
Conductor cross section flexible max.	16 mm <sup>2</sup>
Conductor cross section solid min.	0.5 mm <sup>2</sup>
Conductor cross section solid max.	16 mm <sup>2</sup>
Conductor cross section AWG min.	20
Conductor cross section AWG max.	6
Conductor cross section AWG	15 ... 2 (UL)
	20 ... 6
	12 ... 4

### Remote indication contact

Connection name	Remote fault indicator contact
Switching function	PDT, 1-pos.
Connection method	MC 1,5/3
Screw thread	M2
Tightening torque	0.25 Nm
	2 lb <sub>F</sub> -in. ... 4 lb <sub>F</sub> -in. (UL)
Stripping length	7 mm
Conductor cross section flexible min.	0.14 mm <sup>2</sup>
Conductor cross section flexible max.	1.5 mm <sup>2</sup>
Conductor cross section solid min.	0.14 mm <sup>2</sup>
Conductor cross section solid max.	1.5 mm <sup>2</sup>
Conductor cross section AWG min.	28
Conductor cross section AWG max.	16
Maximum operating voltage U <sub>max</sub> AC	250 V AC
Maximum operating voltage U <sub>max</sub> DC	30 V DC
Max. operating current I <sub>max</sub>	1.5 A AC (250 V AC)
	1.5 A DC (125 V AC)
	1.5 A DC (30 V DC)

## Classifications

eCl@ss

eCl@ss 5.1	27130801
------------	----------

## Type 2 surge protection base element - VAL-MS TE-AR/75X350/3EQ/ FM - 2905684

### Classifications

#### eCl@ss

eCl@ss 6.0	27130802
eCl@ss 8.0	27130802
eCl@ss 9.0	27130802

#### ETIM

ETIM 4.0	EC002497
ETIM 5.0	EC000381

### Accessories

#### Accessories

##### Bridge

Plug-in bridge - FBS 2-18 - 2801068



Plug-in bridge for cross-connections in the VAL-MS BE-AR terminal center, 2-pos., color: Red

Wiring bridge - MPB 18/1-57 - 2809238



Wiring bridge for modules with connecting pitch 17.5 mm, 1-phase, 57-pos.

Plug-in bridge - FBS 2-18 - 2801068



Plug-in bridge for cross-connections in the VAL-MS BE-AR terminal center, 2-pos., color: Red

##### Insertion bridge

## Type 2 surge protection base element - VAL-MS TE-AR/75X350/3EQ/ FM - 2905684

### Accessories

Insertion bridge - EB 56-18 - 3009299



Insertion bridge, Pitch: 18 mm, Number of positions: 56, Color: gray

---

### Screwdriver tools

Screwdriver - SZS 0,8X4,0 VDE - 1212508



Screwdriver, slot-headed, VDE insulated, size: 0.8 x 4.0 x 100 mm, 2-component grip, with non-slip grip

---

Screwdriver - SZS 0,4X2,5 VDE - 1205037



Screwdriver, slot-headed, VDE insulated, size: 0.4 x 2.5 x 80 mm, 2-component grip, with non-slip grip

---

### Spare parts

Type 2 surge protection plug - VAL-MS 75 VF ST - 2805318



Surge protection plug type 2 with series connection consisting of varistor and gas-filled spark gap for VAL-MS base element, thermal monitoring, visual fault warning.

## Type 2 surge protection base element - VAL-MS TE-AR/75X350/3EQ/ FM - 2905684

### Accessories

Type 2 surge protection plug - VAL-MS 350 VF ST - 2856595



surge protection connector type 2 with series connection consisting of varistor and gas-filled spark gap for VAL-MS base element, thermal monitoring, visual fault warning. Design: 350 V AC

### Drawings

Dimensional drawing

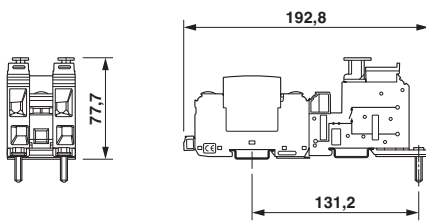

Circuit diagram

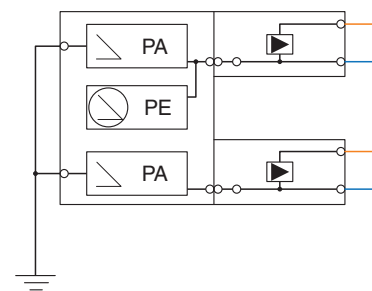

House wires shown as blue. Field wires shown as orange.

单击下面可查看定价，库存，交付和生命周期等信息

[>>Phoenix Contact\(菲尼克斯\)](#)