

COMBICON Spring Cage Plugs and Headers with Self-Locking Flange 5.08 mm Pitch

The new FKC-RF spring cage plug offers a new locking system: the fast plug locking system based on the "click'n lock" principle. When the plug is inserted into the MSTBA-RN header, the snap-in flanges on the sides audibly clip in behind the molded engagement latches. This ensures the plug cannot be inadvertently disconnected. Disconnection is easy thanks to the ergonomically formed locking levers which simply have to be pressed down, thus allowing the plug to be pulled off the header. The "click'n lock" principle functions in the same way when the FKC-RF plug is connected to the inverted FKIC-RN plug for a free-hanging wire connection.

Note:

Plugs and headers with a 5.0 mm pitch can be supplied on request.

Other types available with the "click'n lock" fast locking system include:

- MSTB 2,5 screw connection plugs,
- Vertical plugs with a screw or spring cage connection and
- front screw connection plugs.

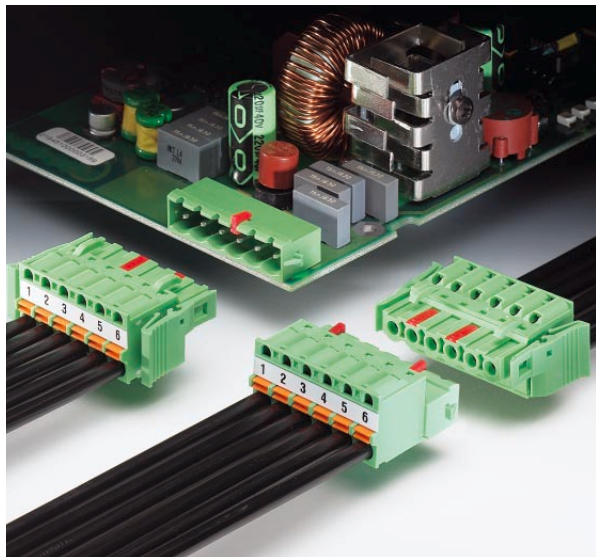

FKC 2,5/...-ST-5,08-RF



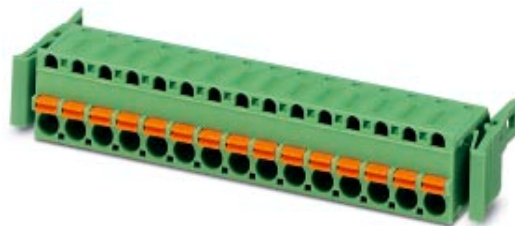

5.08 mm Pitch



Note:

COMBICON plug connectors may only be actuated in the no-load condition. If smaller loads need to be switched for operational reasons, experimental values are available on request.

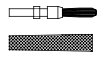
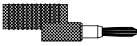
Description	No. of pos.	Dim. a [mm]	Type	Order No.	Pcs./Pkt.
Plugs with self-locking flange, 5.08 mm pitch, color: green,	2	5.08	FKC 2,5/2-ST-5,08-RF	19 25 69 2	50
	3	10.16	FKC 2,5/3-ST-5,08-RF	19 25 70 2	
	4	15.24	FKC 2,5/4-ST-5,08-RF	19 25 71 5	
	5	20.32	FKC 2,5/5-ST-5,08-RF	19 25 72 8	
	6	25.40	FKC 2,5/6-ST-5,08-RF	19 25 73 1	
	7	30.48	FKC 2,5/7-ST-5,08-RF	19 25 74 4	
	8	35.56	FKC 2,5/8-ST-5,08-RF	19 25 75 7	
	9	40.64	FKC 2,5/9-ST-5,08-RF	19 25 76 0	
	10	45.72	FKC 2,5/10-ST-5,08-RF	19 25 77 3	
	11	50.80	FKC 2,5/11-ST-5,08-RF	19 25 78 6	
	12	55.88	FKC 2,5/12-ST-5,08-RF	19 25 79 9	
	13	60.96	FKC 2,5/13-ST-5,08-RF	19 25 80 9	
	14	66.04	FKC 2,5/14-ST-5,08-RF	19 25 81 2	
	15	71.12	FKC 2,5/15-ST-5,08-RF	19 25 82 5	
	16	76.20	FKC 2,5/16-ST-5,08-RF	19 25 83 8	
	17	81.26	FKC 2,5/17-ST-5,08-RF	19 25 84 1	
	18	86.36	FKC 2,5/18-ST-5,08-RF	19 25 85 4	

(1) Coding profile , is inserted into the groove on the plug, insulating material: red			CP-MSTB	17 34 63 4	100
(2) Strain relief , for snapping into the latching chambers of the plugs	4-pos. 8-pos.		STZ 4-FKC-5,08 STZ 8-FKC-5,08	18 76 87 7 18 76 88 0	10
(3) Test plug , consisting of metal part and colored insulating sleeve; Order data, see COMBICON catalog			MPS-... (see COMBICON catalog)		
(4) Reducing plug , for connecting a 4 mm Ø test plug to a 2.3 mm Ø test plug socket, insulation: gray			RPS	02 01 64 7	10
(5) Screwdriver , for releasing the spring blade: 0.6 x 3.5 x 100 mm, length: 180 mm			SZS 0,6 x 3,5	12 05 05 3	10
(6) Marker card , with 12 pcs. 10-section marker strips, white, self-adhesive, for 120 terminal blocks			SK 5,08/3,8 (see COMBICON catalog)		

Technical data

Dimensions	see description		
Pitch	5.08		
Technical data in accordance with IEC/ DIN VDE			
Insulating material group	I		
Surge voltage category / contamination class	III / 3	III / 2	II / 2
Rated voltage [V]	250	320	630
Rated surge voltage [kV]	4	4	4
Nominal current / cross section [A]/[mm²]	12 / 2.5		
Maximum load current / cross section [A]/[mm²]	12 / 2.5		
Connection capacity			
Solid / stranded / conductor sizes [mm²]/[mm²]/AWG	0.2 - 2.5 / 0.2 - 2.5 / 24 - 12		
Stranded with ferrule without / with plastic sleeve [mm²]	0.25 - 2.5 / 0.25 - 2.5		
Multiple connection (2 conductors with same cross section)			
Stranded with TWIN ferrule with plastic sleeve [mm²]	0.5 - 1		
Stripping length [mm]	10		
Internal cylindrical gauge (IEC 60 947-1)	A 2		
Insulating material	PA		
Inflammability class in acc. with UL 94	V0		

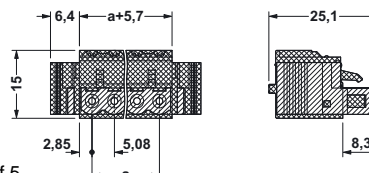

FKIC 2,5/...-ST-5,08-RN 5.08 mm Pitch



Note:
COMBICON plug connectors may only be actuated in the no-load condition. If smaller loads need to be switched for operational reasons, experimental values are available on request.

Description	No. of pos.	Dim. a [mm]	Type	Order No.	Pcs./Pkt.
Inverted plugs with self-locking flange, 5.08 mm pitch, color: green,	2	5.08	FKIC 2,5/2-ST-5,08-RN	19 25 86 7	50
	3	10.16	FKIC 2,5/3-ST-5,08-RN	19 25 87 0	
	4	15.24	FKIC 2,5/4-ST-5,08-RN	19 25 88 3	
	5	20.32	FKIC 2,5/5-ST-5,08-RN	19 25 89 6	
	6	25.40	FKIC 2,5/6-ST-5,08-RN	19 25 90 6	
	7	30.48	FKIC 2,5/7-ST-5,08-RN	19 25 91 9	
	8	35.56	FKIC 2,5/8-ST-5,08-RN	19 25 92 2	
	9	40.64	FKIC 2,5/9-ST-5,08-RN	19 25 93 5	
	10	45.72	FKIC 2,5/10-ST-5,08-RN	19 25 94 8	
	11	50.80	FKIC 2,5/11-ST-5,08-RN	19 25 95 1	
	12	55.88	FKIC 2,5/12-ST-5,08-RN	19 25 96 4	
	13	60.96	FKIC 2,5/13-ST-5,08-RN	19 25 97 7	
	14	66.04	FKIC 2,5/14-ST-5,08-RN	19 25 98 0	
	15	71.12	FKIC 2,5/15-ST-5,08-RN	19 25 99 3	
	16	76.20	FKIC 2,5/16-ST-5,08-RN	19 26 00 2	
	(1) Coding element , is inserted into the recess on the inverted plug, insulating material: red			CR-MSTB	
(2) Strain relief , for snapping into the latching chambers of the plugs	4-pos. 8-pos.		STZ 4-FKC-5,08 STZ 8-FKC-5,08	18 76 87 7 18 76 88 0	10
(3) Test plug , consisting of metal part and colored insulating sleeve; Order data, see COMBICON catalog			MPS-... (see COMBICON catalog)		
(4) Reducing plug , for connecting a 4 mm Ø test plug to a 2.3 mm Ø test plug socket, insulation: gray			RPS	02 01 64 7	10
(5) Screwdriver , for releasing the spring blade: 0.6 x 3.5 x 100 mm, length: 180 mm			SZS 0,6 x 3,5	12 05 05 3	10
(6) Marker card , with 12 pcs. 10-section marker strips, white, self-adhesive, for 120 terminal blocks			SK 5,08/3,8 (see COMBICON catalog)		
Technical data			see description		
Dimensions			5.08		
Pitch [mm]					
Technical data in accordance with IEC/ DIN VDE					
Insulating material group			I		
Surge voltage category / contamination class			III / 3 III / 2 II / 2		
Rated voltage [V]			250 320 630		
Rated surge voltage [kV]			4 4 4		
Nominal current / cross section [A]/[mm²]			12 / 2.5		
Maximum load current / cross section [A]/[mm²]			12 / 2.5		
Connection capacity					
Solid / stranded / conductor sizes [mm²]/[mm²]/AWG			0.2 - 2.5 / 0.2 - 2.5 / 24 - 12		
Stranded with ferrule without / with plastic sleeve [mm²]			0.25 - 2.5 / 0.25 - 2.5		
Multiple connection (2 conductors with same cross section)					
Stranded with TWIN ferrule with plastic sleeve [mm²]			0.5 - 1		
Stripping length [mm]			10		
Internal cylindrical gauge (IEC 60 947-1)			A 2		
Insulating material			PA		
Inflammability class in acc. with UL 94			V0		

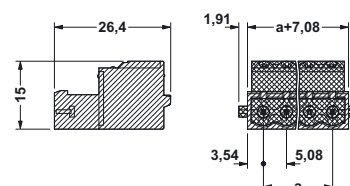

MSTBA 2,5/...-G-5,08-RN 5.08 mm Pitch

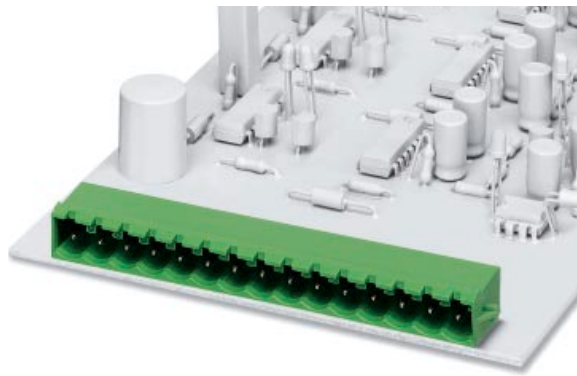

Note:

COMBICON plug connectors may only be actuated in the no-load condition. If smaller loads need to be switched for operational reasons, experimental values are available on request.

Description	No. of pos.	Dim. a [mm]	Type	Order No.	Pcs./Pkt.
Headers with engagement latch, 5.08 mm pitch,	2	5.08	MSTBA 2,5/2-G-5,08-RN	19 26 01 5	50
plug-in direction in parallel to the PCB, color: green,	3	10.16	MSTBA 2,5/3-G-5,08-RN	19 26 02 8	
	4	15.24	MSTBA 2,5/4-G-5,08-RN	19 26 03 1	
	5	20.32	MSTBA 2,5/5-G-5,08-RN	19 26 04 4	
	6	25.40	MSTBA 2,5/6-G-5,08-RN	19 26 05 7	
	7	30.48	MSTBA 2,5/7-G-5,08-RN	19 26 06 0	
	8	35.56	MSTBA 2,5/8-G-5,08-RN	19 26 07 3	
	9	40.64	MSTBA 2,5/9-G-5,08-RN	19 26 08 6	
	10	45.72	MSTBA 2,5/10-G-5,08-RN	19 26 09 9	
	11	50.80	MSTBA 2,5/11-G-5,08-RN	19 26 10 9	
	12	55.88	MSTBA 2,5/12-G-5,08-RN	19 26 11 2	
	13	60.96	MSTBA 2,5/13-G-5,08-RN	19 26 12 5	
	14	66.04	MSTBA 2,5/14-G-5,08-RN	19 26 13 8	
	15	71.12	MSTBA 2,5/15-G-5,08-RN	19 26 14 1	
	16	76.20	MSTBA 2,5/16-G-5,08-RN	19 26 15 4	
	17	81.26	MSTBA 2,5/17-G-5,08-RN	19 26 16 7	
	18	86.36	MSTBA 2,5/18-G-5,08-RN	19 26 17 0	

(1) **Coding element**, is inserted into the recess on the header, insulating material: red



(2) **Marker card**, with 12 pcs. 10-section marker strips, white, self-adhesive, for 120 terminal blocks

Technical data

Dimensions	
Pitch	[mm] 5.08
Hole diameter	[mm] 1.4
Pin dimensions	[mm]x[mm] 1x1

Technical data in accordance with IEC/ DIN VDE

Insulating material group	-
Surge voltage category / contamination class	-/- III / 3
Rated voltage	[V] 250
Rated surge voltage	[kV] 4
Nominal current / cross section	[A]/[mm²] 12 / -
Maximum load current / cross section	[A]/[mm²] 12 / -

Insulating material

Inflammability class in acc. with UL 94

CR-MSTB

Order No. 17 34 40 1

Pcs./Pkt. 100

SK 5,08/3,8
(see COMBICON catalog)

see description

5.08

1.4

1x1

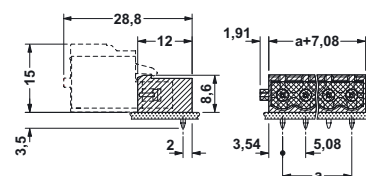
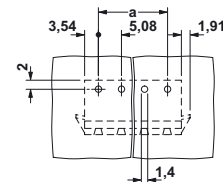

MSTBVA 2,5/...-G-5,08-RN

5.08 mm Pitch

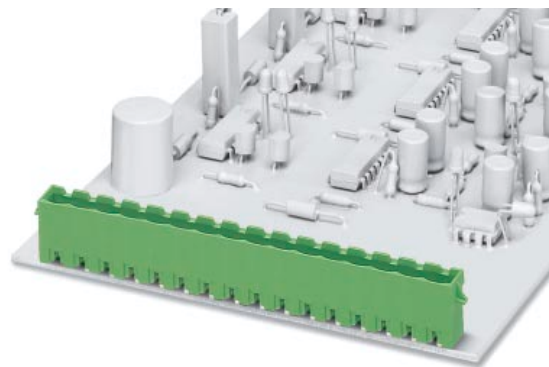

Note:

COMBICON plug connectors may only be actuated in the no-load condition. If smaller loads need to be switched for operational reasons, experimental values are available on request.

Description	No. of pos.	Dim. a [mm]	Type	Order No.	Pcs./Pkt.
Headers with engagement latch, 5.08 mm pitch, plug-in direction vertical to the PCB, color: green,	2	5.08	MSTBVA 2,5/2-G-5,08-RN	19 36 01 8	50
	3	10.16	MSTBVA 2,5/3-G-5,08-RN	19 36 02 1	
	4	15.24	MSTBVA 2,5/4-G-5,08-RN	19 36 03 4	
	5	20.32	MSTBVA 2,5/5-G-5,08-RN	19 36 04 7	
	6	25.40	MSTBVA 2,5/6-G-5,08-RN	19 36 05 0	
	7	30.48	MSTBVA 2,5/7-G-5,08-RN	19 36 06 3	
	8	35.56	MSTBVA 2,5/8-G-5,08-RN	19 36 07 6	
	9	40.64	MSTBVA 2,5/9-G-5,08-RN	19 36 08 9	
	10	45.72	MSTBVA 2,5/10-G-5,08-RN	19 36 09 2	
	11	50.80	MSTBVA 2,5/11-G-5,08-RN	19 36 10 2	
	12	55.88	MSTBVA 2,5/12-G-5,08-RN	19 36 11 5	
	13	60.96	MSTBVA 2,5/13-G-5,08-RN	19 36 12 8	
	14	66.04	MSTBVA 2,5/14-G-5,08-RN	19 36 13 1	
	15	71.12	MSTBVA 2,5/15-G-5,08-RN	19 36 14 4	
	16	76.20	MSTBVA 2,5/16-G-5,08-RN	19 36 15 7	
	17	81.26	MSTBVA 2,5/17-G-5,08-RN	19 36 16 0	
	18	86.36	MSTBVA 2,5/18-G-5,08-RN	19 36 17 3	

(1) **Coding element**, is inserted into the recess on the header, insulating material: red



(2) **Marker card**, with 12 pcs. 10-section marker strips, white, self-adhesive, for 120 terminal blocks

Technical data

Dimensions	
Pitch	[mm] 5.08
Hole diameter	[mm] 1.4
Pin dimensions	[mm]x[mm] 1x1

Technical data in accordance with IEC/ DIN VDE

Insulating material group	-
Surge voltage category / contamination class	-/-
Rated voltage	[V] 250
Rated surge voltage	[kV] 4
Nominal current / cross section	[A]/[mm ²] 12 / -
Maximum load current / cross section	[A]/[mm ²] 12 / -

Insulating material

Inflammability class in acc. with UL 94

CR-MSTB	17 34 40 1	100
SK 5,08/3,8 (see COMBICON catalog)		

see description		
III / 3	IIIa / 2	II / 2
250	320	400
4	4	4
	12 / -	12 / -
	PBT	V0

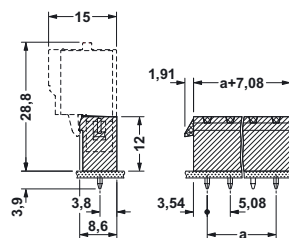
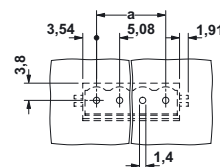

© Phoenix Contact 15.03.02 TNR: 5124499-01 http://www.phoenixcontact.com

单击下面可查看定价，库存，交付和生命周期等信息

[>>Phoenix Contact\(菲尼克斯\)](#)