

# Vehicle charging inlet - EV-T2HBIE24-3ACDC-32A250A2,0M2



1211216

<https://www.phoenixcontact.com/in/products/1211216>

Please be informed that the data shown in this PDF document is generated from our Online Catalog. Please find the complete data in the user documentation. Our General Terms of Use for Downloads are valid.



## Product Description

Vehicle charging inlet for charging with alternating current (AC) and direct current (DC), compatible with type 2 AC and CCS vehicle charging connectors (EVSE), for installation in electric vehicles for electromobility (EV).

## Your advantages

- Uniform, space-saving dimensions for the installation space and the screw connection points of all Phoenix Contact Vehicle Inlets
- Silver-plated surface of the power and signal contacts
- Developed and produced in accordance with the IATF 16949 automotive standard and ISO 9001
- Material data available in the IMDS (International Material Data System of the automotive industry)
- Tested in accordance with selected tests of automotive standards LV124, LV214, LV215-2
- Manual emergency release of the locking actuator
- Integrated interlock during charging
- Integrated temperature sensors for monitoring the temperature at the power contacts

# Vehicle charging inlet - EV-T2HBIE24-3ACDC-32A250A2,0M2



1211216

<https://www.phoenixcontact.com/in/products/1211216>

## Commercial Data

Order Key	1211216
Packing unit	1 pc
Minimum order quantity	1 pc
Note	Made to Order (non-returnable)
Product Key	XWBAID
GTIN	4063151284503
Weight per Piece (including packing)	7,570 g
Weight per Piece (excluding packing)	7,570 g
Customs tariff number	85444290
Country of origin	DE

# Vehicle charging inlet - EV-T2HBIE24-3ACDC-32A250A2,0M2



1211216

<https://www.phoenixcontact.com/in/products/1211216>

## Technical Data

### Notes

General	A protective cap is supplied as standard for the DC and AC contacts.
---------	--

### Product properties

Application	for charging with alternating current (AC) and with direct current (DC) for installation in electric vehicles (EV) Combined Charging System
Type	Locking actuator right
Locking type	Locking in the inserted state with a locking mechanism
Insertion force	< 100 N
Charging standard	CCS type 2
Charging mode	Mode 2, 3, 4

### Electrical properties

Number of phases	3
Type of signal transmission	Pulse width modulation with modulated Powerline communication according to ISO/IEC 15118 / DIN SPEC 70121
Type of charging current	DC, AC 3-phase
Note on the connection method	Crimp connection, cannot be disconnected
Insulation resistance	> 200 M $\Omega$
Coding	4.7 k $\Omega$ (between PE and PP)
Maximum capacity	250 kW
Temperature measurement	DC contacts: 2x PT1000 (DIN EN 60751)
Temperature monitoring	AC contacts: PTC chain (DIN EN 60738-1)

### Power contact

Number	7 (L1, L2, L3, N, PE, DC+, DC-)
Rated voltage	480 V AC 1000 V DC
Rated current	32 A AC 250 A DC

### Signal contact

Number	2 (CP, PP)
Rated voltage	30 V AC
Rated current	2 A

### Temperature sensors

Sensor type	PTC chain
Standards/regulations	DIN EN 60738-1
Recommended measured current	$\leq 1$ mA ( $U_{\max} = 16$ V DC)
Tolerance at the sensor with the recommended measured	$\pm 5$ K

# Vehicle charging inlet - EV-T2HBIE24-3ACDC-32A250A2,0M2



1211216

<https://www.phoenixcontact.com/in/products/1211216>

current	
Temperature range	-40 °C ... 130 °C
Locking actuator	
Number of positions of the connectors	4
Operating voltage	24 V (Typical power supply at the motor)
Possible power supply range at the motor	22 V ... 26 V
Maximum voltage for locking detection	30 V
Typical motor current for locking	0.05 A
Reverse current of the motor	max. 0.5 A
Max. dwell time with reverse current	1 s
Recommended adaptation time	600 ms
Pause time after entry or exit path	3 s
Service life insertion cycles	> 10000 load cycles
Ambient temperature (operation)	-30 °C ... 50 °C
Cable length	0.5 m
Cable structure	4 x 0.5 mm <sup>2</sup>
Lock recognition	available
Mechanical emergency release	available

## Dimensions

Dimensional drawing	
Width	111 mm
Height	130.4 mm
Depth	107.4 mm
Bore dimensions	94.8 mm x 82.4 mm, 94.8 mm x 111.0 mm

## Material specifications

Color Housing	black
Flammability rating according to UL 94	V0
Contact surface	Ag
Material	Plastic

## Connector

Insertion/withdrawal cycles	> 10000
-----------------------------	---------

## Cable / line

Fixed cable length	2 m (AC cables)
	2 m (DC cables)
	2 m (PE cable)

# Vehicle charging inlet - EV-T2HBIE24-3ACDC-32A250A2,0M2



1211216

<https://www.phoenixcontact.com/in/products/1211216>

	1 m (Locking actuator cables)
	1 m (Temperature sensors cables)
	1 m (Communications cables)
Cable weight	approx. 450 kg/km

## Cable structure

Cable structure	4 x 6 mm <sup>2</sup>
Outer sheath, material	Silicone
External sheath, color	orange
External cable diameter	14.7 mm ±0.2 mm

## Electrical properties

Conductor resistance	≤ 3.2 Ω/km
----------------------	------------

## Mechanical properties

Smallest bending radius, fixed installation	3 x D
---	-------

## Mechanical properties

### Mechanical data

Insertion force	< 100 N
Withdrawal force	< 100 N

### Design

Design	Generation 4
Customer variations	On request

### Interlock

Locking type	Locking in the inserted state with a locking mechanism
--------------	--

## Environmental and real-life conditions

### Ambient conditions

Degree of protection	IP44 (plugged in; when plugged in and ready to operate, the degree of protection is only ensued if both plug-in components are original products from Phoenix Contact or suitable standard-compliant products) IP55 (Inner area of vehicle charging inlet)
Ambient temperature (operation)	-40 °C ... 60 °C
Ambient temperature (storage/transport)	-40 °C ... 85 °C
Altitude	4000 m (above sea level)

## Standards and regulations

### Standards

Standards/regulations	IEC 62196-3
-----------------------	-------------

## Mounting

Restrictions to mounting position	Only 0 to 90 degree frontal inclination possible, see figure
-----------------------------------	--

# Vehicle charging inlet - EV-T2HBIE24-3ACDC-32A250A2,0M2



1211216

<https://www.phoenixcontact.com/in/products/1211216>

Mounting hole diameter	6.80 mm (ø)
Fixing screws	M6
Screws included in the scope of delivery	none
Position of the locking actuator	Right-side

# Vehicle charging inlet - EV-T2HBIE24-3ACDC-32A250A2,0M2



1211216

<https://www.phoenixcontact.com/in/products/1211216>

## Drawings

Dimensional drawing

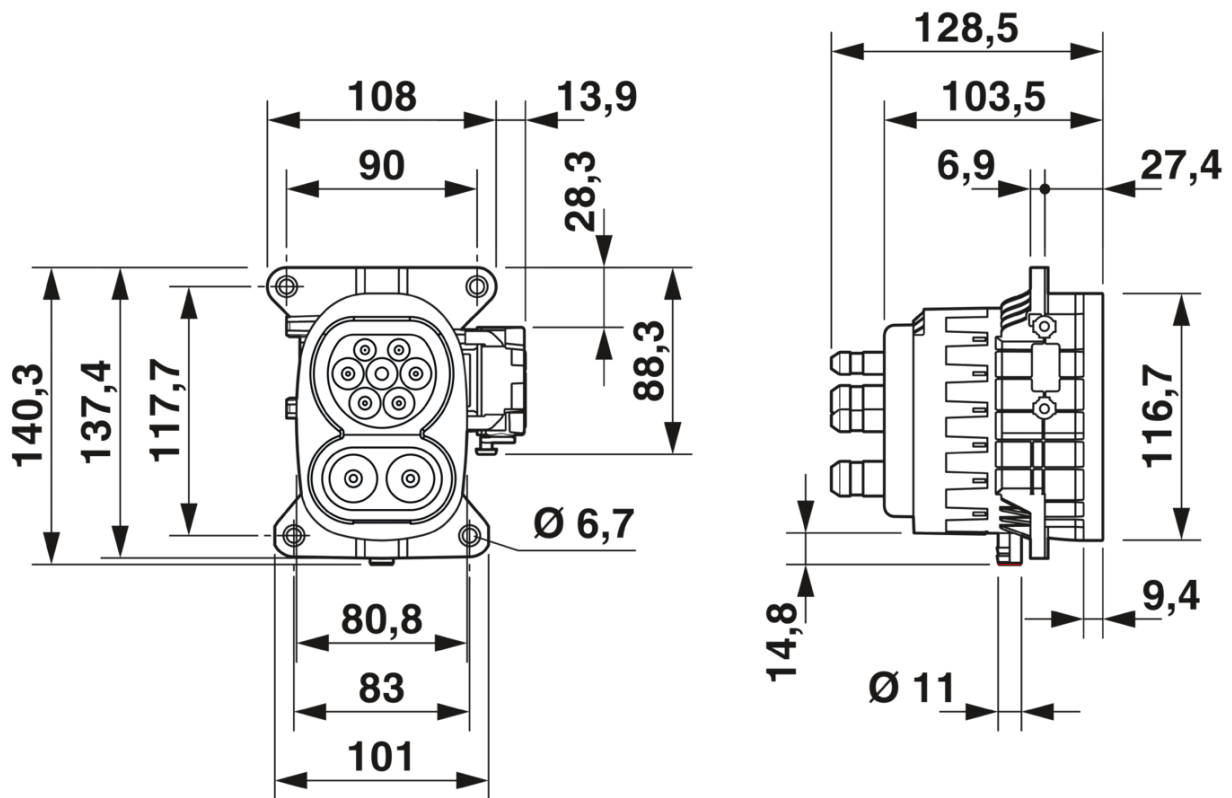

Dimensional drawing

Schematic diagram

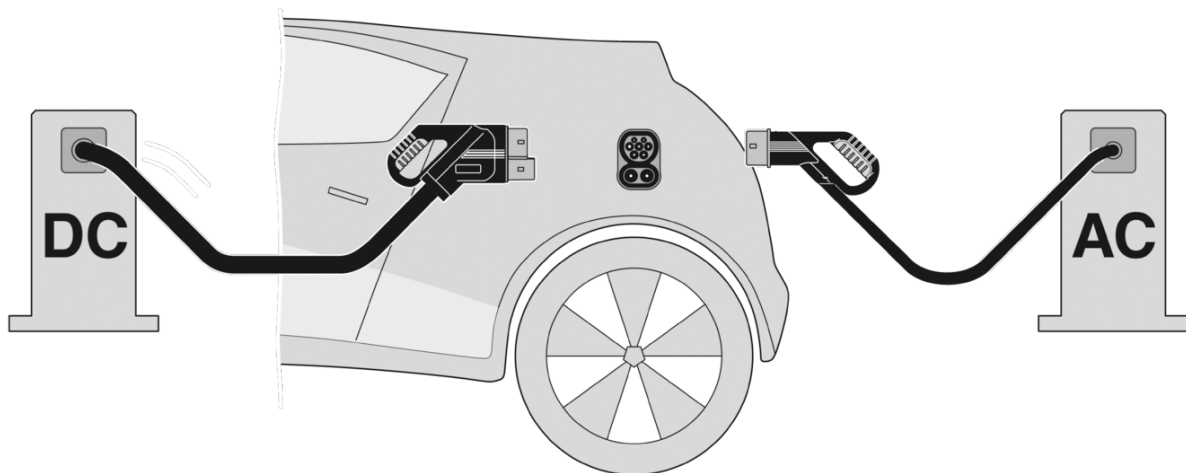

The Combined Charging System (CCS) principle - standard-compliant charging system for electric vehicles, which supports both conventional AC charging and fast DC charging. Both Vehicle Connectors fit into the CCS Vehicle Inlet.

# Vehicle charging inlet - EV-T2HBIE24-3ACDC-32A250A2,0M2

1211216

<https://www.phoenixcontact.com/in/products/1211216>

Block diagram

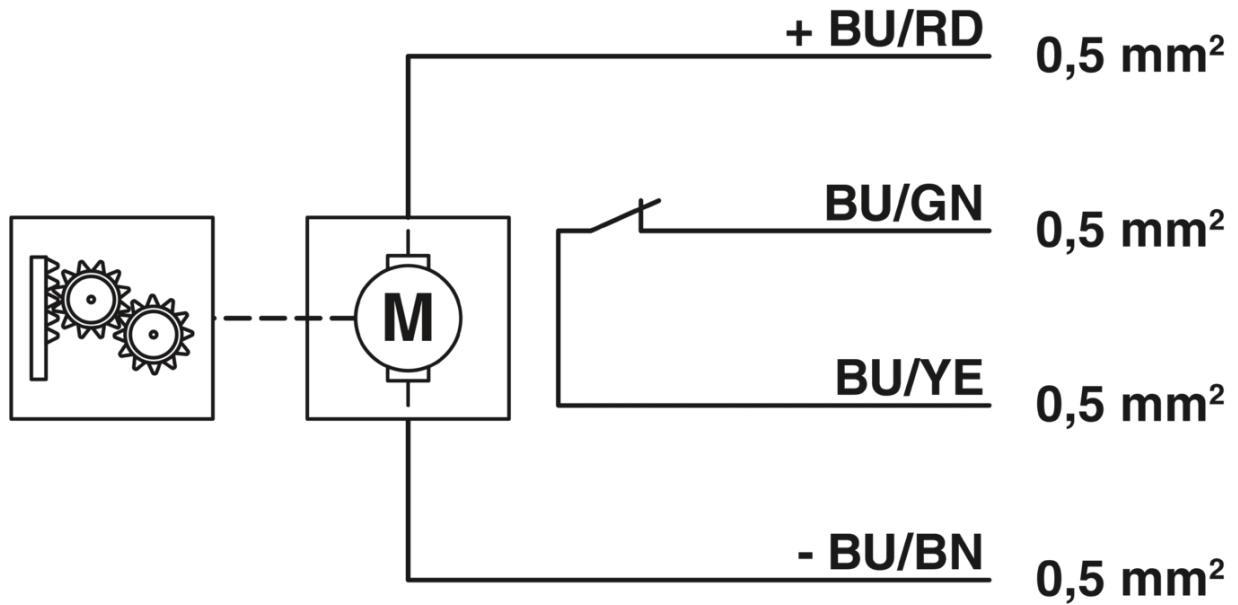

Block diagram of the locking actuator

Connection diagram

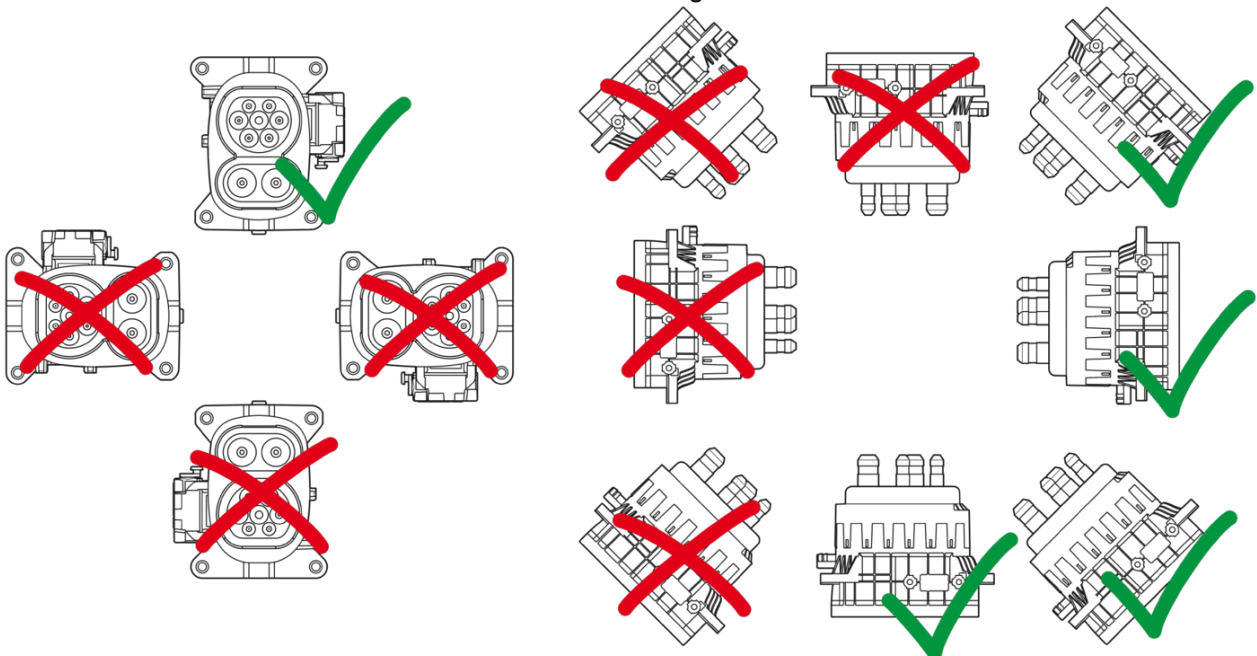

Installation positions



# Vehicle charging inlet - EV-T2HBIE24-3ACDC-32A250A2,0M2

1211216

<https://www.phoenixcontact.com/in/products/1211216>

Connection diagram

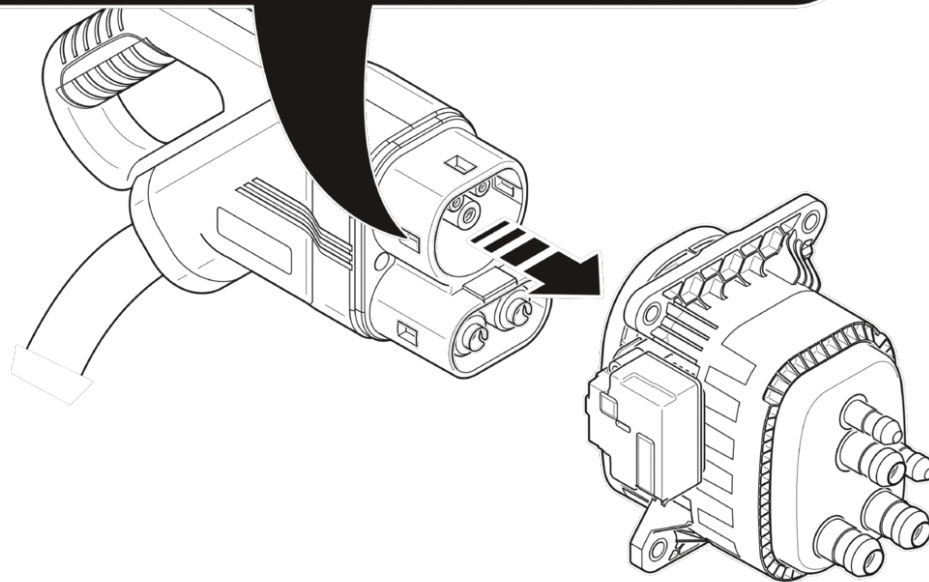
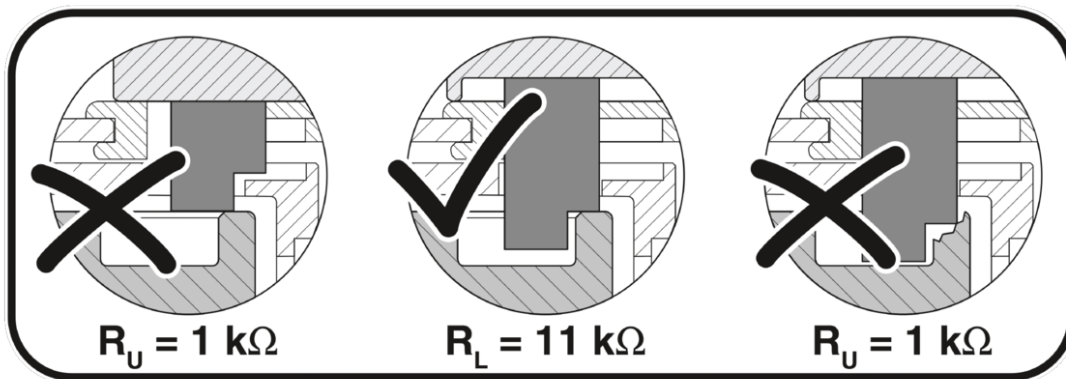
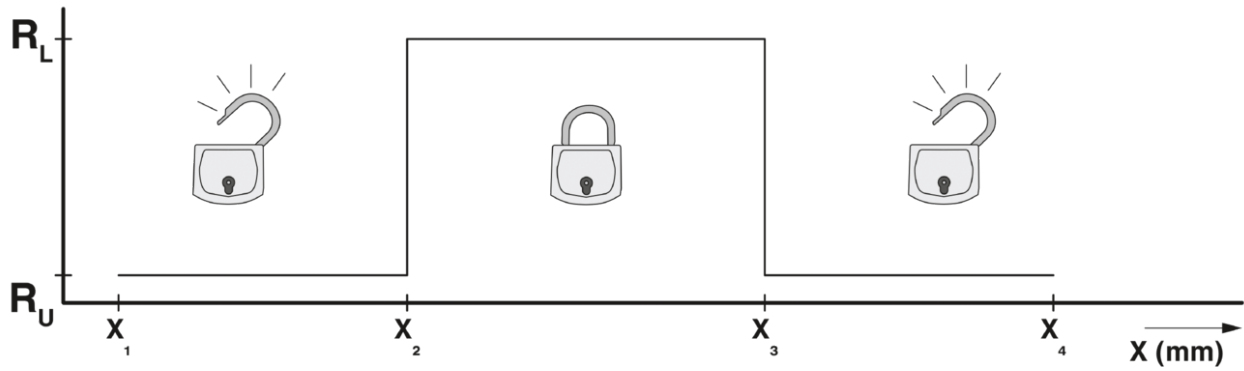

Detection for Vehicle Connector

# Vehicle charging inlet - EV-T2HBIE24-3ACDC-32A250A2,0M2

1211216

<https://www.phoenixcontact.com/in/products/1211216>

Connection diagram

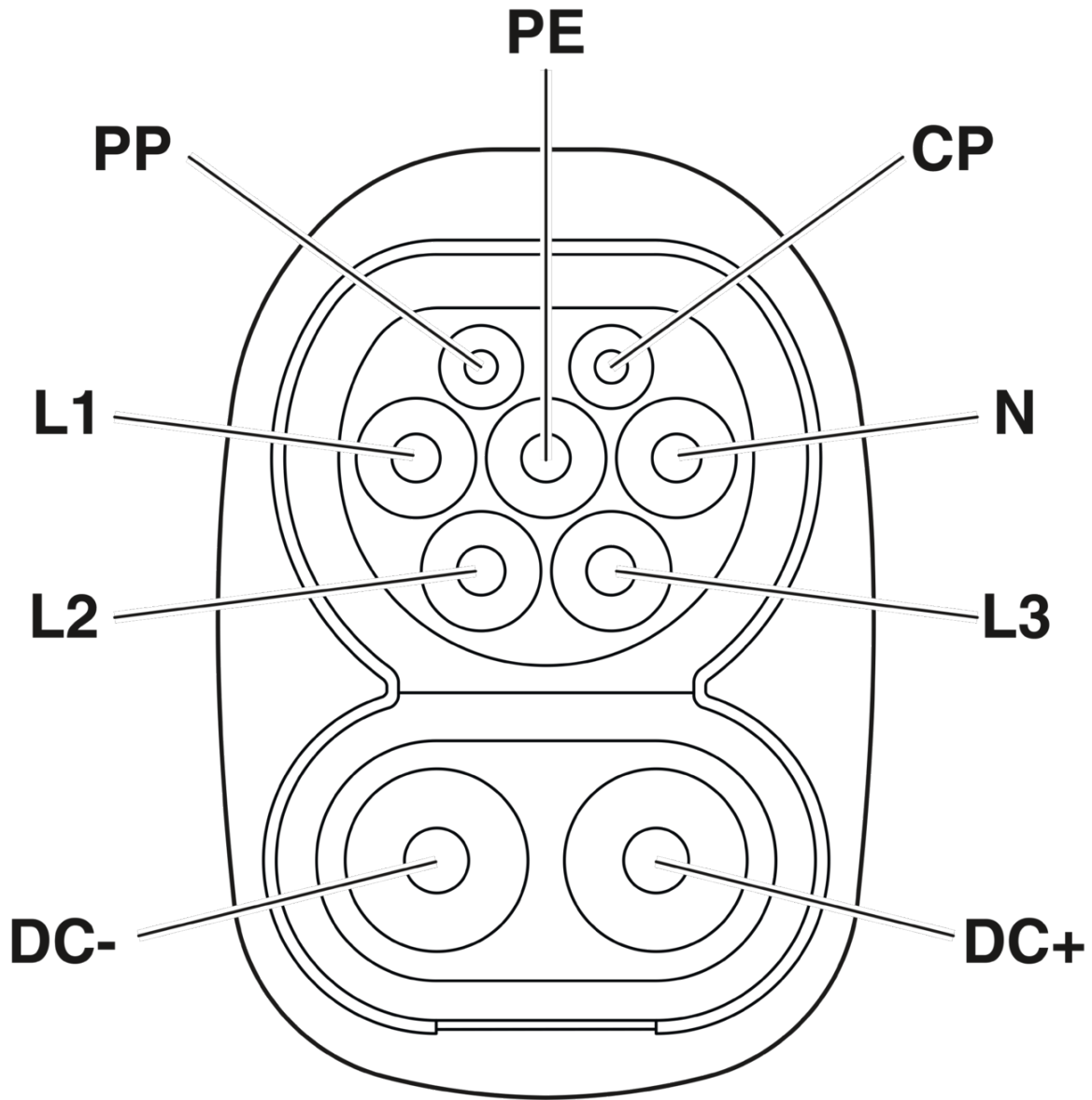

Pin assignment of Vehicle Inlet

# Vehicle charging inlet - EV-T2HBIE24-3ACDC-32A250A2,0M2

1211216

<https://www.phoenixcontact.com/in/products/1211216>

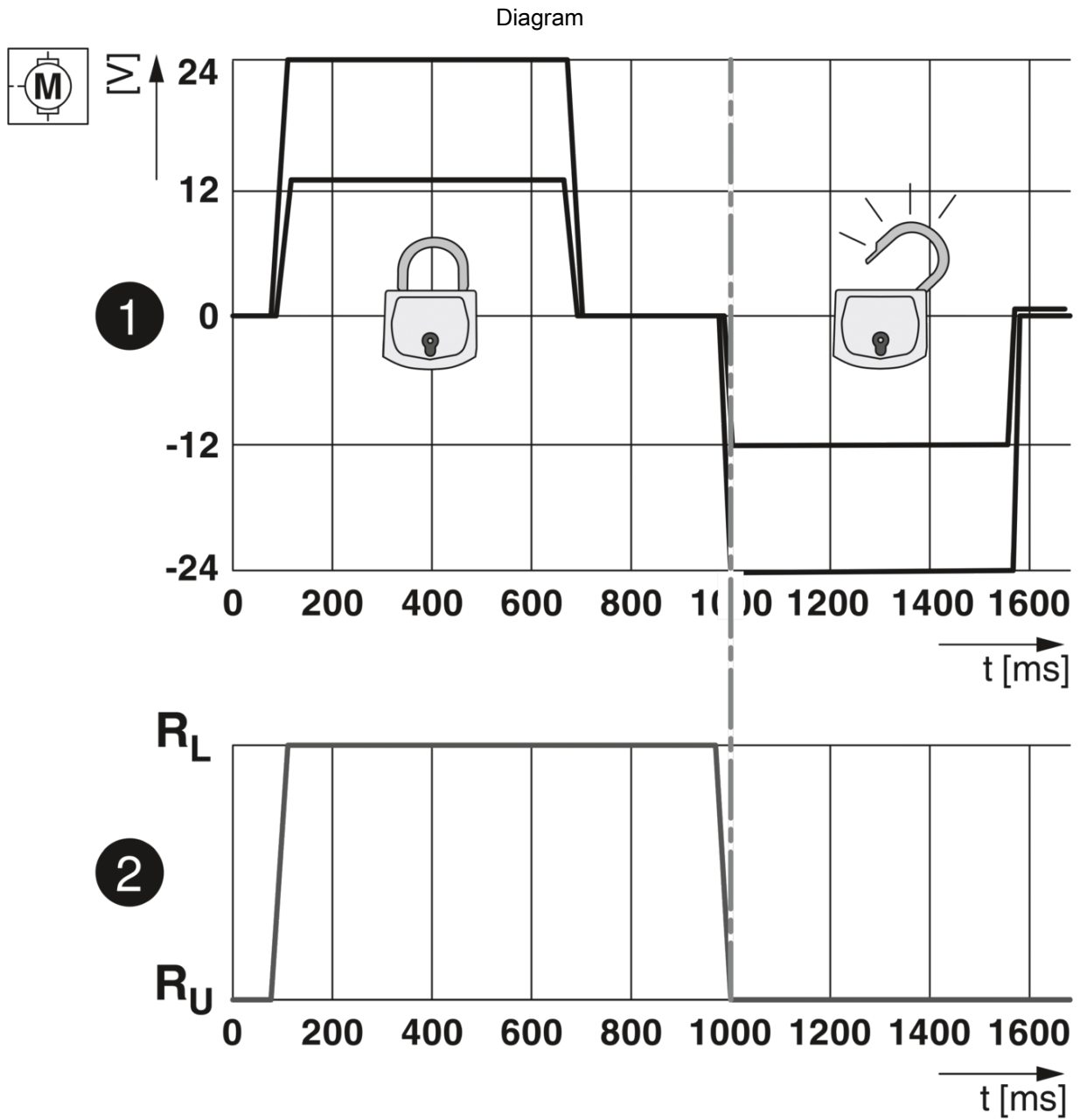

Locking states of the locking actuator

# Vehicle charging inlet - EV-T2HBIE24-3ACDC-32A250A2,0M2

1211216

<https://www.phoenixcontact.com/in/products/1211216>

Schematic diagram

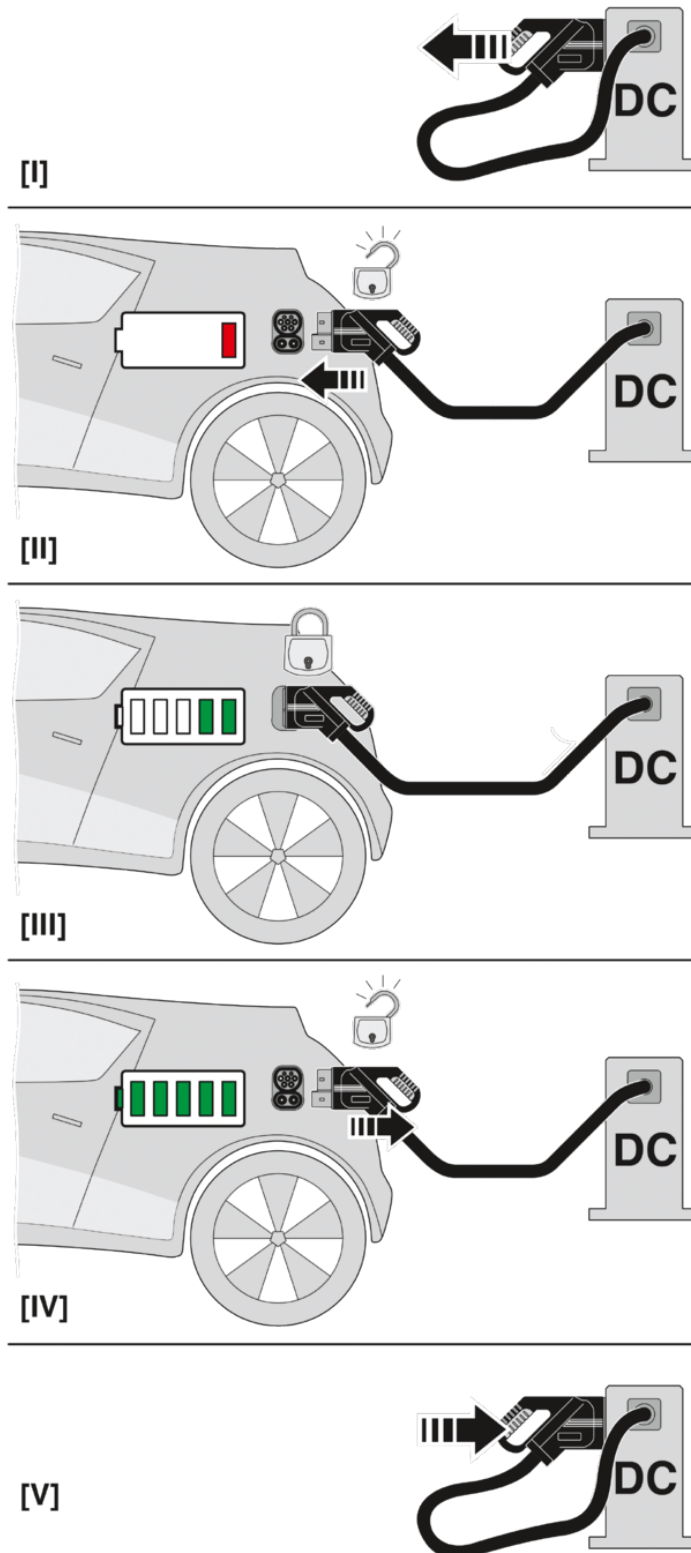

Operating instructions

1211216

<https://www.phoenixcontact.com/in/products/1211216>

Diagram

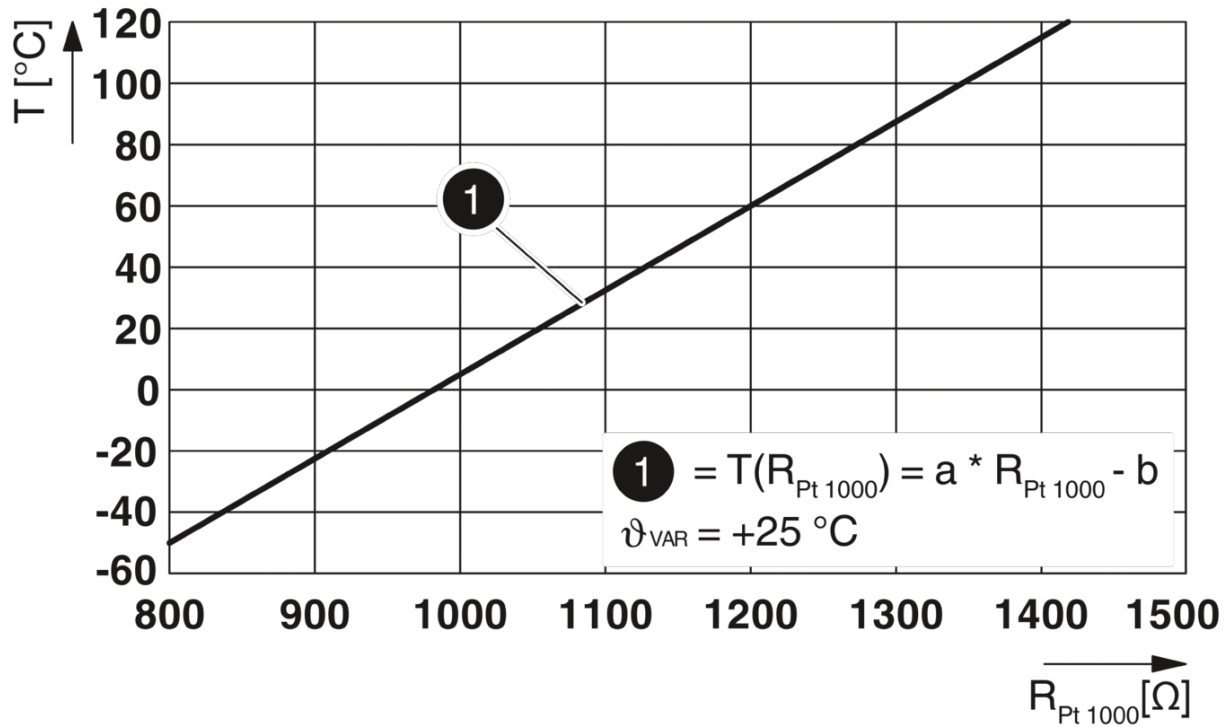

Pt 1000 characteristic curve at an ambient temperature of 25°C for temperature measurement at the DC contacts

Schematic diagram

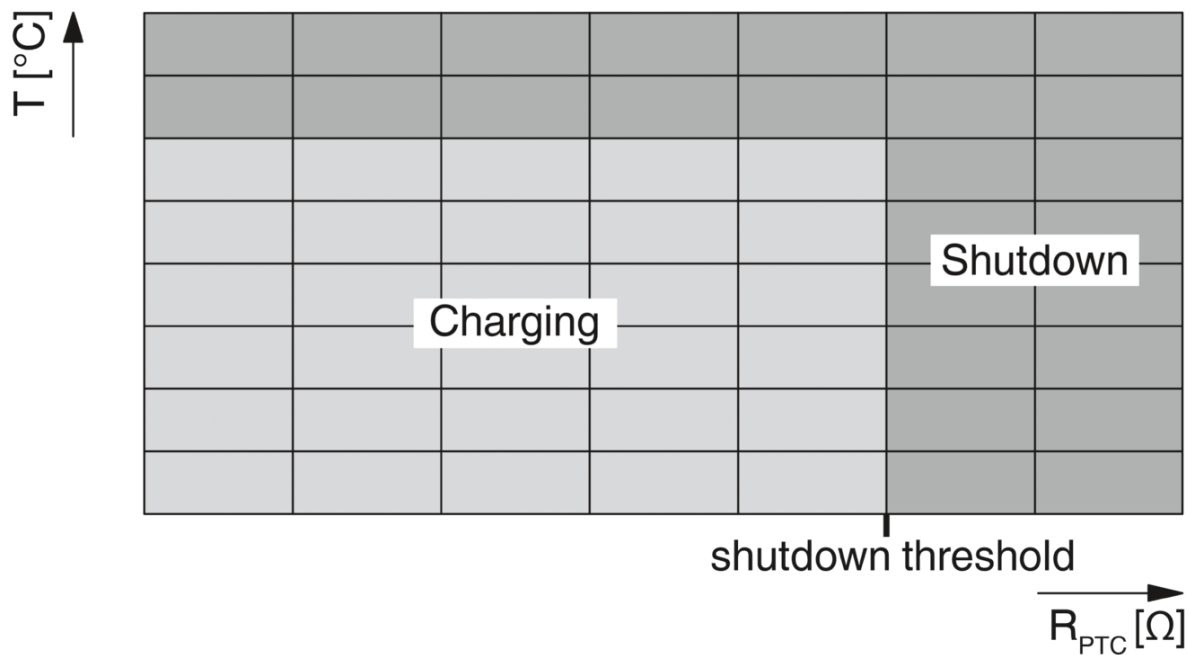

Temperature sensor technology resistance range at AC contacts

# Vehicle charging inlet - EV-T2HBIE24-3ACDC-32A250A2,0M2



1211216

<https://www.phoenixcontact.com/in/products/1211216>

## Classifications

### ECLASS

ECLASS-9.0

27144706

Phoenix Contact 2022 © - all rights reserved

<https://www.phoenixcontact.com>

PHOENIX CONTACT (I) Pvt. Ltd.

A-58/2, Okhla Industrial Area, Phase - II, New Delhi-110 020

+91.1275.71420

[info@phoenixcontact.co.in](mailto:info@phoenixcontact.co.in)

单击下面可查看定价，库存，交付和生命周期等信息

[>>Phoenix Contact\(菲尼克斯\)](#)