

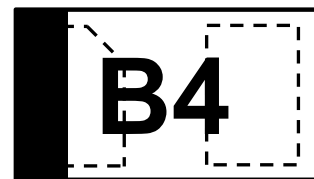

Features

- Low forward Voltage
- Fast switching

DFN1x0.6-2L



Marking Code: B4

Absolute Maximum Ratings ($T_A=25^{\circ}\text{C}$)

Parameter	Symbols	Value	Unit
Repetitive Peak Reverse Voltage	V_{RRM}	40	V
Average Rectified Forward Current	$I_{F(AV)}$	200	mA
Non-Repetitive Peak Forward Surge Current at 8.3ms	I_{FSM}	250	mA
Power Dissipation	P_D	120	mW
Thermal Resistance Junction to Ambient Air	$R_{\theta JA}$	833	$^{\circ}\text{C/W}$
Junction Temperature	T_J	125	$^{\circ}\text{C}$
Storage Temperature Range	T_{STG}	-55 to +125	$^{\circ}\text{C}$

Electrical Characteristics ($T_A=25^{\circ}\text{C}$)

Parameter	Symbols	Min.	Max.	Unit
Forward Voltage at $I_F = 1\text{ mA}$ at $I_F = 40\text{ mA}$	V_F	--	0.38 1	V
Reverse Current at $V_R = 30\text{ V}$	I_R	--	0.2	μA
Breakdown Voltage at $I_R = 10\ \mu\text{A}$	$V_{R(BR)}$	40	--	V
Total Capacitance at $V_R = 0\text{ V}$, $f = 1\text{ MHz}$	C_T	--	5	pF
Reverse Recovery Time at $I_F = I_R = 5\text{ mA}$, $I_{rr} = 0.1 \times I_R$, $R_L = 100\ \Omega$	T_{rr}	--	5	ns



Typical Characteristic Curves

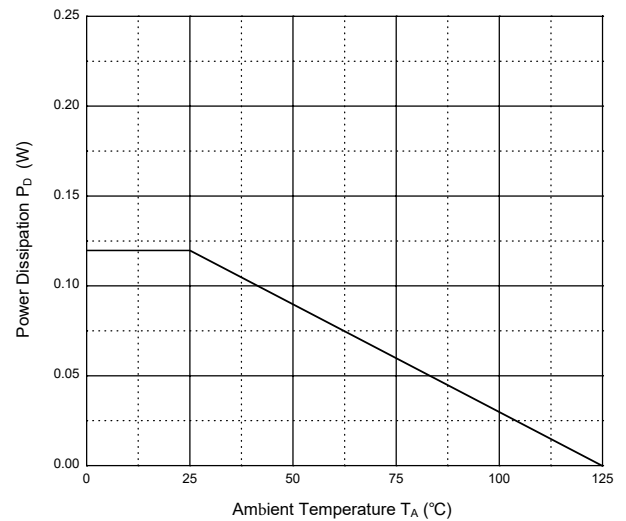
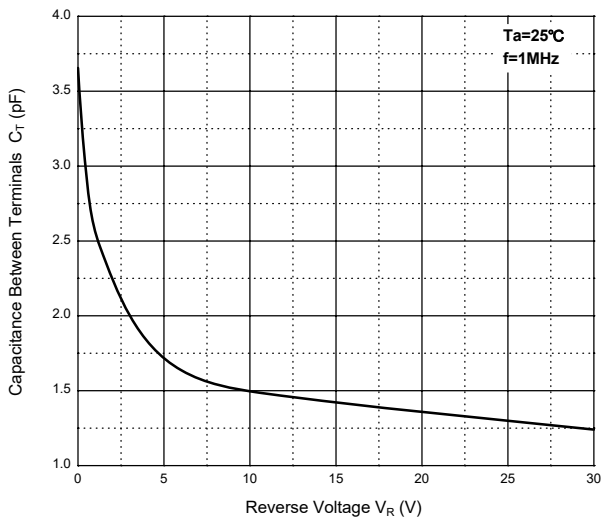
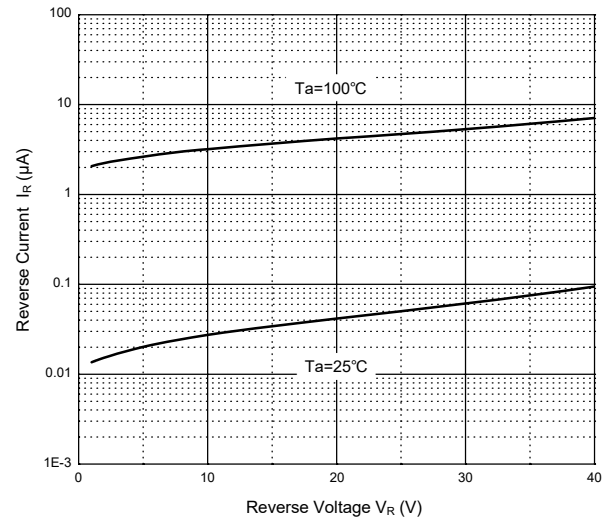
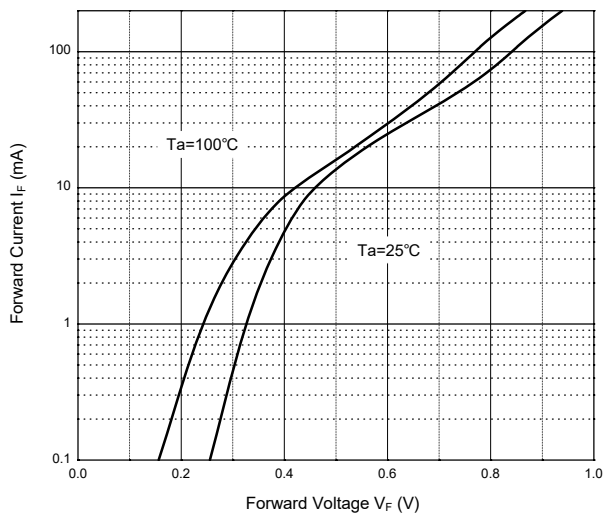



Package Outline

DFN1x0.6-2L-0011

Dimensions in mm

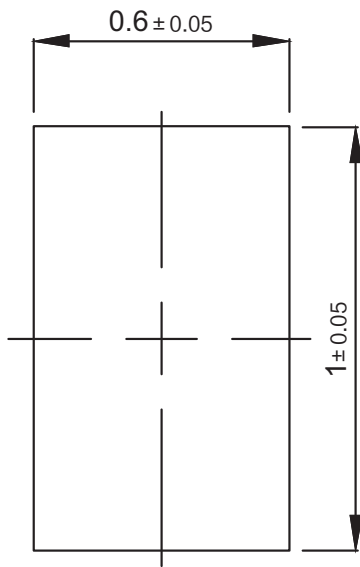

TOP VIEW

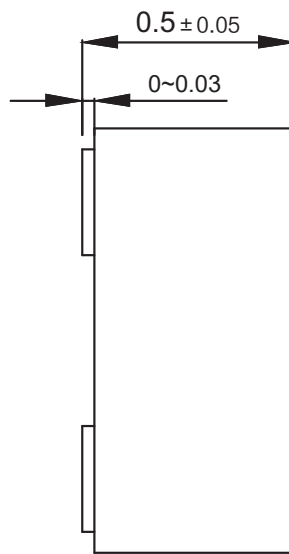

SIDE VIEW

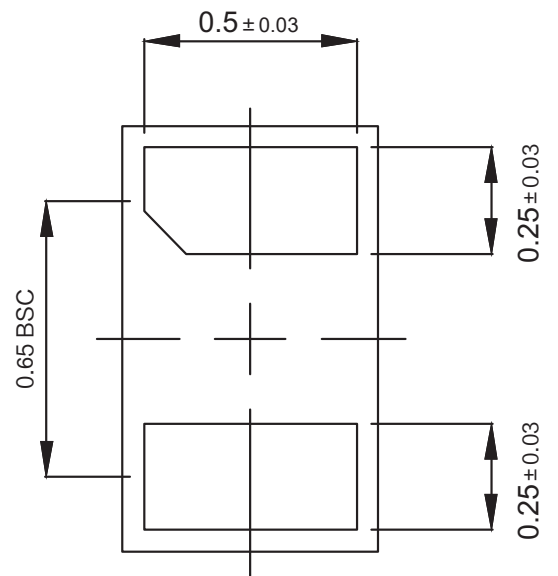

BOTTOM VIEW

Ordering Information

Device	Package	Shipping
BAS40DB	DFN1x0.6-2L	10,000PCS/Reel&7inches

单击下面可查看定价，库存，交付和生命周期等信息

[>>PJSEMI\(平晶微\)](#)