

CX2024NL

- Balun Transformer, 1:1
- IMPEDANCE = 75 OHMS
- 50-1000MHz
- Surface Mount

NOTES: UNLESS OTHERWISE SPECIFIED

1. OPERATING TEMPERATURE: -40°C TO +85°C
2. STORAGE TEMPERATURE: -50°C TO +125°C
3. JEDEC MOISTURE: LEVEL 1.
4. DIMENSIONS ARE IN INCHES WITH THE FOLLOWING TOLERANCE:
.XX= ±.01
.XXX= ±.005
5. OPTIONAL TAPE & REEL PACKAGING CAN BE ORDERED
BY ADDING A "T" SUFFIX TO THE PART NUMBER(EX: CX2024NLT)
6. ROHS COMPLIANT



ELECTRICAL SPECIFICATIONS: @ 25°C

INSERTION LOSS:

| FREQUENCY | ATTENUATION |
|-----------|-------------|
| 10 MHz | -1.0 dB MAX |
| 50 MHz | -0.5 dB MAX |
| 150 MHz | -0.5 dB MAX |
| 300 MHz | -0.5 dB MAX |
| 450 MHz | -0.5 dB MAX |

| FREQUENCY | ATTENUATION |
|-----------|-------------|
| 600 MHz | -0.5 dB MAX |
| 750 MHz | -0.5 dB MAX |
| 1000 MHz | -0.6 dB MAX |

RETURN LOSS:

| FREQUENCY | ATTENUATION |
|-----------|--------------|
| 10 MHz | -20.0 dB MIN |
| 50 MHz | -20.0 dB MIN |
| 150 MHz | -20.0 dB MIN |
| 300 MHz | -20.0 dB MIN |
| 450 MHz | -20.0 dB MIN |

| FREQUENCY | ATTENUATION |
|-----------|--------------|
| 600 MHz | -20.0 dB MIN |
| 750 MHz | -20.0 dB MIN |
| 1000 MHz | -16.0 dB MIN |

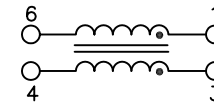

SCHEMATIC

© Copyright, 2014. Pulse Electronics Corp. All rights reserved. Drawing specifications subject to change without notice. (03/13/14)

PULSE CONFIDENTIAL
&
PROPRIETARY

PRODUCT SPECIFICATION:
XFMR, RF, 1:1, 50-1000MHz

| DWG. NO./ PART NO. | SHEET: | REV. |
|--------------------|--------|------|
| CX2024NL | 1 | M11 |

MECHANICAL SPECIFICATIONS:

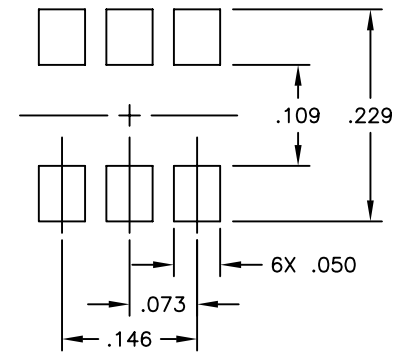
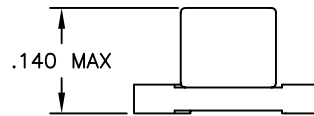
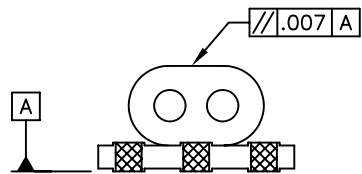
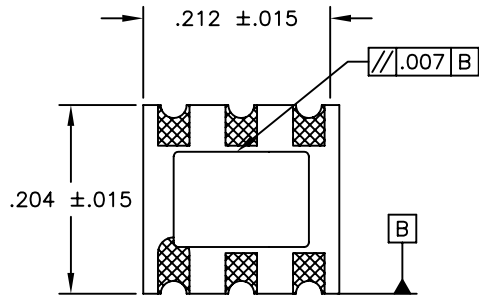

SUGGESTED LAND PATTERN

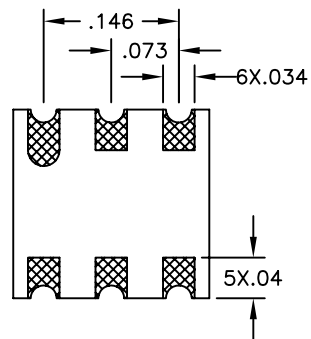

© Copyright, 2014. Pulse Electronics Corp. All rights reserved. Drawing specifications subject to change without notice. (03/13/14)

PULSE CONFIDENTIAL
 &
 PROPRIETARY

PRODUCT SPECIFICATION:
 XFMR, RF, 1:1, 50-1000MHz

| DWG. NO./ PART NO. | SHEET: | REV. |
|--------------------|--------|------|
| CX2024NL | 2 | M11 |

单击下面可查看定价，库存，交付和生命周期等信息

[>>Pulse\(普思\)](#)