

**Description:** 25x25x4mm GPS/Glonass Pin Mount

**Series:** Ceramic Patch

**PART NUMBER:** W3223



**Features:**

- 1575/1602MHz Dualband single feed antenna
- RHCP Polarization
- Zenith Gain +4dBiC
- Pin mounting
- Tray packing
- Moisture sensitivity level:MSL1

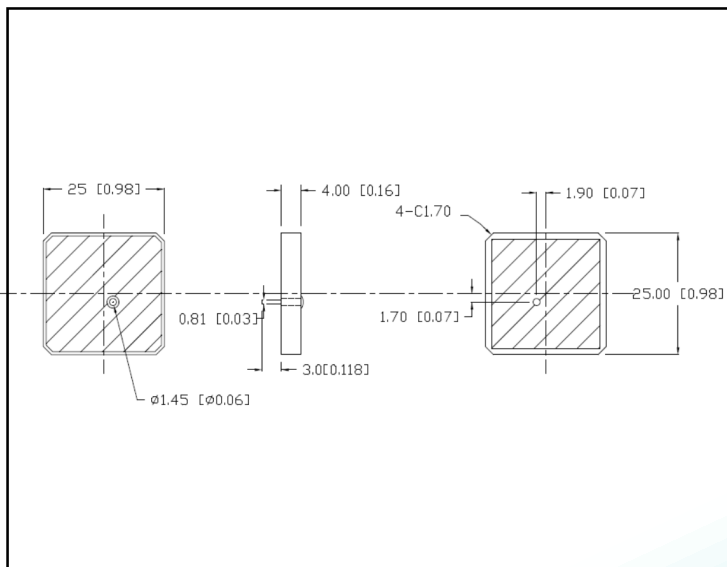

**Applications:**

- GPS and Glonass satellite receivers
- Tracking, Navigation, Satellite Positioning
- Fleet management
- Asset tracking

All dimensions are in mm / inches

Issue: 1910

In the effort to improve our products, we reserve the right to make changes judged to be necessary.

CONFIDENTIAL AND PROPRIETARY INFORMATION

This document contains confidential and proprietary information of Pulse Electronics, Inc. (Pulse) and is protected by copyright, trade secret and other state and federal laws. Its receipt or possession does not convey any rights to reproduce, disclose its contents, or to manufacture, use or sell anything it may describe. Reproduction, disclosure or use without specific written authorization of Pulse is strictly forbidden.

For more information:

Pulse Worldwide Headquarters  
12220 World Trade Drive  
San Diego, CA 92128  
USA  
Tel:1-858-674-8100

Pulse/Larsen Antennas  
18110 SE 34<sup>th</sup> St Bldg 2 Suite 250  
Vancouver, WA 98683  
USA  
Tel: 1-360-944-7551

Europe Headquarters  
Pulse GmbH & Do, KG  
Zeppelinstrasse 15  
Herrenberg, Germany

Pulse (Suzhou) Wireless Products Co, Inc.  
99 Huo Ju Road(#29 Bldg,4<sup>th</sup> Phase  
Suzhou New District  
Jiangsu Province, Suzhou 215009 PR China  
Tel: 86 512 6807 9998



**Description:** 25x25x4mm GPS/Glonass Pin Mount

**Series:** Ceramic Patch

**PART NUMBER:** W3223

## ELECTRICAL SPECIFICATIONS

Frequency	1575.42±1.023/1602.5625±4 MHz
Nominal Impedance	50 Ω
Return Loss*	<-10 dB
RHCP Gain (typical)*	4 dBiC
Zenith Axial Ratio(typical)*	3.8
Polarization:	RHCP

\* Measured on 70 x 70 mm reference board

\* Test the antenna on 70mmX70mm metal plane

Issue: 1910

In the effort to improve our products, we reserve the right to make changes judged to be necessary.

CONFIDENTIAL AND PROPRIETARY INFORMATION

This document contains confidential and proprietary information of Pulse Electronics, Inc. (Pulse) and is protected by copyright, trade secret and other state and federal laws. Its receipt or possession does not convey any rights to reproduce, disclose its contents, or to manufacture, use or sell anything it may describe. Reproduction, disclosure or use without specific written authorization of Pulse is strictly forbidden.

Downloaded From [Oneyac.com](http://Oneyac.com)

**Description:** 25x25x4mm GPS/Glonass Pin Mount

**Series:** Ceramic Patch

**PART NUMBER:** W3223

### MECHANICAL SPECIFICATIONS

Material	Ceramic
Metallization	Silver
Size	25 x 24 x 4 mm
Weight	9.3 g
Mounting type	Pin feed

### ENVIRONMENTAL SPECIFICATIONS

Operating temperature	-40/+85 ° C
-----------------------	-------------

**Description:** 25x25x4mm GPS/Glonass Pin Mount

**Series:** Ceramic Patch

**PART NUMBER:** W3223

**MECHANICAL DRAWING**

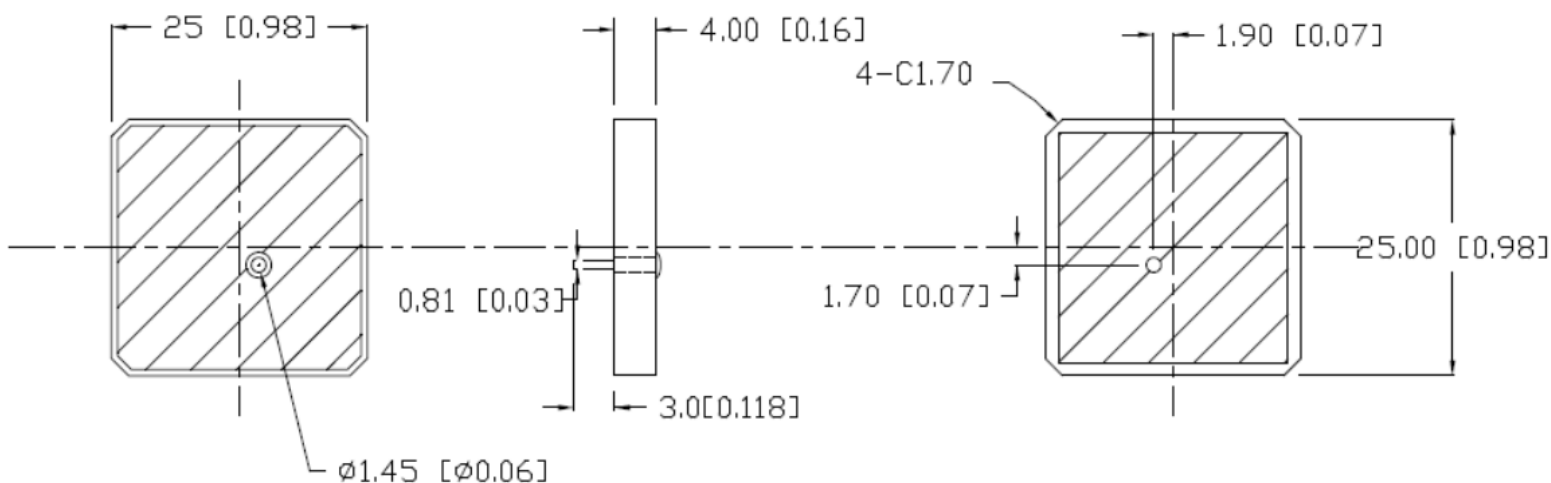

**Adhesive Transfer Tape Specification**

TAPE: Nitto 5000NS 22\*22\*0.16mm

Thickness : 0.16  $\pm$  5% mm

Release Liner : 0.1mm (typ.) printed paper or paper

Dimension : mm

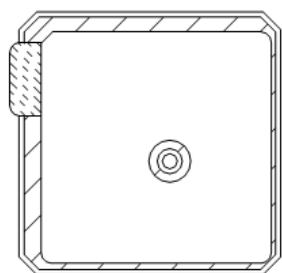

Patch bottom

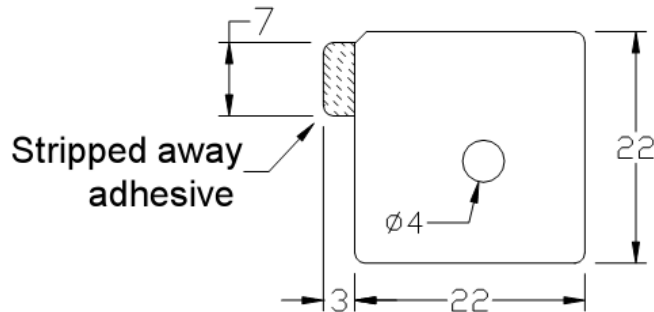

Stripped away adhesive

Tolerance:  $\pm 0.2$ mm

Issue: 1910

In the effort to improve our products, we reserve the right to make changes judged to be necessary.

CONFIDENTIAL AND PROPRIETARY INFORMATION

This document contains confidential and proprietary information of Pulse Electronics, Inc. (Pulse) and is protected by copyright, trade secret and other state and federal laws. Its receipt or possession does not convey any rights to reproduce, disclose its contents, or to manufacture, use or sell anything it may describe. Reproduction, disclosure or use without specific written authorization of Pulse is strictly forbidden.

**Description:** 25x25x4mm GPS/Glonass Pin Mount

**Series:** Ceramic Patch

**PART NUMBER:** W3223

**OTHER SPECIFICATIONS**

**Test Condition Ground Plane (Example for PCB 1 mm)**

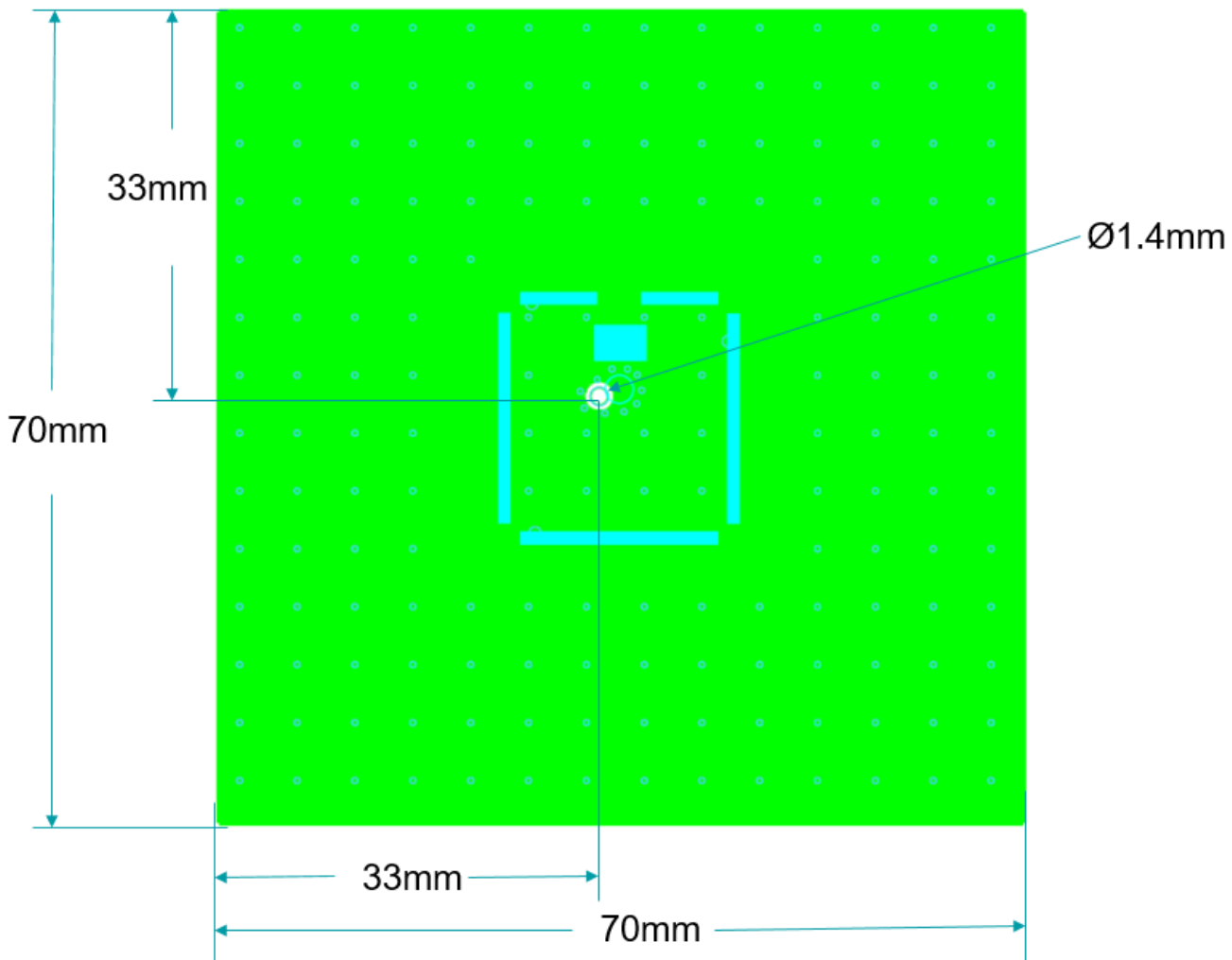

Issue: 1910

In the effort to improve our products, we reserve the right to make changes judged to be necessary.

CONFIDENTIAL AND PROPRIETARY INFORMATION

This document contains confidential and proprietary information of Pulse Electronics, Inc. (Pulse) and is protected by copyright, trade secret and other state and federal laws. Its receipt or possession does not convey any rights to reproduce, disclose its contents, or to manufacture, use or sell anything it may describe. Reproduction, disclosure or use without specific written authorization of Pulse is strictly forbidden.

**Description:** 25x25x4mm GPS/Glonass Pin Mount

**Series:** Ceramic Patch

**PART NUMBER:** W3223

**CHARTS**

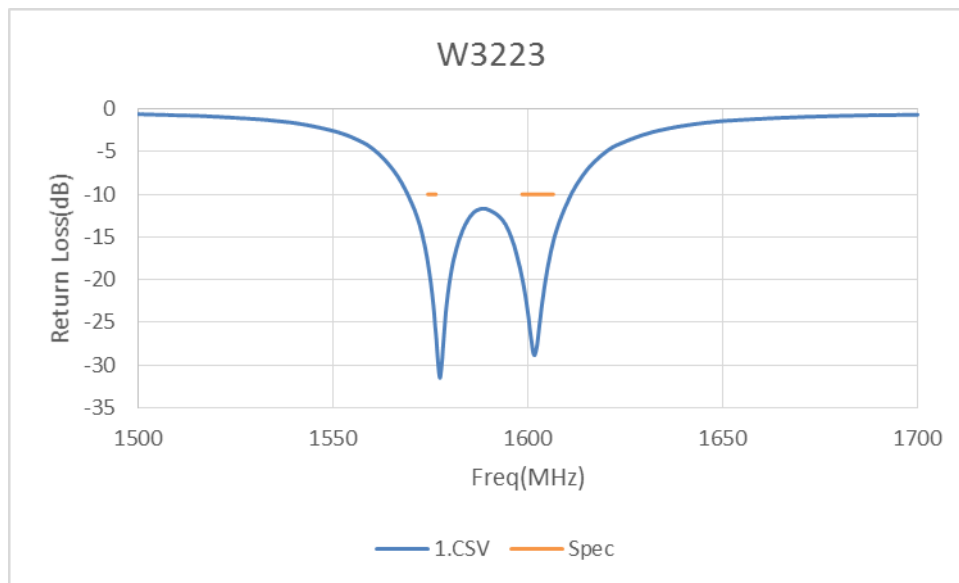

**Return Loss**

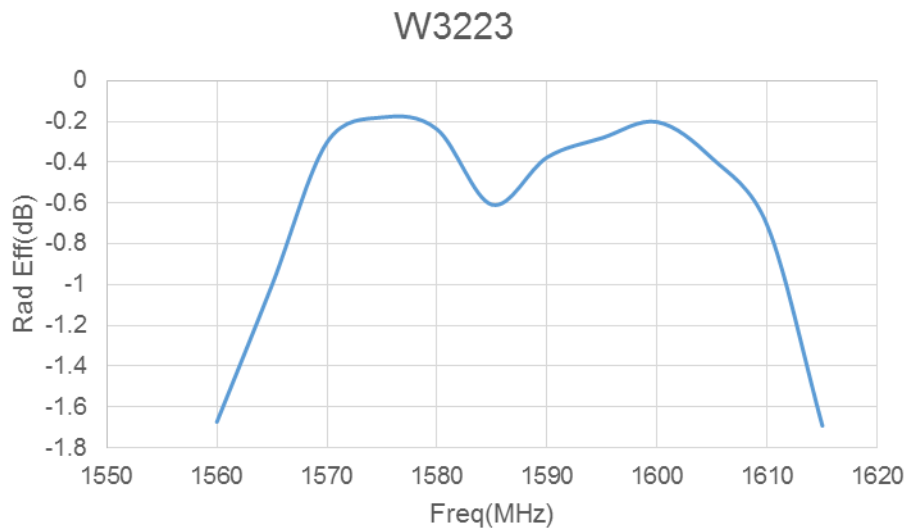

**Total Radiation Efficiency**

Issue: 1910

In the effort to improve our products, we reserve the right to make changes judged to be necessary.

CONFIDENTIAL AND PROPRIETARY INFORMATION

This document contains confidential and proprietary information of Pulse Electronics, Inc. (Pulse) and is protected by copyright, trade secret and other state and federal laws. Its receipt or possession does not convey any rights to reproduce, disclose its contents, or to manufacture, use or sell anything it may describe. Reproduction, disclosure or use without specific written authorization of Pulse is strictly forbidden.

**Description:** 25x25x4mm GPS/Glonass Pin Mount

**Series:** Ceramic Patch

**PART NUMBER:** W3223

**CHARTS**

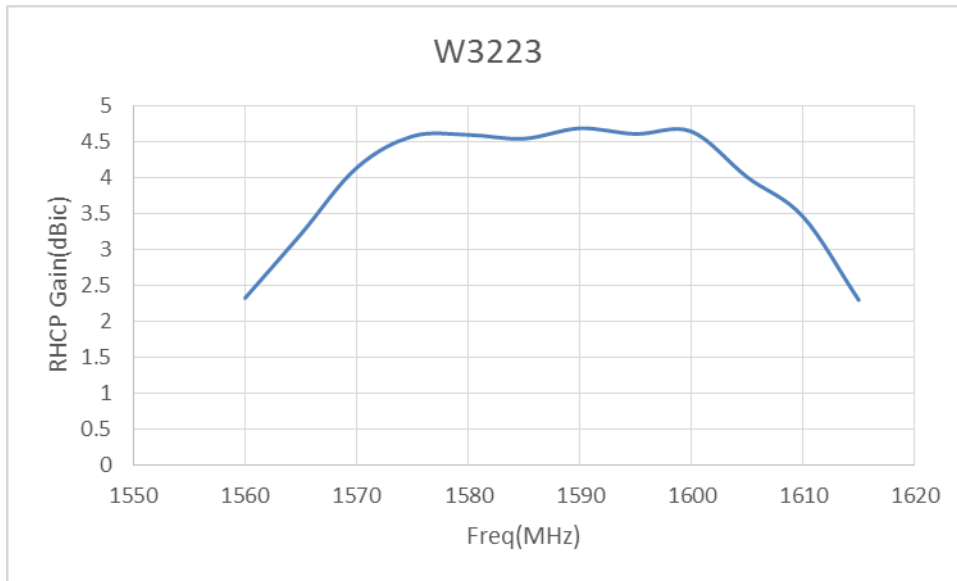

**Zenith RHCP Gain**

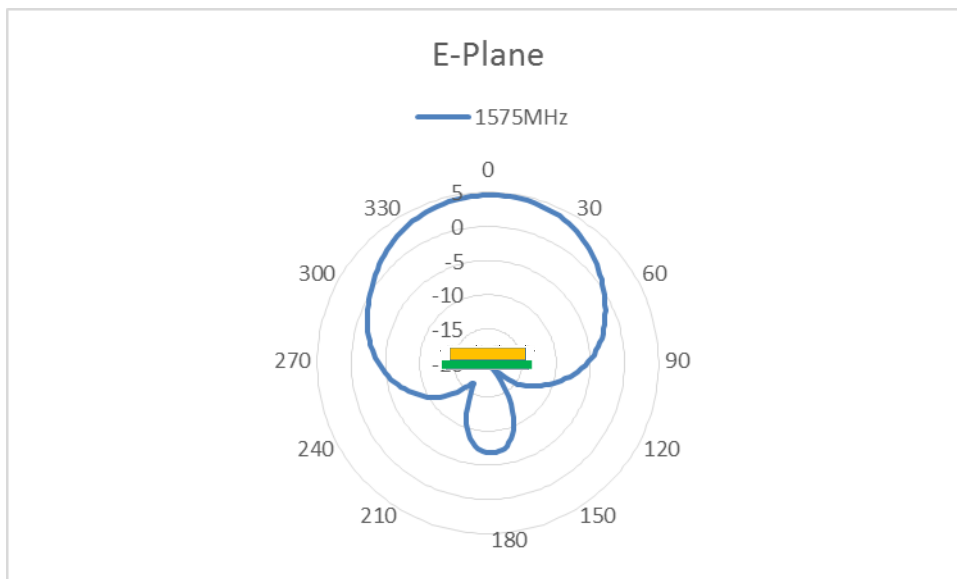

**GPS Radiation pattern on 70mmX70mm metal plane**

Issue: 1910

In the effort to improve our products, we reserve the right to make changes judged to be necessary.

CONFIDENTIAL AND PROPRIETARY INFORMATION

This document contains confidential and proprietary information of Pulse Electronics, Inc. (Pulse) and is protected by copyright, trade secret and other state and federal laws. Its receipt or possession does not convey any rights to reproduce, disclose its contents, or to manufacture, use or sell anything it may describe. Reproduction, disclosure or use without specific written authorization of Pulse is strictly forbidden.

**Description:** 25x25x4mm GPS/Glonass Pin Mount

**Series:** Ceramic Patch

**PART NUMBER:** W3223

**CHARTS**

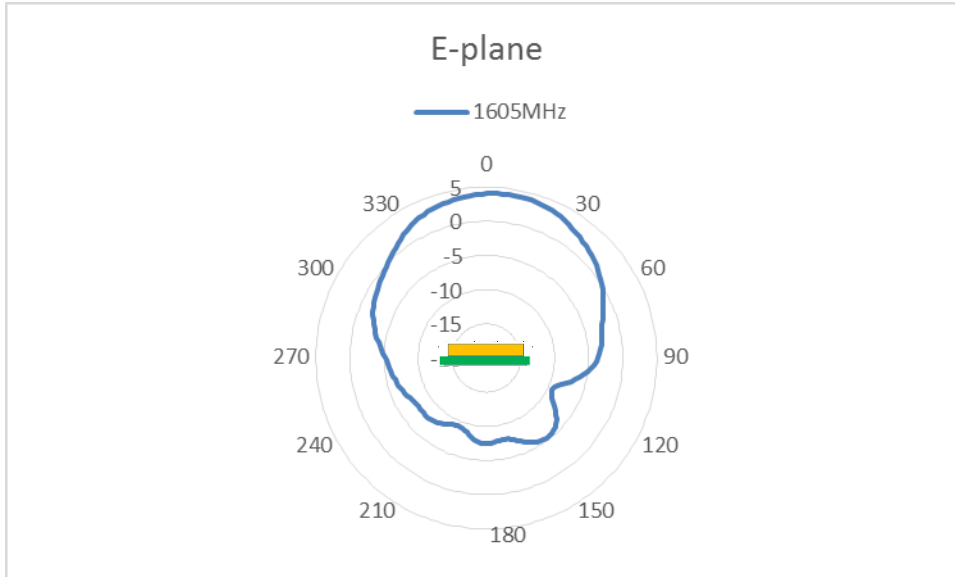

Glonass Radiation pattern on 70mmX70mm metal plane



**Description:** 25x25x4mm GPS/Glonass Pin Mount

**Series:** Ceramic Patch

**PART NUMBER:** W3223

## PACKAGING

Tray packing  
50PCS/Tray  
200PCS/small carton box  
800PCS/big carton box  
Big box dimensions (MM): 472x240x290

Issue: 1910

In the effort to improve our products, we reserve the right to make changes judged to be necessary.

CONFIDENTIAL AND PROPRIETARY INFORMATION

This document contains confidential and proprietary information of Pulse Electronics, Inc. (Pulse) and is protected by copyright, trade secret and other state and federal laws. Its receipt or possession does not convey any rights to reproduce, disclose its contents, or to manufacture, use or sell anything it may describe. Reproduction, disclosure or use without specific written authorization of Pulse is strictly forbidden.

Downloaded From [Oneyac.com](https://www.oneyac.com)

单击下面可查看定价，库存，交付和生命周期等信息

[>>Pulse\(普思\)](#)