

Operation: SMT+DIP/Push-Pull



LTEM NO.: USB-305S
(2.0-USB-CONNECTORS)



Technical parameter

PROJECT	LEVEL	A[better product]		B[average product]	
Electrical Properties	Contact Rating	25mA, 24V DC			
	Initial Contact Resistance	30mΩ max.		50mΩ max.	
	Insulation Resistance	100MΩ min.500V DC		Skey/PD: 100MΩ min.350V DC	
	Withstand Voltage	500V AC for 1 minute		350 V AC for 1 minut	
	Durable Performance	There No Load	5,000 Cycles		4,000 Cycles
Rated Load		4,000 Cycles		3,000 Cycles	
Storage temp.		-40℃~+85℃(Operating Temp:			

表面插装 DIP

側向導入 LATERAL

精密部品 NICETY

可靠 STABILIZE

適合環保 RoHS

Unit:mm

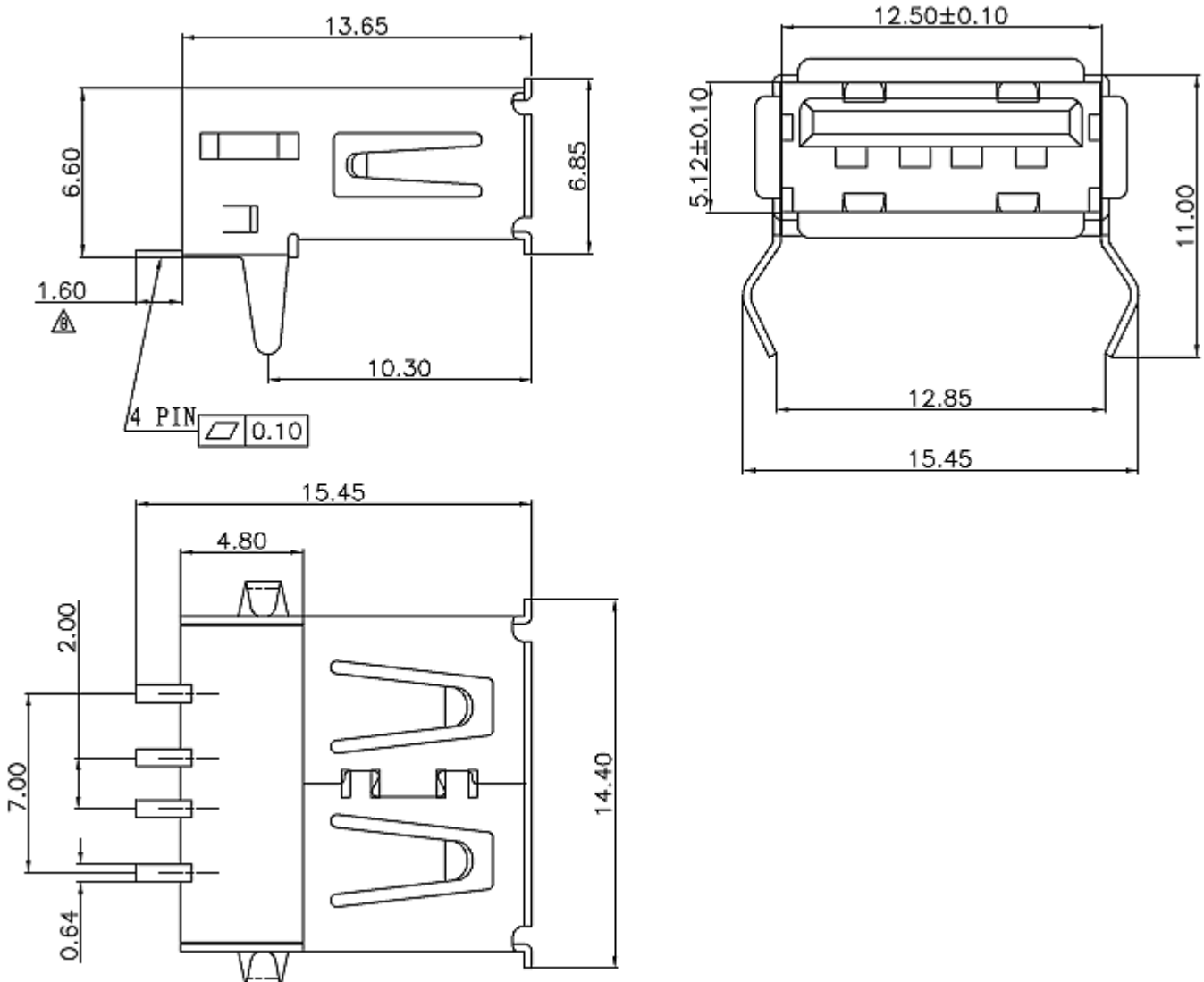

Operating Force

Insertion	12.00N(100grams) ±200gf
Exiting	12.00N(100grams) ±250gf

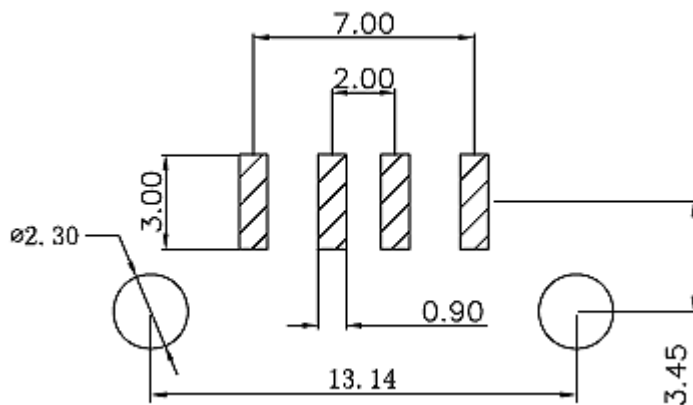

Pin Definition



Material declaration

No.	NAME	Type	Description
① A	胶芯	1	LCP 热塑性 [Black]
② B	接触端子	4	磷铜 C5191 (镀金 1u" / 焊区雾锡)
③ C	外壳	1	黄铜 C2680/SPCC [镀镍 50u" min]

本品不屬於危害性廢棄物,須丟棄時可以委託回收商予以回收再生處理。Products do not belong to hazardous waste, When waste can recycling processing

運送時本產品不要直接與水、酸鹼性化學物質接觸,或放置於含有以上氣體環境中,並且需要注意會有滑落、側翻的危險發生; 運輸過程中不能有碰撞或者擠壓,須保證溫度與濕度適中[常溫 25℃,濕度在 50℃以內],不可導致材料變形或氧化。



注記 NOTICE

1. 碩方公司擁有最終解釋權; The company reserves the right of final interpretation;
2. 文件禁止外洩、轉載; Leaked and reproduced prohibited;
3. 未經授權修改無效。Modify is invalid.

单击下面可查看定价，库存，交付和生命周期等信息

[>>SOFENG\(硕方\)](#)