

VOLTAGE RANGE: 20 - 200V
CURRENT: 1.0 A

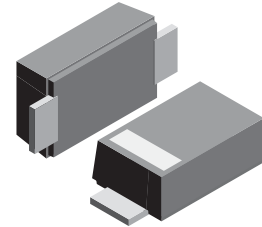

Features

- The plastic package carries Underwriters Laboratory Flammability Classification 94V-0
- Metal silicon junction, majority carrier conduction
- Low power loss, high efficiency
- High forward surge current capability
- High temperature soldering guaranteed:
 250°C/10 seconds, 0.375(9.5mm) lead length,
 5 lbs. (2.3kg) tension

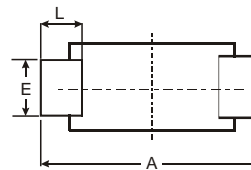
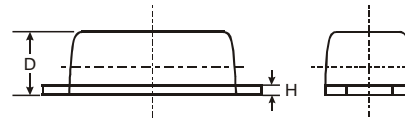
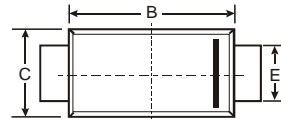

SOD-123FL			
Dim	Min	Max	Typ
A	3.58	3.72	3.65
B	2.72	2.78	2.75
C	1.77	1.83	1.80
D	1.02	1.08	1.05
E	0.097	1.03	1.00
H	0.13	0.17	0.15
L	0.53	0.57	0.55
All Dimensions in mm			

Mechanical Data

- Case: JEDEC SOD-123FL molded plastic body over passivated junction
- Terminals : Plated axial leads,
- solderable per MIL-STD-750, Method 2026
- Polarity : Color band denotes cathode end
- Mounting Position : Any
- Weight: 0.0007 ounce, 0.02 grams



Maximum Ratings and Electrical Characteristics T_A = 25°C unless otherwise specified

Single phase, half wave, 60Hz, resistive or inductive load. For capacitive load, derate current by 20%.

Characteristic	Symbol	DSS12	DSS13	DSS14	DSS15	DSS16	DSS17	DSS18	DSS19	DSS110	DSS115	DSS120	Unit	
	Marking	D12	D13	D14	D15	D16	D17	D18	D19	D110	D115	D120		
Maximum repetitive peak reverse voltage	V _{RRM}	20	30	40	50	60	70	80	90	100	150	200	v	
Maximum RMS voltage	V _{RMS}	14	21	28	35	42	49	56	63	70	105	140	v	
Maximum DC blocking voltage	V _{DC}	20	30	40	50	60	70	80	90	100	150	200	v	
Maximum average forward rectified current	I _(AV)	1.0											A	
Peak forward surge current 8.3ms single half sine-wave superimposed on rated load (JEDEC Method)	I _{FSM}	25.0											A	
Maximum instantaneous forward voltage at 1.0A	V _F	0.55			0.70			0.85			0.95		v	
Maximum DC reverse current at rated DC blocking voltage	I _R	0.5											mA	
		10.0						5.0			2.0			
Typical junction capacitance (NOTE 1)	C _J	110				80								pF
Operating junction temperature range	T _J	-65 to +125						-65 to +150						°C
Storage temperature range	T _{STG}	-65 to +150											°C	

Note: 1. Measured at 1MHz and applied reverse voltage of 4.0V D.C.

RATINGS AND CHARACTERISTIC CURVES DSS12 THRU DSS120

AVERAGE FORWARD RECTIFIED CURRENT, AMPERES

FIG. 1- FORWARD CURRENT DERATING CURVE

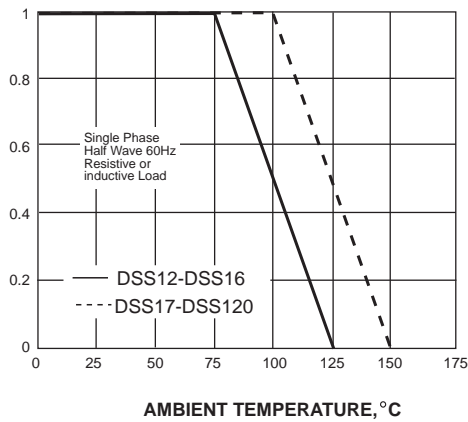

PEAK FORWARD SURGE CURRENT, AMPERES

FIG. 2-MAXIMUM NON-REPETITIVE PEAK FORWARD SURGE CURRENT

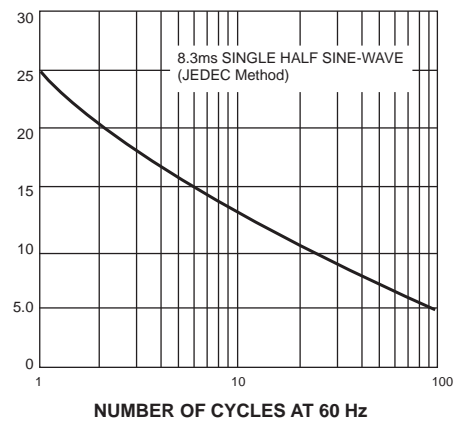

INSTANTANEOUS FORWARD CURRENT, AMPERES

FIG. 3-TYPICAL INSTANTANEOUS FORWARD CHARACTERISTICS

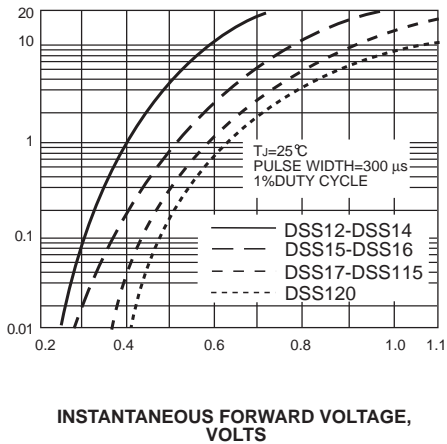

INSTANTANEOUS REVERSE CURRENT, MILLIAMPERES

FIG. 4-TYPICAL REVERSE CHARACTERISTICS

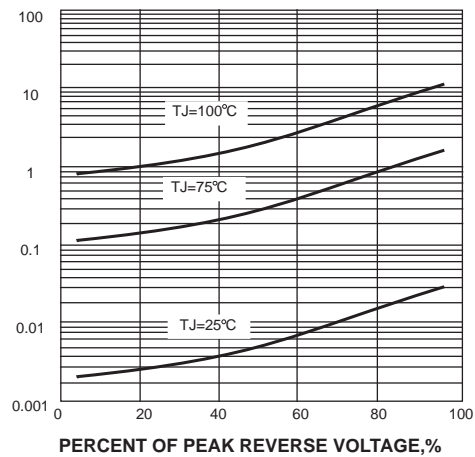

JUNCTION CAPACITANCE, pF

FIG. 5-TYPICAL JUNCTION CAPACITANCE

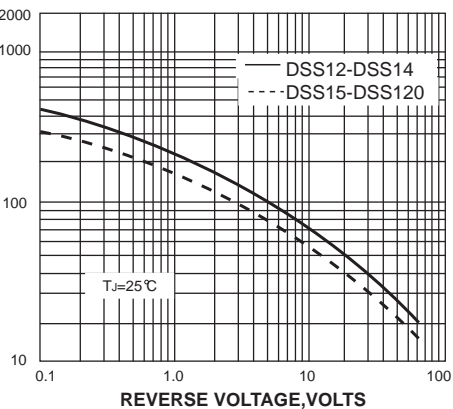

单击下面可查看定价，库存，交付和生命周期等信息

[>>SUNMATE\(森美特\)](#)