

VOLTAGE RANGE: 1.8 - 43V
POWER: 0.5Watts

Features

- Package Designed for Optimal Automated Board Assembly
- Small Package Size for High Density Applications

Mechanical Data

- Case: SOD-123FL
plastic body over passivated junction
- Terminals : Plated axial leads,
- solderable per MIL-STD-750, Method 2026
- Polarity : Color band denotes cathode end
- Mounting Position : Any
- Weight: 0.0007 ounce, 0.02 grams

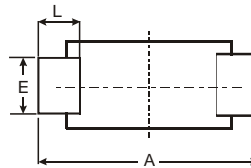
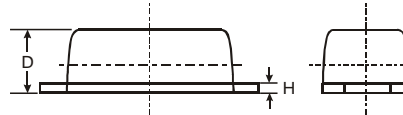
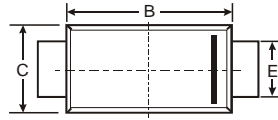
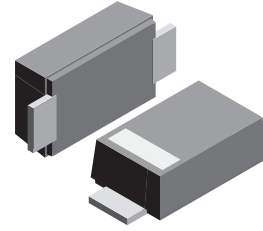

SOD-123FL			
Dim	Min	Max	Typ
A	3.58	3.72	3.65
B	2.72	2.78	2.75
C	1.77	1.83	1.80
D	1.02	1.08	1.05
E	0.097	1.03	1.00
H	0.13	0.17	0.15
L	0.53	0.57	0.55
All Dimensions in mm			

Maximum Ratings and Electrical Characteristics @ T_A = 25°C unless otherwise specified

Parameter	Symbol	Value	Unit
Zener Current see Table "Characteristics"			
Total Power Dissipation on FR-5 Board, at T _L = 75 °C	P _D	500 ⁽¹⁾	mW
Derated above 75 °C		6.7	mW/°C
Maximum Forward Voltage at I _F = 10 mA	V _F	0.95	V
Thermal Resistance Junction to Ambient	R _{θJA}	340	°C/W
Thermal Resistance Junction to Lead	R _{θJL}	150	°C/W
Junction Temperature Range	T _J	-55 to + 150	°C
Storage Temperature Range	T _{STG}	-55 to + 150	°C

Note :

(1) FR-5 = 3.5 x 1.5 inches, using the minimum recommended footprint.

ELECTRICAL CHARACTERISTICS

Rating at 25 °C ambient temperature unless otherwise specified.

Type	Zener Voltage ^(1,2)			Test Current	Maximum Reverse Leakage Current	
	$V_Z @ I_{ZT}$ (V)				I_{ZT}	$I_R @ V_R$
	Min.	Nom.	Max.	(μA)	(μA)	(V)
MMSZ4678	1.71	1.8	1.89	50	7.5	1.0
MMSZ4679	1.90	2.0	2.10	50	5.0	1.0
MMSZ4680	2.09	2.2	2.31	50	4.0	1.0
MMSZ4681	2.28	2.4	2.52	50	2.0	1.0
MMSZ4682	2.565	2.7	2.835	50	1.0	1.0
MMSZ4683	2.85	3.0	3.15	50	0.8	1.0
MMSZ4684	3.13	3.3	3.47	50	7.5	1.5
MMSZ4685	3.42	3.6	3.78	50	7.5	2.0
MMSZ4686	3.70	3.9	4.10	50	5.0	2.0
MMSZ4687	4.09	4.3	4.52	50	4.0	2.0
MMSZ4688	4.47	4.7	4.94	50	10	3.0
MMSZ4689	4.85	5.1	5.36	50	10	3.0
MMSZ4690	5.32	5.6	5.88	50	10	4.0
MMSZ4691	5.89	6.2	6.51	50	10	5.0
MMSZ4692	6.46	6.8	7.14	50	10	5.1
MMSZ4693	7.13	7.5	7.88	50	10	5.7
MMSZ4694	7.79	8.2	8.61	50	1.0	6.2
MMSZ4695	8.27	8.7	9.14	50	1.0	6.6
MMSZ4696	8.65	9.1	9.56	50	1.0	6.9
MMSZ4697	9.50	10	10.50	50	1.0	7.6
MMSZ4698	10.45	11	11.50	50	0.05	8.4
MMSZ4699	11.40	12	12.60	50	0.05	9.1
MMSZ4700	12.35	13	13.65	50	0.05	9.8
MMSZ4701	13.30	14	14.70	50	0.05	10.6
MMSZ4702	14.25	15	15.75	50	0.05	11.4
MMSZ4703	15.20	16	16.80	50	0.05	12.1
MMSZ4704	16.15	17	17.85	50	0.05	12.9
MMSZ4705	17.10	18	18.90	50	0.05	13.6
MMSZ4706	18.05	19	19.95	50	0.05	14.4
MMSZ4707	19.00	20	21.00	50	0.01	15.2
MMSZ4708	20.90	22	23.10	50	0.01	16.7
MMSZ4709	22.80	24	25.20	50	0.01	18.2
MMSZ4710	23.75	25	26.25	50	0.01	19.0
MMSZ4711	25.65	27	28.35	50	0.01	20.4
MMSZ4712	26.60	28	29.40	50	0.01	21.2
MMSZ4713	28.50	30	31.50	50	0.01	22.8
MMSZ4714	31.35	33	34.65	50	0.01	25.0
MMSZ4715	34.20	36	37.80	50	0.01	27.3
MMSZ4716	37.05	39	40.95	50	0.01	29.6
MMSZ4717	40.85	43	45.15	50	0.01	32.6

单击下面可查看定价，库存，交付和生命周期等信息

[>>SUNMATE\(森美特\)](#)