

## Features

- \* 40W peak pulse power (8/20  $\mu$ s)
- \* Protects one data or power line
- \* Operating voltage:  $\pm 5V$
- \* Ultra low clamping voltage
- \* Complies with following standards:
  - IEC 61000-4-2 (ESD) immunity test
    - Air discharge:  $\pm 22kV$
    - Contact discharge:  $\pm 20kV$
  - IEC61000-4-5 (SURGE)2.5A (8/20us)
  - RoHS Compliant

## Mechanical Characteristics

- \* Package: SOD-923(0402)
- \* Ultra low leakage: nA level
- \* Case Material: "Green" Molding Compound.
- \* UL Flammability Classification Rating 94V-0
- \* Moisture Sensitivity: Level 3 per J-STD-020
- \* Shipping Qty :8000 /7Inch Tape & Reel

## Applications

- \* Mobile Phones and Accessories
- \* Battery Protection
- \* USB VBus
- \* Power Line Protection
- \* Hand Held Portable Applications

## Dimensions and Pin Configuration

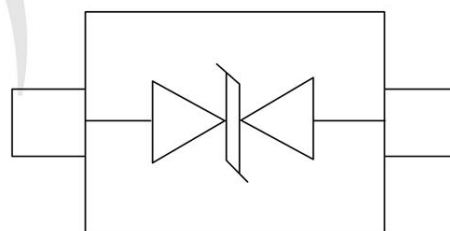

SOD923

**Marking: T\* Or N\***

**\* =Date code**

**Absolute Maximum Ratings** (Tamb=25°C unless otherwise specified)

Parameter	Symbol	Value	Unit
Peak Pulse Power (8/20μs)	Ppk	40	W
Peak Pulse Current (8/20μs)	IPP	2.5	A
ESD per IEC 61000-4-2 (Air)	VESD	±22	kV
ESD per IEC 61000-4-2 (Contact)		±20	
Operating Temperature Range	TJ	-55 to +125	°C
Storage Temperature Range	Tstg	-55 to +150	°C

**Electrical Characteristics** (TA=25°C unless otherwise specified)

Parameter	Symbol	Test Condition	Min	Typ	Max	Unit
Reverse Working Voltage	VRWM				5	V
Breakdown Voltage	VBR	IT = 1mA -	6.5	7.5	9.5	V
Reverse Leakage Current	IR	VRWM = 5.0V			0.08	μA
Clamping Voltage	VC	IPP = 1A (8 x 20us pulse)			10	V
Clamping Voltage	VC	IPP = 2.5A (8 x 20us pulse)			14	V
Junction Capacitance	CJ	VR = 0V, f = 1MHz		0.5	0.9	pF

## Characteristic Curves

**Fig1. 8/20 $\mu$ s Pulse Waveform**

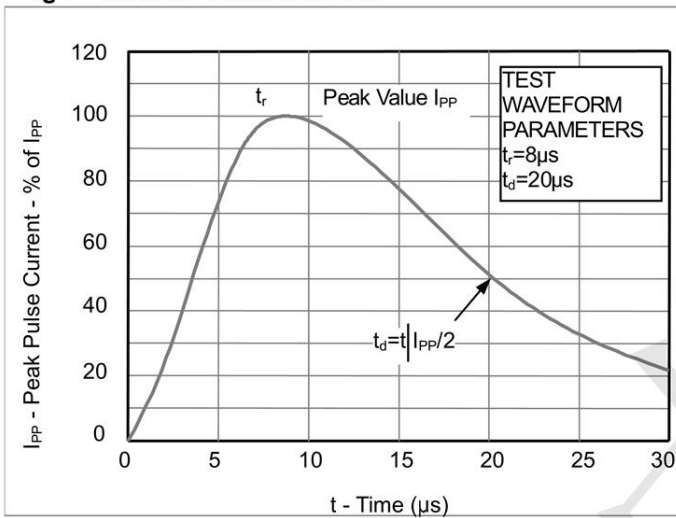

**Fig2. ESD Pulse Waveform (according to IEC 61000-4-2)**

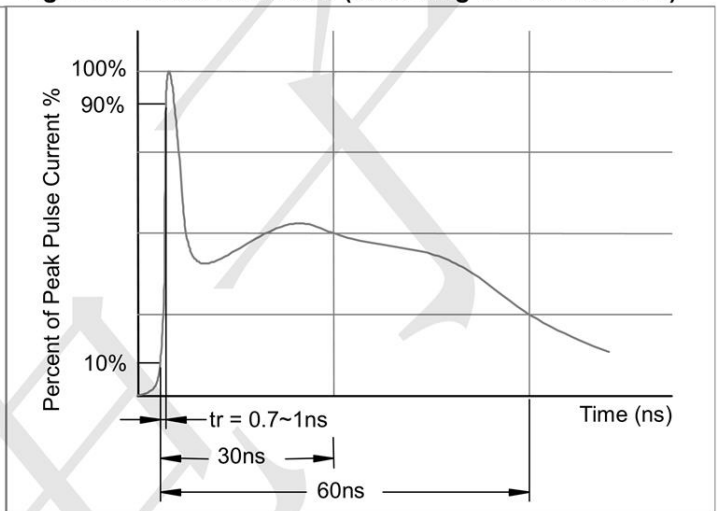

**Fig3. Power Derating Curve**

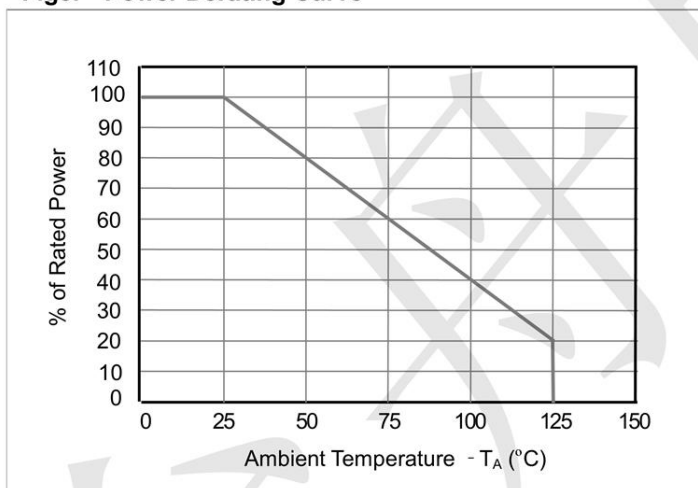

**Outline Drawing - SOD-923(0402)**

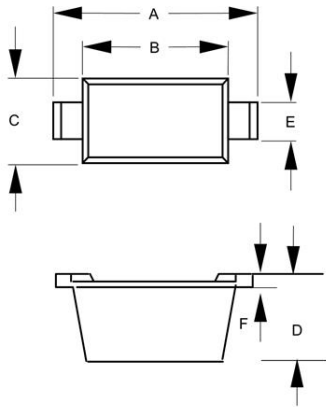

DIM	DIMENSIONS				NOTE
	INCHES		MM		
	MIN	MAX	MIN	MAX	
A	.037	.041	0.95	1.05	
B	.030	.033	0.75	0.85	
C	.022	.026	0.55	0.65	
D	.014	.017	0.36	0.43	
E	.006	.010	0.15	0.25	
F	.003	.007	0.07	0.17	

**Land Pattern - SOD-923(0402)**

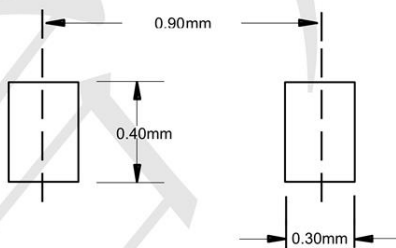

单击下面可查看定价，库存，交付和生命周期等信息

[>>TECH PUBLIC\(台舟\)](#)