

REVISONS		DATE	BY	APPV
D	REV PER ECO 09-014496	6-18-09	CT	DE

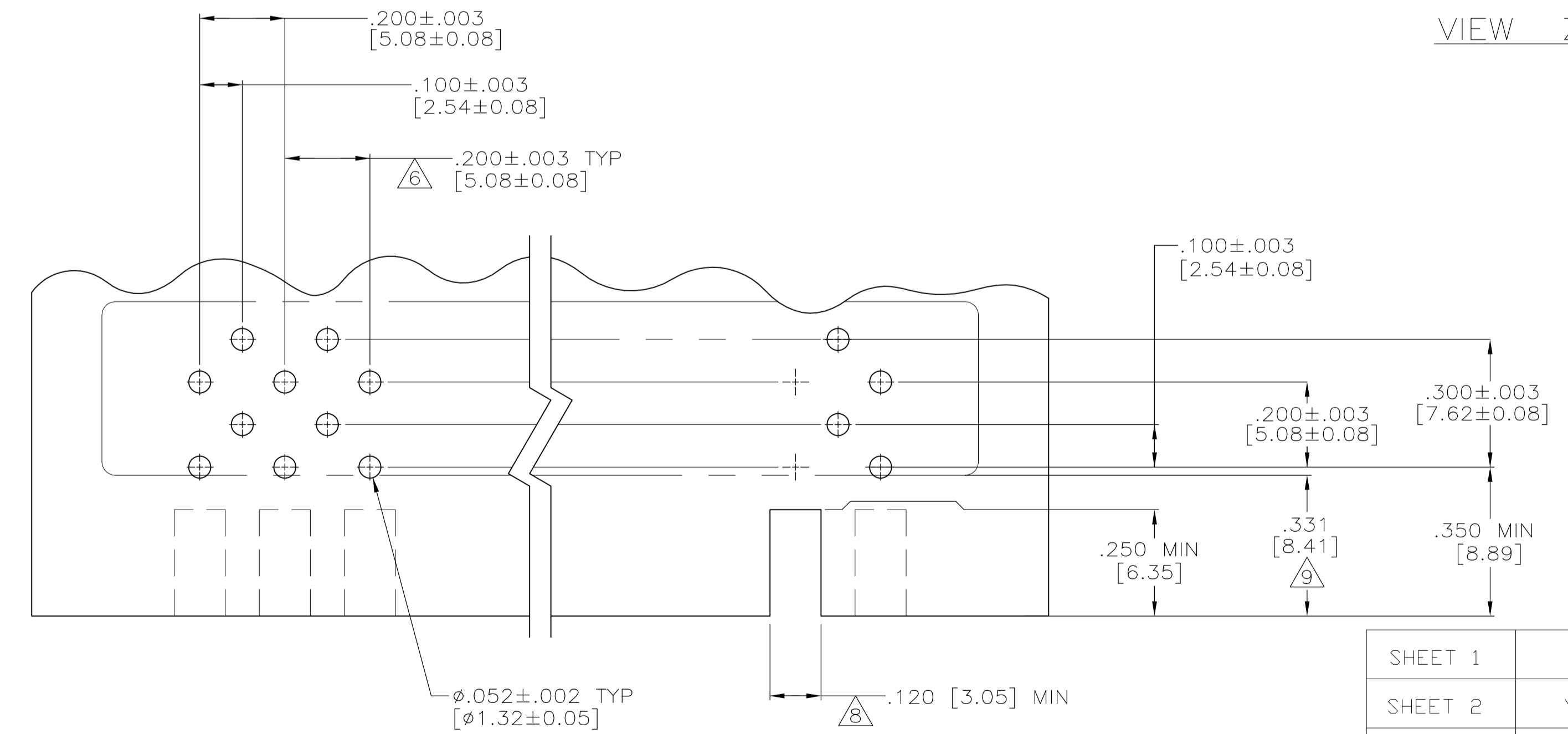
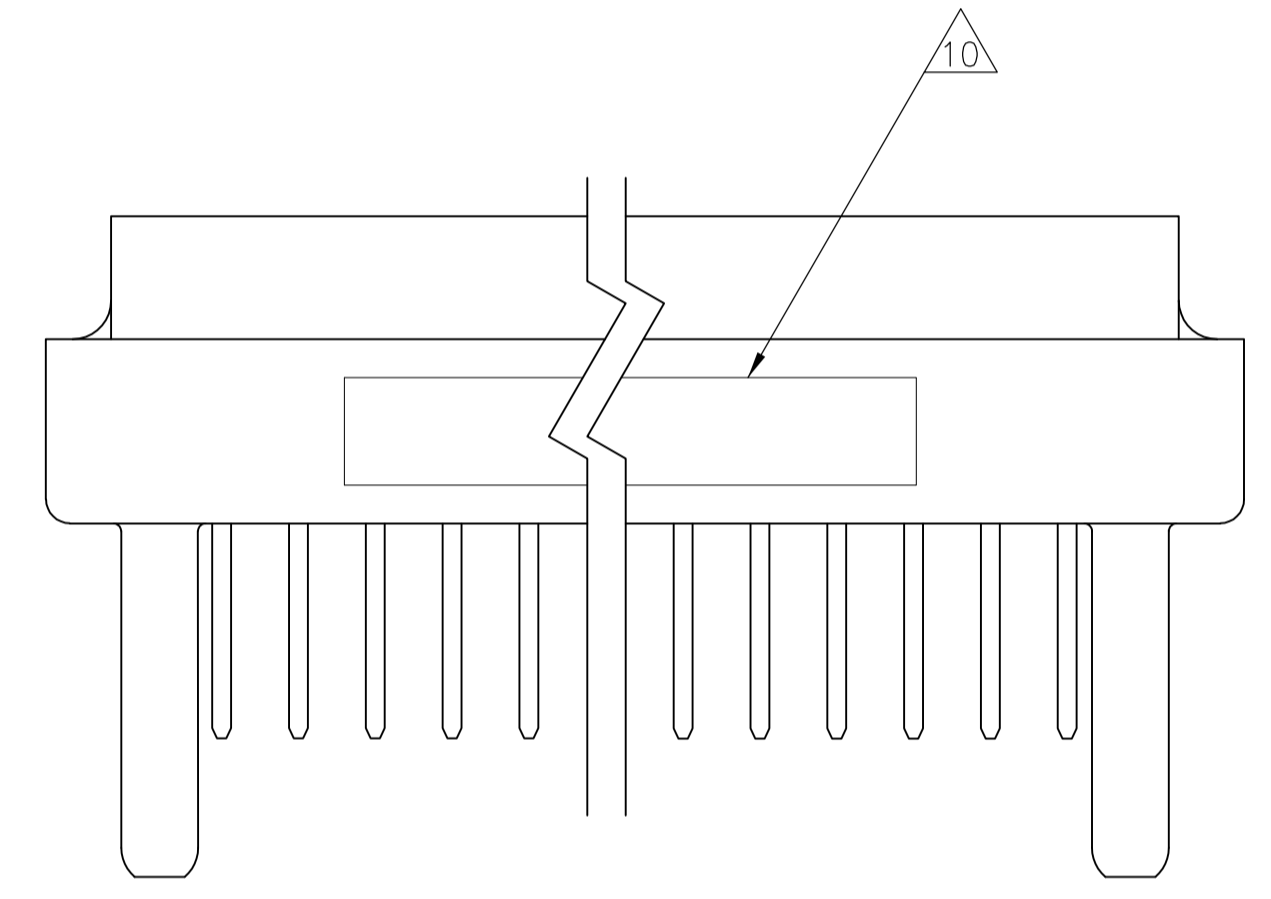
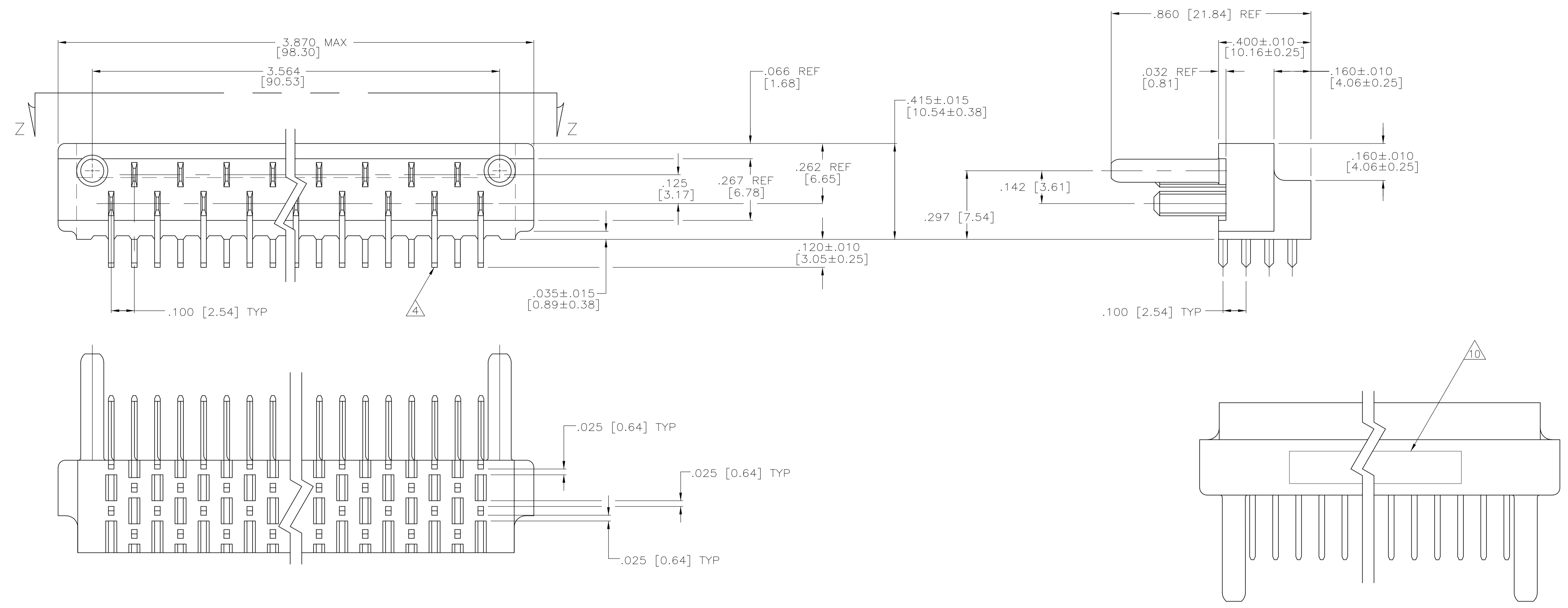

- TAB-HOUSING ASSEMBLY MATES WITH AMP P/N 3-582151 SERIES.
 - BLADE CENTER LINE TO BE MEASURED FROM THE CENTER LINE FORMED BY THE ALIGNMENT PINS & AS LONG AS THE BLADES FALL WITHIN TOLERANCES INDICATED, THE ALLOWABLE WARPAGE IS INDEPENDENT OF THE BLADES & BECOMES A MEASUREMENT OF THE OUTSIDE SURFACE OF THE TAB-HOUSING & DOES NOT EFFECT THE MATING OF THIS TAB-HOUSING WITH 582151.
- 3 MOUNTING HOLES.
- 4 CONTACT POSTS SOLDER DIPPED IN LEAD FREE SOLDER. CONNECTOR MUST MEET REQUIREMENTS OF JEDEC JESD22-B102 EXCEPT STEAM AGE 4 HRS AND 270°C SOLDER POT TEMP.
- 5 CONTACT MATL.; GILDING METAL. GOLD OVER NICKEL.
- 6 TOLERANCE NON CUMULATIVE.
- 7 TAB-HOUSING MATL.; DIALYL PHTHALATE, GLASS FILLED PER MIL-M-14, TYPE S.D.G.-F. COLOR; GREEN.
- 8 CUT OUT FOR KEYING BOSS, LOCATED WHERE REQD. (OPTIONAL)
- 9 FROM EDGE OF P.C. BOARD TO FACE OF TAB-HOUSING.
- 10 TYCO, TYCO PART NO. AND DATE CODE MARKED PER TABLE IN THIS APPROX AREA.
- 11 CONTACT FINISH; .0001 THK. GOLD, OVER NICKEL.

SHEET	NO	THICKNESS	NO. OF CONTACTS	PART NO.
SHEET 1	NO	.062 [1.57]	35	3-5582152-9
SHEET 2	YES	.062 [1.57]	17	3-5582152-1
SHEET 2	YES	.062 [1.57]	29	3-5582152-3
SEE SHEET	MOUNTING HOLES	P.C. BOARD THICKNESS	NO. OF CONTACTS	PART NO.

THIS DRAWING IS A CONTROLLED DOCUMENT.

BY: C.C. THOMAS 5-9-06
 CHK: D. MILLER 5-10-06
 APPV: D. MILLER 5-10-06

TOLERANCES UNLESS OTHERWISE SPECIFIED:
 0 PLC ± -
 1 PLC ± -
 2 PLC ± -
 3 PLC ± .005 [0.13]
 4 PLC ± -
 ANGLES ± -

APPLICATION SPEC: ASSEMBLY, AMP BLADE TAB HOUSING LEAD FREE

SIZE: A1
 CASE CODE: 00779
 DRAWING NO: 5582152

TYCO ELECTRONICS CORPORATION
 Harrisburg, PA 17105-3608

CUSTOMER DRAWING SCALE: 4:1 SHEET: 1 OF 2 REV: D

LOC		DIST		REVISIONS			
P	LTR	DESCRIPTION	DATE	DN	APVD		
-	-	SEE SHEET 1	-	-	-	-	-

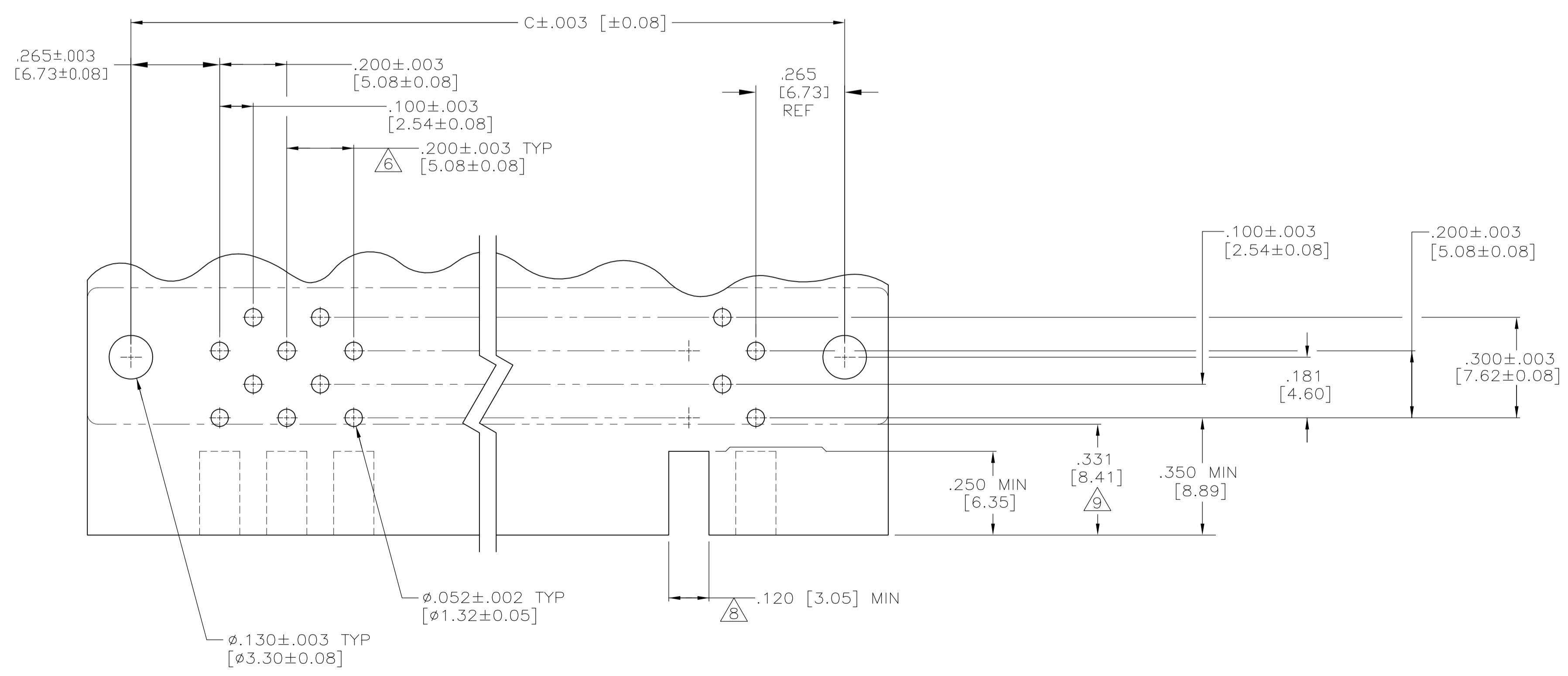
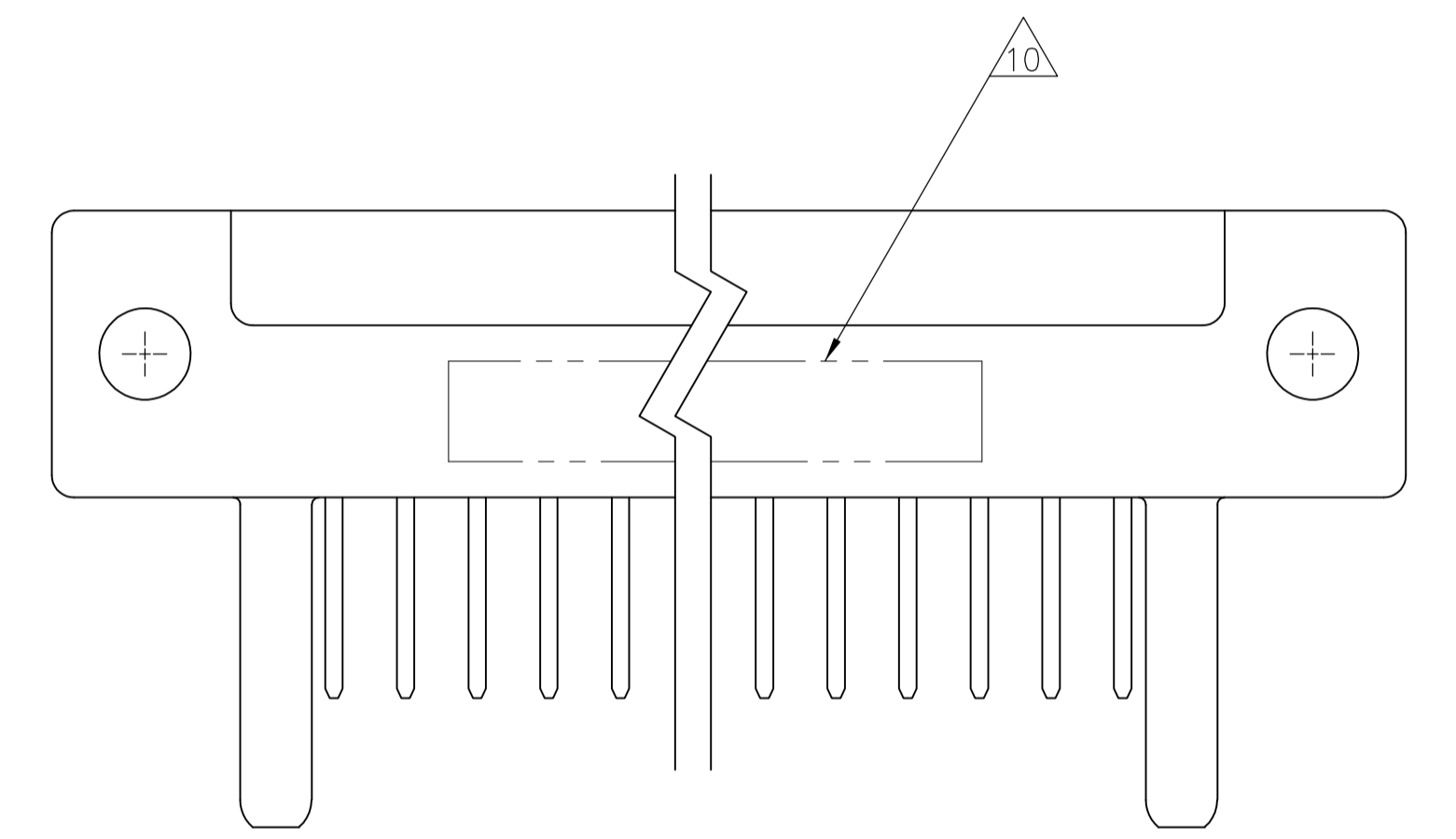
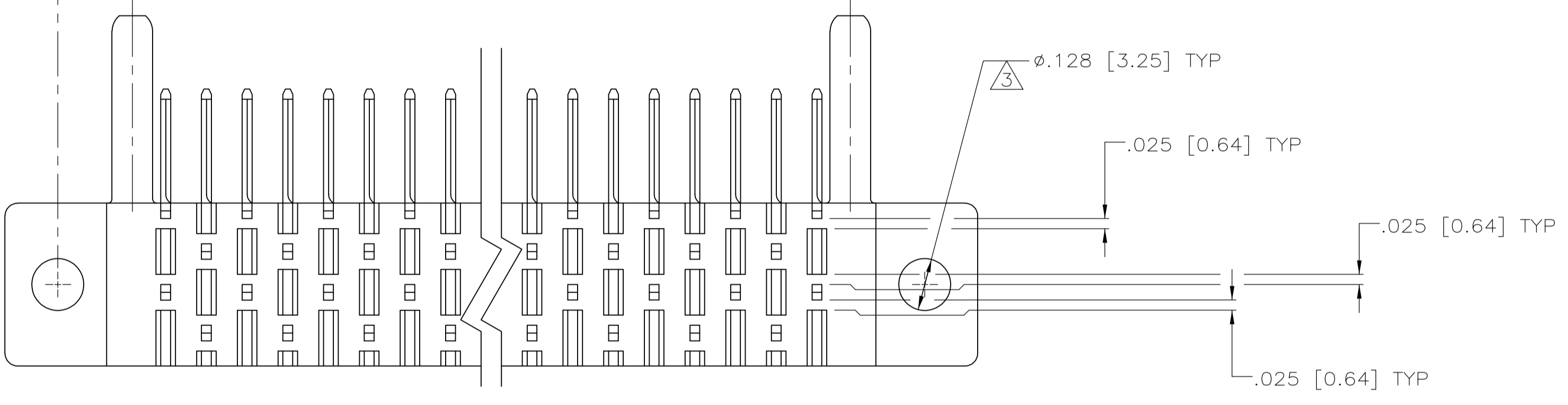
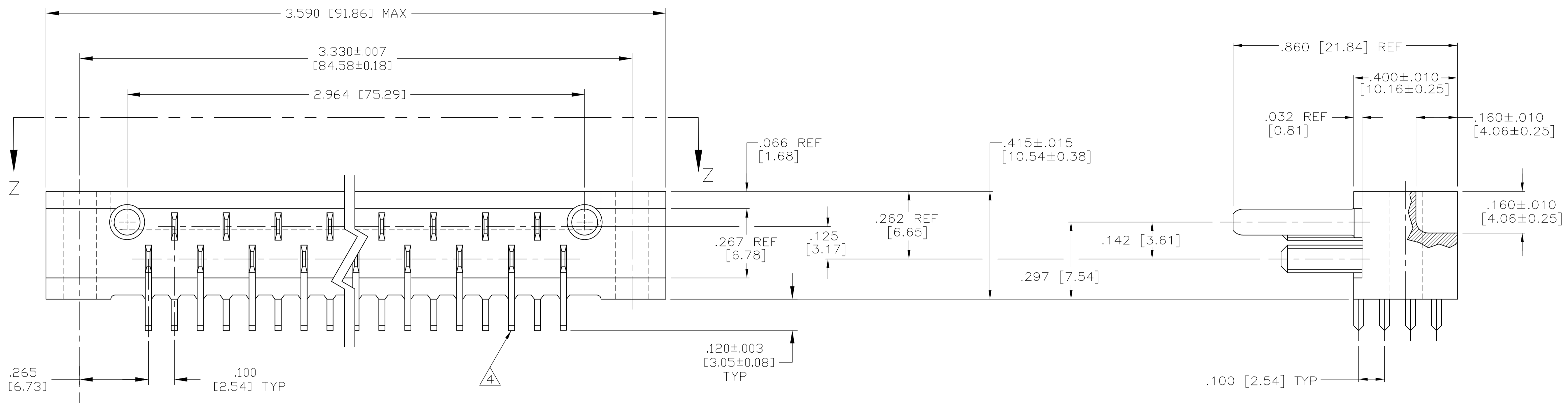

RECOMMENDED P.C. BOARD LAYOUT

THIS DRAWING IS A CONTROLLED DOCUMENT.		DIN C.C.THOMAS 5-9-06	Tyco Electronics Corporation Harrisburg, PA 17105-3608	
DIMENSIONS: INCHES		CHK D.MILLER 5-10-06	NAME D.MILLER 5-10-06	
TOLERANCES UNLESS OTHERWISE SPECIFIED:		APPLICATION SPEC		
0. PLC ± -		RESTRICTED TO		
1. PLC ± -		SIZE A1		
2. PLC ± -		CAGE CODE 00779		
3. PLC ± .005 [0.13]		DRAWING NO 5582152		
4. PLC ± -		SCALE 4:1		
ANGLES ± -		SHEET 2 OF 2		
FINISH SEE CALLOUTS		REV D		
MATERIAL SEE CALLOUTS		CUSTOMER DRAWING		

单击下面可查看定价，库存，交付和生命周期等信息

[>>TE Connectivity\(泰科\)](#)