

THIS DRAWING IS UNPUBLISHED. RELEASED FOR PUBLICATION, 19 .
 © COPYRIGHT 19 BY AMP INCORPORATED. ALL INTERNATIONAL RIGHTS RESERVED.

LOC	DIST	P	F	REVISIONS				
AJ	16			ZONE	LTR	DESCRIPTION	DATE	APPD
					F	OBSOLETE -9 PER OU20-0072-01	12APR01	MO

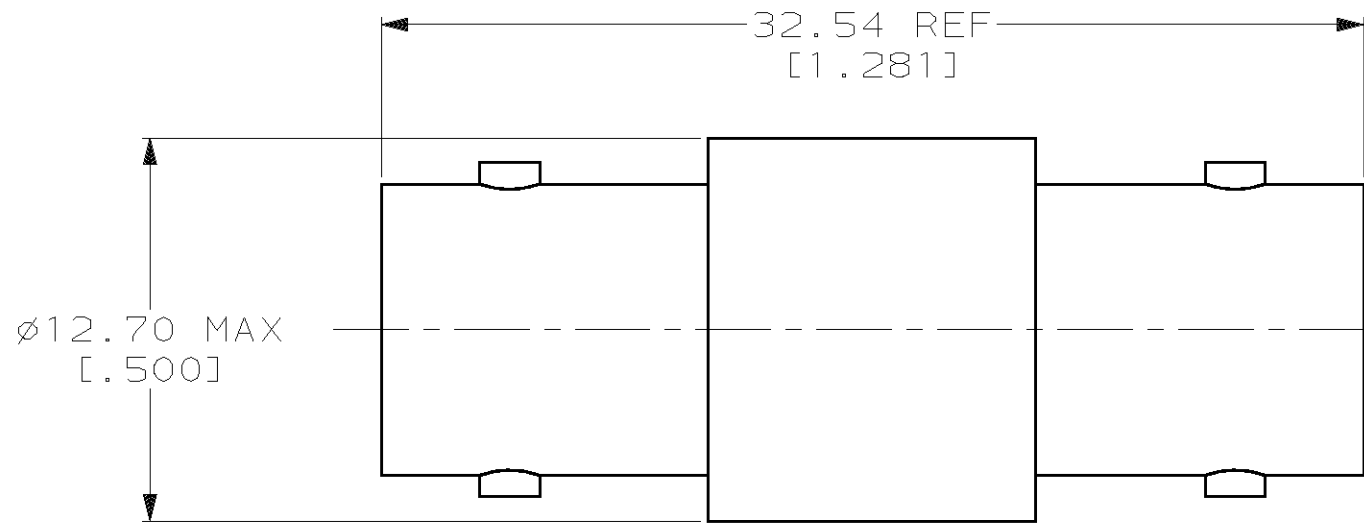

1. PART MAY BE INTER-MATED WITH PRODUCT PER MIL-C-39012
2. GOLD PLATING PER MIL-G-45204
3. NICKEL PLATING PER QQ-N-290
4. SILVER PLATING PER QQ-S-365
5. SEE SEPARATE RESTRICTED CUSTOMER DRAWING 221551-9

	OBSOLETE	2	3	1-221551-0
	OBSOLETE	5	-	221551-9
SUPERSEDED BY	221551-3	2	4	221551-4
		2	3	221551-3
SUPERSEDED BY	221551-1	4	4	221551-2
		4	3	221551-1
	CONTACT		SHELL	PART NUMBER
	FINISH			

DO NOT SCALE PRINT. UNLESS SPECIFIED DIMENSIONS IN mm [INCHES] TOLERANCES ON: 2 PLC DEC ± - 3 PLC DEC ± - ANGLES ± -		DR 5-10-91 M.E. COWHER	PART NO	
MATERIAL -	CHK 5-117-91 J.T. LIPPERT	APPD 5-24-91 M. PHILLIPS	AMP Incorporated Harrisburg, PA 17105-3608	
FINISH 2 3 4	APPD 6-5-91 M.E. COWHER	PRODUCT SPEC -	NAME ADAPTER, FEED THRU, JACK, SERIES BNC	
	APPLICATION SPEC -	WEIGHT -	SIZE B	CAGE CODE 00779
			DRAWING NO 221551	
			SCALE 4:1	SHEET 1 OF 1

单击下面可查看定价，库存，交付和生命周期等信息

[>>TE Connectivity\(泰科\)](#)