

4

3

2

1

THIS DRAWING IS UNPUBLISHED. RELEASED FOR PUBLICATION ,19 .

© COPYRIGHT 19 BY AMP INCORPORATED. ALL RIGHTS RESERVED.

LOC	DIST	REVISIONS					
		P	LTR	DESCRIPTION	DATE	DWN	APVD
G	86		G	REVISED PER 0L20-0217-97	04NOV97	DKS	MJS

- △1 TIN PL 0.00254 [.000100] MIN THK PER ASTM B-545
- △2 NICKEL PL 0.00508 [.000200] MIN THK PER QQ-N-290

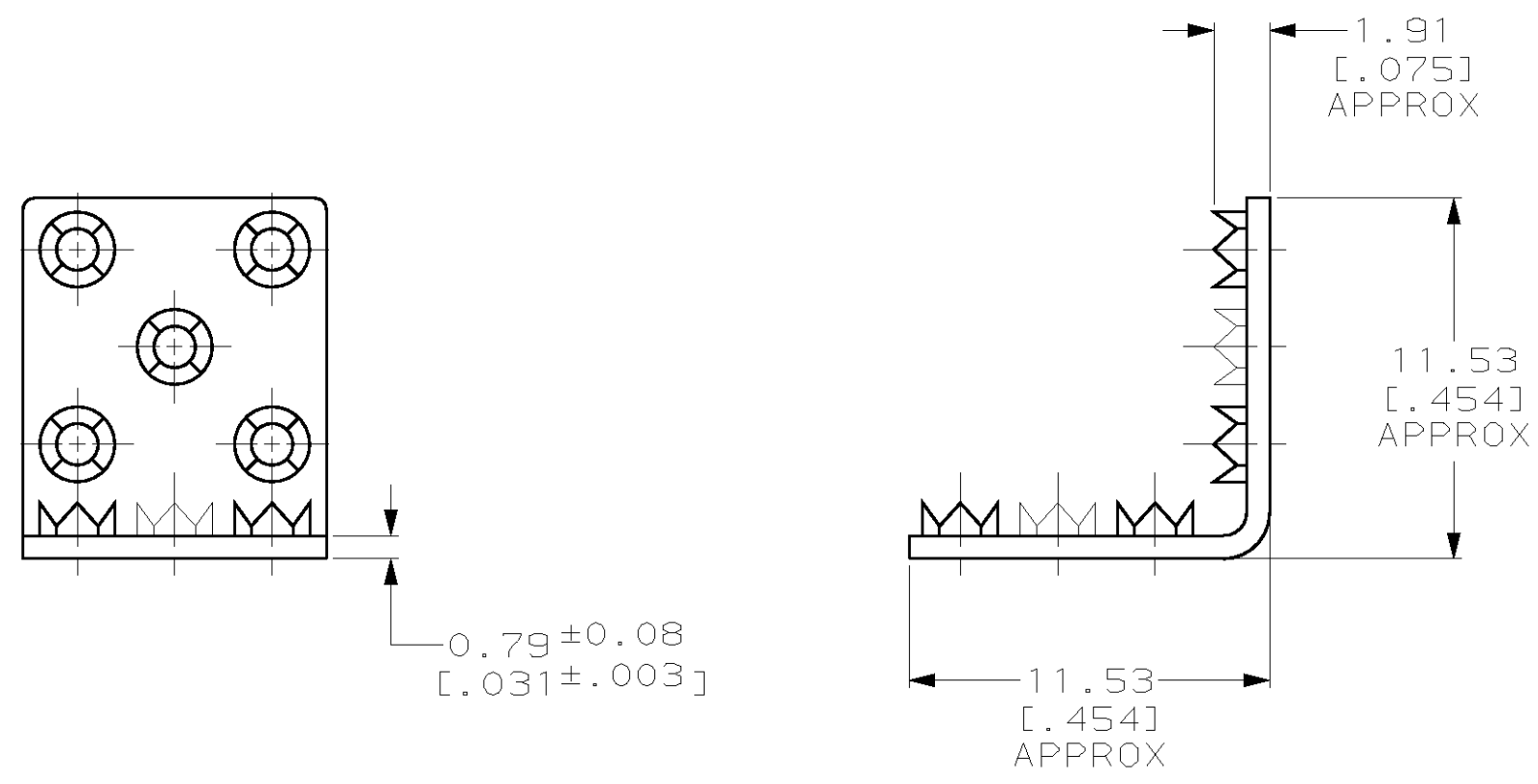

FINISH	OPERATING TEMPERATURE	AMP PART NUMBER
△2	343°C MAX	1-329656-1
△1	150°C MAX	329656

OBSOLETE

**AMP INCORPORATED**  
**CUSTOMER SERVICE SYSTEMS**

FOR ADDITIONAL PRODUCT INFORMATION OR COPIES OF DRAWINGS AND TECHNICAL DOCUMENTS  
PRODUCT INFORMATION CENTER  
1-800-522-6752

FOR APPLICATION TOOLING INFORMATION  
TOOLING ASSISTANCE CENTER  
1-800-722-1111

FOR ORDER ENTRY  
1-800-526-5142

RECOMMENDED OPERATING TEMPERATURE:  
SEE TABLE

VOLTAGE RATING:  
NOT APPLICABLE

ALUMINUM FOIL THICKNESS:  
0.76 [.030] MAX

THIS DRAWING IS A CONTROLLED DOCUMENT.

DIMENSIONS:  
mm [INCHES]

TOLERANCES UNLESS OTHERWISE SPECIFIED:

0 PLC	±-
1 PLC	±-
2 PLC	±0.20 [.008]
3 PLC	±-
4 PLC ANGLES	±-

MATERIAL: COPPER PER ASTM B-152 ANNEALED

FINISH: SEE TABLE

DWN	DK SCHRUM	04NOV97	<b>AMP</b> AMP Incorporated Harrisburg, PA 17105-3608
CHK	MJ SPICER	03DEC97	
APVD	JL MECKLEY	03DEC97	
PRODUCT SPEC	-		
APPLICATION SPEC	-		NAME SPLICE, TERMI-FOIL™, WIRE SIZE: 12-10 AWG
WEIGHT	-	-	SIZE A3
CUSTOMER DRAWING			CAGE CODE 00779
SCALE 4:1			DRAWING NO C- 329656
SHEET 1 OF 1			RESTRICTED TO -
REV G			

单击下面可查看定价，库存，交付和生命周期等信息

[>>TE Connectivity\(泰科\)](#)