

|                              |   |                          |  |
|------------------------------|---|--------------------------|--|
| THIS DRAWING IS UNPUBLISHED. |   | RELEASED FOR PUBLICATION |  |
| © COPYRIGHT - By -           |   | ALL RIGHTS RESERVED.     |  |
| PROJECT                      | PRJ-16-000909157                          |                          |  |
| PART NO.                     | X-2308298-X                               |                          |  |
| DESCRIPTION                  | QL-SET FOR VARIANT E LATCH PIN WITH GUIDE |                          |  |
| CUSTOMER                     | GENERAL MARKET                            |                          |  |

| REVISIONS |     |                           |           |       |
|-----------|-----|---------------------------|-----------|-------|
| P         | LTR | DESCRIPTION               | DATE      | APVD  |
|           | A2  | REVISED PER ECR-17-006621 | 09MAY2017 | KK SE |

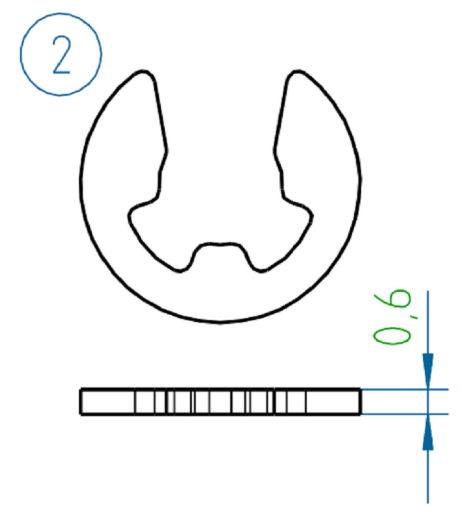
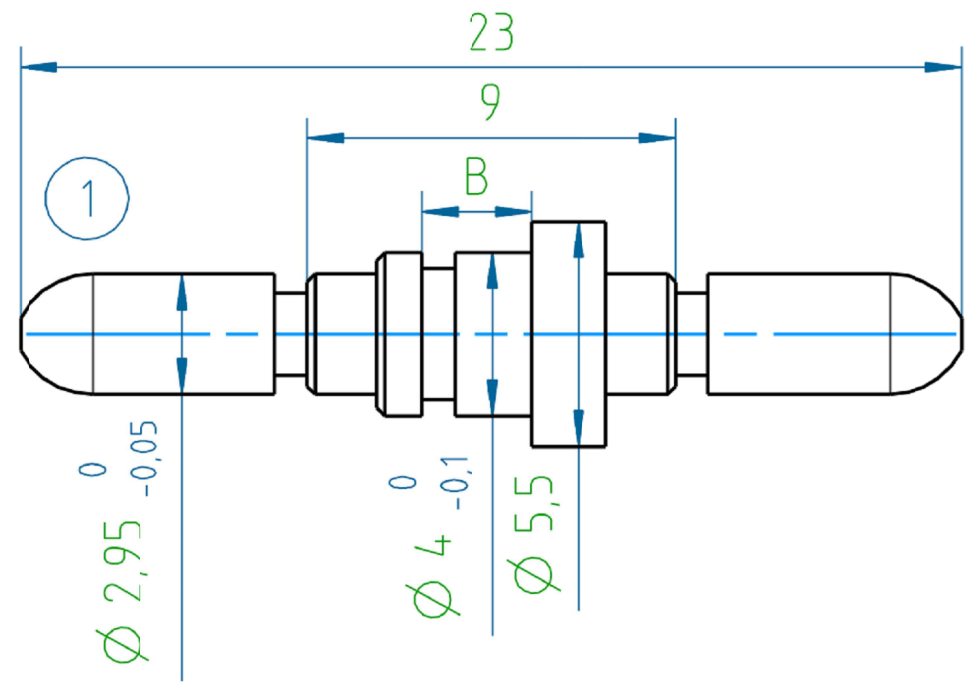

| ASSY. PART NO. | DESCRIPTION                     | B   | SUB-PART NO. | DESCRIPTION POS.1 | APPLICABLE WALL THICKNESS, mm |
|----------------|---------------------------------|-----|--------------|-------------------|-------------------------------|
| 1-2308298-6    | VARIANT E 6 (LATCH PIN W/GUIDE) | 3.8 | -            | LATCH PIN 46      | 3.0                           |
| 1-2308298-5    | VARIANT E 5 (LATCH PIN W/GUIDE) | 3.3 | 3-2308352-0  | LATCH PIN 20      | 2.5                           |
| 1-2308298-4    | VARIANT E 4 (LATCH PIN W/GUIDE) | 2.9 | 2-2308352-9  | LATCH PIN 19      | 2.2                           |
| 1-2308298-3    | VARIANT E 3 (LATCH PIN W/GUIDE) | 2.7 | 2-2308352-8  | LATCH PIN 18      | 2.0                           |
| 1-2308298-2    | VARIANT E 2 (LATCH PIN W/GUIDE) | 2.2 | 2-2308352-7  | LATCH PIN 17      | 1.5                           |
| 1-2308298-1    | VARIANT E 1 (LATCH PIN W/GUIDE) | 2.0 | 2-2308352-6  | LATCH PIN 16      | 1.25                          |

1-2308298-3  
(MOUNTED) (1:1)

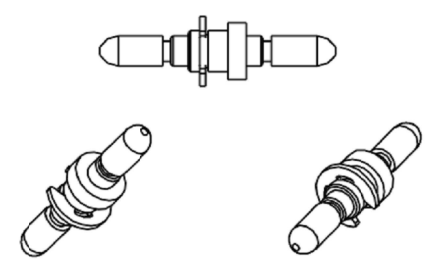

| SL NO. | QTY | ASSY. PART NO. | SUB-PART NO.                         | DESCRIPTION            |
|--------|-----|----------------|--------------------------------------|------------------------|
| 2      | 2   | X-2308298-X    | -                                    | LOCK WASHER DIN 6799-3 |
| 1      | 2   |                | (SEE ABOVE TAB. FOR LATCH PIN P/N'S) | LATCH PIN              |

NOTES:  
1. WEIGHT: 1.6 g.

|   |  |                                |   |                    |
|---|--|--------------------------------|---|--------------------|
| THIS DRAWING IS A CONTROLLED DOCUMENT.                                      |  | DWN 28JUL2016<br>KIRAN K       | TE Connectivity                                   |                    |
| DIMENSIONS: mm  |  | CHK 28JUL2016<br>GUNASEKHAR G  |   |                    |
| TOLERANCES UNLESS OTHERWISE SPECIFIED: DIN ISO 2768 m                       |  | APVD 28JUL2016<br>GUNASEKHAR G | NAME<br>QL-SET FOR VARIANT E LATCH PIN WITH GUIDE |                    |
| 0 PLC ± -<br>1 PLC ± -<br>2 PLC ± -<br>3 PLC ± -<br>4 PLC ± -<br>ANGLES ± - |  | PRODUCT SPEC<br>-              | SIZE<br>A3  |                    |
| MATERIAL<br>-   |  | FINISH<br>-                    | APPLICATION SPEC<br>-                             | CAGE CODE<br>00779 |
|   |  | WEIGHT<br>-                    | DRAWING NO<br>C-2308298                           | RESTRICTED TO<br>- |
| CUSTOMER DRAWING  |  |                                | SCALE<br>NTS                                      | SHEET<br>1 of 1    |
|   |  |                                | REV<br>A2   |                    |

单击下面可查看定价，库存，交付和生命周期等信息

[>>TE Connectivity\(泰科\)](#)