

## **Introducing** Low and High Intensity LED Light Pipe

 **Tyco Electronics**  
Our commitment. Your advantage.

# Low and High Intensity LED Light Pipe

## KEY FEATURES

- Complete solution with LED, Light Pipe Holder, Driver and Cables
- Low Intensity Light Engine Assembly includes a 1/2 watt LED and driver
- High Intensity Light Socket Assembly available for 1 to 5 watt LED
- High Intensity Light Socket Assembly accepts commercially available Star Board LEDs
- Double Sided Light Engine and Light Socket Assembly maximizes light output
- Both 5mm and 10mm Light Pipes available in optical grade clear acrylic
- 1/2 Watt LED Engine Assembly with integrated DC driver does not require any additional heat sink or forced air cooling
- Light Pipe Holder allows the reflector strip to be oriented in 4 different positions for directional lighting flexibility
- LED light source located on end of LIGHT Pipe rod for remote lighting applications
- Options for curved Light Pipes
- Maximum recommended length is 2 meters/78 inches
- Light pipe can be linear or configured in various shapes
- Black anodized heat sink available upon special request

## DESCRIPTIONS

Linear light source using a TE proprietary large core optical fiber rod that projects a band of light along the entire length of the Light Pipe using one or more LEDs.

## APPLICATIONS

Accent/trim lighting found in commercial building, industrial, appliance, rail, motor vehicle and commercial aircraft

## ELECTRICAL

### High Intensity Light Socket

Operating Voltage : Socket can accommodate up to 50V max

Operating Current : Socket can accommodate up to 2500mA

Maximum wattage : Up to 5 watts is possible

Dependant on LED Type

Dependant on max LED Junction Temperature & Environmental conditions

### Low Intensity Light Engine

Input Voltage : Universal 7-27VDC

LED Wattage Rating : 1/2 watt

## MATERIALS

### Light Pipe

Clear and White Acrylic

### Low Intensity Light Engine Assembly

Housing : PB

PCB : FR4

### High Intensity Light Socket Assembly

Contact Carrier : PBT

Locking Ring : PBT

Contacts : Copper Alloy - Tin Plated

Heat Sink : Cast Aluminum

## STANDARDS AND SPECS

### Low Intensity Light Engine Assembly

**108-2347** : Design Objectives

**114-13241** : Application Specification

### High Intensity Light Socket Assembly

**108-2348** : Design Objectives

**114-13232** : Application Specification

### UL 8750

# Low and High Intensity LED Light Pipe

## MECHANICAL

- 5mm and 10mm diameter Light Pipe
- Light Pipe lengths of up to 2 meters
- Complete LED Engine, Driver, Light Pipe Holder

## PRODUCT OFFERING

- 2008876-1** : 10mm Low Intensity Light Engine Assembly
- 2008876-2** : 5mm Low intensity Light Engine Assembly
- 2008639-1** : High Intensity Light Socket Assembly (10mm only)
- 2058295-X** : 10mm Light Pipe (various lengths available, see customer drawing)
- 2058296-X** : 5mm Light Pipe (various lengths available, see customer drawing)

## OPTIONAL ACCESSORIES

- 2058329-1** : Thermally Conductive Pad
- 2058077-1** : 2 Position CT Low Intensity Light Engine Cable Assembly
- 2058102-1** : ULTRA-FAST High Intensity Light Socket Cable Assembly 1.52 mm [6.00] long (Black)
- 2058102-2** : ULTRA-FAST High Intensity Light Socket Cable Assembly 1.52 mm [6.00] long (Red)

### Low Intensity Light Engine

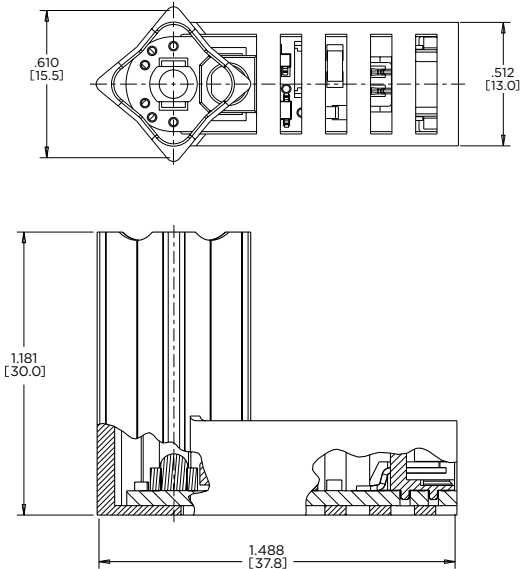

### High Intensity Light Engine

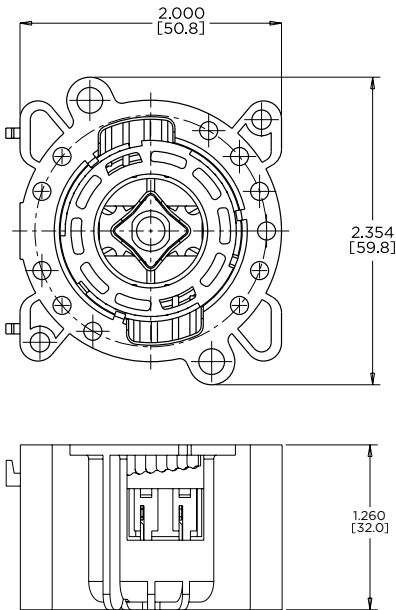

## FOR MORE INFORMATION

[www.tycoelectronics.com/lighting](http://www.tycoelectronics.com/lighting)

### Technical Support

Internet:	<a href="http://www.tycoelectronics.com/help">www.tycoelectronics.com/help</a>
USA:	+1 (800) 522-6752
Canada:	+1 (905) 470-4425
Mexico & Central America:	+52(0) 55-1106-0814
South America:	+55 (0) 11-2103-6000
Germany:	+49 (0) 6251-133-1999
UK:	+44 (0) 8706-080208
France:	+33 (0) 1-3420-8686
Netherlands:	+31 (0) 73-6246-999
China:	+86 (0) 400-820-6015

Part numbers in this brochure are RoHS Compliant\*, unless marked otherwise.

\*as defined [www.tycoelectronics.com/leadfree](http://www.tycoelectronics.com/leadfree)

### Tyco Electronics Corporation

Harrisburg, PA

[tycoelectronics.com](http://tycoelectronics.com)

© 2009 Tyco Electronics Corporation. All Rights Reserved.

6-1773453-7 3M FP 01/2010

TE (logo) and Tyco Electronics are trademarks of the Tyco Electronics group of companies and its licensors.

Other products, logos, and Company names mentioned herein may be trademarks of their respective owners.

While Tyco Electronics has made every reasonable effort to ensure the accuracy of the information in this catalog, Tyco Electronics does not guarantee that it is error-free, nor does Tyco Electronics make any other representation, warranty or guarantee that the information is accurate, correct, reliable or current. Tyco Electronics reserves the right to make any adjustments to the information contained herein at any time without notice. Tyco Electronics expressly disclaims all implied warranties regarding the information contained herein, including, but not limited to, any implied warranties of merchantability or fitness for a particular purpose. The dimensions in this catalog are for reference purposes only and are subject to change without notice. Specifications are subject to change without notice. Consult Tyco Electronics for the latest dimensions and design specifications.



**Tyco Electronics**  
Our commitment. Your advantage.

单击下面可查看定价，库存，交付和生命周期等信息

[>>TE Connectivity\(泰科\)](#)