

REVISIONS				
P.	LTN	DESCRIPTION	DATE	APP'D
1		INITIAL RELEASE	13SEP2013	RG AC
2		REVISED PER ECO-14-018993	2APR2015	RG MC

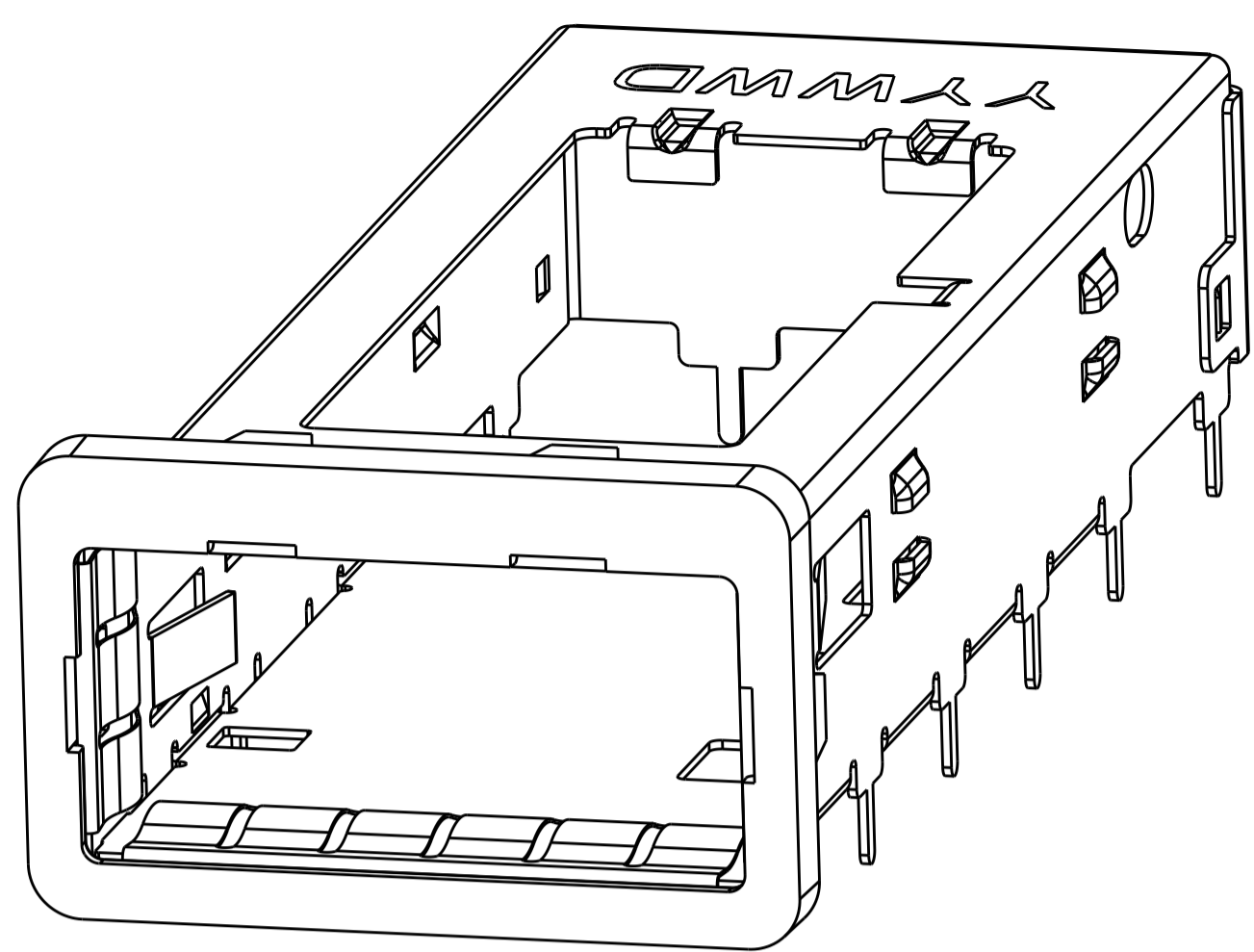

ISOMETRIC VIEW
SCALE 5:1

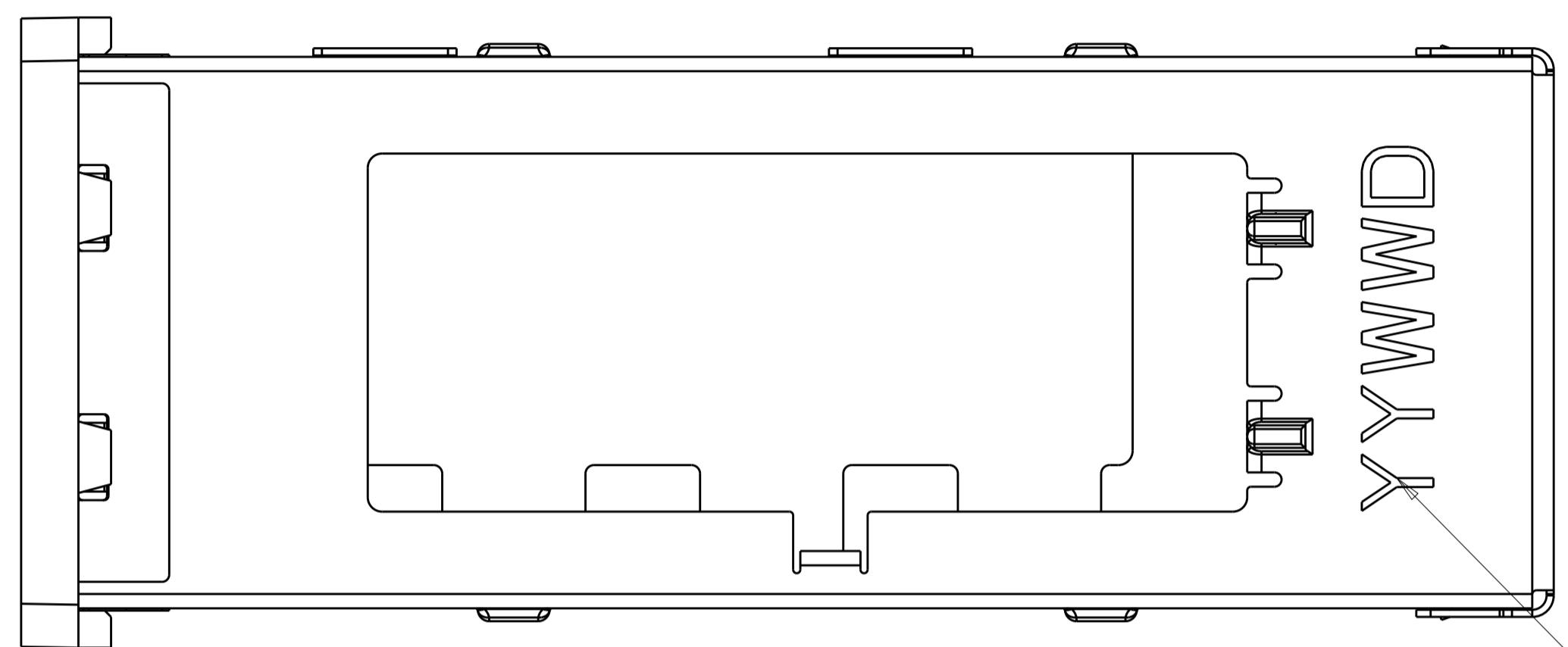

- 1 SURFACE TRACES PERMITTED WITHIN THIS LENGTH EXCEPT WHERE CAGE STANDOFFS, SHOWN IN DETAIL J, CONTACT PC BOARD.
- 2 MINIMUM PITCH DIMENSION.
- 3. MATES WITH QSFP MSA COMPATIBLE TRANSCEIVER.
- 4 REFERENCE APPLICATION SPEC 114-13218 FOR RECOMMENDED DRILL HOLE DIAMETER AND PLATING THICKNESS.
- 5 DATUM AND BASIC DIMENSIONS ESTABLISHED BY CUSTOMERS.
- 6 DIMENSION C IS THE NOMINAL THICKNESS OF CUSTOMER SUPPLIED PC BOARD, SINGLE SIDED PC BOARD MINIMUM THICKNESS: 1.45
- 7 DATUM -A- IS TOP SURFACE OF THE HOST BOARD.
- 8 DATE CODE (YYWWD) MARKED APPROXIMATELY AS SHOWN.
- 9 CAGE MATERIAL: 0.25 THICK COPPER ALLOY
EMI SPRING MATERIAL: COPPER ALLOY
FRONT FLANGE MATERIAL: ZINC ALLOY.
- 10 EMI SPRING FINISH: 2µm TIN
FRONT FLANGE FINISH: 3µm MIN THICK TIN OVER 1.27µm MIN THICK NICKEL OVER 5.08µm MIN THICK COPPER.

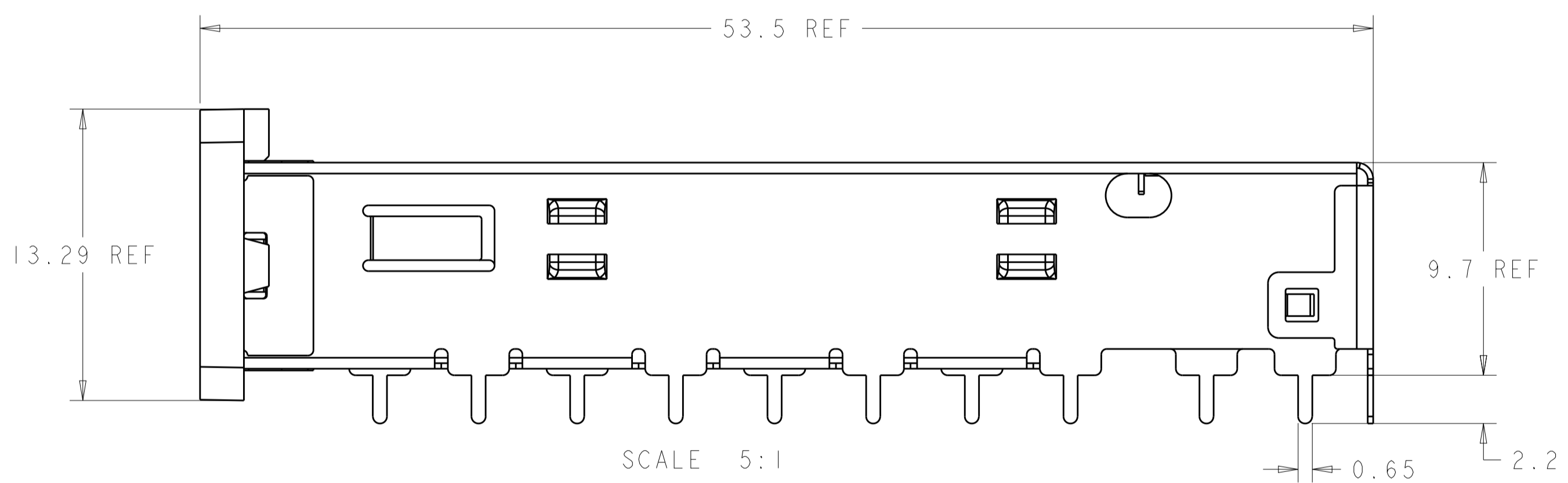
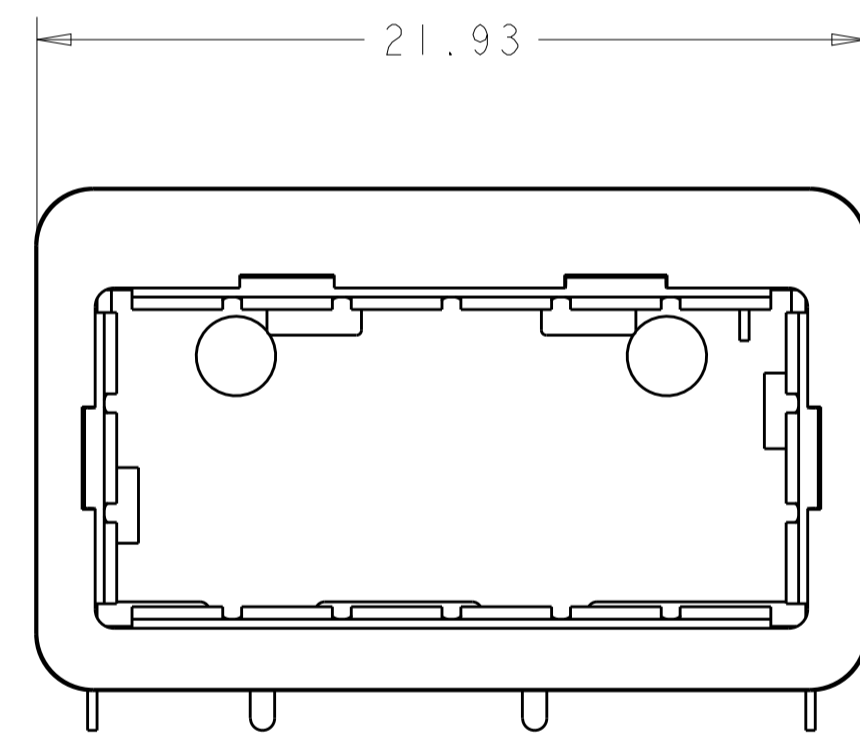

SCALE 5:1

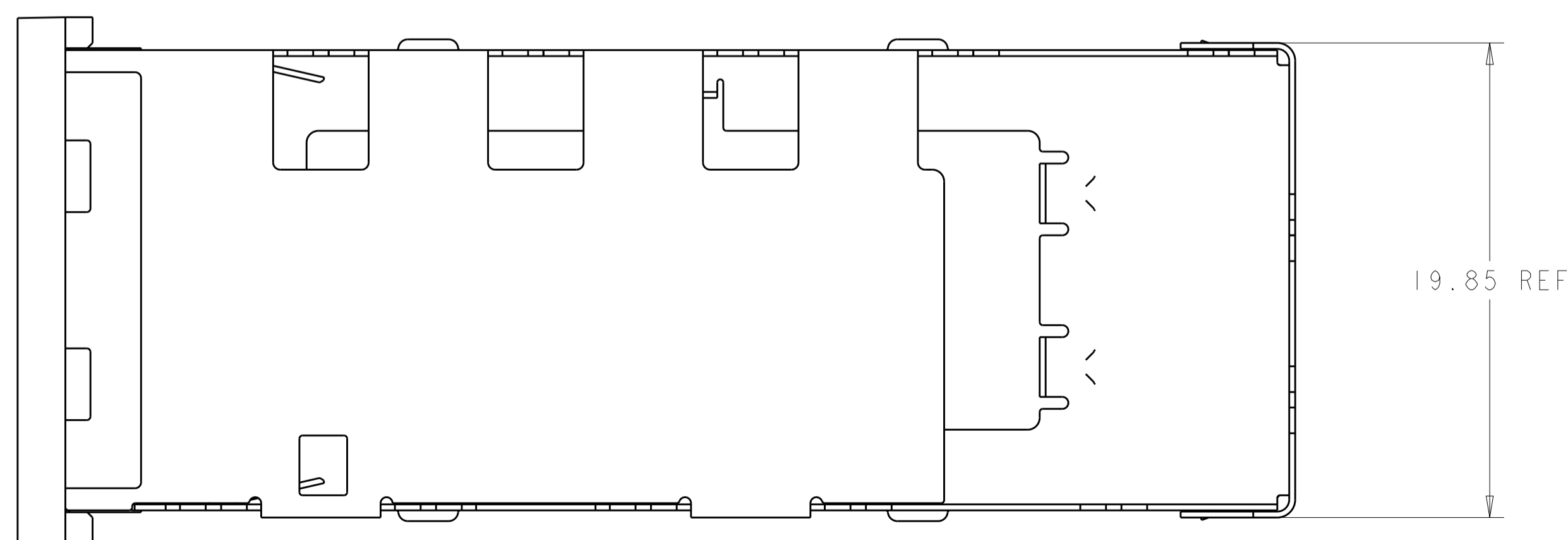
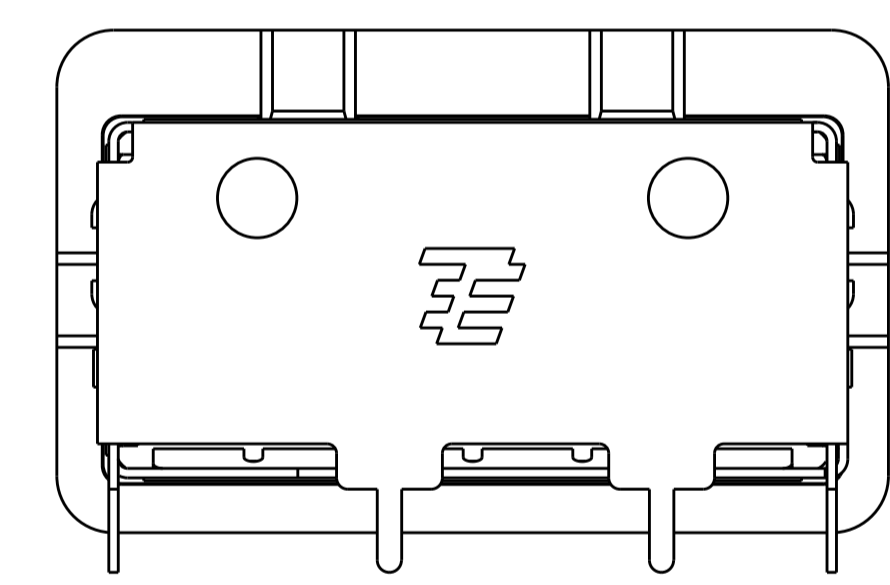

19.85 REF

2170396-1
PART NUMBER

THIS DRAWING IS A CONTROLLED DOCUMENT.		OWN: ROBERT GAN 13SEP2013	TE Connectivity	
DIMENSIONS: mm		CHK: JASON YANG 13SEP2013		
TOLERANCES UNLESS OTHERWISE SPECIFIED:		APP'D: AILEY CAI 13SEP2013		
0 PLC ±0.5	1 PLC ±0.13	NAME: CAGE ASSEMBLY, BEHIND BEZEL, QSPF	RESTRICTED TO	
2 PLC ±0.13	3 PLC ±0.013	PRODUCT SPEC: 108-2286	SIZE: CAGE CODE DRAWING NO	
4 PLC ±0.001	ANGLES ±0.0001	APPLICATION SPEC: 114-13218	A100779C=2170396	
MATERIAL: 9	FINISH: 10	WEIGHT: -	Customer Drawing	
SCALE: 2:1		SHEET 1 OF 3		REV 2

REVISIONS				
P.	LTN	DESCRIPTION	DATE	APVD
-	-	SEE SHEET 1	-	-

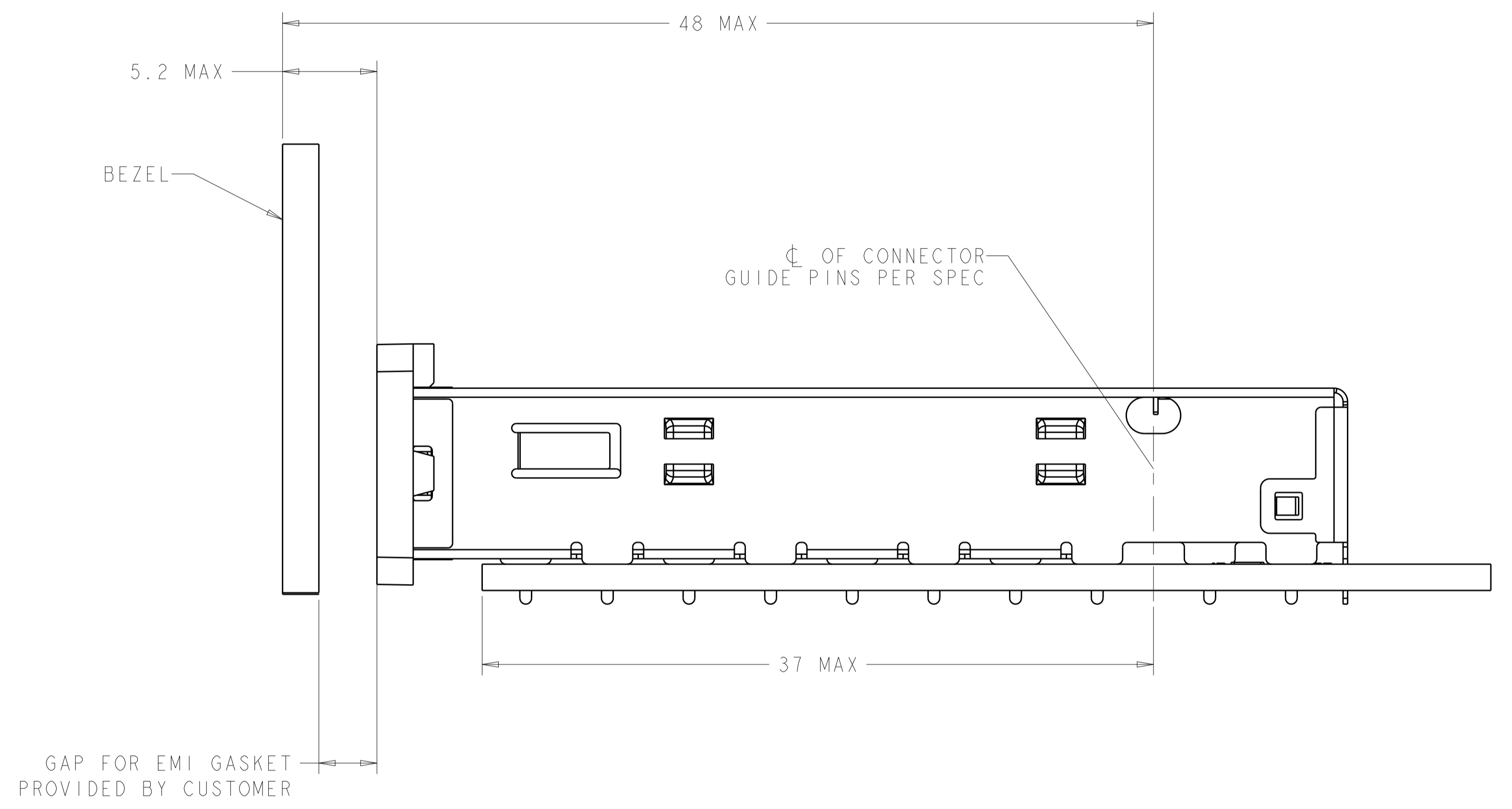
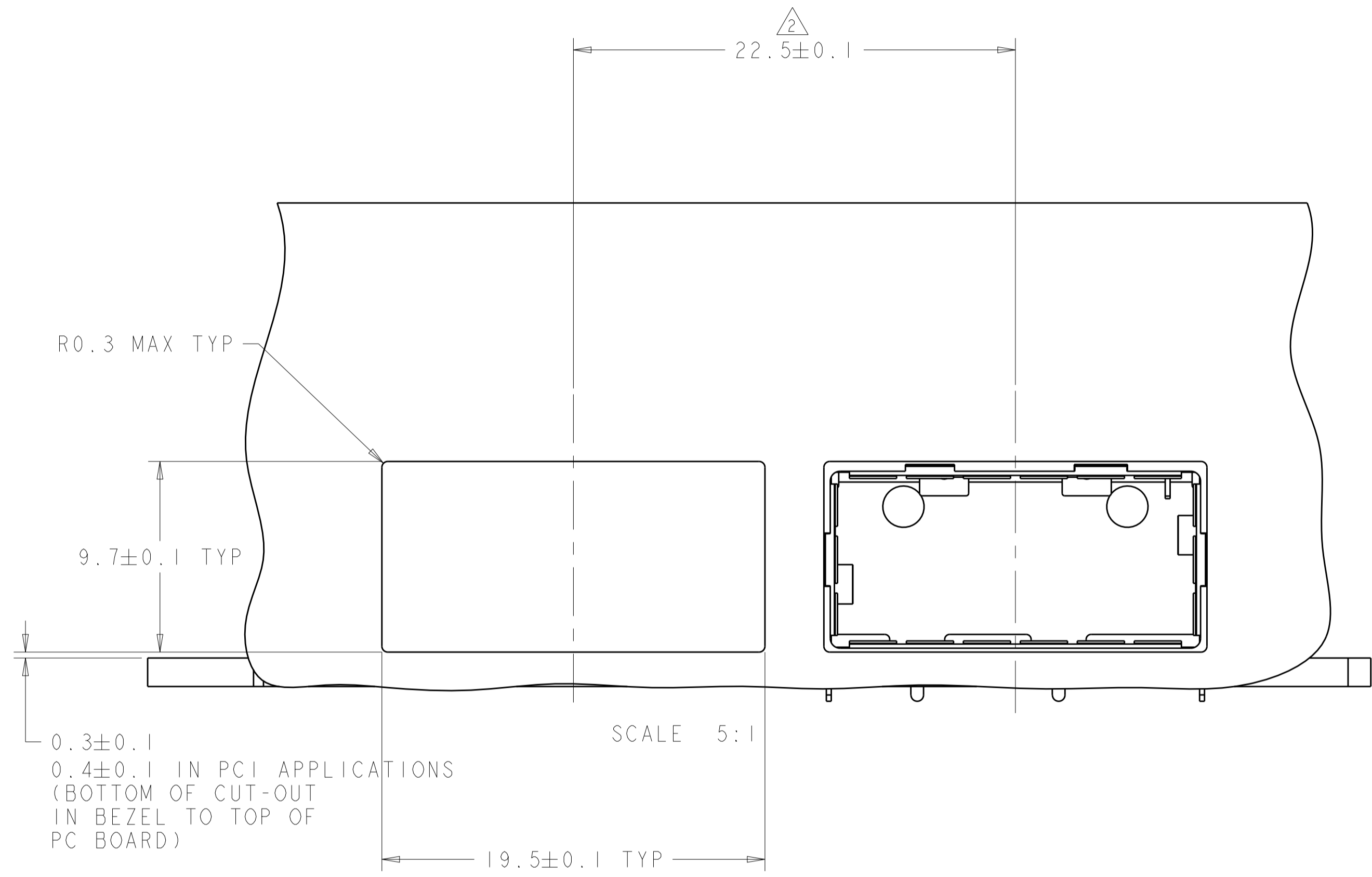

THIS DRAWING IS A CONTROLLED DOCUMENT.		OWN: ROBERT GAN 13SEP2013	TE Connectivity
DIMENSIONS: mm		CHK: JASON YANG 13SEP2013	
TOLERANCES UNLESS OTHERWISE SPECIFIED:		APVD: AILEY CAI 13SEP2013	NAME: CAGE ASSEMBLY, BEHIND BEZEL, QSFP
0 PLC ±	1 PLC ±0.5	PRODUCT SPEC	SIZE: -
2 PLC ±0.13	3 PLC ±0.013	APPLICATION SPEC	CAGE CODE: A100779
4 PLC ±0.0001	ANGLES ±	114-13218	DRAWING NO: C=2170396
MATERIAL: -	FINISH: -	WEIGHT: -	RESTRICTED TO: -
Customer Drawing		SCALE: 2:1	SHEET 2 OF 3
			REV 2

REVISIONS				
P.	LTN.	DESCRIPTION	DATE	APVD.
-	-	SEE SHEET 1	-	-

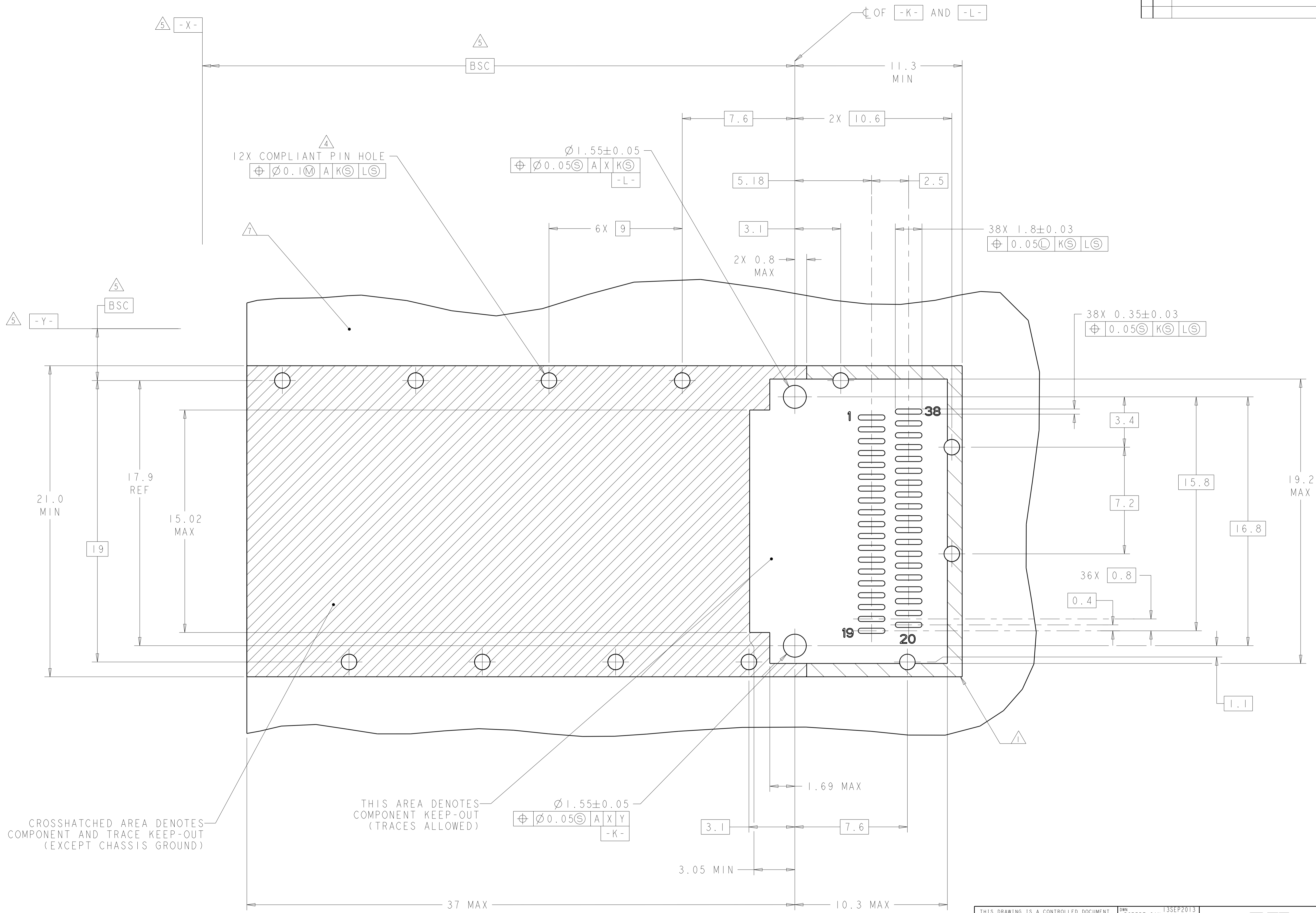

CROSSHATCHED AREA DENOTES COMPONENT AND TRACE KEEP-OUT (EXCEPT CHASSIS GROUND)

THIS AREA DENOTES COMPONENT KEEP-OUT (TRACES ALLOWED)

RECOMMENDED SINGLE-SIDE PC BOARD LAYOUT SCALE 8:1

THIS DRAWING IS A CONTROLLED DOCUMENT.		OWN: ROBERT GAN 13SEP2013	TE Connectivity
DIMENSIONS: mm		CHK: JASON YANG 13SEP2013	
TOLERANCES UNLESS OTHERWISE SPECIFIED:		APVD: AILEY CAI 13SEP2013	NAME: CAGE ASSEMBLY, BEHIND BEZEL, QSFP
0 PLC ±0.5	1 PLC ±0.13	PRODUCT SPEC 108-2286	SIZE: CAGE CODE DRAWING NO. RESTRICTED TO
2 PLC ±0.13	3 PLC ±0.013	APPLICATION SPEC 114-13218	A100779C=2170396
4 PLC ±0.001	ANGLES ±0.0001	WEIGHT	SCALE 2:1 SHEET 3 OF 3 REV 2
MATERIAL	FINISH	Customer Drawing	

单击下面可查看定价，库存，交付和生命周期等信息

[>>TE Connectivity\(泰科\)](#)