

THIS DRAWING IS UNPUBLISHED. RELEASED FOR PUBLICATION
 © COPYRIGHT - BY TYCO ELECTRONICS CORPORATION. ALL RIGHTS RESERVED.

LOC	DIST	REVISIONS					
G	86	P	LTR	DESCRIPTION	DATE	DWN	APVD
		G		ECR-07-024762 (REDRAWN IN AUTOCAD)	08APR08	HMR	JR

- 1 TONGUE MATERIAL THICKNESS: .072±.004.
- 2 BODY - CU PER ASTM B-152
INSERT - BRASS PER ASTM B-36
- 3 BODY - TIN PLATING PER ASTM B-545
INSERT - .000300 MIN EXT. THICK
TIN PLATE PER ASTM B-545

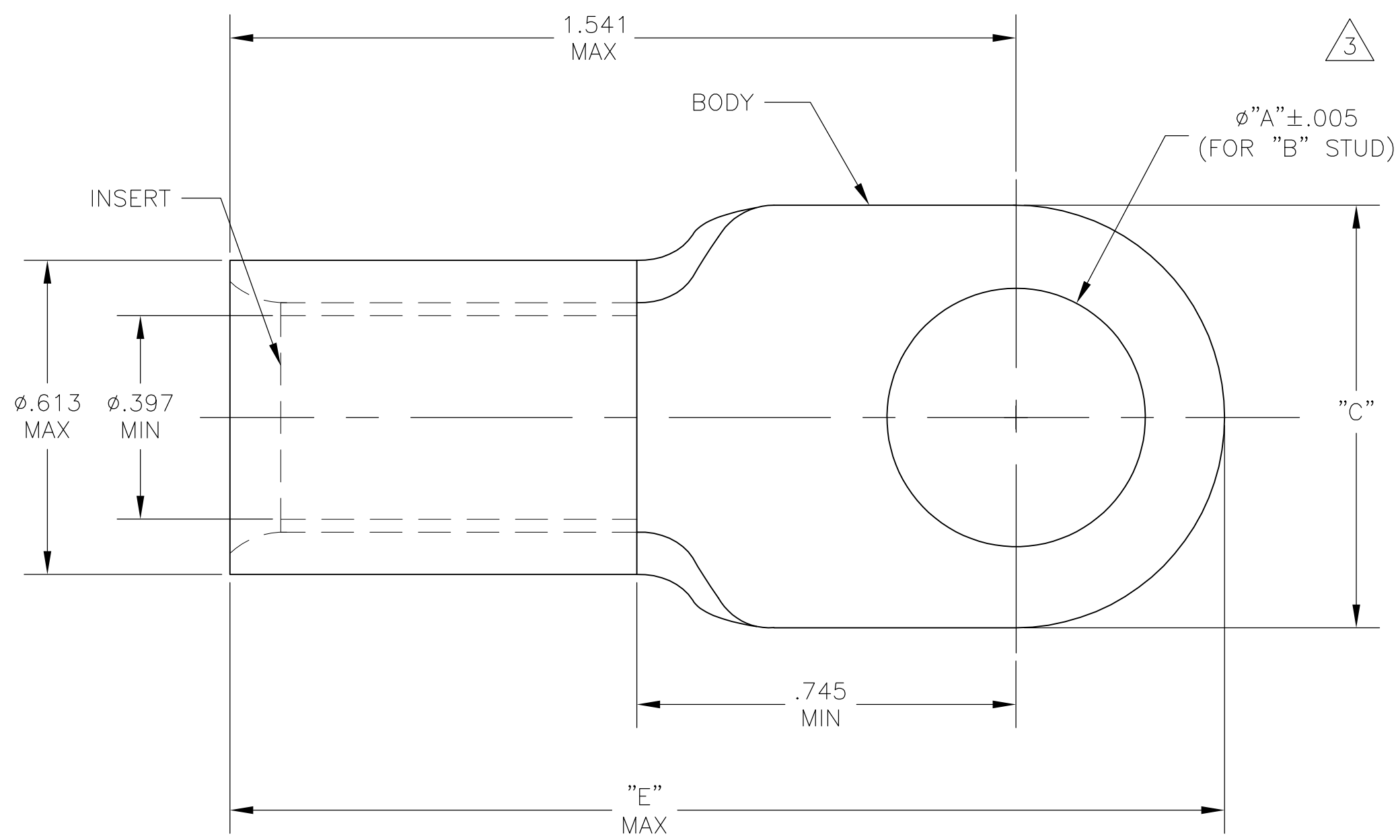

1.925	.807	1/2	.515	51986-3
1.859	.675	3/8	.390	51986-2
1.859	.675	5/16	.328	51986-1
1.859	.675	1/4	.265	51986
"E"	"C"	"B"	"A"	PART NO

1	WIRE TERMINAL	SEE ABOVE TABLE
QTY	DESCRIPTION	PART NO

THIS DRAWING IS A CONTROLLED DOCUMENT.		DWN RAGHAVENDRA 08APR2008	Tyco Electronics Corporation Harrisburg, PA 17105-3608	
DIMENSIONS: INCHES		CHK JEFF RUTH 08APR2008	NAME	
TOLERANCES UNLESS OTHERWISE SPECIFIED:		APVD JEFF RUTH 08APR2008	WIRE TERMINAL COPALUM - STRANDED/SOLID WIRE SIZE 1/0	
0 PLC ± - 1 PLC ± - 2 PLC ± - 3 PLC ± .008 4 PLC ± - ANGLES ± 5°		PRODUCT SPEC -	SIZE A3	CAGE CODE 00779
MATERIAL 2		APPLICATION SPEC -	DRAWING NO G-51986	RESTRICTED TO -
FINISH 3		WEIGHT -	SCALE 4:1 SHEET 1 OF 1 REV G	
CUSTOMER DRAWING				

单击下面可查看定价，库存，交付和生命周期等信息

[>>TE Connectivity\(泰科\)](#)