

THIS DRAWING IS UNPUBLISHED.
 © COPYRIGHT BY TYCO ELECTRONICS CORPORATION. ALL RIGHTS RESERVED.

RELEASED FOR PUBLICATION
 BY TYCO ELECTRONICS CORPORATION.

LOC CM 00

DIST 00
 TP LTR C
 ECO-07-012868

REVISIONS
 DESCRIPTION DATE
 14JUN07 KW DB

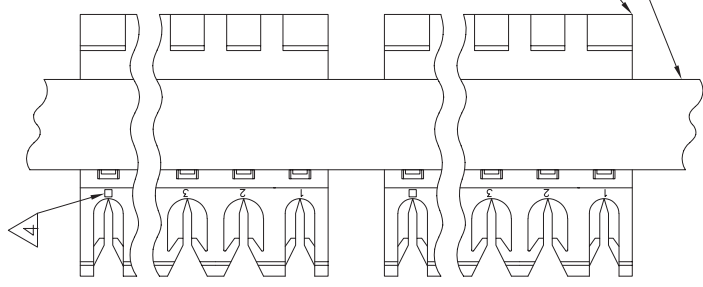

CONNECTOR ASSEMBLY
 TAPE

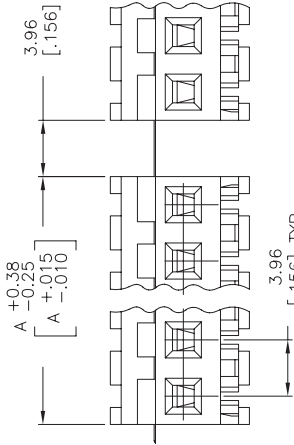
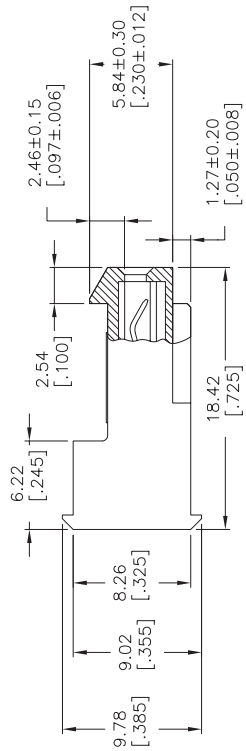

95.10	3.744	24	5-641301-4
91.14	3.588	23	5-641301-3
87.17	3.432	22	5-641301-2
83.21	3.276	21	5-641301-1
79.25	3.120	20	5-641301-0
75.29	2.964	19	4-641301-9
71.32	2.808	18	4-641301-8
67.36	2.652	17	4-641301-7
63.40	2.496	16	4-641301-6
59.44	2.340	15	4-641301-5
55.47	2.184	14	4-641301-4
51.51	2.028	13	4-641301-3
47.55	1.872	12	4-641301-2
43.59	1.716	11	4-641301-1
39.62	1.560	10	4-641301-0
35.66	1.404	9	3-641301-9
31.70	1.248	8	3-641301-8
27.74	1.092	7	3-641301-7
23.77	.936	6	3-641301-6
19.81	.780	5	3-641301-5
15.85	.624	4	3-641301-4
11.89	.468	3	3-641301-3
7.92	.312	2	3-641301-2
95.10	3.744	24	5-641301-4
91.14	3.588	23	5-641301-3
87.17	3.432	22	5-641301-2
83.21	3.276	21	5-641301-1
79.25	3.120	20	5-641301-0
75.29	2.964	19	4-641301-9
71.32	2.808	18	4-641301-8
67.36	2.652	17	4-641301-7
63.40	2.496	16	4-641301-6
59.44	2.340	15	4-641301-5
55.47	2.184	14	4-641301-4
51.51	2.028	13	4-641301-3
47.55	1.872	12	4-641301-2
43.59	1.716	11	4-641301-1
39.62	1.560	10	4-641301-0
35.66	1.404	9	3-641301-9
31.70	1.248	8	3-641301-8
27.74	1.092	7	3-641301-7
23.77	.936	6	3-641301-6
19.81	.780	5	3-641301-5
15.85	.624	4	3-641301-4
11.89	.468	3	3-641301-3
7.92	.312	2	3-641301-2

- CONTACTS ACCEPT 26 AWG WIRE WITH 2.41[.095] MAX INSULATION DIAMETER.
- CONTACTS MUST ACCEPT 1.14±0.03 [.045±.001] SQUARE POST AND REMAIN LOCKED IN POSITION.
- IDENTIFICATION NUMBER FOR LAST CIRCUIT MAY NOT APPEAR ON ALL ASSEMBLIES.
- DIMENSIONS IN BRACKETS ARE IN INCHES.
- HOUSING FEATURES ARE: FEED-THRU WITH LOCKING RAMP.

1 MATERIAL: CONNECTOR - NYLON UL94V-2 (BLUE) CONTACTS - 0.30[.012] THICK COPPER ALLOY BRIGHT TIN-LEAD 0.00203[.000080] MIN THICK FOR CONTACTS 641301-2 THRU 2-641301-4 MATTE WHISKER MITIGATED TIN 0.00203[.000080] MIN THICKNESS OVER NICKEL UNDERPLATE FOR 3-641301-2 THRU 5-641301-4.



THIS DRAWING IS A CONTROLLED DOCUMENT.

DATE	01 MAY 98
BY	B. LEWIS
CHK	C. SWING
APPROVED	D. CLARK
PRODUCT SPEC	108-1051
APPLICATION SPEC	114-1020
WEIGHT	-
CUSTOMER DRAWING	-

SCALE 1:1 SHEET 1 OF 1

TYCO ELECTRONICS
 Tyco Electronics Corporation
 Harrisburg, Pa 17105-3608

MTA-156 CONNECTOR ASSEMBLY,
 26 AWG, STANDARD
 TAPE MOUNTED

SIZE CASE CODE DRAWING NO
 A2 00779 ©=641301

RESTRICTED TO
 -
 -

单击下面可查看定价，库存，交付和生命周期等信息

[>>TE Connectivity\(泰科\)](#)