

LOC	DIST	REVISIONS					
H	-	P	LTR	DESCRIPTION	DATE	DWN	APVD
			C I	REVISED PER ECO-13-011353	12JUL2013	KH	RL

FREQUENCY RANGE	2400-2500 MHz	5150-5875 MHz
GAIN (PEAK)	2.0 dBi	4.0 dBi
V.S.W.R.	<2.0	<2.0
RETURN LOSS.	<10-dB	<10-dB
IMPEDANCE	50Ω	50Ω

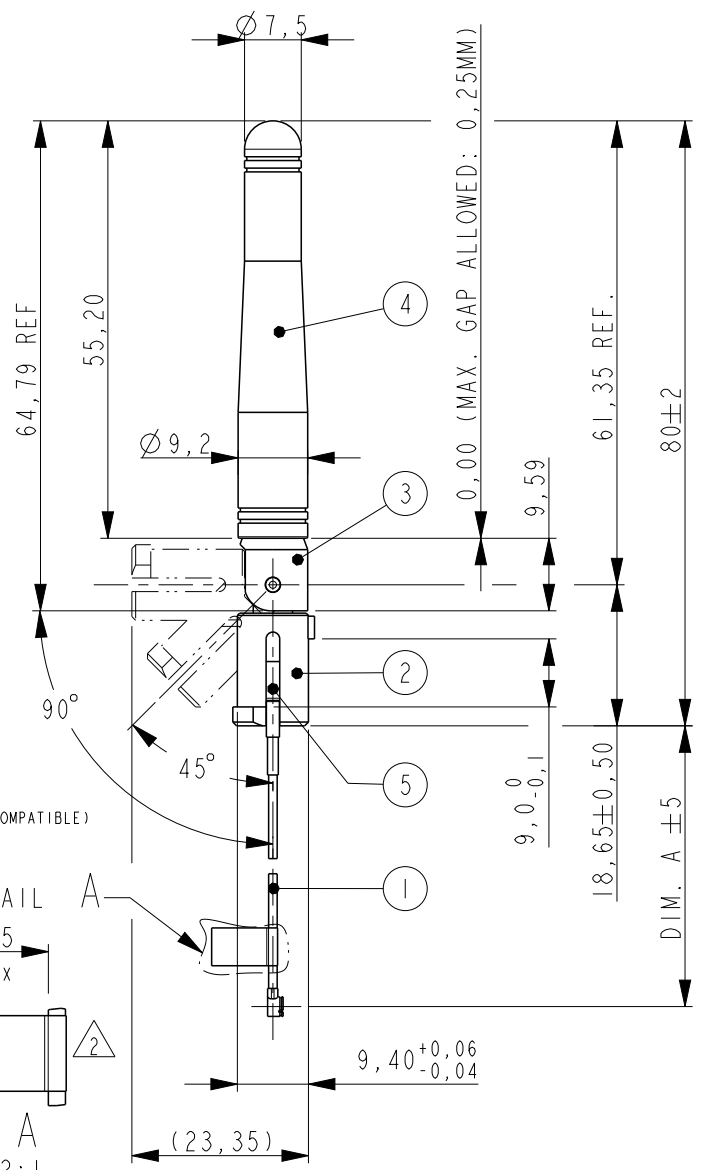

1 FLAMMABILITY: UL94; V-0
 2 LABEL:
 YYWWNN
 YY: YEAR CODE 15 REF
 WW: WEEK CODE
 NN: PRODUCTION LINE CODE

DIM. A (mm)	PART NUMBER			COLOR
	PREFIX	BASE	SUFFIX	
50	0-	2042986	-1	BLACK
100	1-		-2	WHITE
130	2-		-3	LIGHT GREY
150	3-		-4	DARK GREY
190	4-			
200	5-			
250	6-			
225	7-			
90	8-			

CABLE Ø1,13
 UMCC (I-PEX COMPATIBLE)

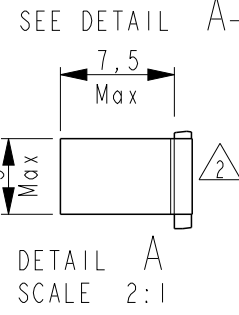

ITEM	NO.	DESCRIPTION	MATERIAL	FINISH	QTY.
5		FERRITE		BLACK	1
4		COVER	PU. TPEE	BLACK	1
3		UPPER BASE	PC. ABS/PC	BLACK	1
2		LOWER BASE	PC. PC/PBT	BLACK	1
1		CABLE	-	Ø1,13	1

EXAMPLE:
 P/N 3-2042986-1 HAS A CABLE LENGTH OF 150mm
 AND A BLACK COLOR.

THIS DRAWING IS UNPUBLISHED. BY - ALL RIGHTS RESERVED. COPYRIGHT -

DIMENSIONS:	DWN	18-Nov-08	MATERIAL	FINISH
mm	J. VOS		-	-
TOLERANCES UNLESS OTHERWISE SPECIFIED:	CHK	18-Nov-08		
0 PLC ±-	R. LOKKER			
1 PLC ±0,1	APVD	-		
2 PLC ±0,05	R. VD. SANDT			
3 PLC ±0,025	PRODUCT SPEC		NAME	EXTERNAL DUAL BAND WLAN ANTENNA
4 PLC ±-	APPLICATION SPEC		SIZE	CAGE CODE
ANGLES ±2°			A 4	00779
	WEIGHT	-	DRAWING NO	RESTRICTED TO
			C=2042986	-
	CUSTOMER DRAWING		SCALE	SHEET OF REV
			1:1	1 OF 1 C I

单击下面可查看定价，库存，交付和生命周期等信息

[>>TE Connectivity\(泰科\)](#)