

THIS DRAWING IS UNPUBLISHED. RELEASED FOR PUBLICATION
 © COPYRIGHT - By - ALL RIGHTS RESERVED.

| LOC | DIST | REVISIONS | | | | | |
|-----|------|-----------|-----|---------------|-----------|-----|------|
| G | 86 | P | LTR | DESCRIPTION | DATE | DWN | APVD |
| | | R | | ECR-13-000998 | 08FEB2013 | PK | HS |

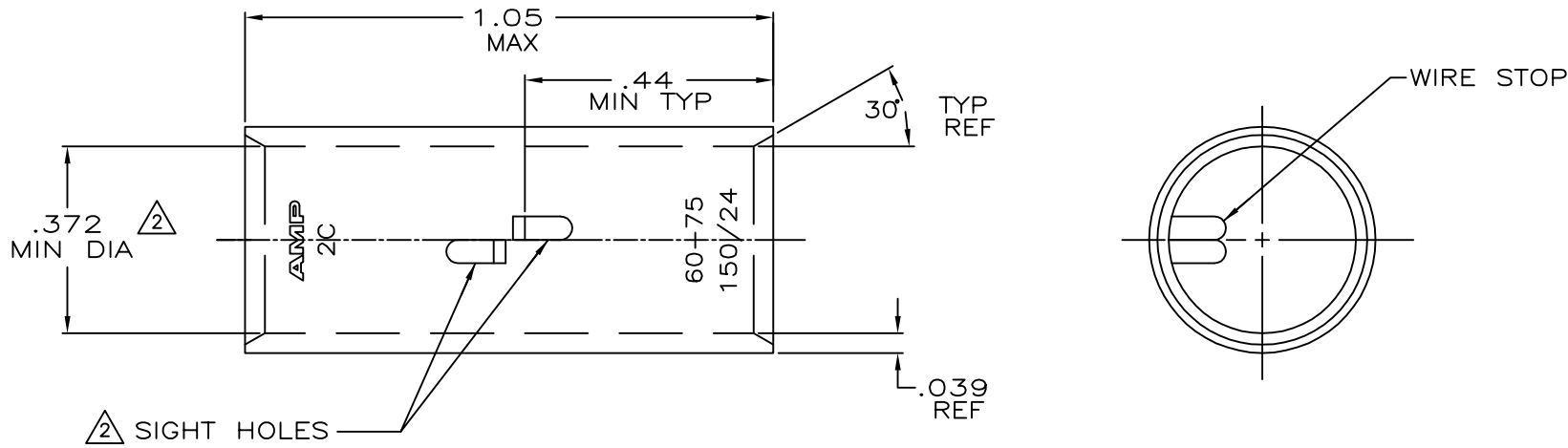

- ① TIN PL .000150 MIN THK PER ASTM B 545
- ② .045 MAX BURR ALLOWED INSIDE THE WIRE BARREL ID IN AREA OF SIGHT HOLE.

| | | | | |
|----------|--------------------|------------------|---------------------------------|-----------------------|
| OBSELETE | CLEANED | 52,600-83,700 CM | COPPER ASTM-B-75 ANNEALED | 1-324457-0 |
| | ① | | | 324457 |
| | FINISH | WIRE RANGE | MATERIAL | PART No |

| | | | | |
|---|--|---------------------------------|--|-----------------|
| THIS DRAWING IS A CONTROLLED DOCUMENT. | | DWN DK SCHRUM 4/24/89 | TE TE Connectivity | |
| DIMENSIONS: INCHES | | CHK MS FEHER 4/24/89 | | |
| TOLERANCES UNLESS OTHERWISE SPECIFIED: | | APVD WJ VOCKROTHC 11/8/89 | NAME SPLICE, BUTT, AMPPOWER WIRE SIZE: 2 AWG | |
| 0 PLC ± - 1 PLC ± - 2 PLC ± - 3 PLC ± - 4 PLC ± - ANGLES ± - | | PRODUCT SPEC | SIZE A3 00779 C=324457 | |
| MATERIAL SEE TABLE | | FINISH SEE TABLE | APPLICATION SPEC | RESTRICTED TO |
| | | WEIGHT .017 LB. | SCALE 4:1 | SHEET 1 OF 1 |
| | | CUSTOMER DRAWING | REV R | |

单击下面可查看定价，库存，交付和生命周期等信息

[>>TE Connectivity\(泰科\)](#)