

DESIGNED FOR USE WITH	.085 S/R
CABLE ENTRY DIAMETER MINIMUM	
HOUSING	.088
CONTACT	.021

REVISIONS			
REV	DESCRIPTION	DATE	APPROVED
03 ₁	REVISED	K.L. 7-24-96	<i>[Signature]</i> 8/7/96
B	REVISED PER 0U20-0262-01	G.V. 12/10/02	JGH

	DIM 'A'
BEFORE CRIMP	.782 REF. 19.9
AFTER CRIMP	.667 ±.010 16.9

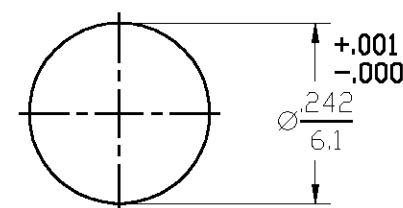

RECOMMENDED MOUNTING HOLE

ELECTRICAL	MECHANICAL	ENVIRONMENTAL
Nominal Impedance (Ohms) 50	Interface Dimensions MIL-STD-348, Fig 321-1	TEMPERATURE RATING -65° TO +125°C
Frequency Range (GHz) DC to 22	Mating Characteristics:	Vibration MIL-STD-202, Method 204, Condition D
Volt Rating (VRMS MAX) @ Sea Level 335	Insertion (MAX Lbs) 3	Shock MIL-STD-202, Method 213, Condition I
VSWR 1.05+.005F(GHz) DC to 18 GHz	Withdrawal (MIN Oz) 1	Thermal Shock MIL-STD-202, Method 107, Condition B
1.05+.009F(GHz) DC to 22 GHz	Force to Engage (In-Lbs MAX) 3 & Disengage (In-Lbs MAX) 1.5	Moisture Resistance MIL-STD-202, Method 106
Insertion Loss (dB MAX) .03x√F(GHz)	Center Contact Captivation Axial (Lbs) 6	Corrosion - MIL-STD-202, Method 101, Condition B
RF Leakage (dB MIN) (Interface Only, Fully Mated) -(90-F(GHz))	Cable Retention Axial Force (Lbs MIN) 30 Torque (In-Oz MIN) 16	
Corona, 70,000 Ft (VRMS MIN) 250	Weight (Grams)	
Dielectric Withstanding Voltage (VRMS MIN) @ Sea Level 1000		
Contact Resistance (Milliohms MAX) Center Contact 2.0 Outer Contact 2.0 Cable to Housing 0.5		
RF High Potential @ Sea Level (VRMS MIN @ 5 MHz) 670		
I.R.(Megohms MIN) 5000		

COMPONENT	MATERIAL	FINISH
HOUSING BUSHING MOUNTING NUT LOCKWASHER	STAINLESS STEEL PER ASTM-A484 AND ASTM-A582, TYPE 303	PASSIVATE PER QQ-P-35
DIELECTRIC	TFE FLUOROCARBON PER ASTM-D-1457	N/A
CENTER CONTACT	BERYLLIUM COPPER PER ASTM-B-196 OR ASTM-B-197, ALLOY C17300, CONDITION H	GOLD PLATE PER MIL-G-45204
O-RING	FLOUROSILOCONE PER MIL-R-25988, CLASS I, TYPE I.	N/A

UNLESS OTHERWISE SPECIFIED DIMENSIONS ARE IN INCHES

FRAC. ± 1/64	DEC. ± .005	ANGLES ± 1'
--------------	-------------	-------------

These drawings and specifications are the property of M/A COM Interconnect Div. and shall not be reproduced or copied or used in whole or in part as the basis for the manufacture or sale of items without written permission.

DRAWN BY D. CAN	DATE 12-10-83		AMP Incorporated 140 Fourth Avenue Waltham, MA 02451-7599
CHECKED BY L.B.	DATE 12-18-83		
APP'D BY RR	DATE 12-19-83		

USE ASS'Y PROCEDURE

NEL AP. 45-028
408-04763

TITLE DSP BULKHEAD FEEDTHRU CABLE PLUG REAR MOUNT-COMPRESSION CRIMP ATTACHMENT			
SIZE B	CODE IDENT NO. 26805	4503-7685-02	REV 03 ₁
SCALE 5:1			SHEET 1 OF 1

.XXX = in
XX.X = mm (REF)

CUSTOMER DRAWING

AMP PART # 1059399-1
SHEET 1 OF 1 REV B

单击下面可查看定价，库存，交付和生命周期等信息

[>>TE Connectivity\(泰科\)](#)