

4

3

2

1

THIS DRAWING IS UNPUBLISHED. RELEASED FOR PUBLICATION
 © COPYRIGHT - TE Connectivity ALL RIGHTS RESERVED.

| REVISIONS | | | | | |
|-----------|-----|---------------------------|-----------|-----|------|
| P | LTR | DESCRIPTION | DATE | DWN | APVD |
| | D | REVISED PER ECO-17-004099 | 30AUG2017 | RS | DR |
| | E | REVISED PER ECO-18-004162 | 06APR2018 | RS | DR |

| | |
|------------------------------|--------------------------|
| AMP WIRE RANGE | E13288 Listed |
| 1/0 AWG SOLID OR STRANDED | 1/0 AWG STRANDED ONLY |

| |
|------------------------------|
| LR7189 Certified |
| 1/0 AWG SOLID OR STRANDED |

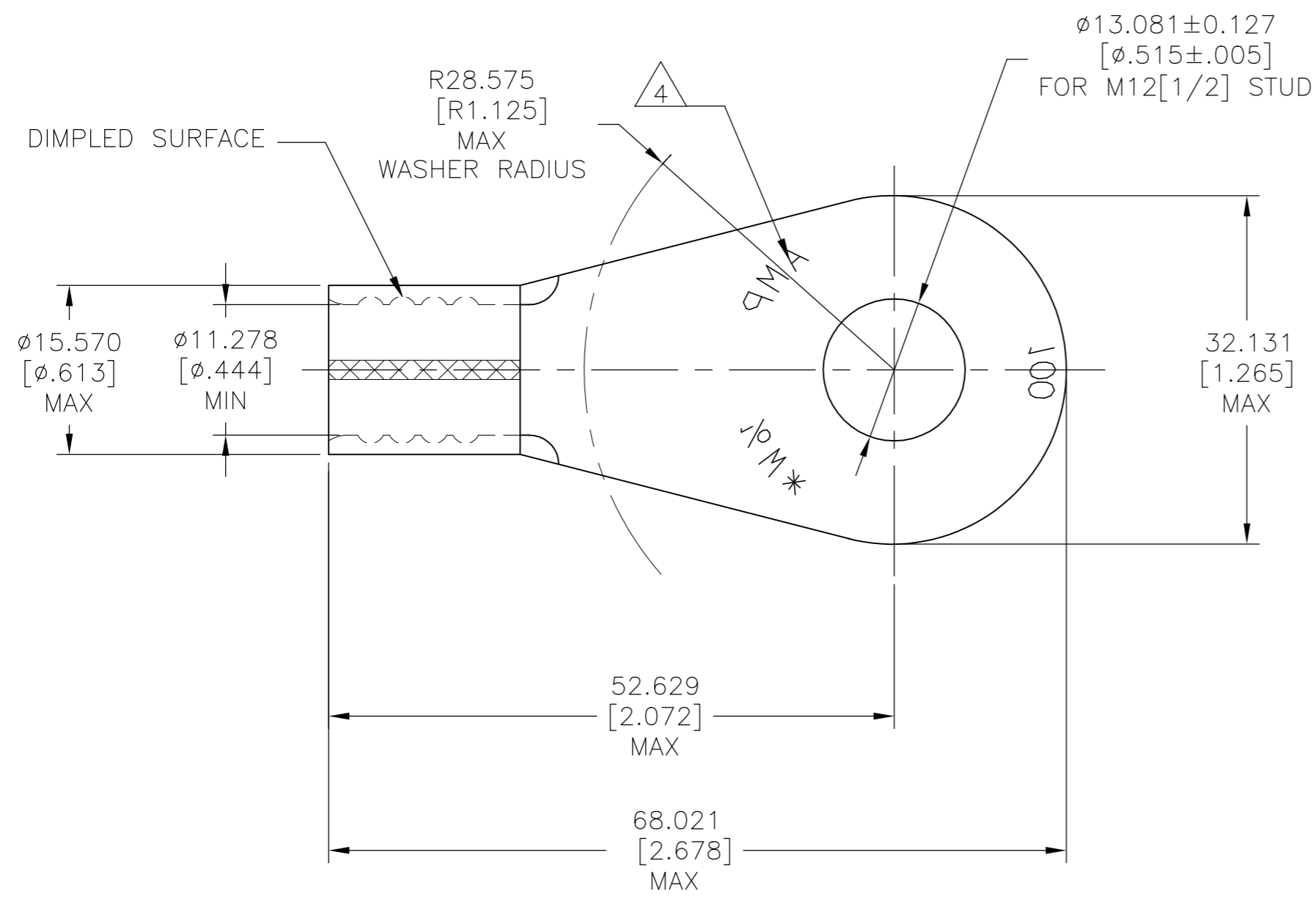

- 1 COPPER PER ASTM B-152, ANNEALED
- 2 TIN PLATE .000100 MIN EXT. THK PER ASTM B-545
- 3 BODY MATERIAL THK IS 1.778 ± 0.076 [.070 ± .003]
- 4 STAMP AMP 1/0 W* APPROX AS SHOWN

| | | |
|-----|--------------|---------|
| 50 | LOOSE PIECE | 322291 |
| QTY | PACKAGE TYPE | PART NO |

AMP INCORPORATED
 CUSTOMER SERVICE SYSTEMS

THIS DRAWING IS A CONTROLLED DOCUMENT.

| | | |
|------|-----------|---------|
| DWN | jr ruth | 07MAY04 |
| CHK | MJ SPICER | 07MAY04 |
| APVD | MJ SPICER | 07MAY04 |

TE Connectivity Ltd.

| | | |
|----------------------------------------------------------------------------------|----------------------------------------------|-------------------------------------------------------------------------------|
| FOR ADDITIONAL PRODUCT INFORMATION OR COPIES OF DRAWINGS AND TECHNICAL DOCUMENTS | PRODUCT INFORMATION CENTER 1-800-522-6752 | MAX RECOMMENDED OPERATING TEMPERATURE: 170°C [338°F] MAX |
| FOR APPLICATION TOOLING INFORMATION | TOOLING ASSISTANCE CENTER 1-800-722-1111 | VOLTAGE RATING: NOT APPLICABLE |
| FOR ORDER ENTRY | 1-800-526-5142 | WIRE CROSS SECTIONAL AREA RANGE, 42.4-60.6mm ² [83,700-119,500] |

| | |
|----------------------------|----------------------------------------|
| DIMENSIONS: mm [INCHES] | TOLERANCES UNLESS OTHERWISE SPECIFIED: |
| | 0 PLC ± - |
| | 1 PLC ± - |
| | 2 PLC ± - |
| | 3 PLC ± 0.127[.005] |
| | 4 PLC ± - |
| | ANGLES ± 5° |
| MATERIAL | FINISH |
| 1 | 2 |

| | |
|------------------|------------|
| PRODUCT SPEC | UL 486 A-B |
| APPLICATION SPEC | - |
| WEIGHT | - |
| CUSTOMER DRAWING | |

| | | | |
|-----------------------------------------------------------------------|-----------|------------|---------------|
| NAME WIRE TERMINAL SOLISTRAND, RING TONGUE WIRE SIZE 1/0 AWG | | | |
| SIZE | CAGE CODE | DRAWING NO | RESTRICTED TO |
| A3 | 00779 | C-322291 | - |
| SCALE | | SHEET | REV |
| 2:1 | | 1 OF 1 | E |

单击下面可查看定价，库存，交付和生命周期等信息

[>>TE Connectivity\(泰科\)](#)