

NUMBER C-172129

METRIC

METRIC

ALL DIMENSIONS IN MM. DO NOT SCALE PRINT

PRINT DIST

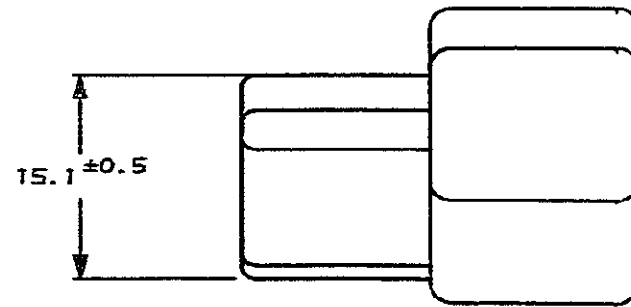
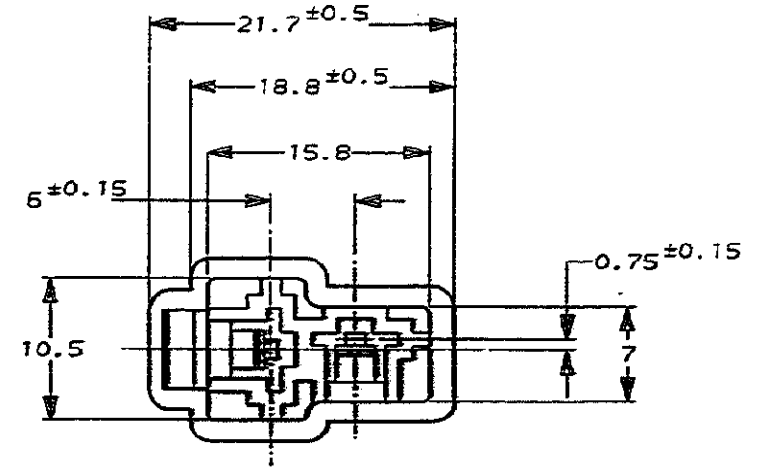
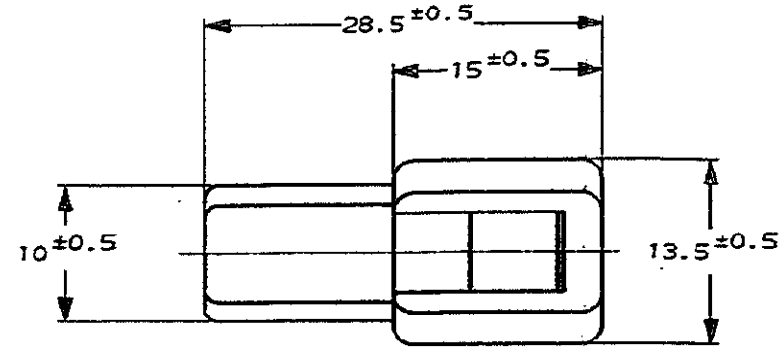
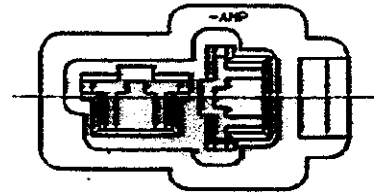

注.

- 1. 嵌合する相手ハウジングは型番172130
- 2. 使用端子は型番170340, 170341, 170349

NOTE.

- 1. THE MATING PLUG HOUSING, P/N 172130
- 2. APPLIED CONTACT, P/N 170340, 170341, 170349

△ OBSOLETE PARTS: OBSOLETE CIS STREAMLINING PER D.RENAUD/D.SINISI

色 (COLOR)	番号 (NUMBER)
淡灰 (LIGHT GRAY)	6-172129-5
自然色 (NATURAL) 94V-0	1-▲-1
赤 (RED)	-9
△ OBSOLETE 橙 (ORANGE)	-8
OBSOLETE YELLOW	7
青 (BLUE)	-5
△ OBSOLETE 緑 (GREEN)	-4
OBSOLETE 茶 (BROWN)	-3
黒 (BLACK)	▼-2
自然色 (NATURAL)	172129-1

STE TE Connectivity

C6	REVISED PER ECR-21-116405	SS	EW	11OCT2023	絶縁電線用被覆線 (WIRE RANGES)	絶縁体 (INSULATION DIA.)	名称 (NAME)	
C5	REVISED PER ECR-19-018127	AA	EW	10AUG20	mm ² (AWG)	mm	"250"シリーズハウジングランスコネクタ2極キャップハウジング	
C4	REVISED PER ECR-17-012979	BDA	TD	11SEP2017	材料 (MATERIAL)	仕上 (FINISH)	"250" SERIES HOUSING LANCE CONNECTOR 2P CAP HOUSING	
C3	REVISED PER ECR-16-015261	RS	TD	28OCT16	6/6 ナイロン (6/6 NYLON)	色: 表参照 (COLOR: SEE TABLE)	一般公差 (GENERAL TOLERANCES)	
C2	REVISED PER ECO-11-005030	RK	HMR	22MAR11	DR. K. Yamada 9/10/23	DE. K. Yamada 9/10/23	10%以下: ±0.2 10%以上 30%以下: ±0.25 30%以上 100%以下: ±0.3 角度: ±3°	
LTR	変更 (REVISION RECORD)	DR	CHK	DATE	CHK. D. Tomita 9/10/23	APR. D. Tomita 9/10/23	LOG 番号 (No.) B J C-172129	
							尺度 (SCALED) 2-1	REV. C6 SHEET 1 OF 1

单击下面可查看定价，库存，交付和生命周期等信息

[>>TE Connectivity\(泰科\)](#)