

European Projection

ZEICHNUNG GÜLTIG AB ...KW...04.1972

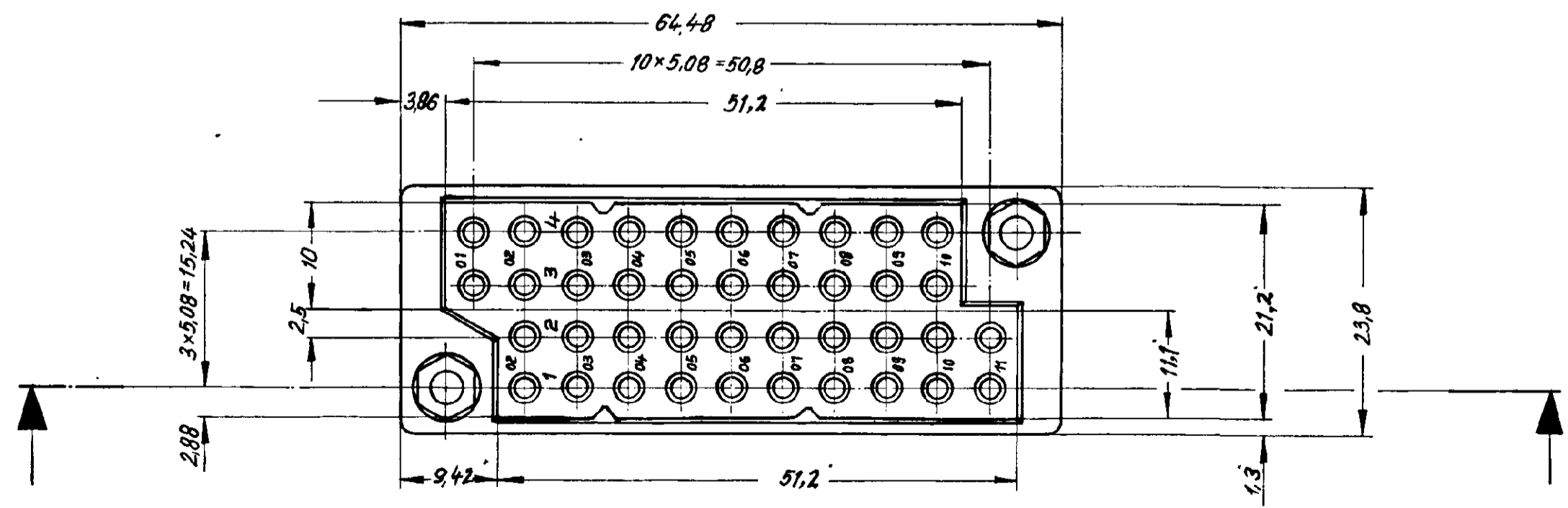
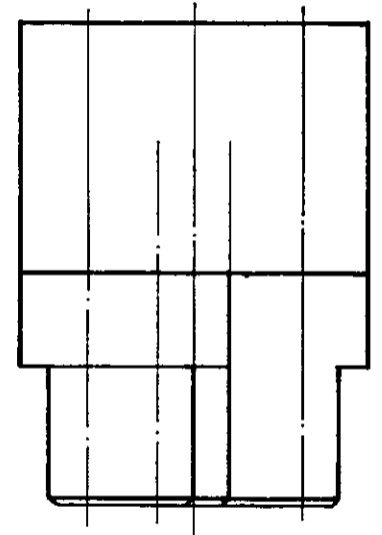
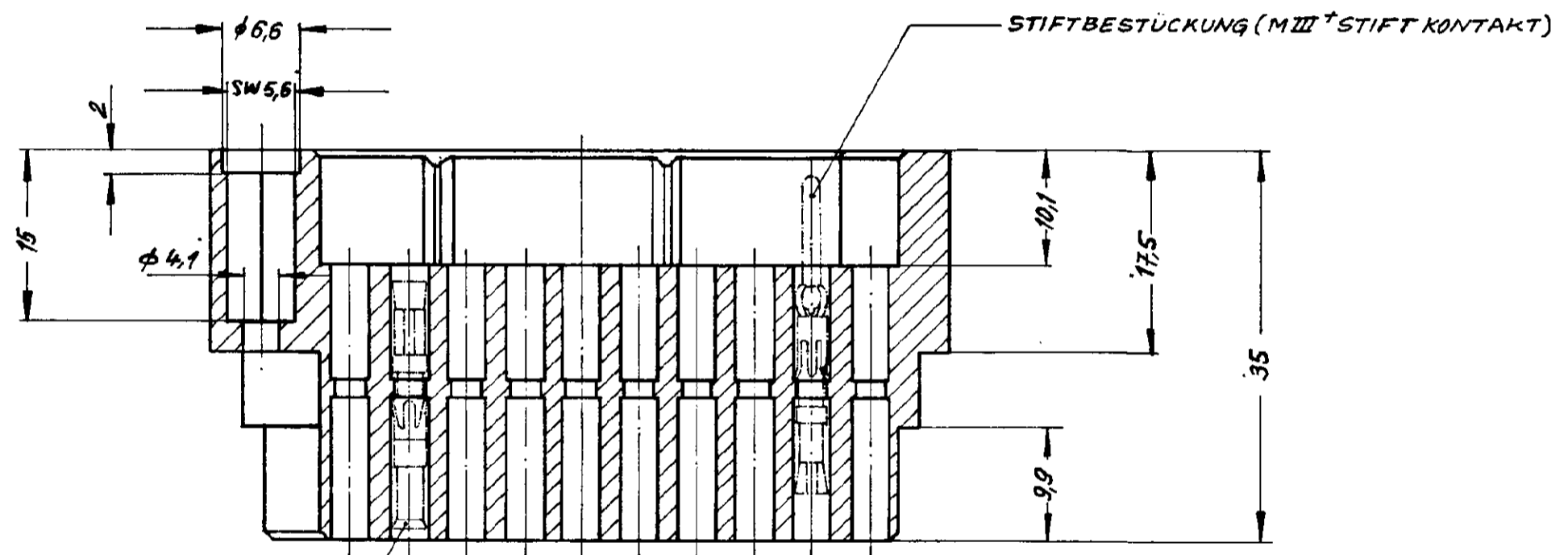
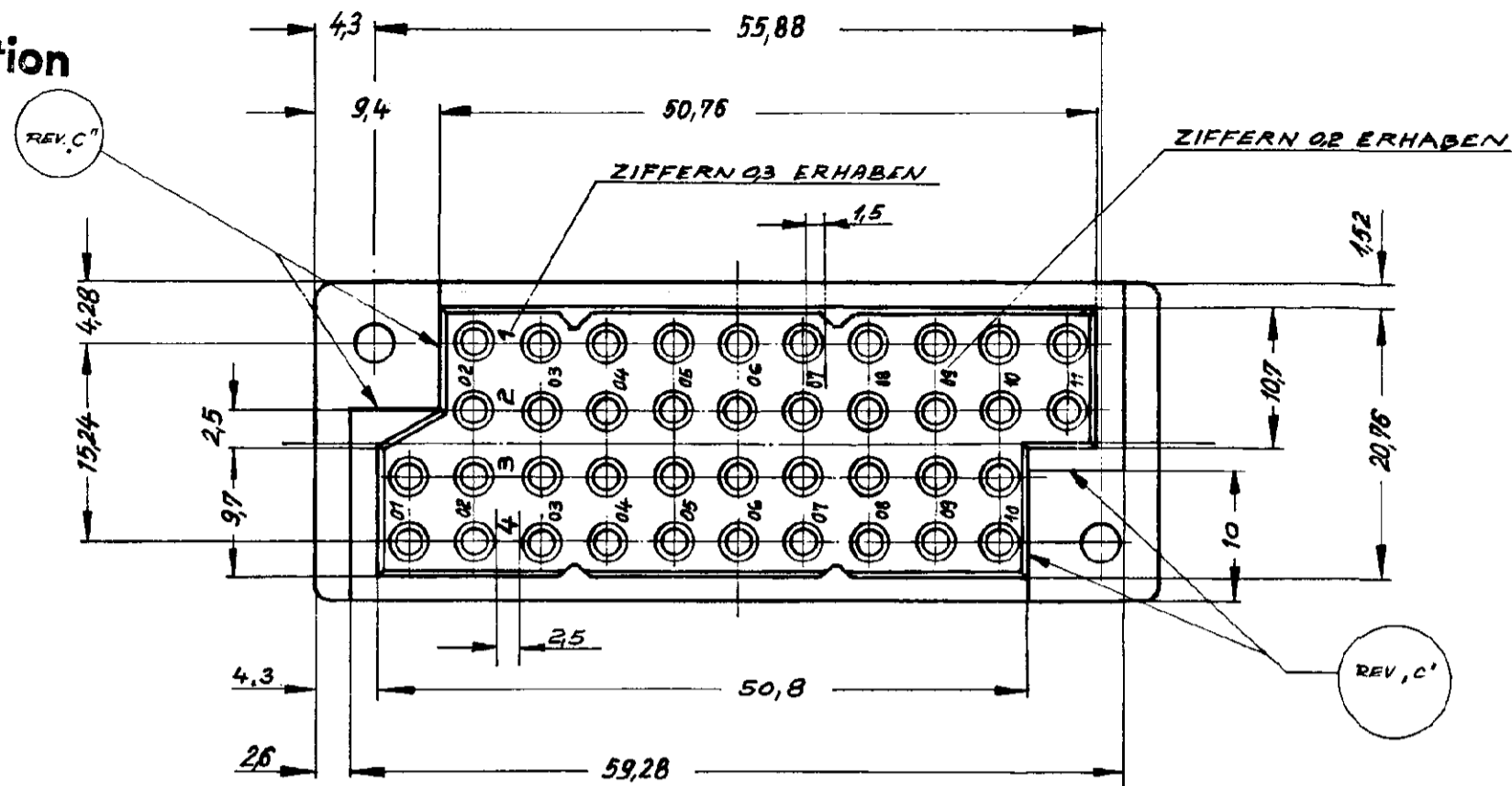

| | | |
|-------------|-------------------|---------|
| 925 256-2 | PA 6.6 25GV (V-0) | SCHWARZ |
| 925 256-1 | PA 30GV | NATUR |
| BESTELL-NR. | WERKSTOFF | FARBE |

CUSTOMER COPY
REFERENCE ONLY

USED ON

72-9245

NOT FURTHER DISCLOSURE IS MADE BY YOU TO OTHER THAN AMP PERSONNEL WITHOUT WRITTEN AUTHORIZATION FROM AMP INCORPORATED, HARRISBURG, PA.

PRINT DIST

| | | | | | | | |
|---|--|---------------------|---|--|-----------------------|--|--|
| 925 256-2 HINBAU FORMER GEW. (M03 8.1 und 8.5 enHaben) M03 4.3 war 4.01, 50.8 war 50.76 M03 - SW 5.6 M03 5.57 4.1 M03 3.12 35 War 35.3; Maximal 17.5 35.3 WRK 34 | | 5.36 174 5.73 | C. F. H. 21.1.72 5.2.72 5.2.72 | DWG SIZE NUMBER NAME ITEM NO. | REQUIRED PER ASSEMBLY | UNLESS OTHERWISE SPECIFIED DR R. L. / 03.1.73 APP CHK REL TERMINAL TYPE FIRST USED SCALE NAME 2:1 | AMP Deutsche AMP G.m.b.H. Langen b. Ffm. Germany LOC G NO C-925256 REV D |
|---|--|---------------------|---|--|-----------------------|--|--|

Buchsengehäuse 40-polig

单击下面可查看定价，库存，交付和生命周期等信息

[>>TE Connectivity\(泰科\)](#)