

4

3

2

1

THIS DRAWING IS UNPUBLISHED. RELEASED FOR PUBLICATION
 © COPYRIGHT - By - ALL RIGHTS RESERVED.

REVISIONS				
P	LTR	DESCRIPTION	DATE	APVD
B1		REVISED PER ECO-14-003208	18MAR2014	NK DR
B2		REVISED PER ECO-17-008806	21FEB2018	RS DR

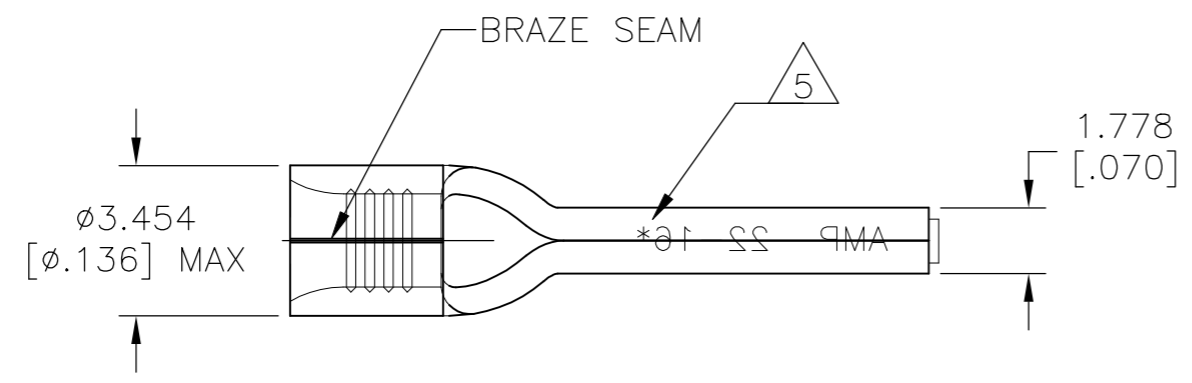

- 1 170°C [338°F] MAXIMUM OPERATING TEMPERATURE
- 2 MATERIAL 0.770±0.051 [0.030±.002] THK
- 3 WIRE CROSS SECTIONAL AREA RANGE:
0.26-1.65mm² [509-3,260 CMA]
SOLID OR STRANDED
- 4 NOTE DELETED
- △5 STAMP AMP 22-16* APPROX AS SHOWN

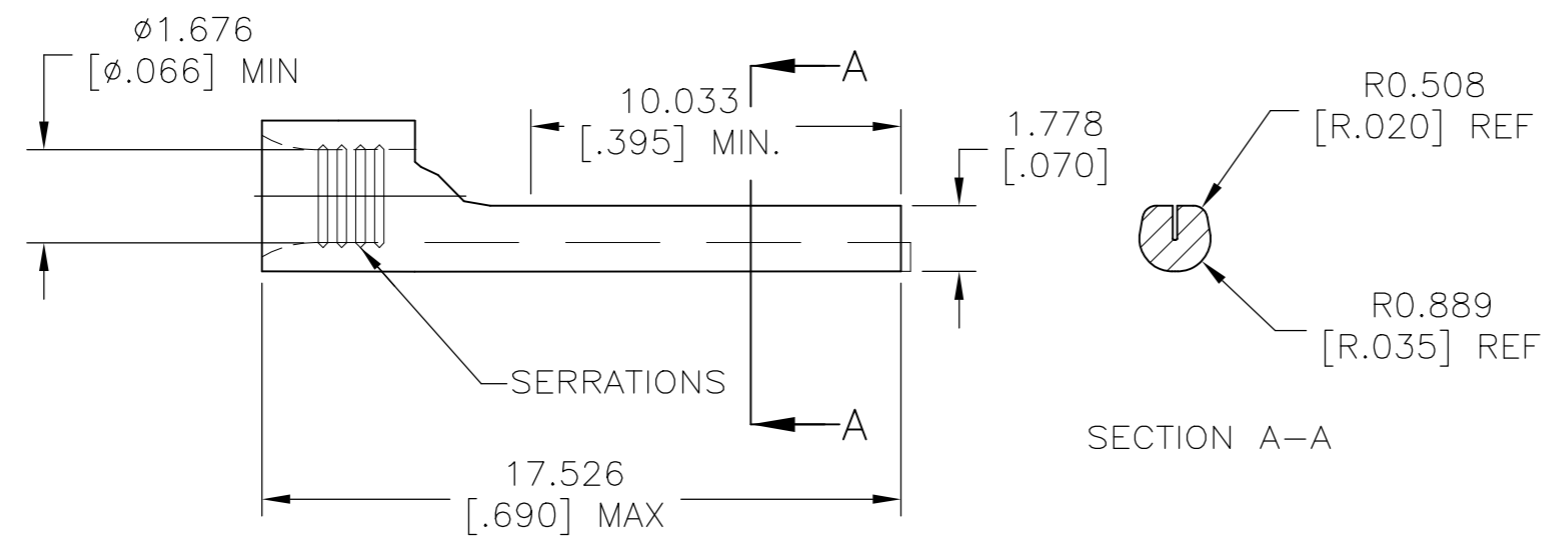

1000	LOOSE PIECE	TIN PLATED PER ASTM B-545 0.00254[.0001] MIN EXT THK	COPPER PER ASTM B-152, ANNEALED	165166
QTY	PACKAGING	FINISH	MATERIAL	PART NO

THIS DRAWING IS A CONTROLLED DOCUMENT.		DWN JR RUTH 04DEC08	TE Connectivity Ltd.	
DIMENSIONS: mm [INCHES]		CHK T MICHIELUTTI 04DEC08		
TOLERANCES UNLESS OTHERWISE SPECIFIED:		APVD T MICHIELUTTI 04DEC08	NAME SOLISTRAND WIRE PIN (LONG) 22-16 AWG	
0 PLC ± - 1 PLC ± - 2 PLC ± - 3 PLC ± 0.127[.005] 4 PLC ± - ANGLES ± -		PRODUCT SPEC -	RESTRICTED TO -	
MATERIAL -		FINISH -	APPLICATION SPEC -	WEIGHT -
		SIZE A3 00779		DRAWING NO C-165166
		CUSTOMER DRAWING		SCALE 5:1
		SHEET 1 OF 1		REV B2

单击下面可查看定价，库存，交付和生命周期等信息

[>>TE Connectivity\(泰科\)](#)