

REVISIONS

P	LTR	DESCRIPTION	DATE	DWN	APVD
F		Contact pin material change back to CuSn	04FEB2020	KJK	PS

POS. PER ROW	L +0.4 -0.7	PART NUMBER
-	-	-
2	5.08	-2
3	7.62	-3
4	10.16	-4
5	12.70	829759-5
6	15.24	-6
7	17.78	-7
8	20.32	-8
9	22.86	-9
10	25.40	1-829759-0
11	27.94	1--1
12	30.48	1--2
13	33.02	1--3
14	35.56	1--4
15	38.10	1--5 $\triangle 2$
16	40.64	1--6
17	43.18	1--7
18	45.72	1--8
19	48.26	1--9
20	50.80	2--0 $\triangle 2$
21	53.34	2--1
22	55.88	2--2
23	58.42	2--3
24	60.96	2--4
25	63.50	2--5
26	66.04	2--6
27	68.58	2--7
28	71.12	2--8
29	73.66	2--9
30	76.20	3-829759-0 $\triangle 2$
31	78.74	3--1
32	81.28	3--2 $\triangle 2$
33	83.82	3--3
34	86.36	3--4
35	88.90	3--5
36	91.44	3--6 $\triangle 2$
37	93.98	3--7
38	96.52	3--8
39	99.06	3--9
40	101.60	4--0
41	104.14	4--1
42	106.68	4--2
43	109.22	4--3
44	111.76	4--4
45	114.30	4--5
46	116.84	4--6
47	119.38	4--7
48	121.92	4--8
49	124.46	4--9
50	127.00	5-829759-0 $\triangle 2$

NOTES:

- $\triangle 1$ MIN 2.5 μ m TIN OVER 1.27 μ m NICKEL
- $\triangle 2$ OBSOLETE PARTS: OBSOLETE CIS STREAMLINING PER D.RENAUD/D.SINISI

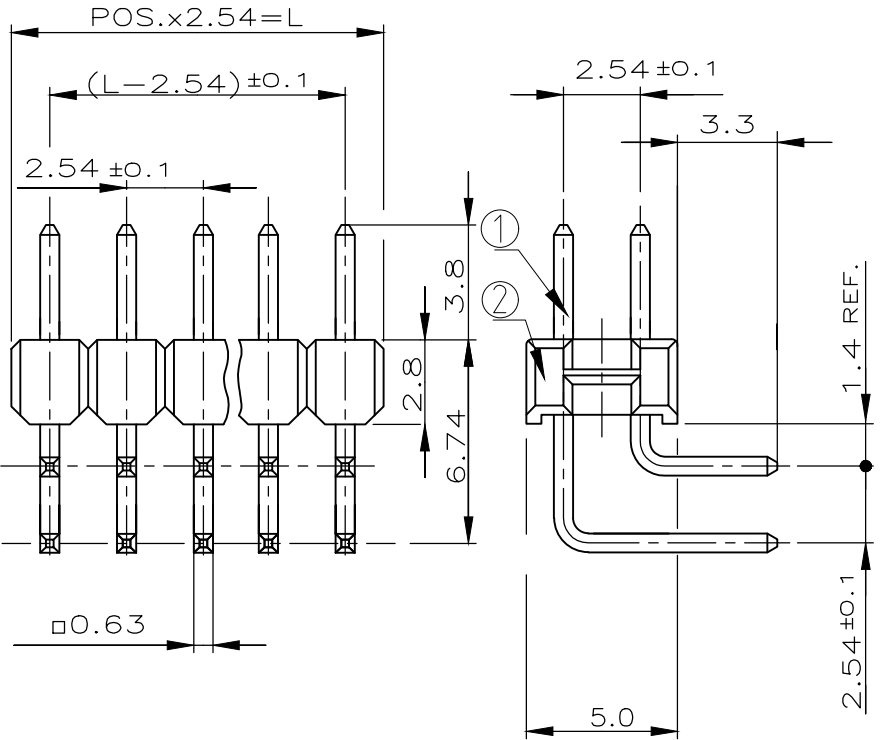

1	CONTACT PIN	CuSn	$\triangle 1$
2	PIN HOUSING	PBT	GREEN
ITEM NUM	DESCRIPTION	MATERIAL	COLOR/FINISH

RELEASED FOR PUBLICATION

ALL RIGHTS RESERVED.

COPYRIGHT - By -

THIS DRAWING IS UNPUBLISHED.

DIMENSIONS:

mm

TOLERANCES UNLESS OTHERWISE SPECIFIED:
 ± 0.2 mm

0 PLC	$\pm -$
1 PLC	$\pm -$
2 PLC	$\pm -$
3 PLC	$\pm -$
4 PLC	$\pm -$
ANGLES	$\pm -$

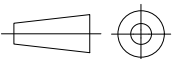

DWN A.HO 14.05.91	MATERIAL SEE TABLE	FINISH SEE NOTE 1
CHK M.SCHAARSCHMIDT 14.05.91	TE Connectivity	
APVD -		
PRODUCT SPEC 108-18012	NAME AMPMODU II PIN HEADER 90 DEG, DUAL ROW	
APPLICATION SPEC -	SIZE A4	CAGE CODE 00779
WEIGHT -	DRAWING NO C-829759	RESTRICTED TO -
CUSTOMER DRAWING		SCALE 4:1
		SHEET 1 OF 1
		REV F

单击下面可查看定价，库存，交付和生命周期等信息

[>>TE Connectivity\(泰科\)](#)