

THIS DRAWING IS UNPUBLISHED. RELEASED FOR PUBLICATION  
 © COPYRIGHT - TE Connectivity ALL RIGHTS RESERVED.

| REVISIONS |     |                           |           |     |      |
|-----------|-----|---------------------------|-----------|-----|------|
| P         | LTR | DESCRIPTION               | DATE      | DWN | APVD |
| B         |     | REVISED PER ECO-16-018096 | 29MAY2017 | RK  | PO   |

SPECIFICATIONS:  
 MAKE-BEFORE-BREAK

MATERIALS:  
 ACTUATOR - NYLON 66 UL94V-0, BLACK  
 FRAME - TIN PLATED STEEL  
 TERMINAL BOARD - PHENOLIC LAMINATE UL94HB, NATURAL  
 TERMINAL (SILVER) - COPPER ALLOY- SILVER OVER NICKEL PLATE  
 TERMINAL (GOLD) - COPPER ALLOY- TIN OVER NICKEL PLATE  
 FIXED CONTACT (SILVER) - COPPER ALLOY- SILVER OVER NICKEL PLATE  
 FIXED CONTACT (GOLD) - COPPER ALLOY-GOLD OVER NICKEL PLATE  
 MOVING CONTACT (SILVER) - COPPER ALLOY- SILVER OVER NICKEL PLATE  
 MOVING CONTACT (GOLD) - COPPER ALLOY-GOLD OVER NICKEL PLATE  
 DETENT BALL - STAINLESS STEEL  
 COIL SPRING - TEMPERED STEEL WIRE  
 SEAL - EPOXY

ELECTRICAL:  
 CONTACT RATING - .4VA@20VDC OR PEAK AC (GOLD)  
 300mA@125V AC (SILVER)  
 INITIAL CONTACT RESISTANCE - 30milliohm max.  
 FINAL CONTACT RESISTANCE - 100milliohm max> (AFTER TEST)  
 INSULATION RESISTANCE - 1,000Megohms min."  
 DIELECTRIC STRENGTH - 500V RMS@SEA LEVEL  
 LIFE EXPECTANCY - 15,000 CYCLES MIN."

MECHANICAL:  
 ACTUATION FORCE - 600±300 GRAMS  
 TRAVEL - 2.00±0.51[.079±.020]

ENVIRONMENTAL:  
 OPERATING TEMPERATURE - -20 TO +85 DEGREES C  
 STORAGE TEMPERATURE - -40 TO +100 DEGREES C  
 RESISTANCE TO SOLDER HEAT PER 109-202, CONDITION B  
 SOLDERABILITY PER EIA- 364-52, CLASS 2, CATEGORY 1, 95% MIN  
 COVERAGE

NOTES:  
 1. ALL MATERIALS AND FINISHES SHALL COMPLY WITH EU  
 DIRECTIVE 2002 95/EC OF 27JAN2003 (ROHS).  
 2. ANTI SOLDER WICK SEAL AT TERMINAL TO BOARD INTERFACE.

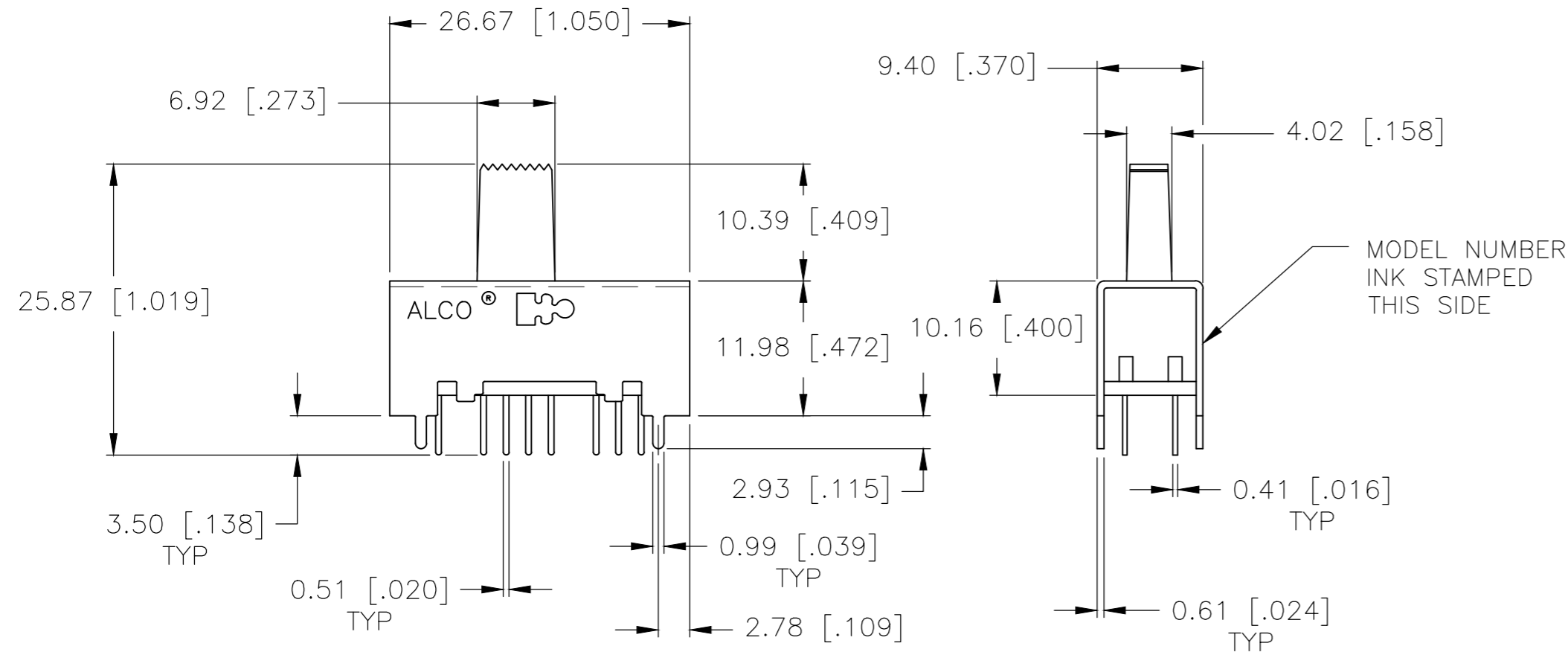
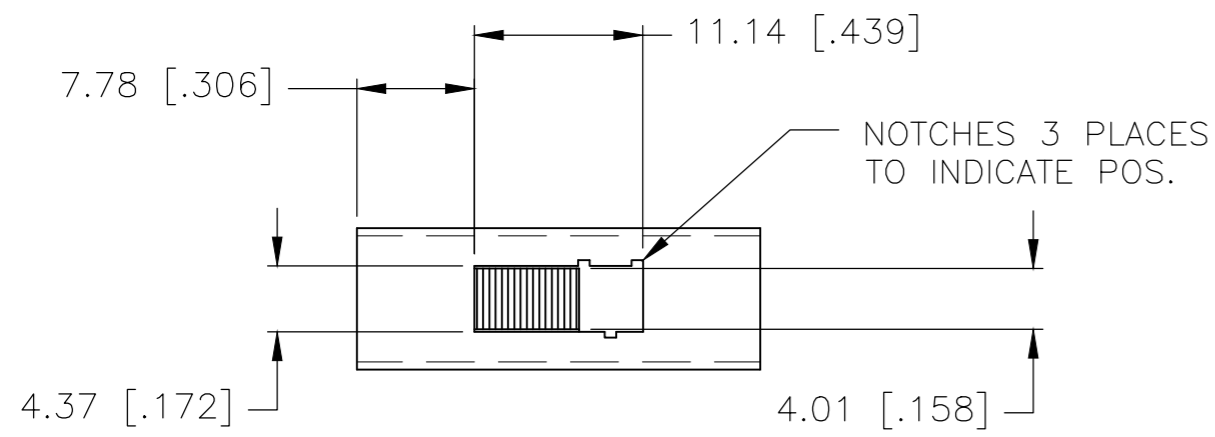

[\*] THIS TERMINAL SET IS NOT USED ON 3350 SERIES

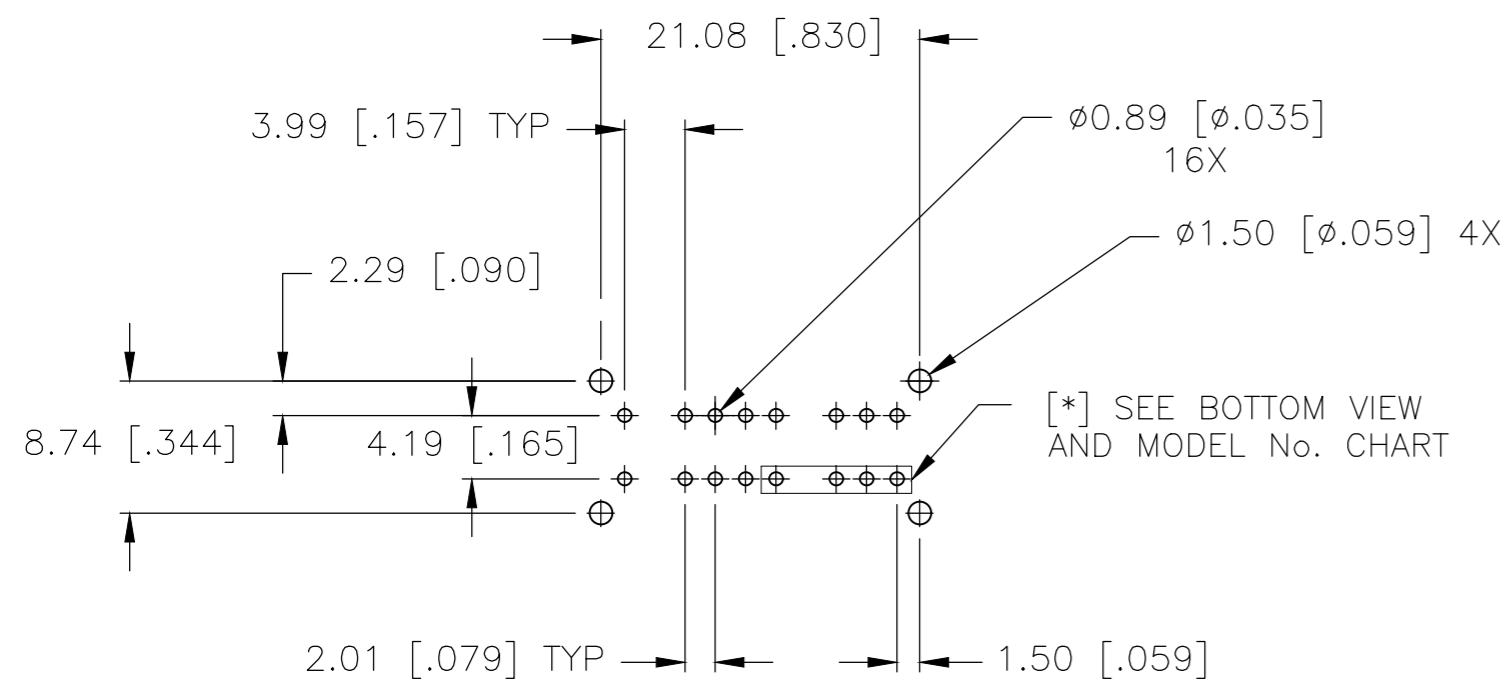
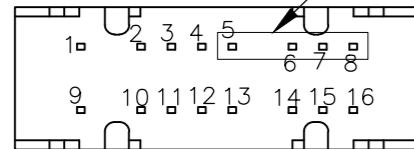

PC HOLE LAYOUT (TOP VIEW)  
 RECOMMENDED TOLERANCES ±.002

|          |                   |            |                  |             |                  |             |      |                  |             |            |  |
|----------|-------------------|------------|------------------|-------------|------------------|-------------|------|------------------|-------------|------------|--|
|          | 1,2&5,6           | 9,10&13,14 | 2,3&5,7          | 10,11&13,15 | 2,4&5,8          | 10,12&13,16 | 4P3T | GOLD OVER NICKEL | MSSA4350G04 | 1825202-4  |  |
|          | 1,2&5,6           | 9,10&13,14 | 2,3&5,7          | 10,11&13,15 | 2,4&5,8          | 10,12&13,16 | 4P3T | SILVER           | MSSA435004  | 1825202-3  |  |
| OBSOLETE | 1,2, 9,10         | &13,14     | 2,3, 10,11&13,15 |             | 2,4, 10,12&13,16 |             | 3P3T | GOLD OVER NICKEL | MSSA3350G04 | *1825202-2 |  |
|          | 1,2, 9,10         | &13,14     | 2,3, 10,11&13,15 |             | 2,4, 10,12&13,16 |             | 3P3T | SILVER           | MSSA335004  | *1825202-1 |  |
|          | LEFT              |            | CENTER           |             | RIGHT            |             | TYPE | CONTACT PLATING  | ALCO P/N    | TE P/N     |  |
|          | ACTUATOR POSITION |            |                  |             |                  |             |      |                  |             |            |  |

|  |  |                  |            |         |                 |           |
|--|--|------------------|------------|---------|-----------------|-----------|
| THIS DRAWING IS A CONTROLLED DOCUMENT. |  | DWN              | C.THEODORE | 17SEP96 | TE Connectivity |           |
| DIMENSIONS: mm [INCHES]                |  | CHK              | -          | -       | NAME            |           |
| TOLERANCES UNLESS OTHERWISE SPECIFIED: |  | APVD             | -          | -       | OUTLINE DRAWING |           |
| 0 PLC ± -                              |  | PRODUCT SPEC     | -          | -       | SLIDE SWITCH    |           |
| 1 PLC ± -                              |  | APPLICATION SPEC | -          | -       | 3 POSITION PC   |           |
| 2 PLC ± 0.25[.010]                     |  | WEIGHT           | -          | -       | SIZE            | CAGE CODE |
| 3 PLC ± -                              |  | CUSTOMER DRAWING | -          | -       | A2              | 00779     |
| 4 PLC ± -                              |  | SCALE            | 2:1        | SHEET   | 1 of 1          | REV       |
| ANGLES ± 1°                            |  | RESTRICTED TO    | -          | -       | -               | B         |
| FINISH                                 |  | DRAWING NO       |            |         |                 |           |
| SEE SPECIFICATIONS                     |  | C=1825202        |            |         |                 |           |

单击下面可查看定价，库存，交付和生命周期等信息

[>>TE Connectivity\(泰科\)](#)