

- a. Part as supplied
A Dust Cap will also be supplied with this part.

207W264

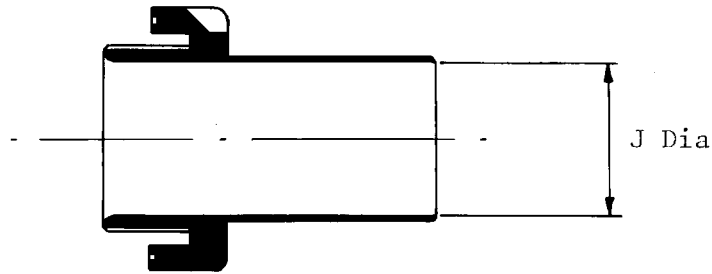

- b. Part after unrestricted recovery

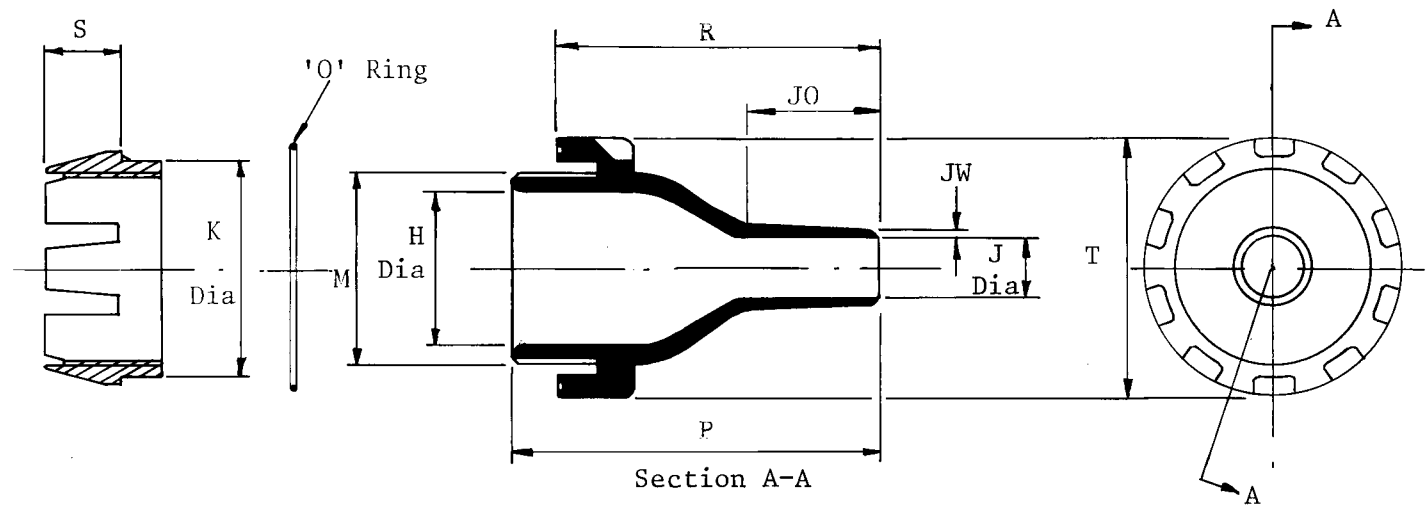

Dimensions (in millimetres)

Part Number	H ref	J		JO Max	K ref	M Thread ref	P +10%	R +10%	S +10%	T ref	JW +20%	Hole Dia +0,5
	b	Min a	Max b	Max b	b	b	b	b	b	b	b	b
207W264	40	38	15	28,3	54	50	95	82	18	66,5	2,5	55

Drawn by L.Ellis

Issued by L.Ellis

Checked by *AW*

Approved by

Design *AW*

MKT *APS*

QC *DR*

Issue 3

Date

October

1983

Ordering Information

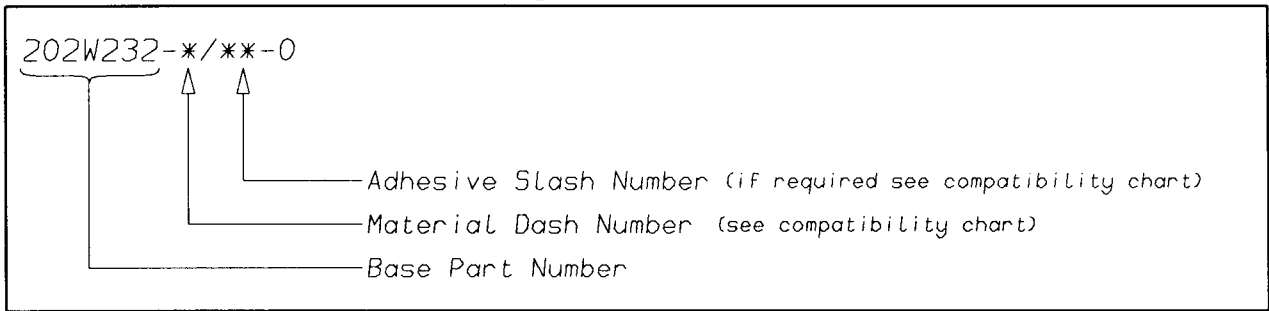

COMPATIBILITY CHART

MATERIAL DASH NUMBER	MATERIAL DESCRIPTION	COATING SLASH NUMBER
-3	POLYOLEFIN, SEMI-RIGID	/42, /86
-4	POLYOLEFIN, FLEXIBLE	/42, /86
-25	ELASTOMER, FLUID RESISTANT	/86, /225

AS SUPPLIED DIMENSIONS ARE FOR UNCOATED PARTS,
WHEN COATING IS ADDED, ENTRY DIAMETERS WILL REDUCE BY 1.5mm MAX.

POTTING PORTS ARE OPTIONAL
WHEN SPECIFIED BY SUFFIX "-00"
THEY WILL BE LOCATED AS SHOWN

Raychem
Electronics OEM Division Europe
Swindon, Wiltshire, England.
Telephone: (01793) 528171 Fax: 573923

单击下面可查看定价，库存，交付和生命周期等信息

[>>TE Connectivity\(泰科\)](#)