

NUMBER C-179464

三角度 (3-ANGLE PROJECTION)

METRIC

PRINT DIM. DIMENSIONS IN MM. DO NOT SCALE PRINT

注:

1. 通用製品規格: 108-5410
 2. 通用コンタクト型番
タブ・コンタクト: 177917-□ (#20-#16AWG)
177916-□ (#26-#22AWG)
 3. 嵌合相手側製品型番
プラグ・ハウジング: 177899-□
リセ・コンタクト: 177915-□ (#20-#16AWG)
177914-□ (#26-#22AWG)
 4. 通用プレート型番: 177919-□
 5. 取扱説明書: 411-5638
- 表1参照
8. PART 5-179464-1 COMPLY WITH GLOW WIRE REQUIREMENT FOR PARTS OF NON-METALLIC MATERIAL SUPPORTING A CURRENT-CARRYING CONNECTION DETAILED IN IEC 60335-1, SECTION 30 (GWT)
 9. APPLICATION SPEC: 114-5175



表1 (TABLE 1)

トレードマーク (TRADE MARK)	生産場所 (MANUFACTURING PLACE)
— AMP OR AMP	日本 (JAPAN)
—+ AMP OR AMP	中国 (CHINA(PO))
· AMP OR AMP	韓国 (KOREA)



断面 "A"- "A"
(SECT)

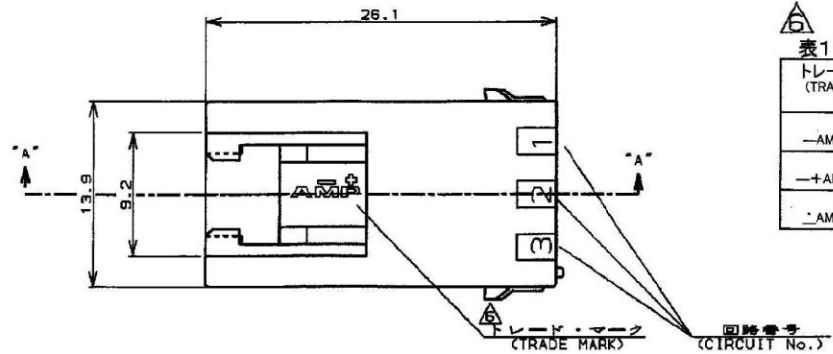
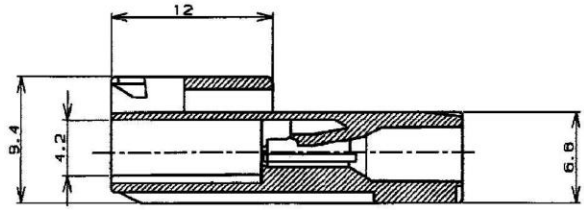
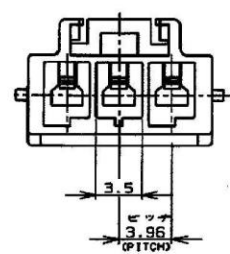
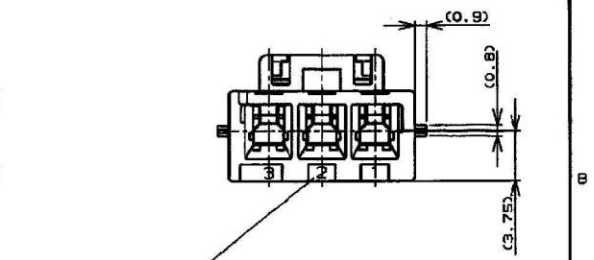

回路番号
(CIRCUIT No.)

NOTES,

1. PRODUCT SPEC, 108-5410
2. APPLICABLE CONTACT P/N
TAB CONTACT: 177917-□ (#20-#16AWG)
177916-□ (#26-#22AWG)
3. MATING CONN. P/N
PLUG H56: 177899-□
REC CONTACT: 177915-□ (#20-#16AWG)
177914-□ (#26-#22AWG)
4. APPLICABLE PLATE P/N: 177919-□
5. INSTRUCTION SHEET: 411-5638
- △ SEE TABLE 1
7. ALL PARTS MEET RTI ELECTRICAL RATING OF 105C ACCORDING TO UL 1977

自然色 (NATURAL)	3	5-179464-1
黒 (BLACK)	↑	↑ -9
青 (BLUE)	↑	↑ -6
黄 (YELLOW)	↑	↑ -4
赤 (RED)	↓	↓ -2
自然色 (NATURAL)	3	179464-1
ハウジング色調 係数	型番	
(HOUSING COLOR) (Pos.)	(P/N)	

STE TE Connectivity

C4	REVISED PER ECR-19-017851	SM	DZ	21NOV 2019	TYPE 14	DR. 23. MAR. '94	DE. 23. MAR. '94	100μT: ±0.2	SIZE	LOC	番号 (No.)
C3	REVISED PER ECR-14-001994	A. Z	D. Z	11FEB 2014	TYPE 14	DR. 23. MAR. '94	DE. 23. MAR. '94	100μT: ±0.25	A3	J	C-179464
C2	REVISED PER ECR-12-013854	A. Z	F. M	02AUG 2012	TYPE 12	DR. 25. MAR. '94	APP. 25. MAR. '94	300μT: ±0.3	尺度 (SCALE)	REV.	SHEET
C1	REVISED PER ECO-11-005140	RK	HMR	01MAR 2011	TYPE 11	DR. 25. MAR. '94	APP. 25. MAR. '94	尺度: ±3°	C4		1 OF 1
LTR	変更 (REVISION RECORD)	DR	CHK	DATE		CHK. M. SHINDO	APP. Y. KASHIWA				

CUSTOMER DRAWING

单击下面可查看定价，库存，交付和生命周期等信息

[>>TE Connectivity\(泰科\)](#)