

THIS DRAWING IS UNPUBLISHED. RELEASED FOR PUBLICATION
 © COPYRIGHT - By - ALL RIGHTS RESERVED.

REVISIONS					
P	LTR	DESCRIPTION	DATE	DWN	APVD
A4		REVISED PER ECR-18-018655	11DEC2018	BW	SV

- 1 CONTINUOUS STRIP ON REELS WITH TERMINALS LOCATED ON 5.59±0.08 [.220±.003] CENTERS.
- 2 SLOT ACCEPTS A SINGLE OR DOUBLE 0.36-0.57mm [#27-#23] AWG COPPER MAGNET WIRE OR SLOT ACCEPTS A SINGLE OR DOUBLE 0.51-0.64mm [#24-#22] AWG ALUMINUM MAGNET WIRE. ALUMINUM WIRE RANGE APPLIES FOR POST-TIN PLATED VERSIONS ONLY.
- 3 AFTER INSERTION INTO PLASTIC HOLDER TAB PORTION MUST BE BENT OVER 45° TO 90° OR POTTED TO PREVENT PULL-OUT WHEN MATING RECEPTACLE IS DISCONNECTED.
- 4 PRELIMINARY - NOT FOR PRODUCTION.

IDENTIFICATION NUMBER 10 FOR MAGNET WIRE RANGE

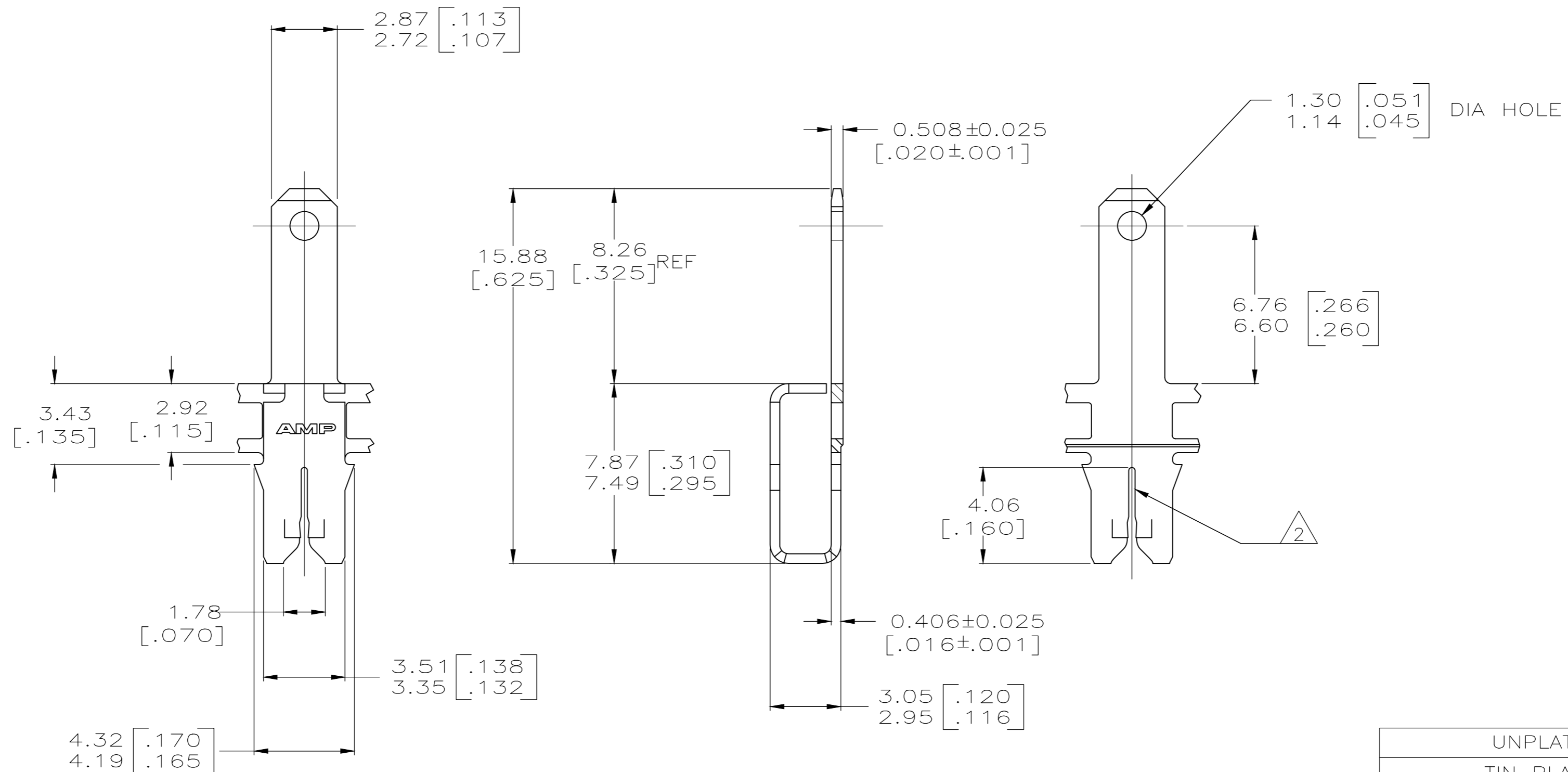
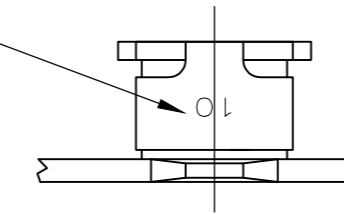

UNPLATED	4 63746-2
TIN PLATED	63746-1
FINISH	PART NO

THIS DRAWING IS A CONTROLLED DOCUMENT.		DWN 11/JAN/94 MICHAEL S. FEHER	STE TE Connectivity Ltd.	
DIMENSIONS: mm [INCHES]		CHK 13/JAN/94 PHILLIP M. FORTNEY		
TOLERANCES UNLESS OTHERWISE SPECIFIED:		APVD 14/JAN/94 NELSON E. NEFF	NAME TAB, 2.79 [.110] FASTON™ MAG-MATE™	
0 PLC ± -	1 PLC ± -	PRODUCT SPEC 108-2012	SIZE A2	CAGE CODE 00779
2 PLC ± 0.25 [.010]	3 PLC ± -	APPLICATION SPEC 114-2046	DRAWING NO C=63746	RESTRICTED TO -
4 PLC ± -	ANGLES ± -	MATERIAL BRASS	WEIGHT -	SCALE 6:1
FINISH SEE TABLE		CUSTOMER DRAWING		SHEET 1 of 1 REV A4

单击下面可查看定价，库存，交付和生命周期等信息

[>>TE Connectivity\(泰科\)](#)