

REVISIONS		
LTR	DESCRIPTION	DATE
A	INITIAL RELEASE PER ECO-09-007066	03/20/2009

NOTES

- ALL DIMENSIONS ARE IN INCHES
[MILLIMETERS]
- DIMENSIONS APPEARING IN TABLE ARE AS FOLLOWS:
a - AS SUPPLIED
b - AFTER UNRESTRICTED RECOVERY
- COATING (ADHESIVE): IS OPTIONAL AS SUPPLIED DIMENSIONS APPEARING IN TABLE ARE FOR UNCOATED PARTS. WHEN COATING IS ADDED, ENTRY DIAMETER WILL BE REDUCED BY .06 MAX.
- "S" AND "T" DIMENSIONS APPLY TO A MINIMUM OF 240° OF THE CIRCUMFERENCE
- ORDERING INFORMATION:

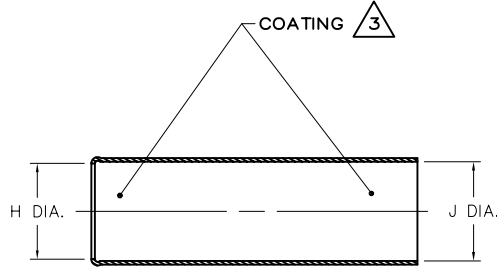

AS SUPPLIED

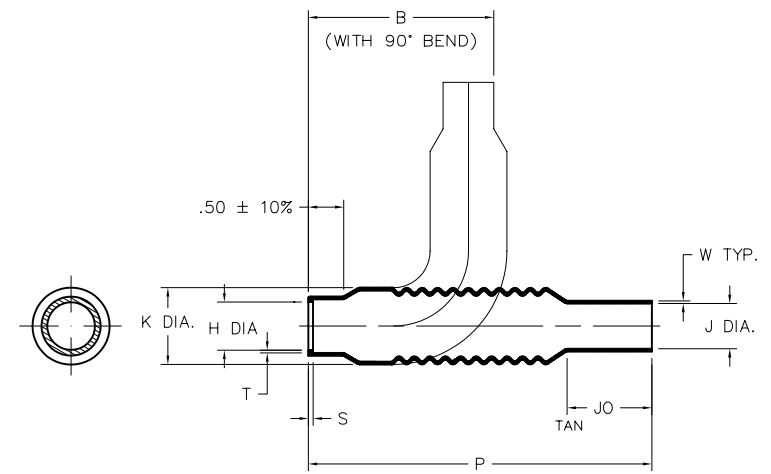

AFTER UNRESTRICTED RECOVERY

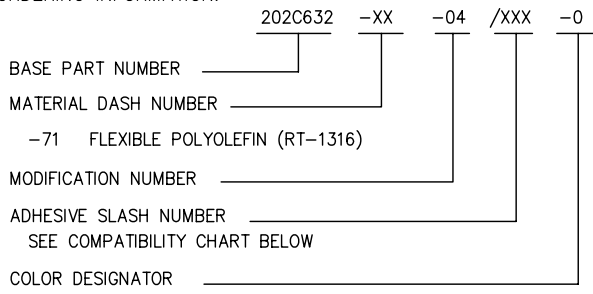

TABLE OF DIMENSIONS											
PART DESCRIPTION	H		J		K MAX b	P ±10% b	JO ±10% b	S ±.03 b	T ±.03 b	W MIN b	B REF b
	MIN a	MAX b	MIN a	MAX b							
202C632-XX-04	1.70 [43,2]	.69 [17,5]	1.70 [43,2]	.50 [12,7]	1.29 [32,8]	5.75 [146,1]	.88 [22,4]	.07 [1,78]	.05 [1,27]	.02 [0,51]	2.89 [73,4]

If this document is printed it becomes uncontrolled. Check for the latest revision

CUSTOMER DRAWING

COMPATIBILITY CHART

MATERIAL DASH NO.	ADHESIVE (COATING) SLASH NO.	ADHESIVE (COATING) S NO.
-71	/42; /86; /180	S-1017; S-1048; S-1030

UNLESS OTHERWISE SPECIFIED DIMENSIONS ARE INCHES. METRIC DIMENSIONS ARE IN BRACKETS.
 DECIMAL TOLERANCES
 .XXX ± 0.005 [0.13 mm]
 .XX ± 0.01 [0.25 mm]
 .X ± 0.1 [0.50 mm]
 ANGLE TOLERANCE
 .X ± 1 DEG.
 TYCO ELECTRONICS RESERVES THE RIGHT TO AMEND THIS DRAWING AT ANY TIME. USERS SHOULD EVALUATE THE SUITABILITY OF THE PRODUCT FOR THEIR APPLICATION.
 © 2009 Tyco Electronics Corporation. All rights reserved.

DRAWN YUNGUEN
 APPROVED J. KUSTER
 RPN
 THIRD ANGLE PROJECTION

Tyco Electronics Raychem Molded Parts
 305 Constitution Dr
 Menlo Park, CA 94025

TITLE
 UNI-BOOT

SIZE B CODE IDENT. NO. 06090 DWG. NO. 202C632-XX-04
 DO NOT SCALE THIS DRAWING SHEET 1 OF 1

单击下面可查看定价，库存，交付和生命周期等信息

[>>TE Connectivity\(泰科\)](#)