

THIS DRAWING IS UNPUBLISHED. RELEASED FOR PUBLICATION ,19 .
 © COPYRIGHT 19 BY AMP INCORPORATED. ALL INTERNATIONAL RIGHTS RESERVED.

LOC	DIST	P	F	ZONE	LTR	DESCRIPTION	DATE	APPD
CM	54				R	REACT -15 THRU -23, -25 THRU -28 PER EC 0730-0095-96	5-21-96	BL RS

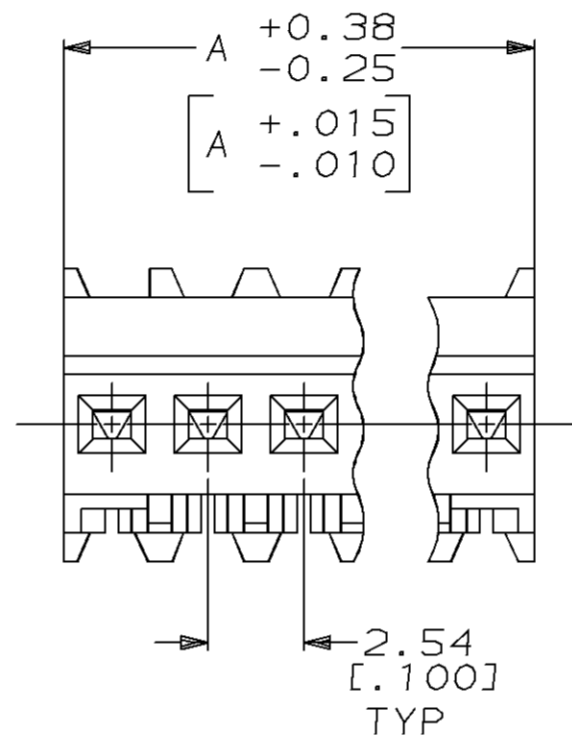
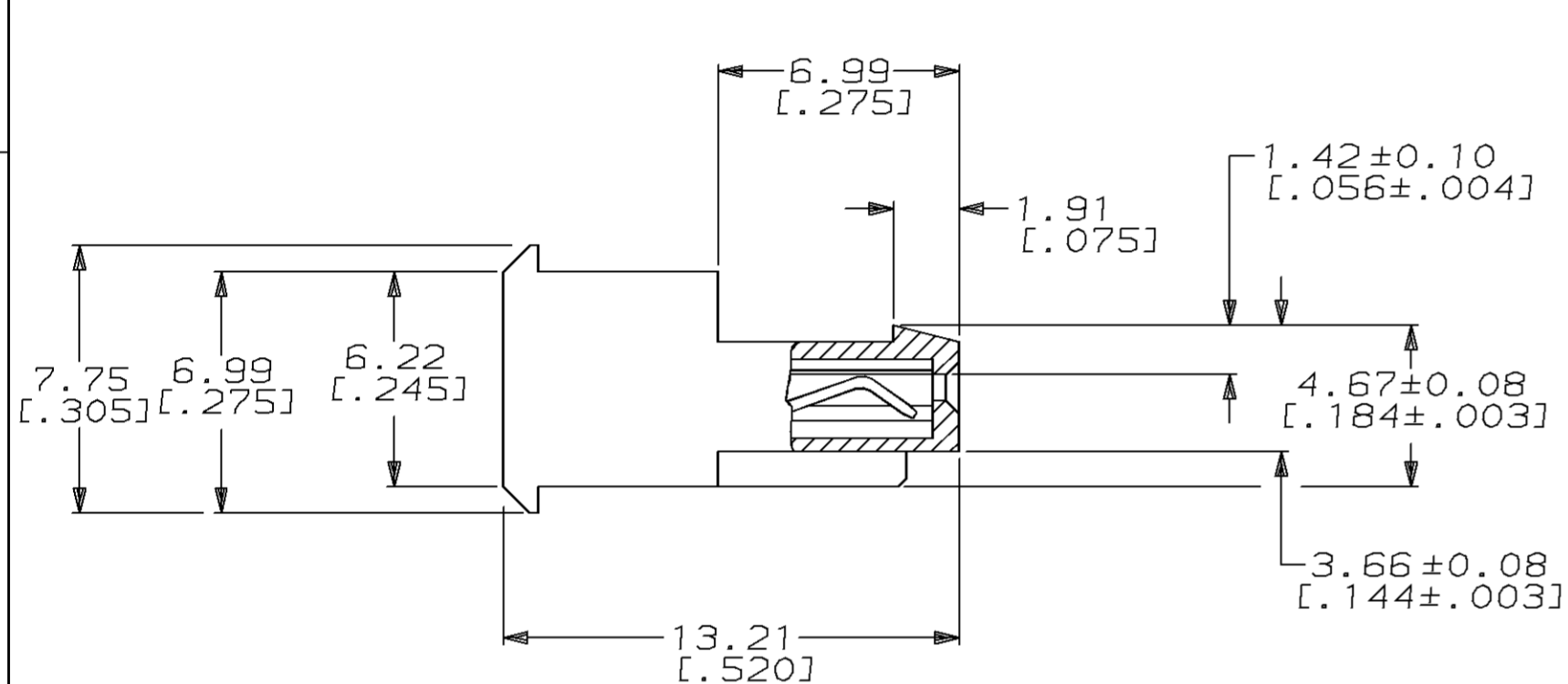
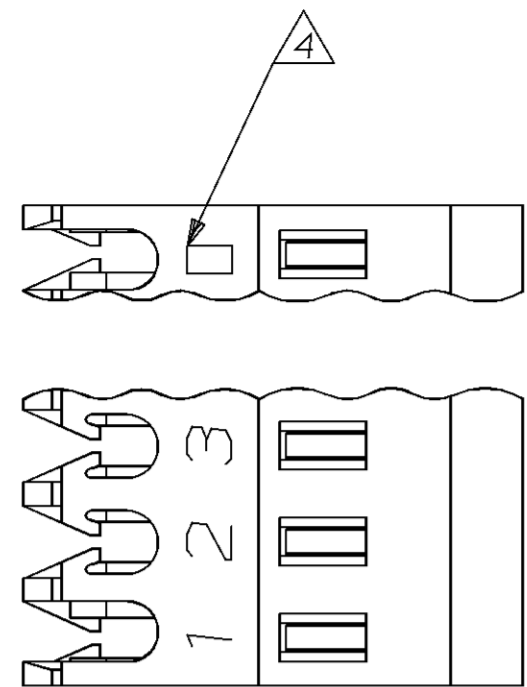

71.12	[2.800]	28	2-641241-8
68.58	[2.700]	27	2-641241-7
66.04	[2.600]	26	2-641241-6
63.50	[2.500]	25	2-641241-5
60.96	[2.400]	24	2-641241-4
58.42	[2.300]	23	2-641241-3
55.88	[2.200]	22	2-641241-2
53.34	[2.100]	21	2-641241-1
50.80	[2.000]	20	2-641241-0
48.26	[1.900]	19	1-641241-9
45.72	[1.800]	18	1-641241-8
43.18	[1.700]	17	1-641241-7
40.64	[1.600]	16	1-641241-6
38.10	[1.500]	15	1-641241-5
35.56	[1.400]	14	1-641241-4
33.02	[1.300]	13	1-641241-3
30.48	[1.200]	12	1-641241-2
27.94	[1.100]	11	1-641241-1
25.40	[1.000]	10	1-641241-0
22.86	[.900]	9	641241-9
20.32	[.800]	8	641241-8
17.78	[.700]	7	641241-7
15.24	[.600]	6	641241-6
12.70	[.500]	5	641241-5
10.16	[.400]	4	641241-4
7.62	[.300]	3	641241-3
5.08	[.200]	2	641241-2

1 MATERIAL: CONNECTOR - NYLON UL94V-2 (RED).
 CONTACTS - 0.30 [.012] THICK COPPER ALLOY
 (0.00076 [.000030] GOLD)

- CONTACTS ACCEPT 22 AWG WIRE WITH 1.52 [.060] MAX INSULATION DIAMETER.
- CONTACTS MUST ACCEPT 0.64±0.03 [.025±.001] SQUARE POST AND REMAIN LOCKED IN POSITION.

4 IDENTIFICATION NUMBER FOR LAST CIRCUIT MAY NOT APPEAR ON ALL ASSEMBLIES.

- DIMENSIONS IN BRACKETS ARE IN INCHES.
- HOUSING FEATURES ARE: FEED THRU WITH LOCKING RAMP.

		DIM A	NO OF CIRCUITS	PART NO
DO NOT SCALE PRINT. UNLESS SPECIFIED DIMENSIONS IN mm [INCHES] TOLERANCES ON : 2 PLC DEC ± - 3 PLC DEC ± 0.13 [.005] ANGLES ± -	DR 4-22-91 B. LEWIS CHK 4-22-91 R. SWING APPD 4-22-91 G. MILLER APPD 4-22-91 G. MILLER PRODUCT SPEC 108-1050	AMP AMP Incorporated Harrisburg, PA 17105-3608 NAME MTA-100 CONNECTOR ASSEMBLY, 22 AWG, STANDARD		
MATERIAL	FINISH			
	APPLICATION SPEC 114-1019	SIZE C	CAGE CODE 00779	DRAWING NO 641241
	WEIGHT -	SCALE 5:1	SHEET 1 OF 1	

METRIC

单击下面可查看定价，库存，交付和生命周期等信息

[>>TE Connectivity\(泰科\)](#)