

REVISIONS				
P	LTR	DESCRIPTION	DATE	APVD
D		REVISED PER ECO-18-008015	24MAY2018	AP DG

RECOMMENDED PCB LAYOUT
 TOLERANCE IS ±0.05

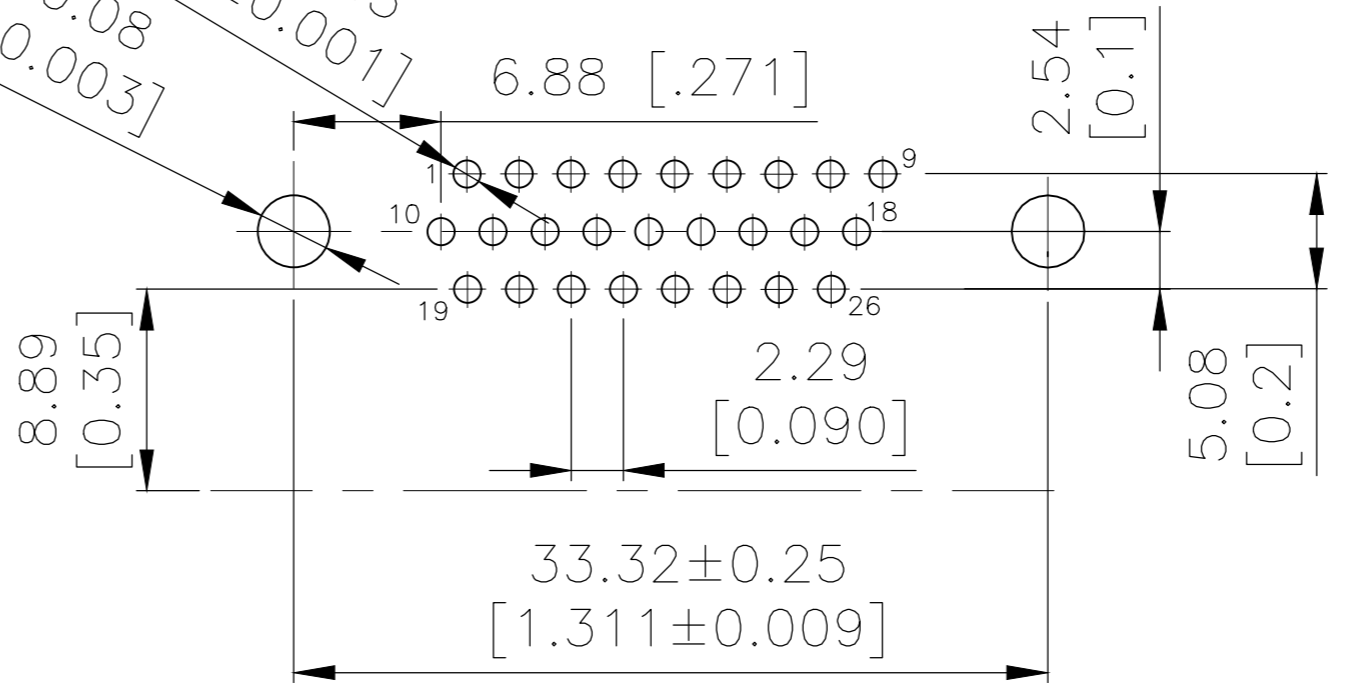

NOTES:
 Housing:PBT+30%GF(UL94V-0) BLACK
 Contact:Brass
 " GOLD PLATING ON CONTACT AREA
 100u" MATTE TIN PLATING ON SOLDER TAIL
 50u" NICKEL UNDERPLATED OVERALL
 Holddown:Brass,100u" TIN OVER 50u" NICKEL
 Shell: Cold Roller Steel, Ni Plated
 Revit: Brass, Nickel Plating
 LOT NUMBER "XXXX"
 └─ Stands For Calendar Year
 └─ Stands For Week Number

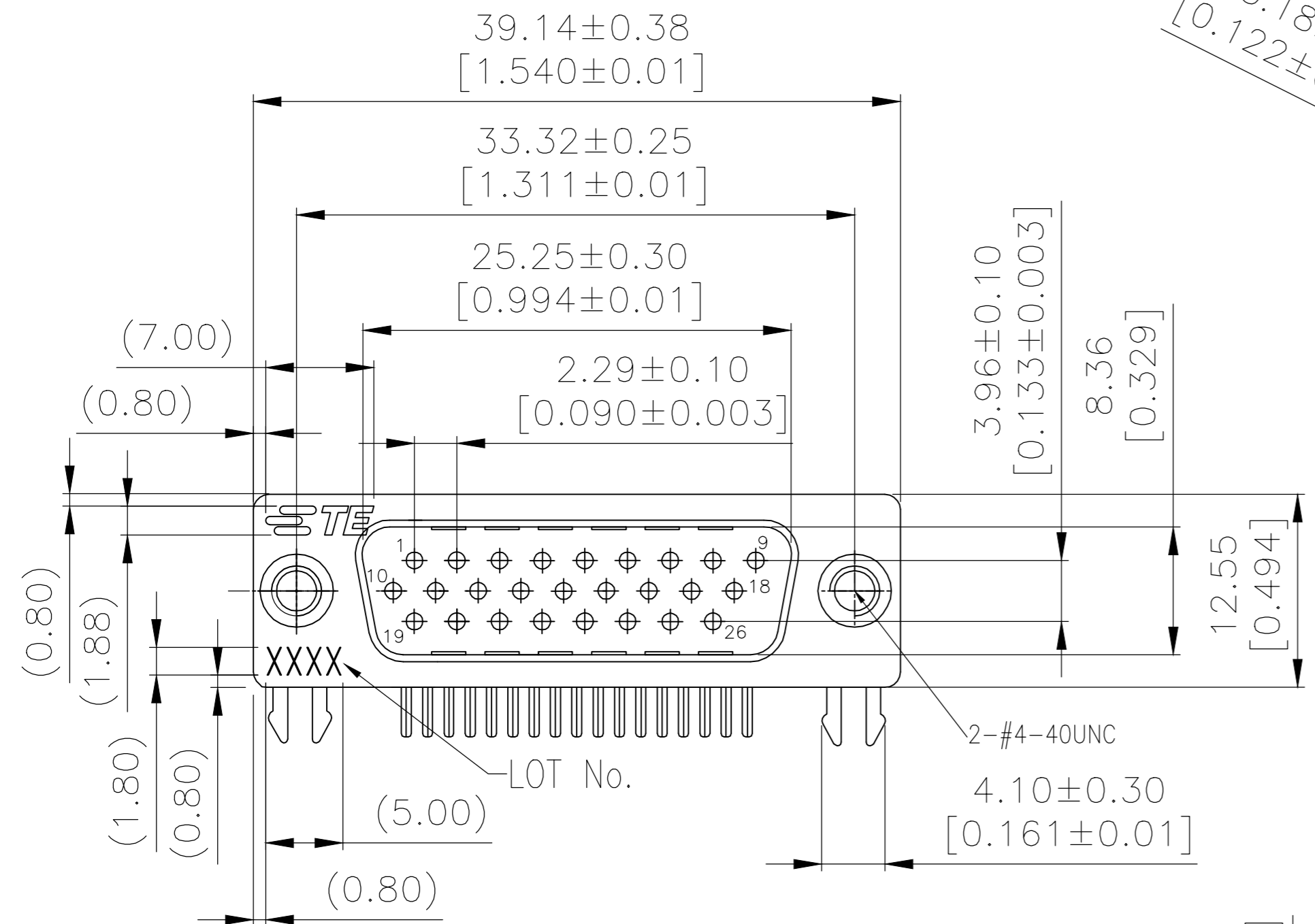
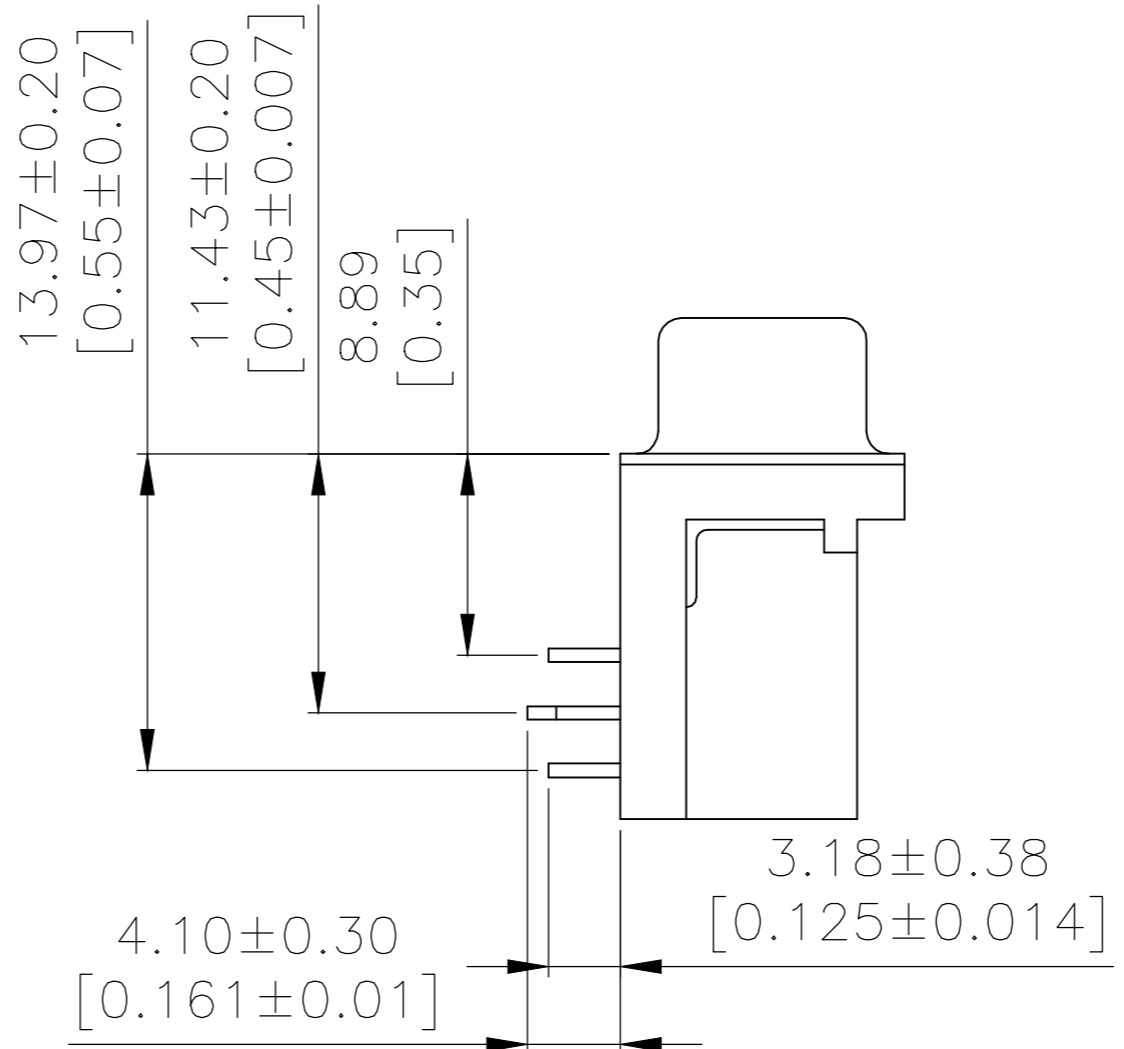
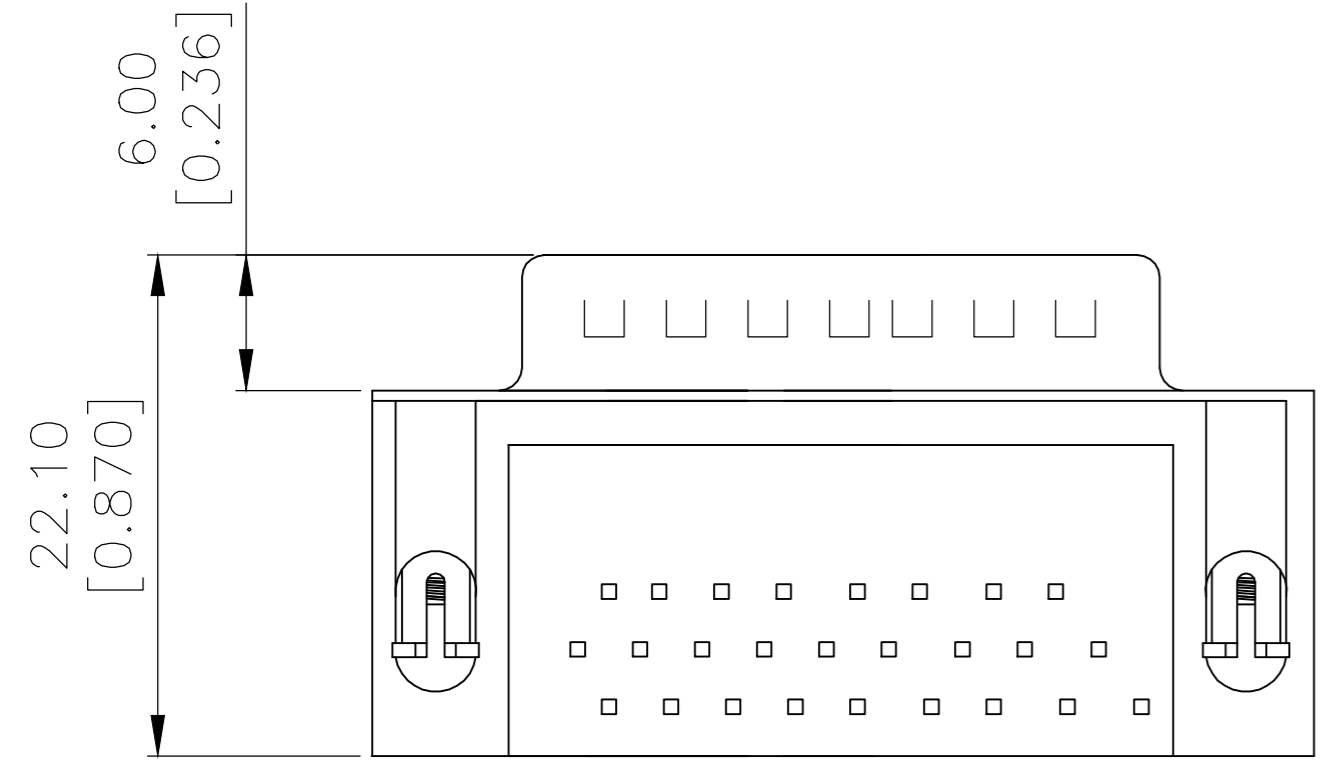

THREADED	30μ" Au	2311776-1
TYPE	Contact Area	P/N
	Plating	

THIS DRAWING IS A CONTROLLED DOCUMENT.		DWN AJITH PAI 25FEB2017	STE TE Connectivity	
DIMENSIONS: mm		CHK DANIEL GORENC 25FEB2017		
TOLERANCES UNLESS OTHERWISE SPECIFIED:		APVD DANIEL GORENC 25FEB2017	NAME AMPLIMITE PLUG, HD22, RIGHT ANGLE, 26P THREADED	
0 PLC ± -		PRODUCT SPEC 108-130023	SIZE A2	
1 PLC ± -		APPLICATION SPEC	CAGE CODE 00779	
2 PLC ± 0.25			DRAWING NO C=2311776	
3 PLC ± -			RESTRICTED TO	
4 PLC ± -			-	
ANGLES ± -			-	
FINISH		WEIGHT	SCALE 1:1	
-			SHEET 1 of 1	
		CUSTOMER DRAWING	REV D	

单击下面可查看定价，库存，交付和生命周期等信息

[>>TE Connectivity\(泰科\)](#)