

LOC		DIST		REVISIONS			
AD	00	REV	DATE	BY	CHK	APPV	
A1		REVISED PER ECO-08-009182	22APR08	DH	AS		

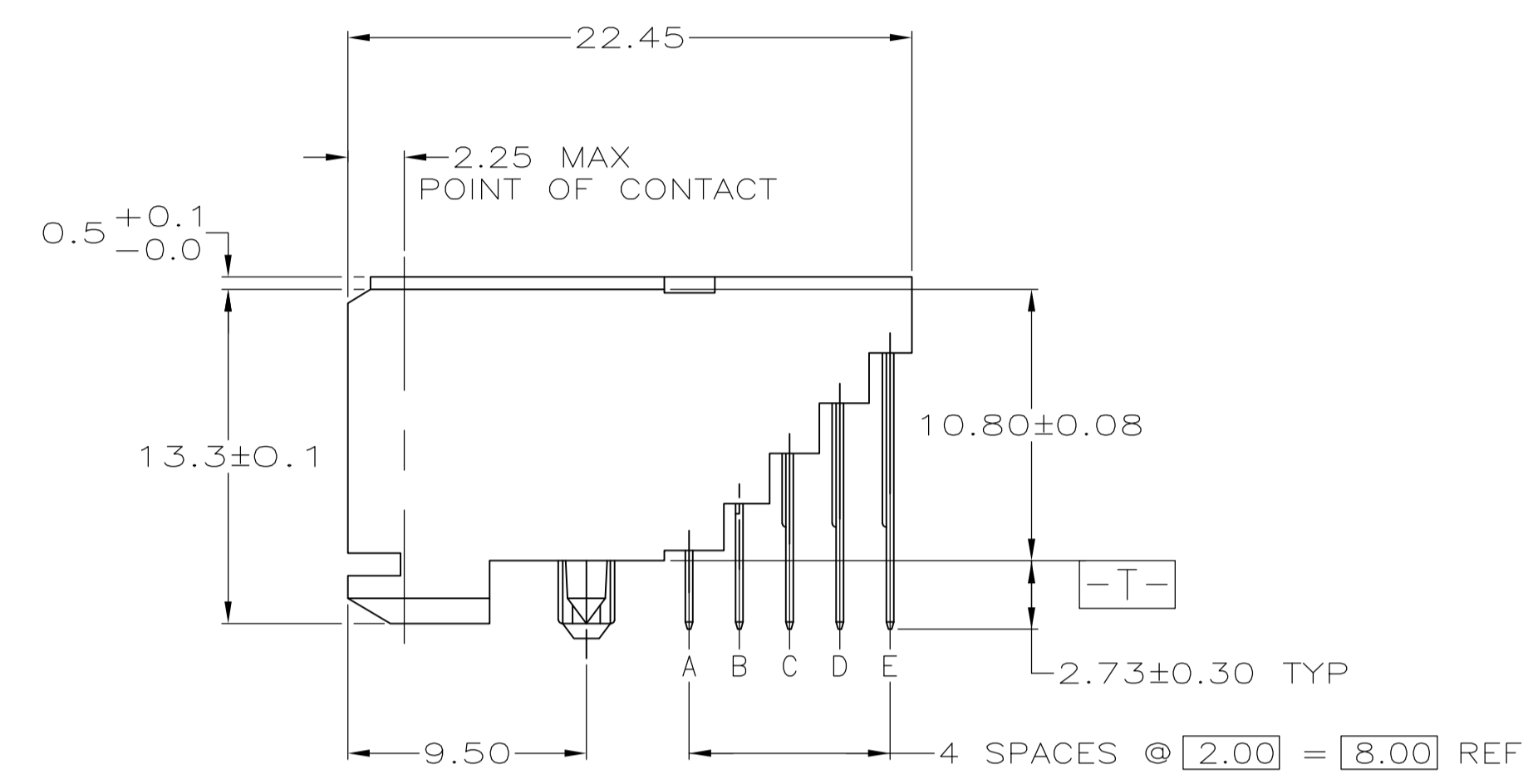

△ HOUSING MATERIAL: LIQUID CRYSTAL POLYMER.
 COLOR: NATURAL.
 △ CONTACT MATERIAL: PHOSPHOR BRONZE.
 △ CONTACT FINISH:
 UNDERPLATE (ENTIRE CONTACT):
 0.00127 MIN NICKEL PER SAE-AMS-QQ-N-290
 ON MATING SURFACES:
 FLASH GOLD PER ASTM B 488, OVER
 0.00076 MIN PALLADIUM-NICKEL OVER UNDERPLATE, OR
 0.00076 MIN GOLD PER ASTM B 488 OVER UNDERPLATE.
 ON LEADS:
 0.00381 MIN MATTE TIN PER ASTM B 545 OVER UNDERPLATE.
 LUBRICATION (MIN MATING SURFACES):
 SURFACE CONDITIONER AFTER PLATING.

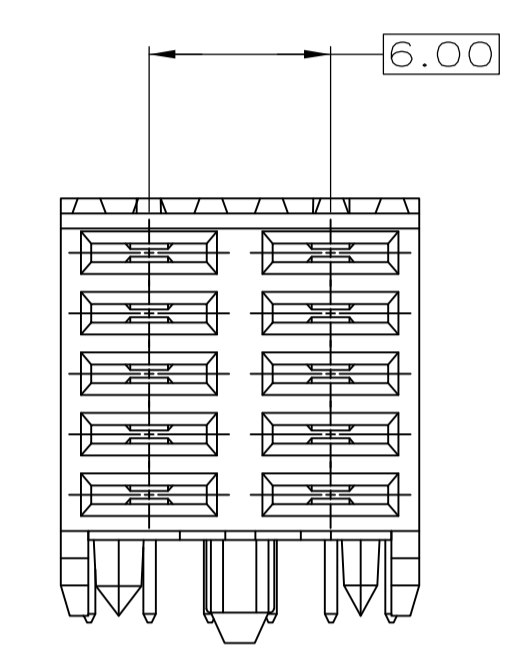
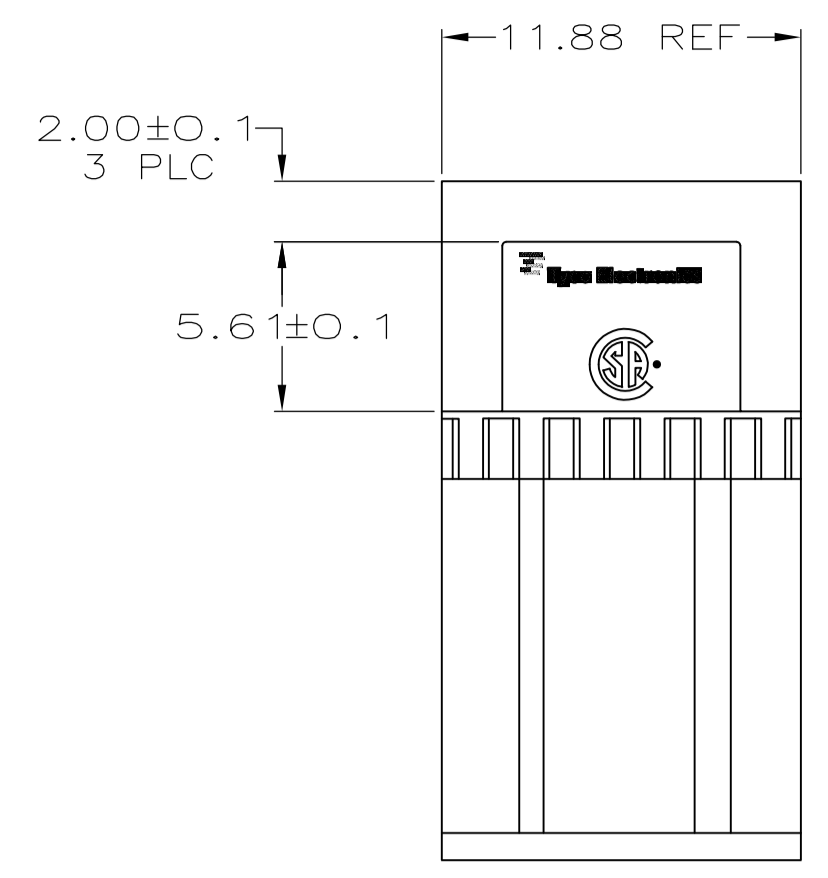
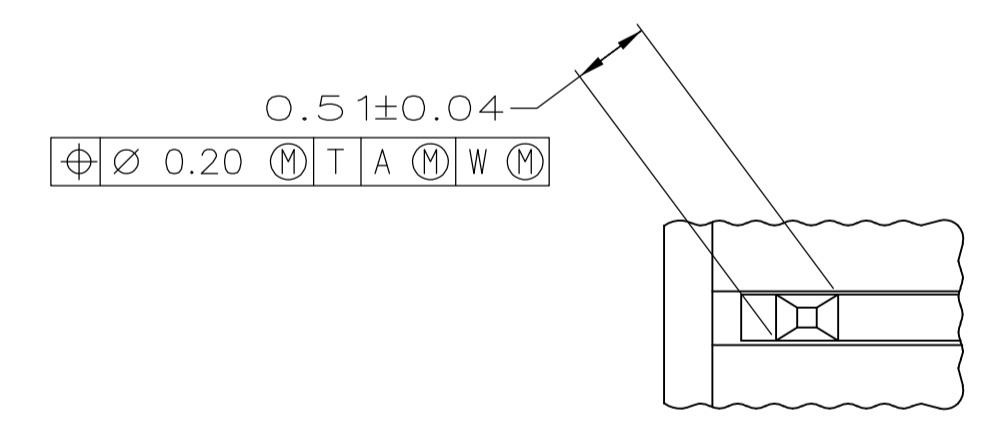
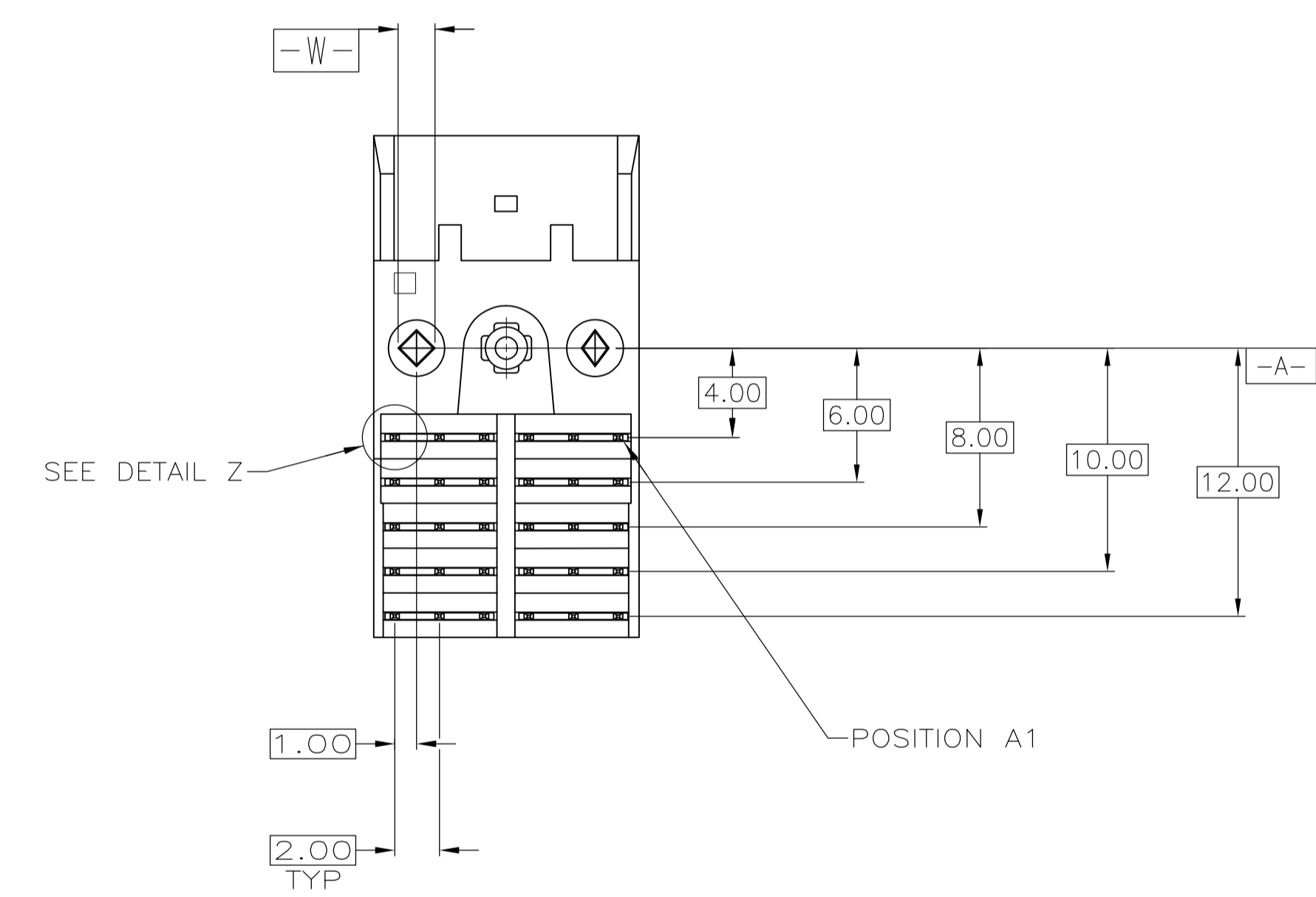

DETAIL Z
 SCALE 20:1

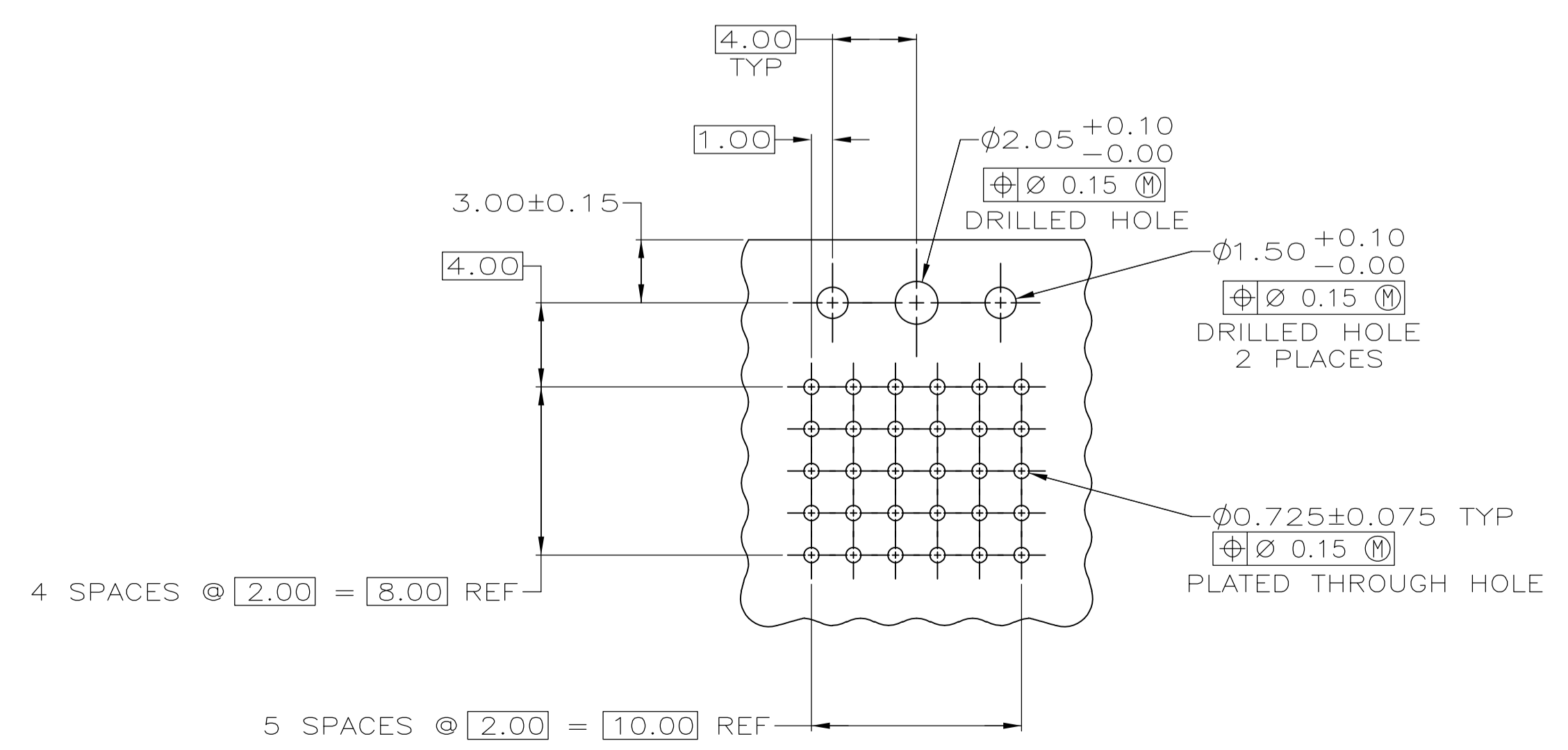

RECOMMENDED CIRCUIT PATTERN
 PER IPC-D300 TYPE II, CLASS 3
 COMPONENT SIDE

5223092-1
 PART NUMBER

THIS DRAWING IS A CONTROLLED DOCUMENT.		DIN B CARDO 01OCT04	Tyco Electronics Corporation Harrisburg, PA 17105-3608	
DIMENSIONS: mm		CHK R WERTZ 01OCT04	NAME RCPT ASSEMBLY, POWER, Z-PACK 2mm FB, 10 POSITION, RIGHT ANGLE, SOLDER LEADS	
TOLERANCES UNLESS OTHERWISE SPECIFIED:		APPV R WERTZ 01OCT04	PRODUCT SPEC	
0 PLC ± -		APPLICATION SPEC		
1 PLC ± -		SIZE CAGE CODE DRAWING NO		
2 PLC ± 0.13		RESTRICTED TO		
3 PLC ± 0.013		A1 00779 C=5223092		
4 PLC ± -		CUSTOMER DRAWING SCALE 4:1 SHEET 1 OF 1 REV A1		
ANGLES ± -				
MATERIAL		FINISH		

单击下面可查看定价，库存，交付和生命周期等信息

[>>TE Connectivity\(泰科\)](#)