

THIS DRAWING IS UNPUBLISHED. RELEASED FOR PUBLICATION 20  
 © COPYRIGHT 20 BY TYCO ELECTRONICS CORPORATION. ALL RIGHTS RESERVED.

LOC		DIST		REVISIONS			
P	LTR	DESCRIPTION	DATE	DWN	APVD		
GP	00	A	11OCT2006	GIP	DO	INITIAL RELEASE	
		B	21FEB2007	GIP	DO	REVISED PER ECO-07-004109	

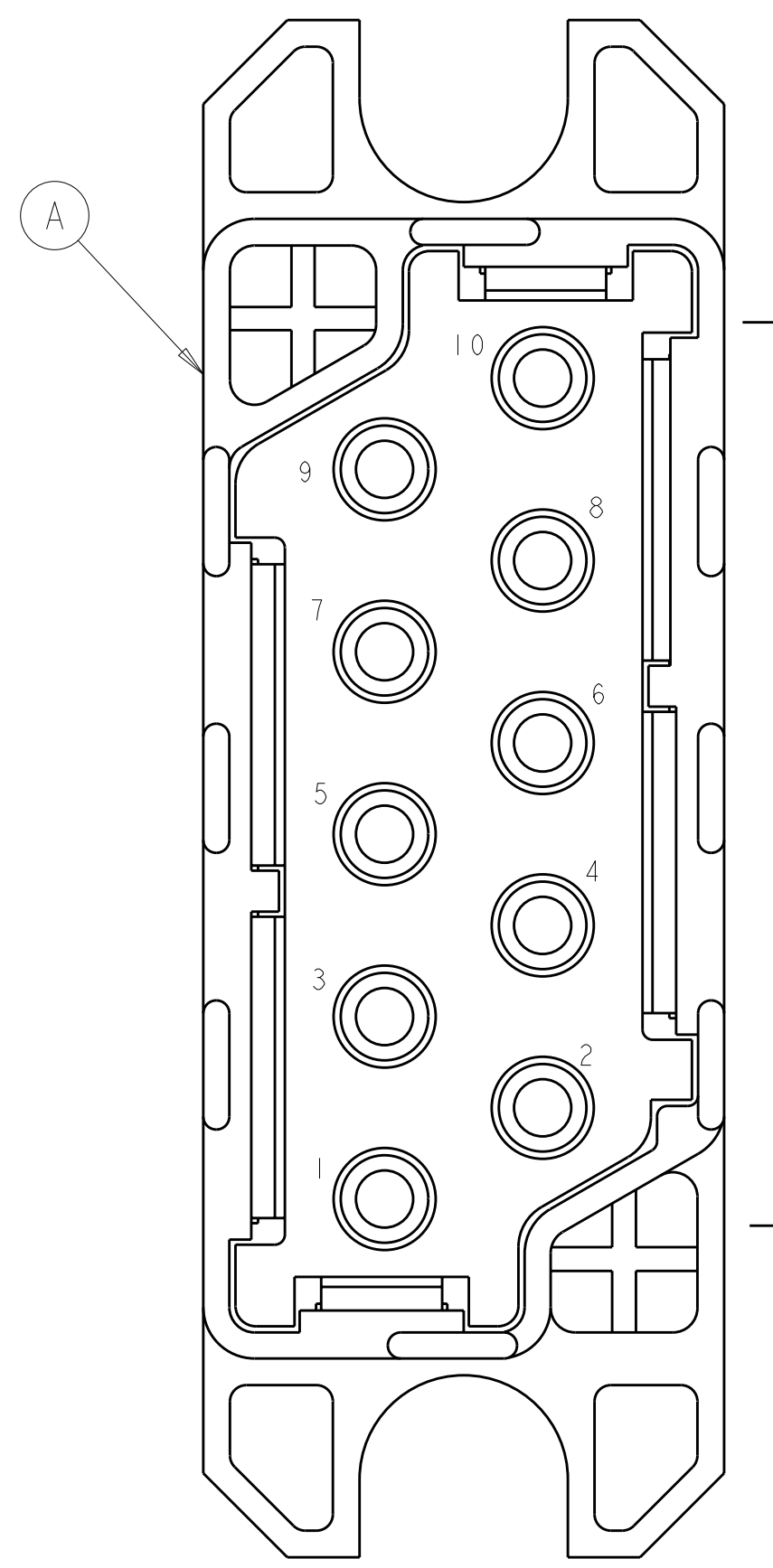
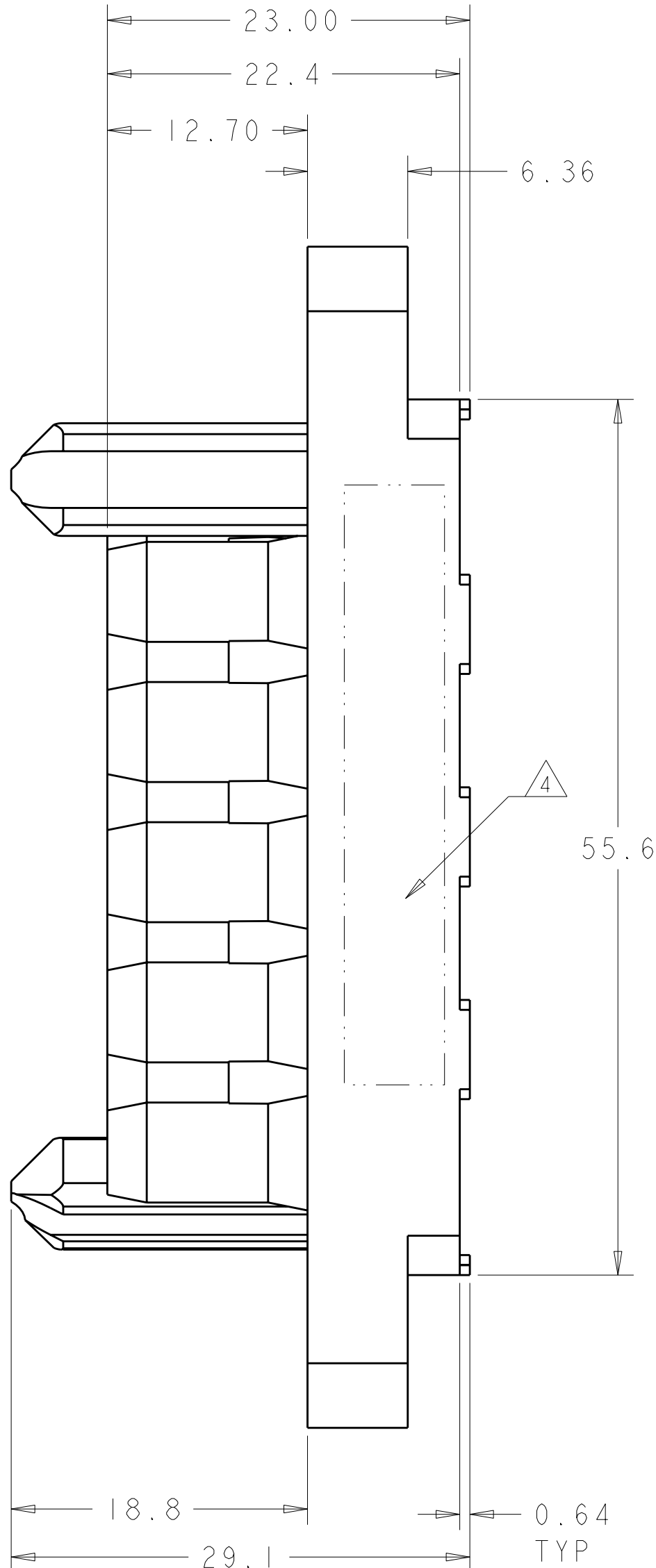
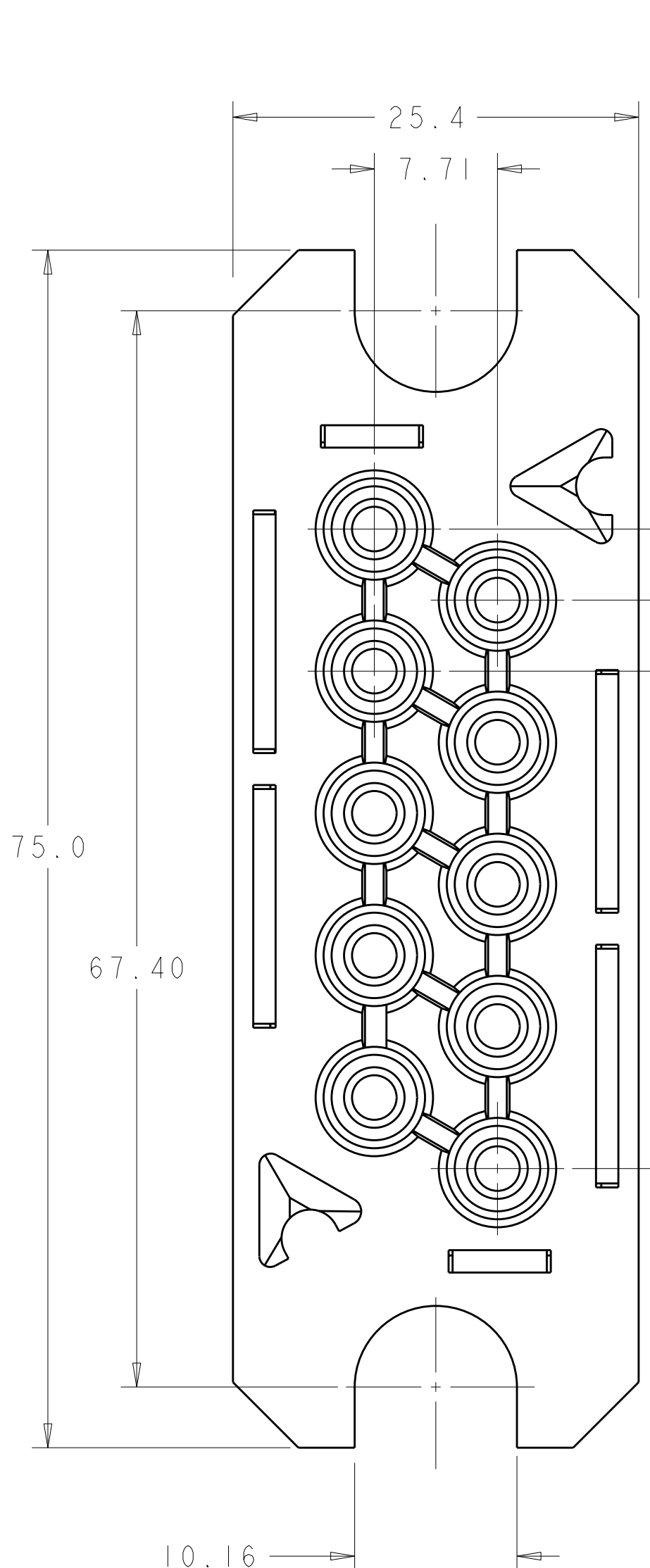

SOCKET CONTACT SIZE #12 (B)

REAR VIEW

AS SHOWN	1926212-1
DESCRIPTION	PART NUMBER

**ELCON P1050 DRAWER**

<small>THIS DRAWING IS A CONTROLLED DOCUMENT FOR TYCO ELECTRONICS CORPORATION. IT IS SUBJECT TO CHANGE AND THE CONTROLLING ENGINEERING ORGANIZATION SHOULD BE CONTACTED FOR THE LATEST REVISION.</small>		DWN G. PETERS 11OCT2006 CHK D. ORRIS 11OCT2006 APVD S. FLICKINGER 11OCT2006	<b>tyco</b> Tyco Electronics Harrisburg, PA 17105-3608
DIMENSIONS: mm 	TOLERANCES UNLESS OTHERWISE SPECIFIED: 0 PLC ± 1 PLC ± 2 PLC ±.30 3 PLC ±.10 4 PLC ± ANGLES ±2 FINISH	PRODUCT SPEC - APPLICATION SPEC - WEIGHT -	NAME: SOCKET CONNECTOR P1050 DRAWER SIZE: A2 CAGE CODE: 00779 DRAWING NO: 1926212 RESTRICTED TO: -
MATERIAL: -		CUSTOMER DRAWING SCALE: 3:1 SHEET: 1 OF 2 REV: B	

THIS DRAWING IS UNPUBLISHED. RELEASED FOR PUBLICATION 20  
 © COPYRIGHT 20 BY TYCO ELECTRONICS CORPORATION. ALL RIGHTS RESERVED.

LOC	DIST	REVISIONS			
P	LTR	DESCRIPTION	DATE	DWN	APVD
GP	00	-	SEE SHEET 1	-	-

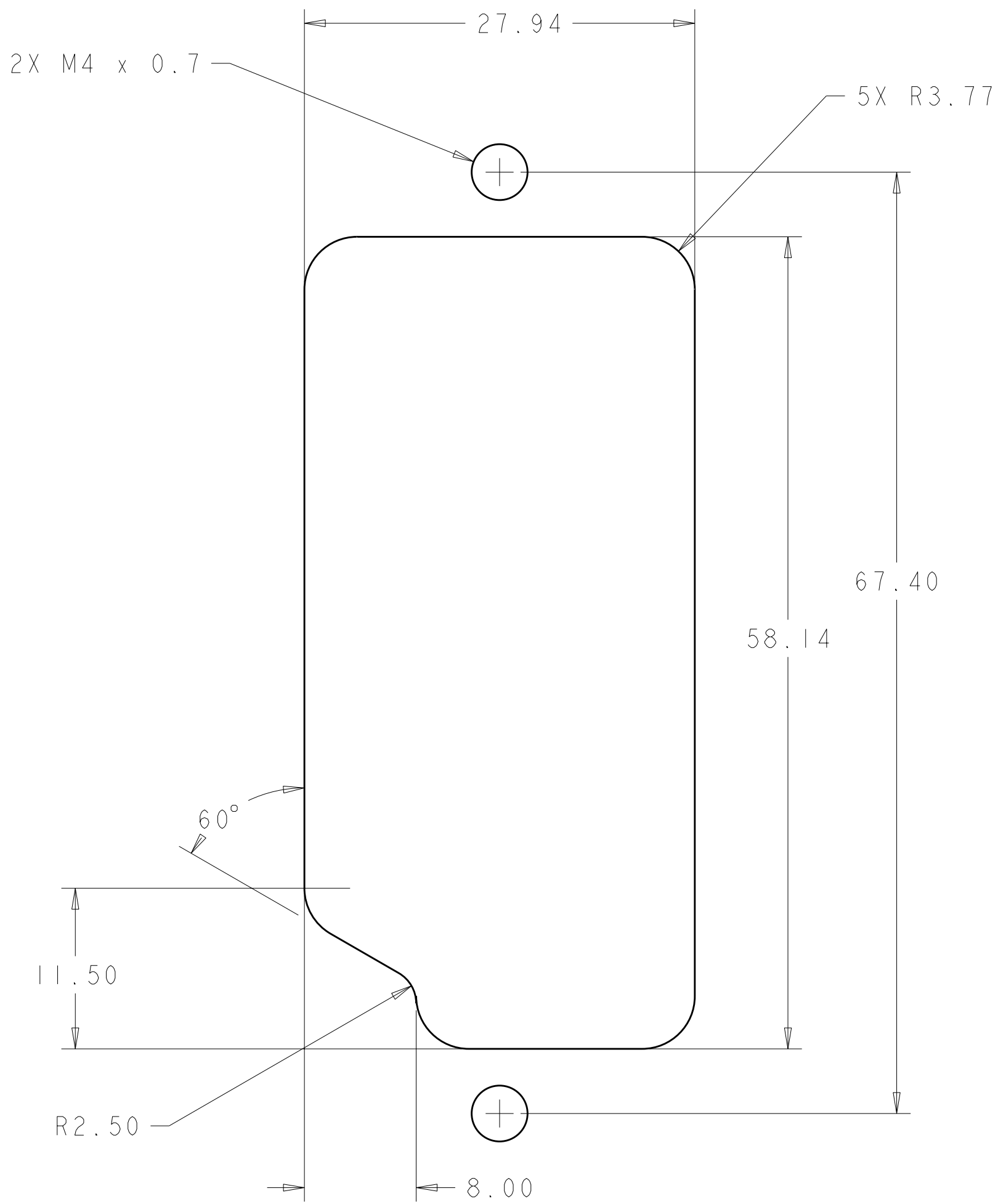

SUGGESTED PANEL CUT-OUT  
 VIEW FROM CONNECTOR MOUNTING SIDE

- PART NUMBER CHANGES AND OR DESIGN CHANGES AFFECTING ITEM INTERCHANGEABILITY REQUIRE PRIOR TYCO APPROVAL AND AUTHORIZATION BY REVISION TO THIS DRAWING.
- MATERIAL:
  - INSULATORS - THERMOPLASTIC, GLASS REINFORCED, COLOR: BLACK UL94V-0 FLAMMABILITY RATED.
  - SOCKET CONTACTS - COPPER ALLOY
  - RETENTION CLIPS: BERYLLIUM COPPER OR STAINLESS STEEL
  - CROWN BAND: BERYLLIUM COPPER
  - SHOULDER SCREWS: STAINLESS STEEL
- FINISH:
  - CONTACTS - SILVER PLATE .000200 INCH MIN. THK., OVER NICKEL .000040 INCH MIN. THK.

- △ ITEMS PROVIDED TO THIS SPECIFICATION TO BE PERMANENTLY IDENTIFIED PER THE FOLLOWING IDENTIFIER LABEL
- YEAR      WEEK
- TYCO PART NO.      DATE CODE (e.g. 0106)
- XXXXXXXX-X      XXXX
- △ CRIMP CONTACTS AND SHOULDER SCREWS ( ITEM B ) SHALL BE PACKAGED SEPERATELY AND PLACED IN THE BOX WITH THE CONNECTOR ASSEMBLY.

△ 10	6648433-1	CONTACT SOCKET #12, CRIMP #10	B
1	1648596-2	SOCKET, CONNECTOR ASSY	A
-1	PART NUMBER	DESCRIPTION	ITEM NO.

<small>THIS DRAWING IS A CONTROLLED DOCUMENT FOR TYCO ELECTRONICS CORPORATION IT IS SUBJECT TO CHANGE AND THE CONTROLLING ENGINEERING ORGANIZATION SHOULD BE CONTACTED FOR THE LATEST REVISION.</small>		DWN G. PETERS 11OCT2006	Tyco Electronics Harrisburg, PA 17105-3608		
DIMENSIONS: mm		CHK D. ORRIS 11OCT2006			
		APVD S. FLICKINGER 11OCT2006	NAME SOCKET CONNECTOR P10S0 DRAWER		
TOLERANCES UNLESS OTHERWISE SPECIFIED: 0 PLC ±- 1 PLC ±- 2 PLC ±.30 3 PLC ±.10 4 PLC ±- ANGLES ±2 FINISH		PRODUCT SPEC -	RESTRICTED TO		
MATERIAL		APPLICATION SPEC -	SIZE A2	CAGE CODE 00779	DRAWING NO. 1926212
-		WEIGHT -	CUSTOMER DRAWING		
		SCALE 3:1	SHEET 2	OF 2	REV B

**ELCON P10S0 DRAWER**

单击下面可查看定价，库存，交付和生命周期等信息

[>>TE Connectivity\(泰科\)](#)