

THIS DRAWING IS UNPUBLISHED. RELEASED FOR PUBLICATION
 © COPYRIGHT - By - ALL RIGHTS RESERVED.

LOC		DIST		REVISIONS					
AF		50		P	LTR	DESCRIPTION	DATE	DWN	APVD
				B3		ECR-15-005665	10AUG2015	BDA	PKS

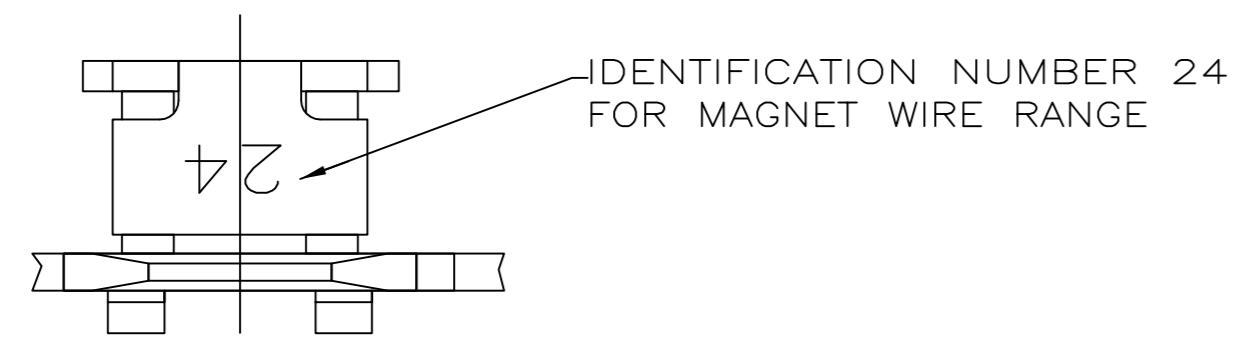

- CONTINUOUS STRIP ON REELS WITH TERMINALS LOCATED ON 5.59 ± 0.08 [$.220 \pm .003$] CENTERS. SLOT TERMINATES A SINGLE MAGNET WIRE ONLY. COPPER RANGE: 0.91-1.15mm [#19-#17] AWG. ALUMINUM RANGE: 0.95-1.15mm [#18.5-#17] AWG. ALUMINUM WIRE RANGE APPLIES FOR POST-TIN PLATED VERSIONS ONLY. ALTERNATE RANGE: 0.95-1.15mm [#18.5-#17] AWG.
- AFTER INSERTION INTO PLASTIC HOLDER TAB PORTION MUST BE BENT OVER 45° TO 90° OR
- POTTED-IN TO PREVENT PULL-OUT WHEN MATING RECEPTACLE IS DISCONNECTED.

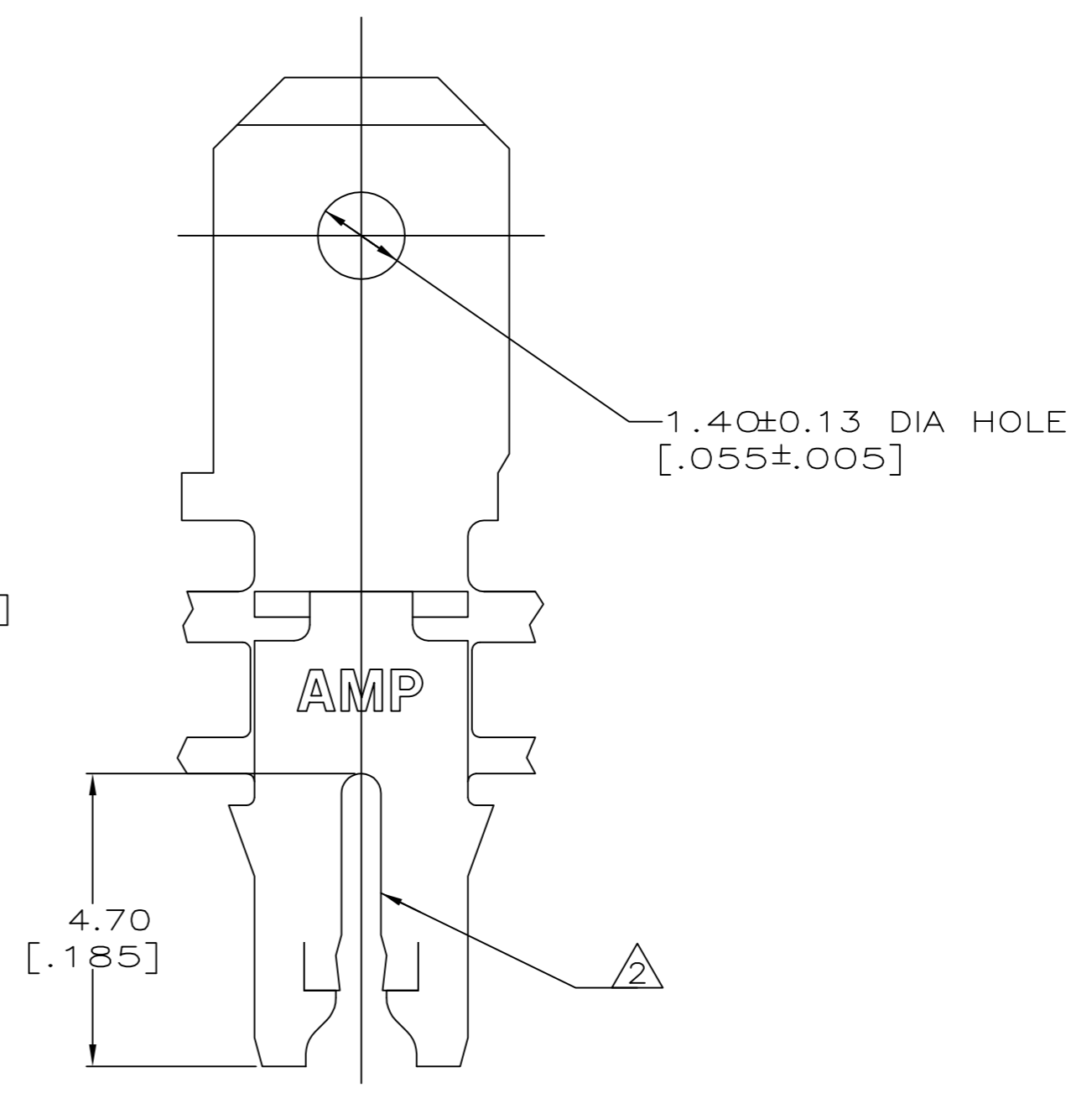
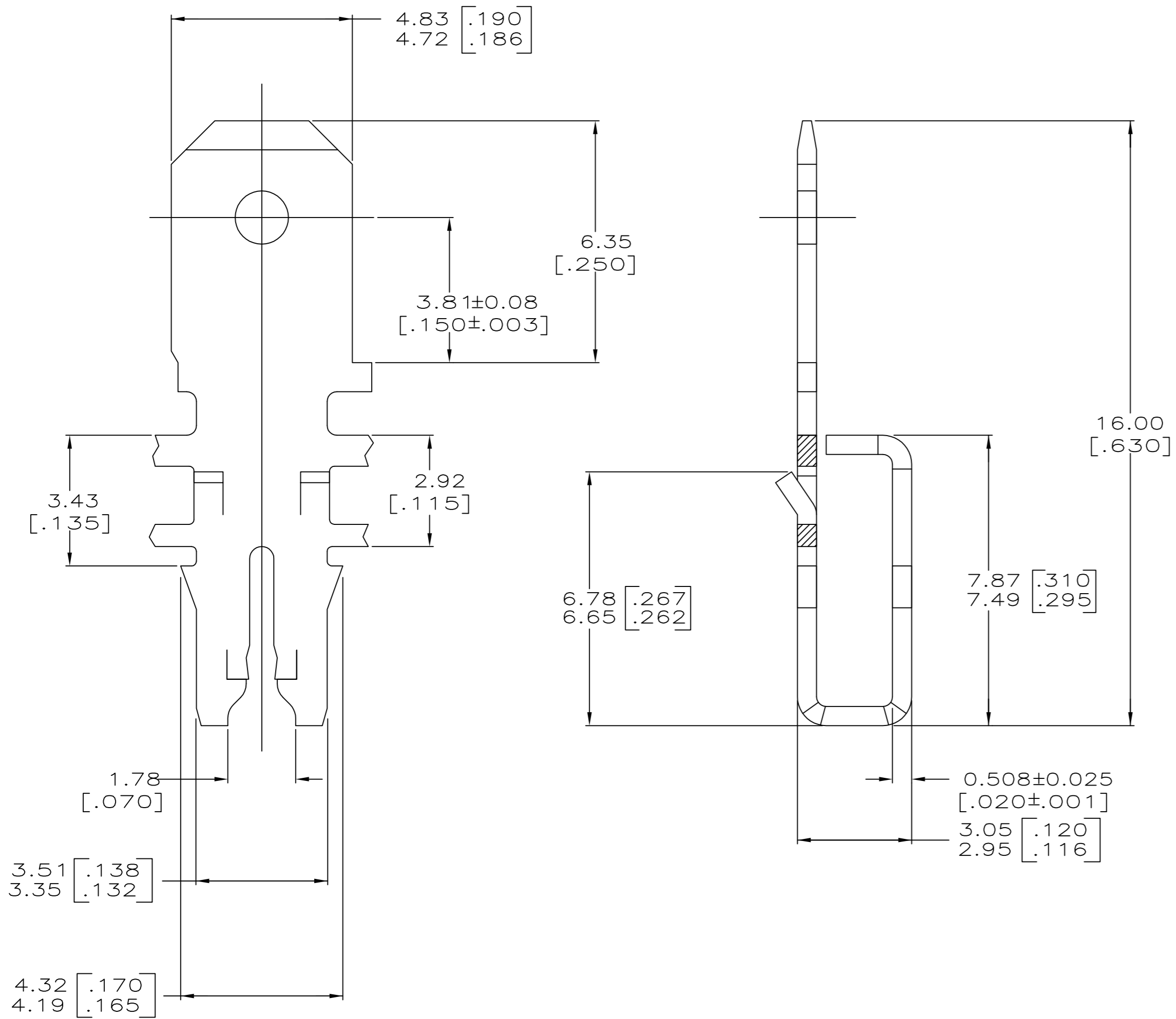

63782-1

THIS DRAWING IS A CONTROLLED DOCUMENT.		DWN	22/MAR/94	 TE Connectivity	NAME TERMINAL, TAB, 4.75 [.187] FASTON™ MAG-MATE™
		CHK	25/MAR/94		
		PHILLIP M. FORTNEY		PRODUCT SPEC 108-2012	SIZE A2
		NELSON E NEFF			
		APPLICATION SPEC		CAGE CODE 00779	DRAWING NO 63782
		114-2067			
MATERIAL		FINISH		RESTRICTED TO	
BRASS		TIN PLATED		-	
CUSTOMER DRAWING				SCALE	10:1
				SHEET	1 of 1
				REV	B3

单击下面可查看定价，库存，交付和生命周期等信息

[>>TE Connectivity\(泰科\)](#)