

THIS DRAWING IS UNPUBLISHED. RELEASED FOR PUBLICATION , 19

© COPYRIGHT 19 BY AMP INCORPORATED. ALL INTERNATIONAL RIGHTS RESERVED.

PROJ LGC DIST
5049 DF A0

		REVISIONS			
ZONE	LTR	DESCRIPTION	DATE	APPD	
	0	RLSE/NPR 89-015 CCT	2-89	EH	
	A	REV PER ECN DF-1837 TW	5-89	EH	
✓	B	REV PER DF-3934 CT	6-89	12-70	

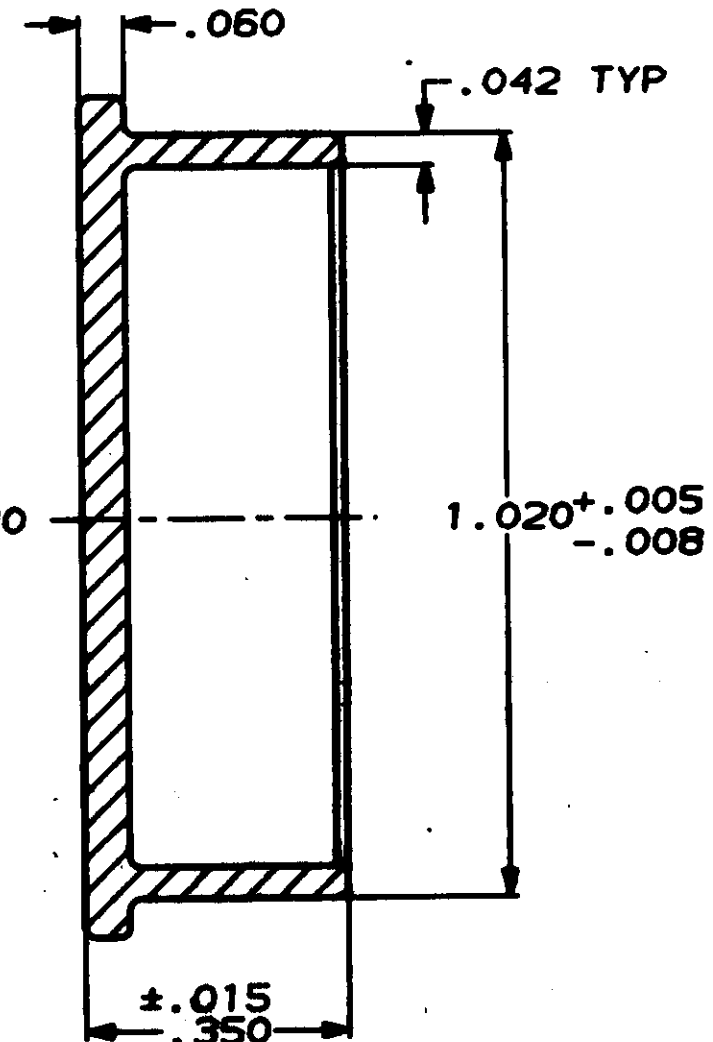
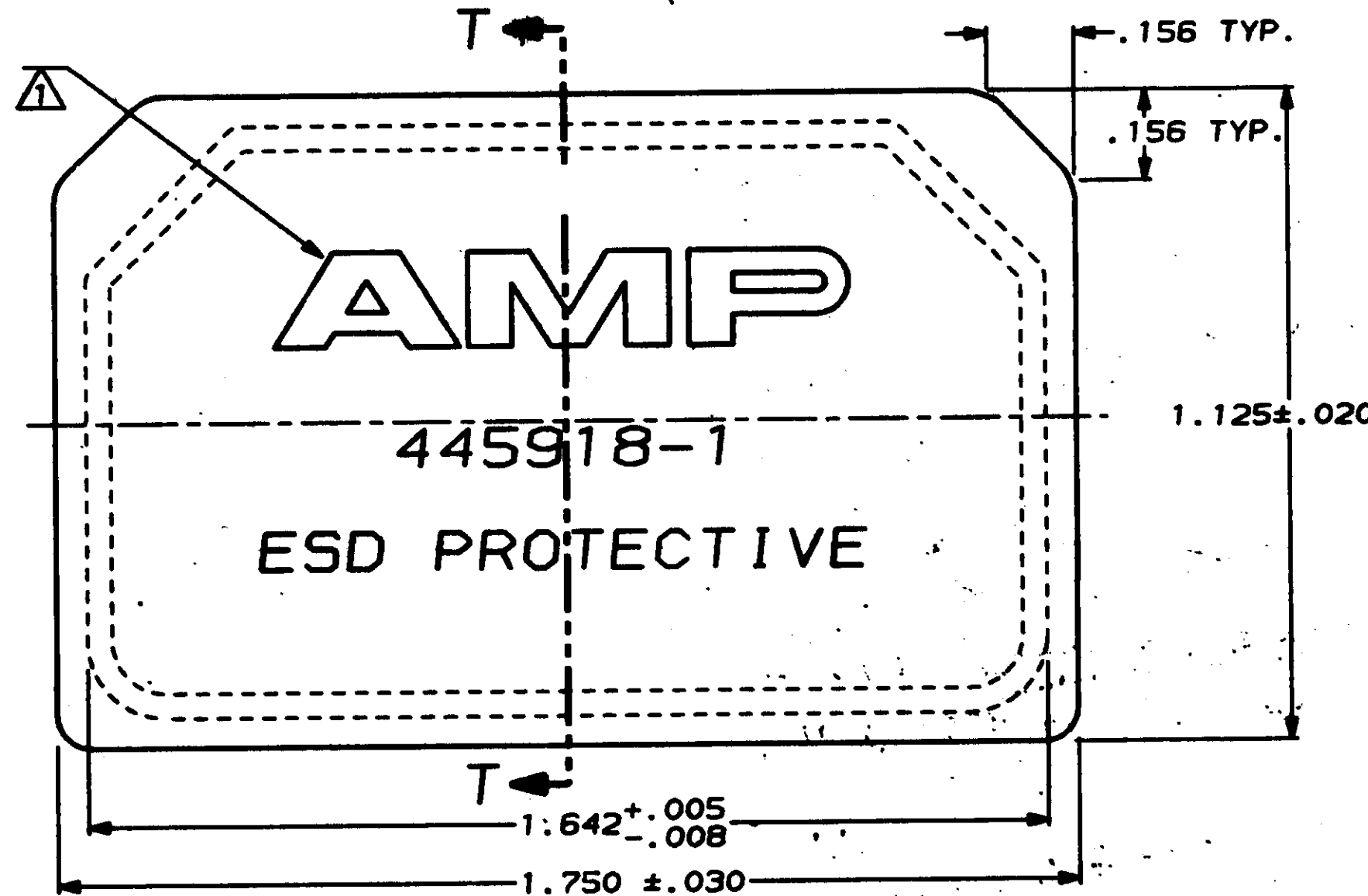

SECTION T-T

⚠ MARKING IS MOLDED IN AND RAISED .005-.012 ABOVE SURFACE APPROX: AS SHOWN.

DO NOT SCALE PRINT. UNLESS SPECIFIED DIMENSIONS IN INCHES TOLERANCES ON: PLC DEC ± .005 PLC DEC ± .008 ANGLES ± .5		ON 2-15-89 C.G. THOMPSON CHK 3-1-89 E. HENNING APPD 3-1-89 E. HENNING APPD 3-1-89 E. HENNING	445918-1 PART NO	
MATERIAL CONDUCTIVE THERMOPLASTIC		AMP INCORPORATED Harrisburg, Pa. 17106	DUST COVER, ARINC 404 DUAL RECEPTACLE	
FINISH BLACK		SIZE B PCH NO 00779 DRAWING NO 445918		
APPLICATION SPEC -		SCALE 4:1	SHEET 1 OF 1	

CUSTOMER DRAWING

单击下面可查看定价，库存，交付和生命周期等信息

[>>TE Connectivity\(泰科\)](#)