

a) Part as supplied

312W021

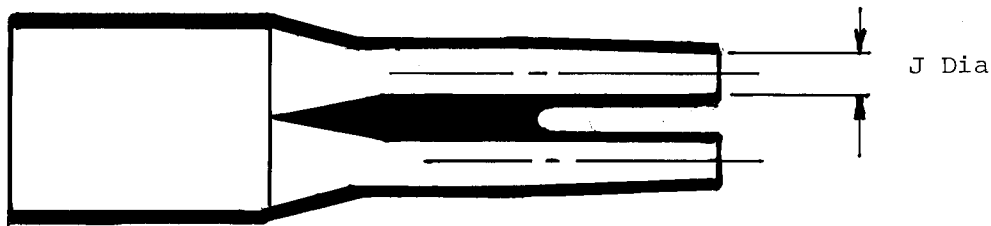

b) Part after unrestricted recovery

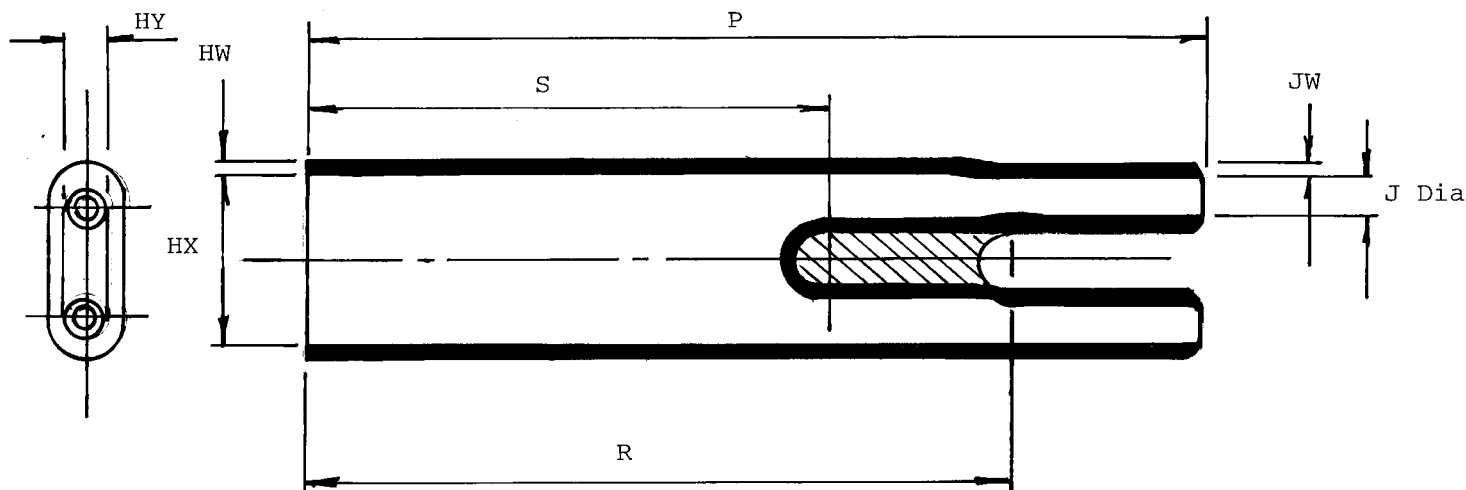

Dimensions in millimetres

Part Number	HX	HY	J	J̄	P	R	S	HW	JW
	min a	min a	min a	max b	+10% b	+10% b	+10% b	+20% b	+20%
312W021	15	6	5	1.5	60	48.5	27	1.0	0.5

Drawn S. Dixon Checked *[Signature]* Issue 2 Date June '85

**Approval**

Design *[Signature]* MKTG *[Signature]* O.C. *[Signature]*

Conforms to ISO Recommendations  
3rd Angle Projection  
Not to scale

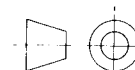

## Ordering Information

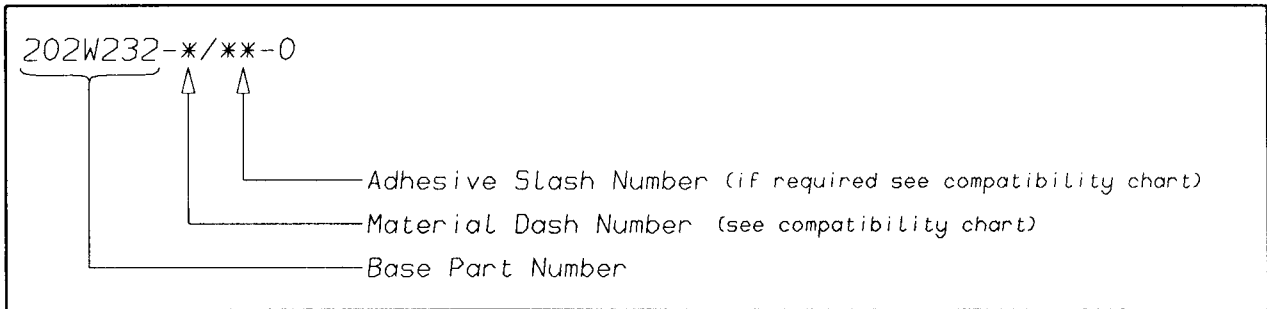

## COMPATIBILITY CHART

MATERIAL DASH NUMBER	MATERIAL DESCRIPTION	COATING SLASH NUMBER
-3	POLYOLEFIN, SEMI-RIGID	/42, /86
-4	POLYOLEFIN, FLEXIBLE	/42, /86
-25	ELASTOMER, FLUID RESISTANT	/86, /225

AS SUPPLIED DIMENSIONS ARE FOR UNCOATED PARTS,  
WHEN COATING IS ADDED, ENTRY DIAMETERS WILL REDUCE BY 1.5mm MAX.

POTTING PORTS ARE OPTIONAL  
WHEN SPECIFIED BY SUFFIX "-00"  
THEY WILL BE LOCATED AS SHOWN

Raychem  
Electronics OEM Division Europe  
Swindon, Wiltshire, England.  
Telephone: (01793) 528171 Fax: 573923

单击下面可查看定价，库存，交付和生命周期等信息

[>>TE Connectivity\(泰科\)](#)