

LOC	DIST	REV	DATE	BY	APP'D
GP	00	A	14FEB2011	RG	DO

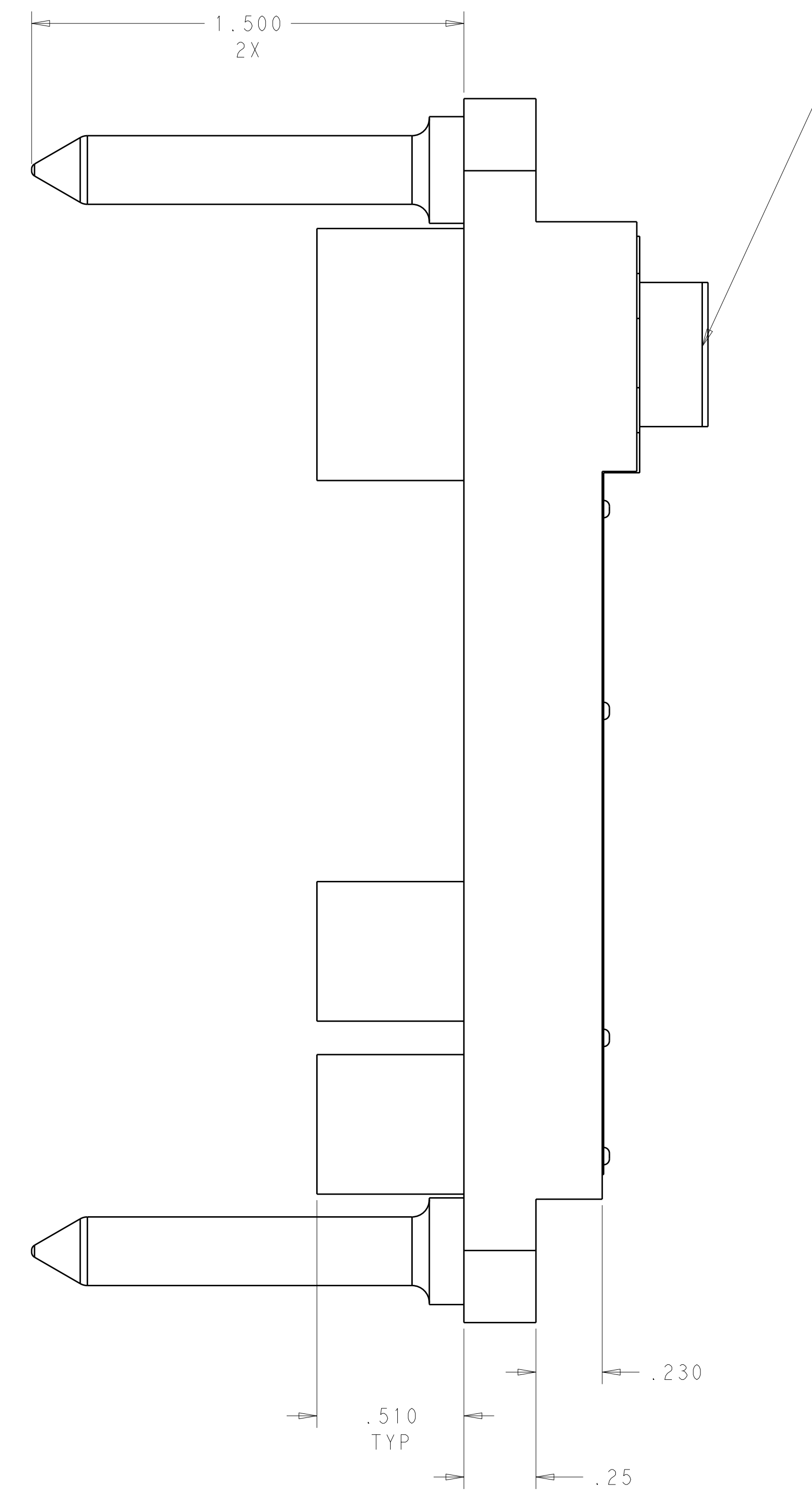

M6 X 1 INT. THREAD

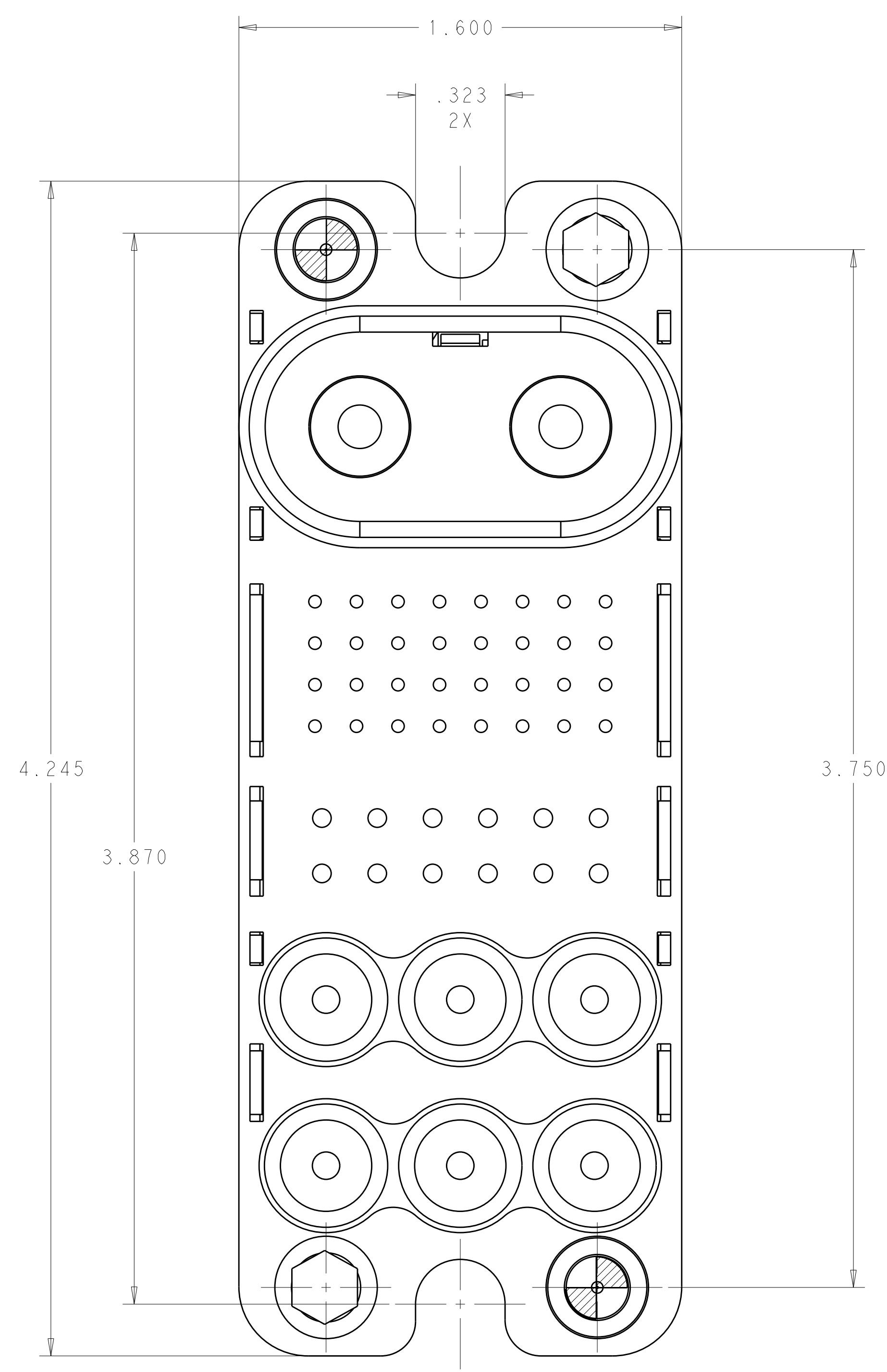
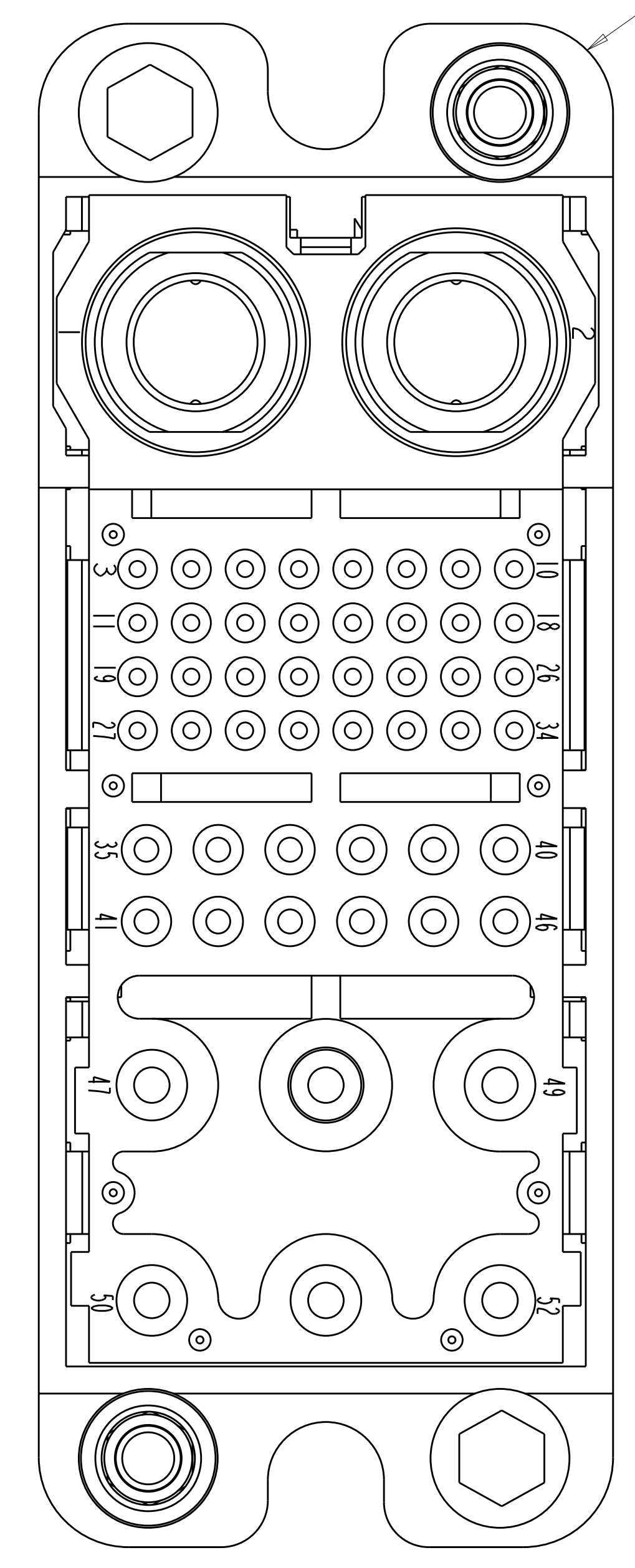

- PIN CONTACT SIZE #0 POSN. 1 & 2 (B) (5)
- PIN CONTACT SIZE #20 (C) (4)
- PIN CONTACT SIZE #16 (D) (4)
- PIN CONTACT SIZE #12 (E) (4)

6	1650156-2	CONTACT, PIN, SIZE No.12, CRIMP, PREMATE, HP	E
3	1650160-2	CONTACT, PIN, SIZE No.16, CRIMP, PREMATE	D
23	1650155-1	CONTACT, PIN, SIZE No.20, CRIMP, STD	C
2	1650280-3	CONTACT, PIN, SIZE No.0	B
1	1648570-2	CONNECTOR, PIN W/GUIDES	A
-1	PART NO.	DESCRIPTION	ITEM

DIMENSIONS: INCHES 9 PLC ±.01 7 PLC ±.02 5 PLC ±.010 4 PLC ±. ANGLES ±. MATERIAL: FINISH:		TOLERANCES UNLESS OTHERWISE SPECIFIED: 9 PLC ±. 7 PLC ±.02 5 PLC ±.010 4 PLC ±. ANGLES ±. MATERIAL: FINISH:		DWN: R. GRZYBOWSKI 14FEB2011 CHK: D. ORRIS 14FEB2011 APVD: D. ORRIS 14FEB2011 PRODUCT SPEC: 108-2285 APPLICATION SPEC: 114-13206 WEIGHT: - CUSTOMER DRAWING		Tyco Electronics Corporation Harrisburg, PA 17105-3608 NAME: PIN CONNECTOR ASSEMBLY W/GUIDES TOP DRAWER SIZE: A100779 CAGE CODE: C-1766680 SCALE: 3:1 SHEET 1 OF 2 REV A	
--	--	--	--	---	--	---	--

单击下面可查看定价，库存，交付和生命周期等信息

[>>TE Connectivity\(泰科\)](#)