

SCALA NON IMPEGNATIVA
(DO NOT SCALE)
DIMENSIONI IN mm
(DIMENSIONS IN)

METRIC

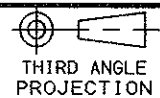

THIRD ANGLE
PROJECTION

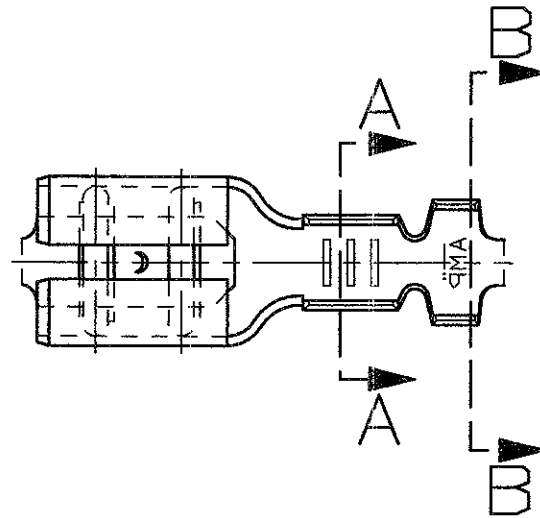

- PER PEZZI IN NASTRO
VEDERE DISEGNO 160429
(FOR STRIP VERSION
SEE DWG. 160429).
 - CONFEZIONATO IN ACCORDO ALLA
SPECIFICA AMP 107-20201.
(PACKAGED ACCORDING TO AMP SPEC. 107-20201).
- 3** OBSOLETE PARTS: OBSOLETE CIS STREAMLINING PER
D.RENAUD/D.SINISI

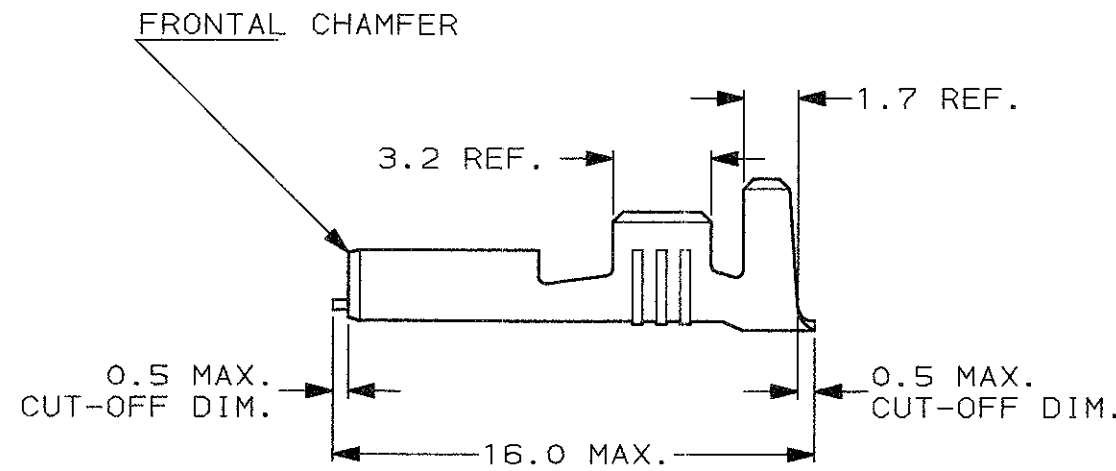
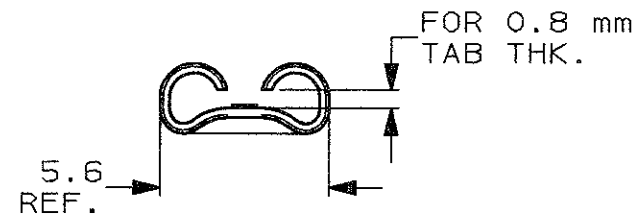

SEZIONE A-A
(SECTION A-A)

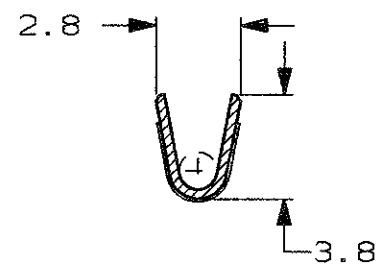

SEZIONE B-B
(SECTION B-B)

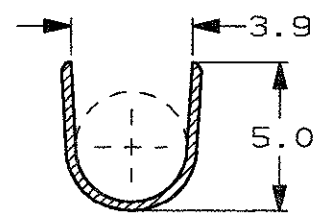

3 OBSOLETE

STAGNATO (TIN PLATED)	BRONZO FOS. (PHOS. BRONZE)	5-160491-6	K
PRE NICHIELATO (PRE-NICKEL PL.)	ACCIAIO (STEEL)	5-160491-4	K
STAGNATO (TIN PLATED)	OTTONE (BRASS)	5-160491-2	K
NUDO (PLAIN)	OTTONE (BRASS)	5-160491-1	K
FINITURA / COLORE (FINISH / COLOUR)	MATERIALE (MATERIAL)	NUMERO (AMP P/N)	REV

CUSTOMER DWG.
FOR REFERENCE ONLY

DISEGNO PER CLIENTE
SOLO PER RIFERIMENTO

THIS DRAWING IS UNPUBLISHED | RELEASE FOR PUBLICATION | 19

© COPYRIGHT 19 BY AMP INCORPORATED, HARRISBURG, PA. ALL INTERNATIONAL RIGHT RESERVED. AMP PRODUCTS MAY BE COVERED BY U.S. AND FOREIGN PATENT AND/OR PATENT PENDING

TOLLERANZE, SE NON DIVERSAMENTE SPECIFICATO (TOLERANCES, UNLESS OTHERWISE SPECIFIED)	DIAM. ISOLANTE (INS. DIA. RANGE)	RANGO FILO (WIRE RANGE)	SCALA (SCALE)
± 0.3	3.0-4.0	1.0-2.5	4:1

ANGOLI
(ANGLES) ± 2°

AMP AMP ITALIA S.p.A.
Corso F.lli Cervi, 15
COLLENO (TORINO)

K1	REVISED PER ECO-09-022178	KK	24 SEP 09	DIS. 02 NOV 2000 (DR.) H. YAALI	DESCRIZIONE (DESCRIPTION) FASTON® Connector, .187" sr. REC. CONTACT (LOOSE PIECE VERSION)	LOC. SIZE	NUMERO (DWG NO)	REV.	FOGLIO (SHEET)
K	FIRST EMISSION ET00-0198-01	H.Y.	27 JUL 2001	CONT. 02 NOV 2000 (CHK) C. TARTARI		I	A3	C-160491	K1
REV.	REVISIONI (REVISION RECORD)	DIS. DATA (DR)	DATE	APP. (APP.)					1 D1 (OF)

DISTRIBUZIONE
(PRINT DIST.)

单击下面可查看定价，库存，交付和生命周期等信息

[>>TE Connectivity\(泰科\)](#)