

THIS DRAWING IS UNPUBLISHED. RELEASED FOR PUBLICATION  
 © COPYRIGHT BY TYCO ELECTRONICS CORPORATION. ALL RIGHTS RESERVED.

LOC		DIST		REVISIONS			
P	LTR	DESCRIPTION		DATE	DWN	APVD	
B		REV PER ECO 05-013558		12DEC05	VF	CT	

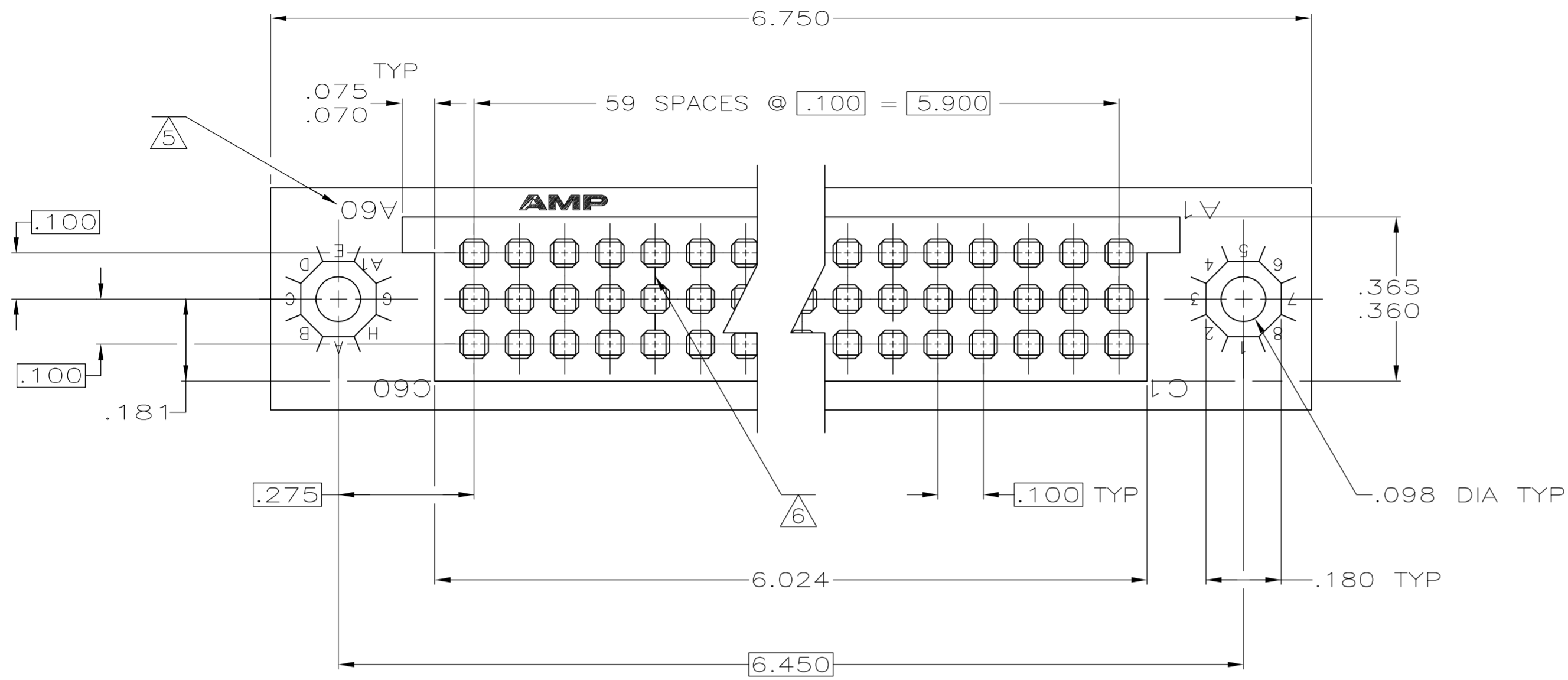

- ① (774444-4), AMP, DATE CODE, AMP P/N, MARKED THIS AREA.
- ② HOUSING MATERIAL: POLYPHENYLENE SULFIDE, GST-40F PER MIL-M-24519.
- ③ CONTACT MATERIAL: BERYLLIUM COPPER (BeCu) OR COPPER-NICKEL-SILICON (CuNiSi)
- ④ CONTACT FINISH: .000030 GOLD OVER .000030 NICKEL IN CONTACT AREA .000150 MIN BRIGHT TIN-LEAD (93/7) ON POSTS.
- ⑤ LETTERS INDICATING OUTSIDE ROWS AND NUMBERS INDICATING END CAVITIES MARKED THIS AREA.
- ⑥ LINES INDICATING EVERY FIVE CAVITIES MARKED ON MATING FACE.

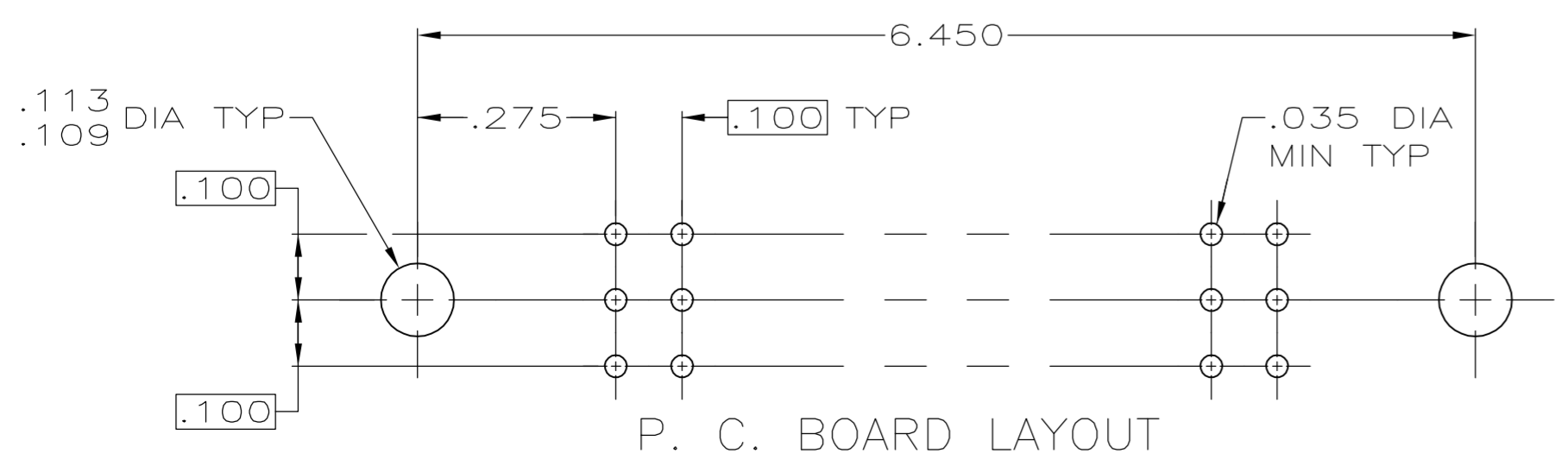
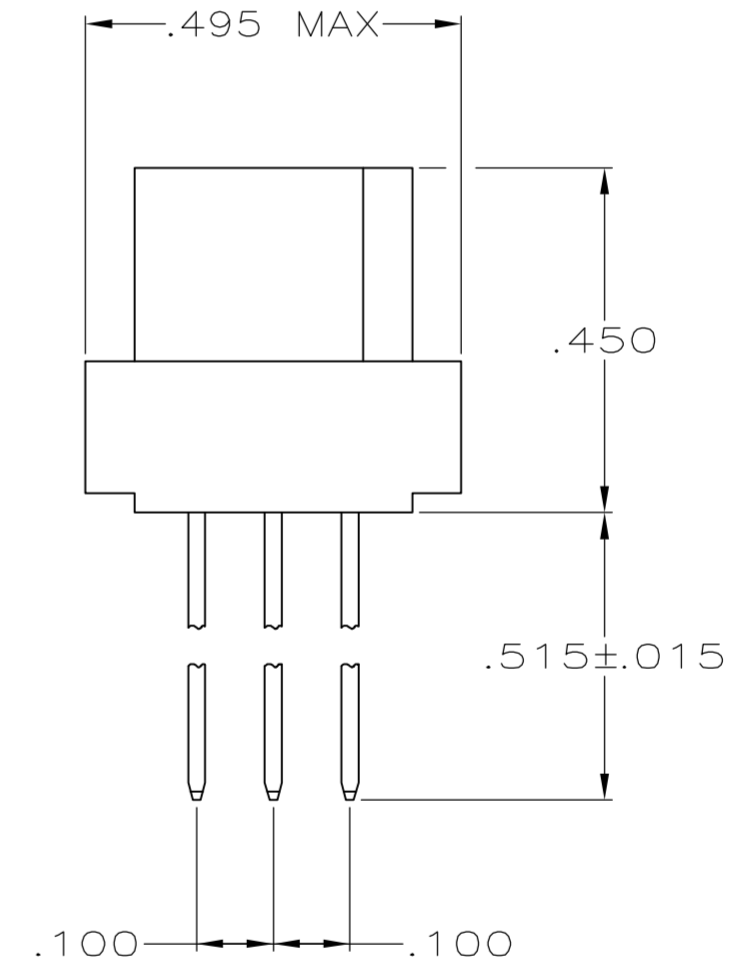
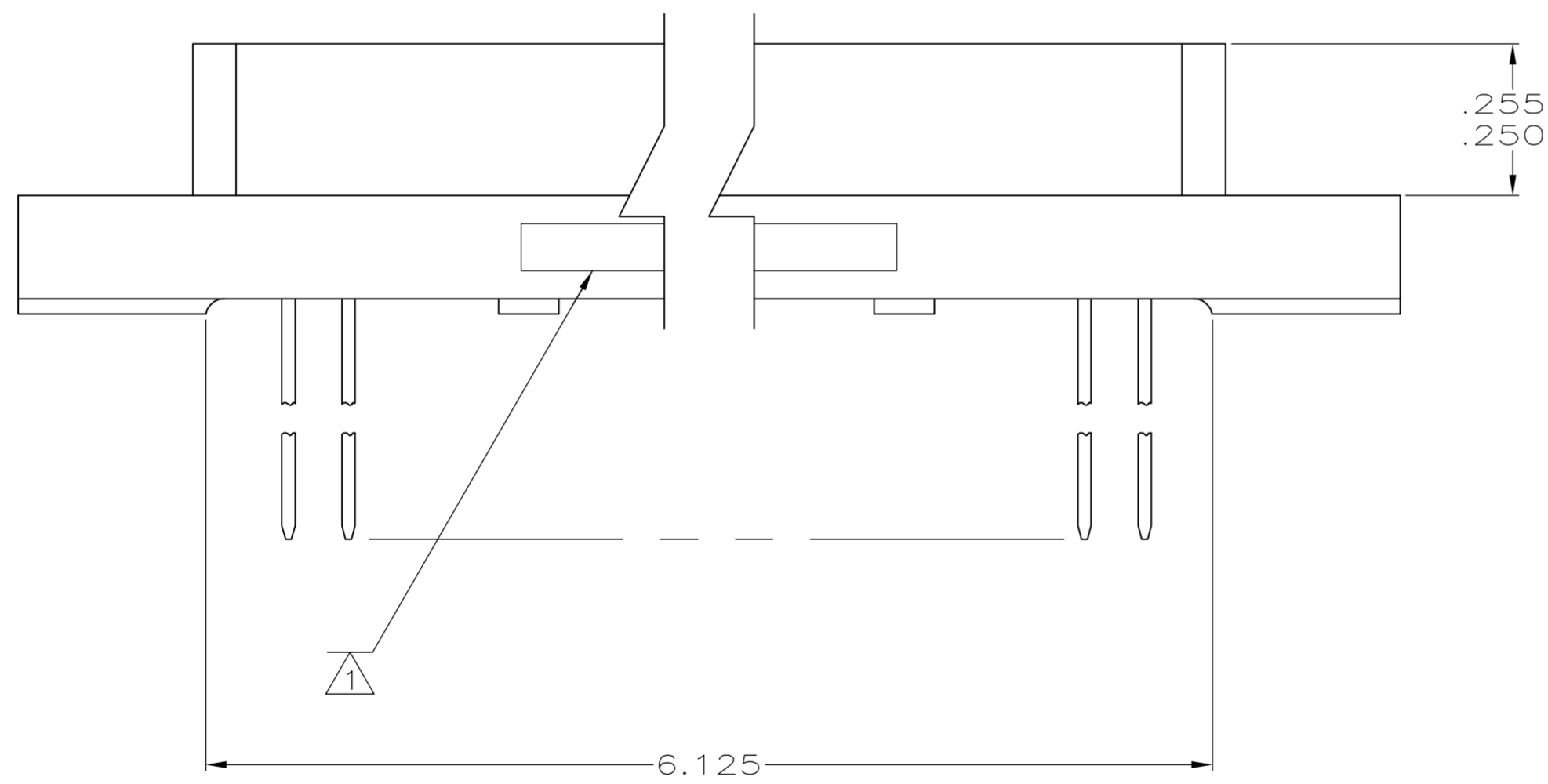

445457-1  
PART NO

THIS DRAWING IS A CONTROLLED DOCUMENT.		DWN T. SHUEY 8-5-88	 Tyco Electronics Corporation Harrisburg, PA 17105-3608
DIMENSIONS: INCHES		CHK D. MILLER 8-15-88	
TOLERANCES UNLESS OTHERWISE SPECIFIED:		APVD T. SHUEY 8-15-88	NAME
0 PLC ± -		PRODUCT SPEC	RECEPTACLE ASSEMBLY, 3-ROW BOX
1 PLC ± -		APPLICATION SPEC	100 C/L, W/MOUNTING EARS
2 PLC ± -			AND 2-HIGH WIRE WRAP POSTS
3 PLC ± .010		SIZE A2	CAGE CODE 00779
4 PLC ± -		DRAWING NO C=445457	RESTRICTED TO
ANGLES ± -		WEIGHT -	
FINISH		CUSTOMER DRAWING	SCALE 4:1
② ③		SHEET 1 of 1	REV B

单击下面可查看定价，库存，交付和生命周期等信息

[>>TE Connectivity\(泰科\)](#)