

PROD	LOC	DIST	P	F	ZONE	LTR	DESCRIPTION	DATE	APPD
4085	DF	50				A	REV PER 0600-4326-95	CT	DE

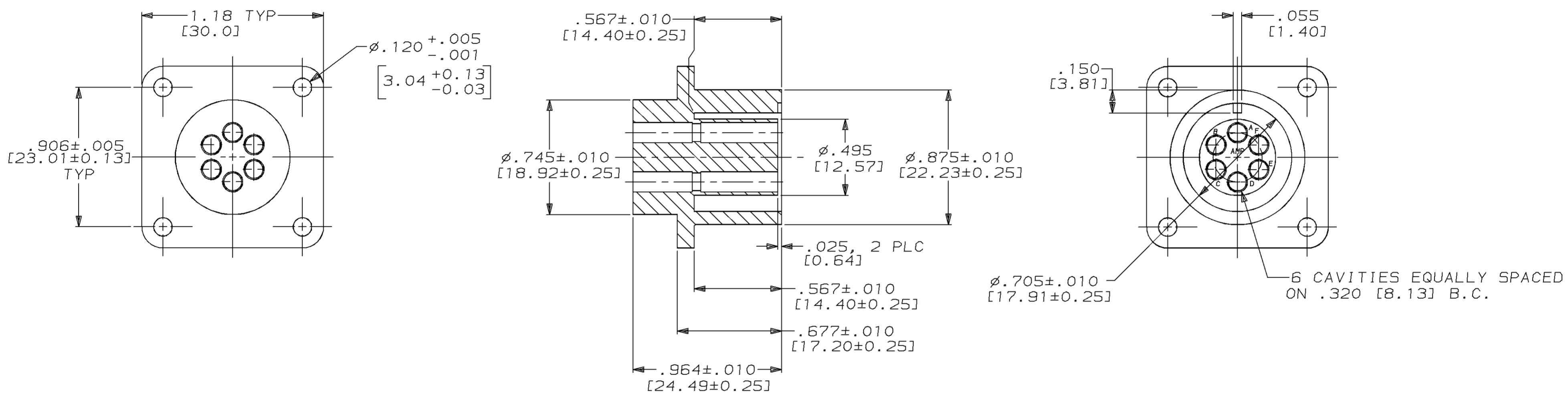

1. THIS CONNECTOR ACCEPTS SIX AMP MULTIMATE SOCKET CONTACTS, NOT SUPPLIED WITH CONNECTOR.
2. MARKED PER MIL-STD-130.

449652-1
PART NO.

DO NOT SCALE PRINT. UNLESS SPECIFIED DIMENSIONS IN INCHES [mm] TOLERANCES ON : 2 PLC DEC ± .03 [0.8] 3 PLC DEC ± .005 [0.13] ANGLES ± -	DR 9-8-93 C.C. THOMAS	AMP Incorporated Harrisburg, PA 17105-3608		
	CHK 9-8-93 S. GLATFELTER			
MATERIAL POLYESTER MLDG CMPD	APPD 9-8-93 S. GLATFELTER	SIZE	CAGE CODE	DRAWING NO
COLOR RED	APPD 9-9-93 C.C. THOMAS	©	00779	©=449652
	PRODUCT SPEC -	SCALE	2:1	SHEET 1 OF 1
	APPLICATION SPEC -	WEIGHT	-	

THIS DRAWING IS A CONTROLLED DOCUMENT FOR AMP INCORPORATED. IT IS SUBJECT TO CHANGE AND THE CONTROLLING ENGINEERING ORGANIZATION SHOULD BE CONTACTED FOR THE LATEST REVISION.

单击下面可查看定价，库存，交付和生命周期等信息

[>>TE Connectivity\(泰科\)](#)