

REVISIONS			
REV	DESCRIPTION	DATE	APPROVED
01 ₀	RELEASED		
01 ₁	ECNs 88-0678 & 90-0493	12/9/91	CW

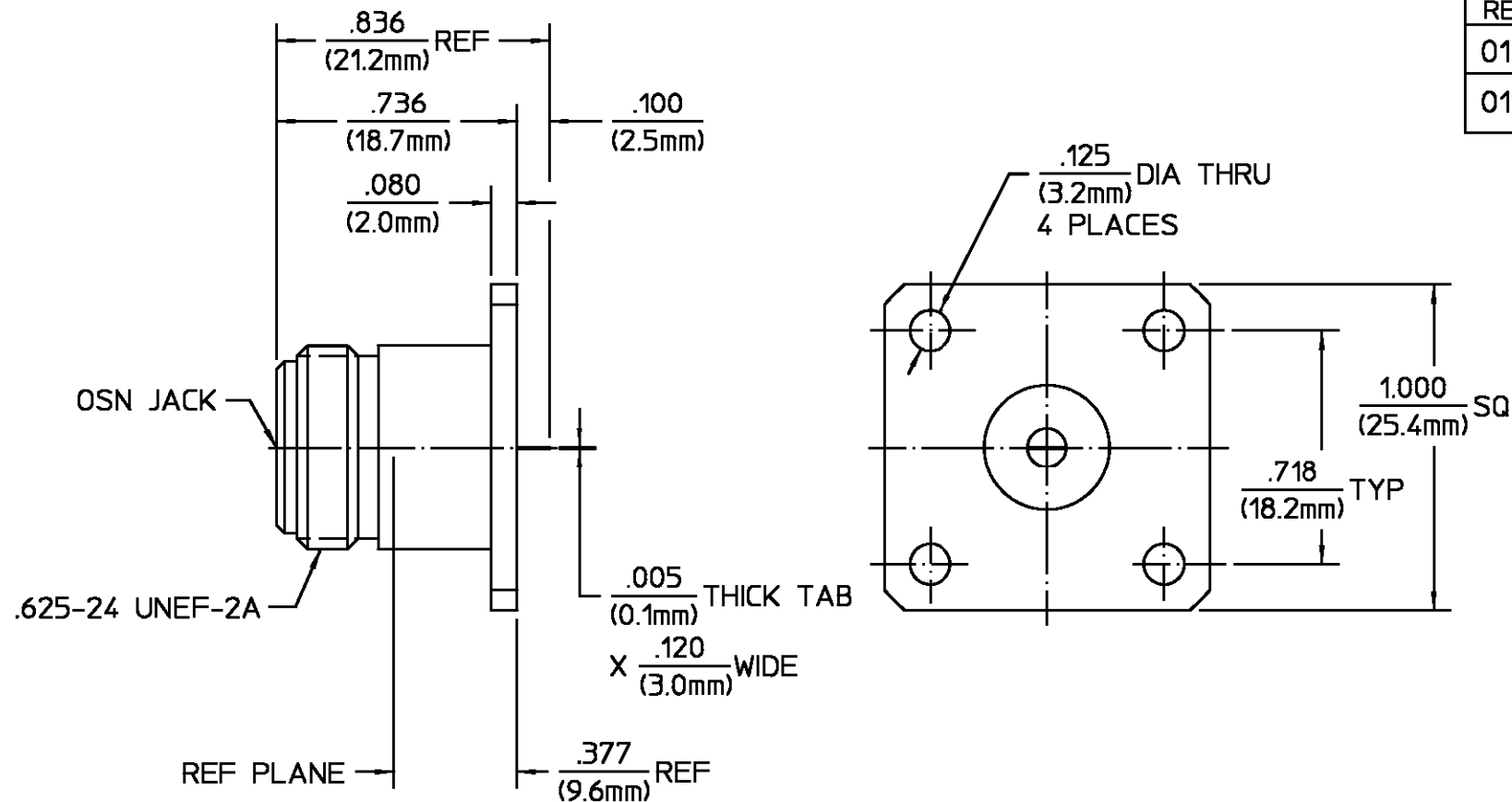

ELECTRICAL	MECHANICAL	ENVIRONMENTAL	HOUSING	MATERIAL	FINISH
Nominal Impedance (Ohms) <u>50</u>	Interface Dimensions MIL-STD-348A, Fig. 304.2	Temperature Rating <u>-65°C to +125°C</u>	BRASS PER QQ-B-626 COMP. 360, HALF HARD	NICKEL PLATE PER QQ-N-290 OVER COPPER PLATE PER MIL-C-14550	
Frequency Range (GHz) DC to <u>10</u>	Recommended Mating Torque <u>12 to 15 In-Lbs</u>	Vibration MIL-STD-202, Method 204, Condition B	DIELECTRIC TFE FLUOROCARBON PER ASTM-D-1457	N/A	
Volt Rating (VRMS MAX) @ Sea Level <u>1000</u>	Mating Characteristics: Insertion (MAX Lbs) <u>2.0</u>	Shock MIL-STD-202, Method 213, Condition I	CENTER CONTACT BERYLLIUM COPPER PER ASTM B 196, ALLOY C17300, CONDITION H	GOLD PLATE PER MIL-G-45204 MIL-G-45204 OVER COPPER PLATE PER MIL-C-14550	
VSWR <u>1.06+.007f(GHz)</u>	Withdrawal (MIN Oz) <u>2.0</u>	Thermal Shock MIL-STD-202, Method 107, Condition B, Except High Temp +115°C	COMPONENT		
Insertion Loss (dB MAX) <u>.05VfGHz</u>	Force to Engage and Disengage (In-Lbs MAX) <u>3.0</u>	Moisture Resistance MIL-STD-202, Method 106	UNLESS OTHERWISE SPECIFIED DIMENSIONS ARE IN INCHES TOLERANCE ON	<p>AMP Incorporated 140 Fourth Avenue Waltham, MA 02451-7599</p>	
RF Leakage (dB MIN) <u>-60 @ 2 to 3 GHz</u>	Center Contact Captivation Axial (Lbs) <u>6.0</u>	Corrosion - MIL-STD-202, Method 101, Condition B, 5% salt spray	FRAC. DEC. ANGLES ± 1/64 ±.005 ± °	<p>DRAWN BY JB DATE 10/27/75</p> <p>CHECKED BY RMF DATE 10/27/75</p> <p>APPD BY PRB DATE 10/27/75</p>	<p>AMP</p>
Corona, 70,000 Ft (VRMS MIN) <u>N/A</u>	Radial (In-Oz) <u>4.0</u>		These drawings and specifications are the property of Omni Spectra Incorporated and shall not be reproduced or copied or used in whole or in part as the basis for the manufacture or sale of item(s) without written permission.	<p>USE ASS'Y PROCEDURE</p> <p>NO. AP. <u>N/A</u></p>	<p>TITLE OSN FLANGE MOUNT JACK RECEPTACLE TAB TERMINAL</p>
Dielectric Withstanding Voltage (VRMS MIN) @ Sea Level <u>2500</u>				<p>SCALE 2:1</p>	<p>SIZE B CODE IDENT NO. 26805 3052-1648-10 REV 01₁</p>
Contact Resistance (Milliohms MAX) Center Contact <u>1.5</u>					SHEET 1 OF 1
Outer Contact <u>2.0</u>					
RF High Potential @ Sea Level (VRMS MIN @ 5 MHz) <u>1500</u>					
LR.(Megohms MIN) <u>10,000</u>					

CUSTOMER DRAWING

AMP PART # 1057293-1
SHEET 1 OF 1 REV A

单击下面可查看定价，库存，交付和生命周期等信息

[>>TE Connectivity\(泰科\)](#)