

4	SIZE 5 COAX (SOCKET)	225791-2
3	SIZE 16 (SOCKET)	205117-1
124	SIZE 20 (SOCKET)	205116-1
QTY	CONTACT DESCRIPTION	PART NUMBER

1. MATERIAL AND FINISH:
 SHELL: DIE CAST ALUMINUM ALLOY PER FED. SPEC QQ-A-591.
 STANDARD FINISH: CADMIUM PLATE PER QQ-P-416, TYPE I,
 CLASS 2 YELLOW CHROMATE CONVERSION.
 INSERT RETENTION PLATE: ALUMINUM ALLOY, BLUE ANODIZE
 PER MIL-A-8625.
 SCREWS AND WASHERS: STAINLESS STEEL, PASSIVATED.
 POLARIZING POSTS: STAINLESS STEEL, PASSIVATED.
 POLARIZING NUTS: BRASS, CADMIUM PLATED.

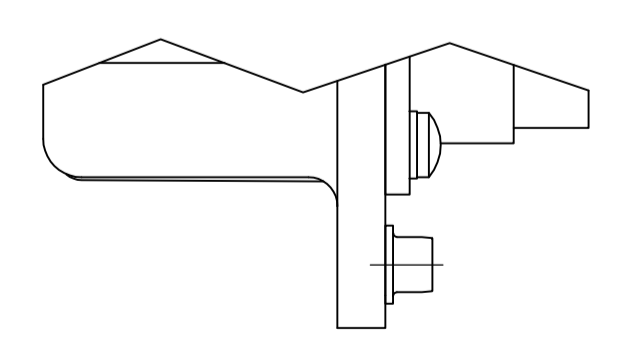
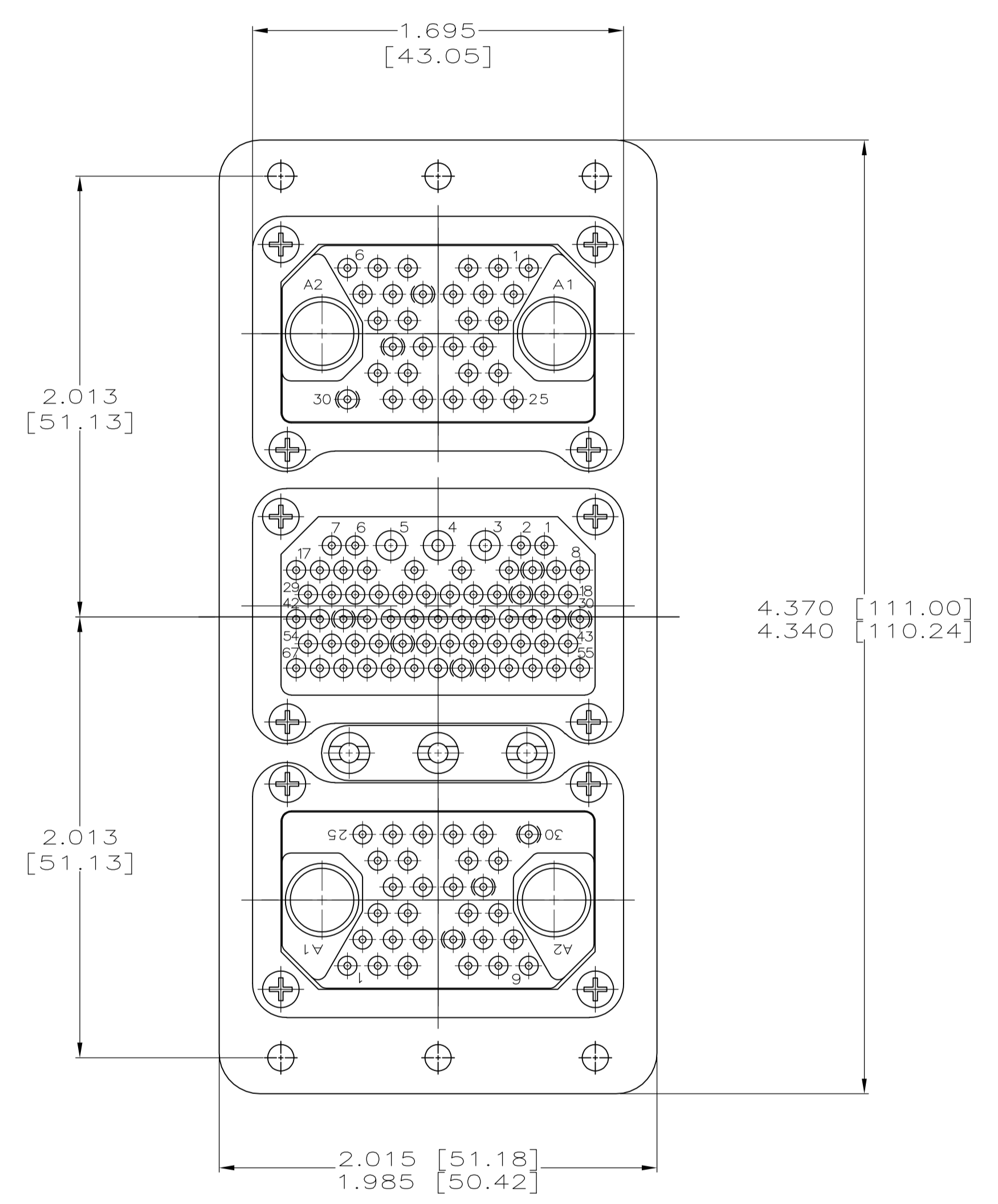
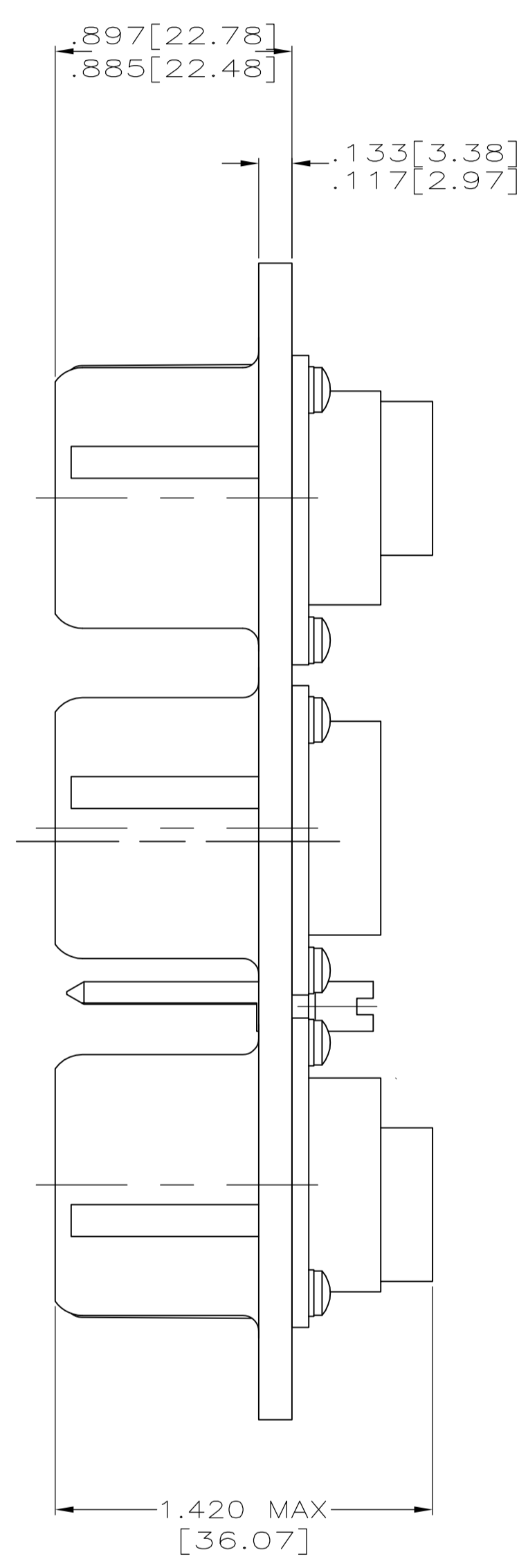
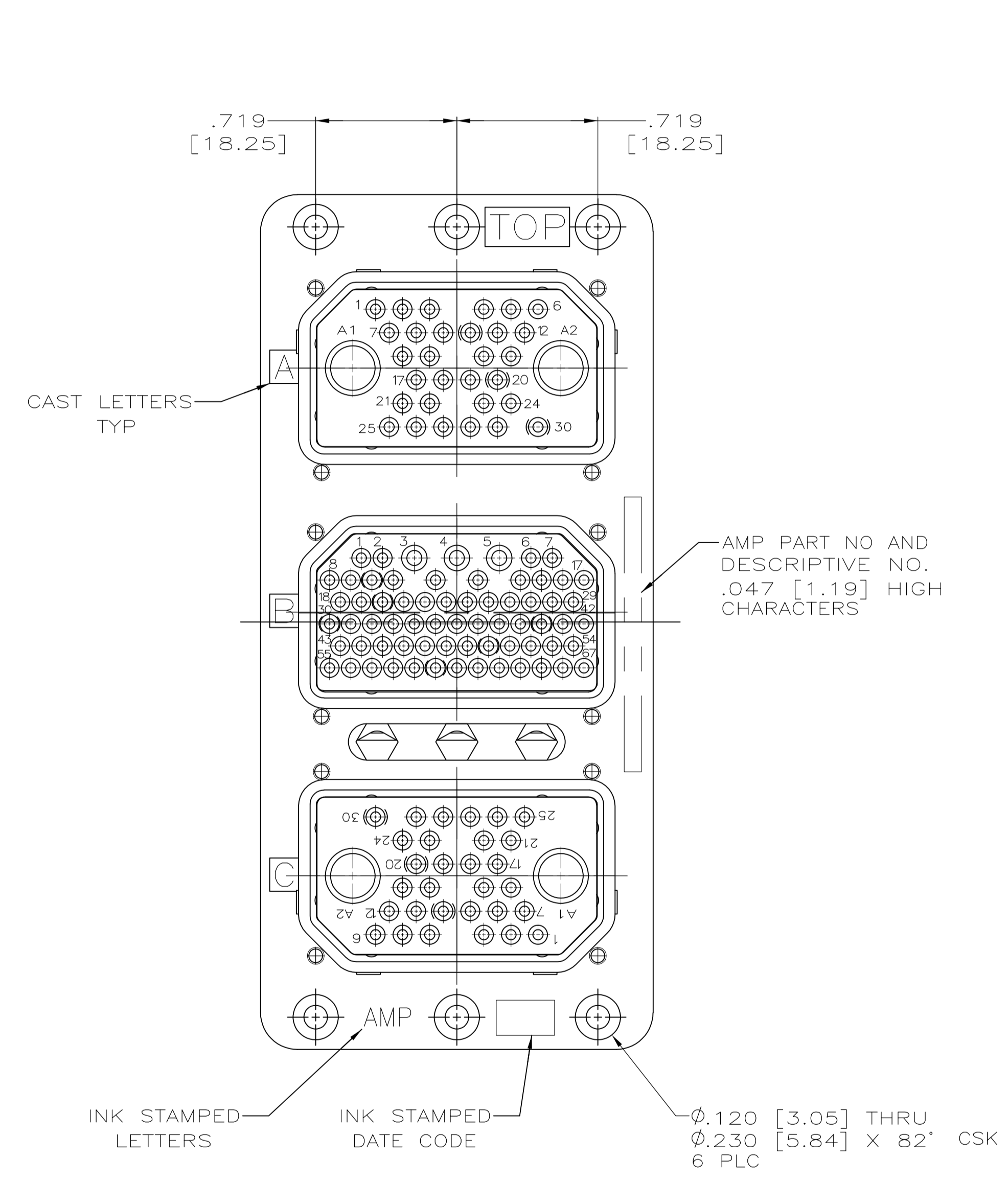

#4-40 CLINCH NUT DETAIL
 IN 4 CORNERS
 443197-3 ONLY

01	RM3P32C2S67S32C2S-0101 (200)	443197-3
02	RM3P32C2S67S32C2S-0002 (200)	443197-2
01	RM3P32C2S67S32C2S-0001 (200)	443197-1
KEYING POSITION	DESCRIPTIVE NO.	PART NO.

THIS DRAWING IS A CONTROLLED DOCUMENT.		DIN	7-2-96	TE Connectivity	
DIMENSIONS: INCHES		CHK	8-12-96	NAME	
TOLERANCES UNLESS OTHERWISE SPECIFIED:		APVD	8-12-96	CONNECTOR ASSY,ARINC 404,PLUG	
0 PLC	± -	PRODUCT SPEC		APPLICATION SPEC	
1 PLC	± -			SIZE	
2 PLC	± -			CAGE CODE	
3 PLC	± -			DRAWING NO	
4 PLC	± -			RESTRICTED TO	
ANGLES	± -			WEIGHT	
MATERIAL	SEE CALLOUT	FINISH	SEE CALLOUT	A1 00779 C=443197	
CUSTOMER DRAWING		SCALE	2:1	SHEET 1 OF 1 REV C	

单击下面可查看定价，库存，交付和生命周期等信息

[>>TE Connectivity\(泰科\)](#)