

© 2020 TE Connectivity. All Rights Reserved.

PART NUMBER	REV	DESCRIPTION
2359750-1	A	HV DIE SET
7-2359750-7	A	CRIMP TOOLING KIT

REVISIONS					
P	LTR	DESCRIPTION	DATE	DWN	APVD
	A	RELEASED	03JUN2020	LG	TE
	A1	ECR-20-012805	10SEP2020	JL	YY

TERMINAL NAME	FERRULE, HVA280-2phi		
TE TERMINAL PART NUMBER(S)	1587828-3	1587829-3	
APPLICATION SPECIFICATION	114-13259		
USED ON	2305470-1	2326378-1	
INSTRUCTION SHEET	408-35055		

CABLE SUPPLIER / SPECIFICATION	CABLE SIZE	CRIMP HEIGHT	CRIMP HEIGHT REFERENCE SETTING
HUBER+SUHNER/12582674 LEONI/76231175A	4.0mm ²	7.4±0.1	C5

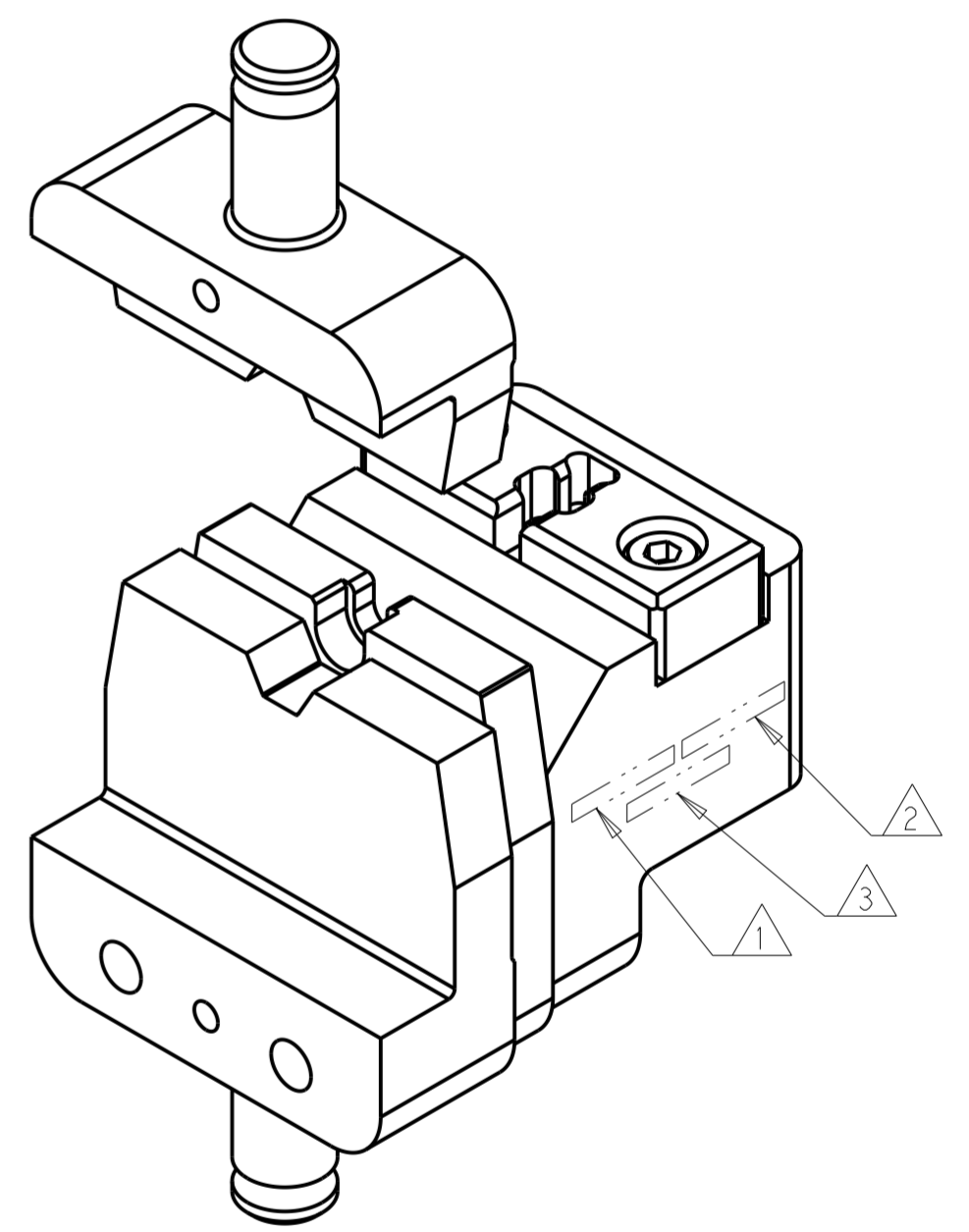
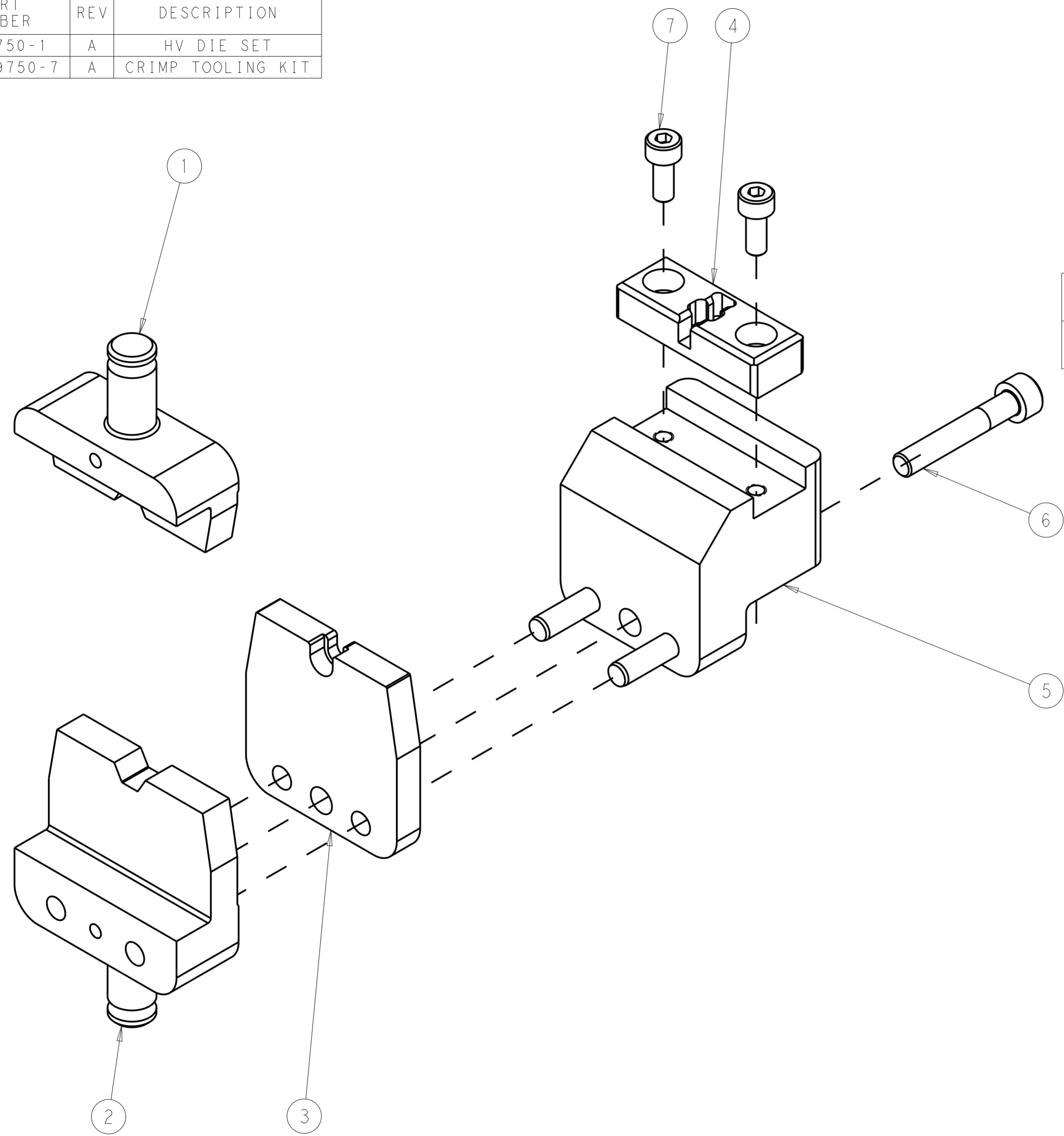

-	2	1-18023-1	SCR, SKT HD CAP M4 X 10.0	7
-	1	2-18023-3	SCR, SKT HD CAP M5 X 30.0	6
-	1	2365901-1	HOUSING, LOCATOR	5
-	1	2361412-1	BLOCK, TERMINAL	4
-	1	2361389-2	LOCATOR, FERRULE	3
1	1	2365893-4	ANVIL	2
1	1	2365896-4	CRIMPER	1
-77	-1	PART NO	DESCRIPTION	ITEM NO

- ① APPLY "DIE SET PN" PER TEC-115-67-2 IN APPROXIMATE AREA SHOWN.
- ② IDENTIFY PART NUMBER AND REVISION LETTER PER TEC-115-67-2 IN APPROXIMATE AREA SHOWN.
- ③ IDENTIFY SERIAL NUMBER PER TEC-115-67-2 IN APPROXIMATE AREA SHOWN.
- 4. TORQUE RECOMMENDATIONS PER 101-35000 UNLESS OTHERWISE SPECIFIED.

THIS DRAWING IS A CONTROLLED DOCUMENT.

DIMENSIONS:	TOLERANCES UNLESS OTHERWISE SPECIFIED:	DWN	12FEB2020
mm	0 PLC ±	CHK	K HUANG
	1 PLC ±	CHK	K HUANG
	2 PLC ±	APVD	Y YIN
	3 PLC ±	APVD	12FEB2020
	4 PLC ±	PRODUCT SPEC	
MATERIAL	ANGLES ±	APPLICATION SPEC	
	FINISH ±	WEIGHT	
		CUSTOMER ACCESSIBLE PRODUCTION DRAWING	SCALE 3:2 SHEET 1 OF 1 REV A1

STE TE Connectivity

NAME: DIE ASM, HVA280-2phi
4mm² FERRULE

SIZE: A2 CAGE CODE: 00779 DRAWING NO: C-2359750

单击下面可查看定价，库存，交付和生命周期等信息

[>>TE Connectivity\(泰科\)](#)