

THIS DRAWING IS UNPUBLISHED. RELEASED FOR PUBLICATION .19
 BY AMP INCORPORATED. ALL RIGHTS RESERVED.

LOC	DIST	REVISIONS			
P	LTR	DESCRIPTION	DATE	DWN	APVD
AD	00	G	REV PER 0621-0284-98	REDRAWN	25JAN99 BH 5B

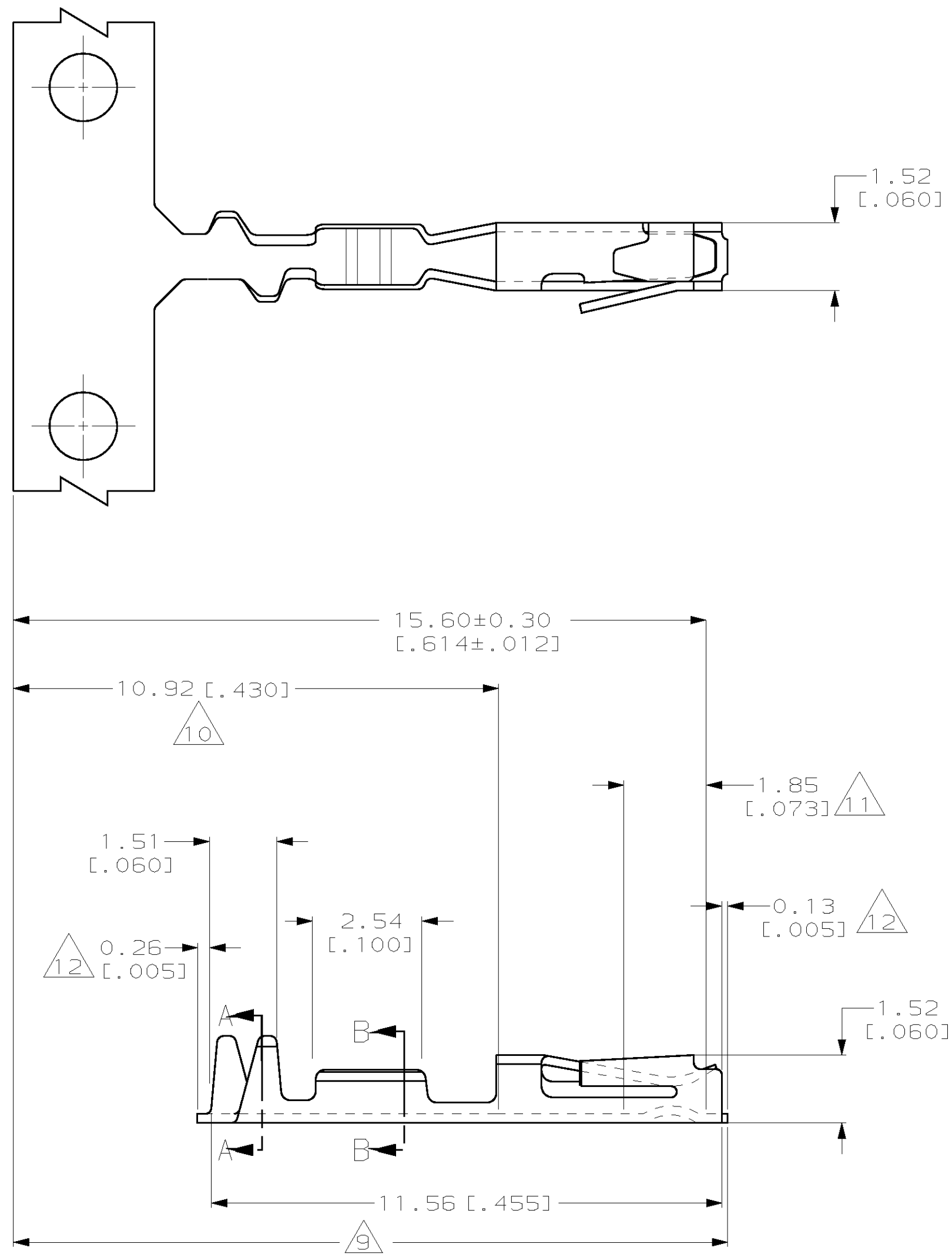

1. WIRE RANGE 28-32 AWG.
2. INSULATION RANGE 0.71-1.37 [0.028-.054] DIA.
3. 0.00254 [0.000100] MIN TIN-LEAD OVER 0.000762 [0.000030] MIN NICKEL.
4. PREPLATED 0.00127 [0.000050] MIN TIN-LEAD IN ZONES I & II, 0.000762 [0.000030] MIN GOLD OVER 0.000762 [0.000030] MIN NICKEL INLAY IN ZONE III.
5. PREPLATED 0.00127 [0.000050] MIN TIN-LEAD IN ZONES I & II, 0.000381 [0.000015] MIN GOLD OVER 0.000762 [0.000030] MIN NICKEL INLAY IN ZONE III.
6. PREPLATED 0.00127 [0.000050] MIN TIN-LEAD IN ZONES I & II, 0.00127 [0.000050] MIN GOLD OVER 0.000762 [0.000030] MIN NICKEL INLAY IN ZONE III.
7. PHOSPHOR BRONZE.
8. OBSOLETE.
9. ZONE I (OUTSIDE SURFACES).
10. ZONE II (INSIDE SURFACES).
11. ZONE III (INSIDE SURFACES).
12. MAXIMUM CUTOFF.

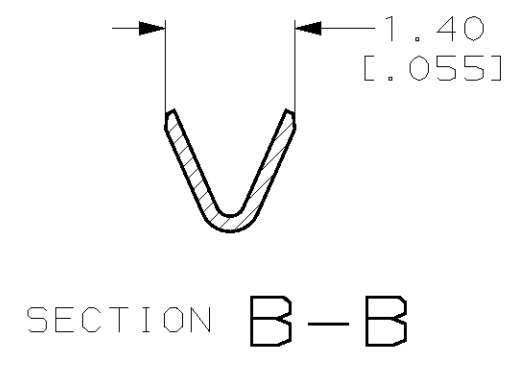
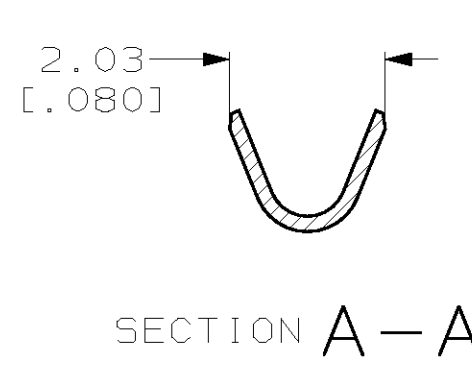

6	8	531225-9	8	531225-8
4	8	531225-7	8	531225-6
5	8	531225-5	8	531225-4
3	8	531225-3	8	531225-2
FINISH		LOOSE PIECE PART NO	STRIP PART NO	

THIS DRAWING IS A CONTROLLED DOCUMENT.		DWN B. HAYMAKER 25JAN99	AMP Incorporated Harrisburg, PA 17105-3608	
DIMENSIONS: MM(INCH)		CHK S. BOLASH 25JAN99	CONTACT, RECEPTACLE, HIGH PRESSURE MINI-TANDEM SPRING	
TOLERANCES UNLESS OTHERWISE SPECIFIED:		APVD S. BOLASH 25JAN99	PRODUCT SPEC 108-25031	
0 PLC ±-		APPLICATION SPEC 114-25021		
1 PLC ±-		SIZE A2		
2 PLC ±-		CAGE CODE 00779		
3 PLC ±0.13(.005)		DRAWING NO 531225		
4 PLC ±-		RESTRICTED TO -		
ANGLES ±-		SCALE 4:1		
FINISH		SHEET 1 OF 1		
7		REV G		
3 4 5 6		CUSTOMER DRAWING		

531225

B

A

单击下面可查看定价，库存，交付和生命周期等信息

[>>TE Connectivity\(泰科\)](#)